

151 PLUG IN DRIVE | RIDGEVILLE, SC 29472

MAGNUS CBRE



152,880 SF Building For Sale  
OR  
±32,760-120,120 SF Available For Lease

# Vantage Point 2

CAMPUS 1 | CAMP HALL MASTER PLANNED DEVELOPMENT

PROPERTY VIDEO



# Available For Sale / Lease



±32,760 - 120,120 SF

Available



152,880 SF

Total Size



IMMEDIATE

Possession

## Camp Hall – Campus 1 Site Details

- » On-site Interchange
- » Construction complete
- » 1 mile from I-26
- » Under 4 miles from US-176
- » 2.5 miles from SC Highway 27
- » 18 miles from I-95
- » 27 miles from Charleston International Airport (CHS)
- » 30 minutes from Port of Charleston
- » CSX railroad access coming soon
- » Highly visible location as the first development parcel off I-26
- » Access to Camp Hall multi-use trail network
- » Across from the Village Center
- » Less than 1 mile to Refuel Market
- » Closest to the Volvo Plant and Offices
- » Accessible from both Volvo Car Drive and Autonomous Drive
- » Part of FTZ (Foreign-Trade Zone) offering substantial logistics & economic benefits

# Building Specs



TOTAL SIZE	152,880 SF
AVAILABLE	120,120 SF
DIVISIBILITY	32,760 SF
DIMENSIONS	210' DEEP X 728' LONG
BAY SIZE	10,920 SF
DOCK DOORS	ELEVEN (11)
DRIVE-IN DOOR	ONE (1) 12' X 14'
CLEAR HEIGHT	32'
COLUMN SPACING	52' X 50'
SPEED BAY	60'
TRUCK COURT	135'
ELECTRIC	400 AMPS EXPLANDABLE
AUTO PARKING	129 SPACES
LIGHTING	25 FCL
LEVELERS	ELEVEN (11) 35,000 LBS



# FLOOR PLAN

152,880 TOTAL SF

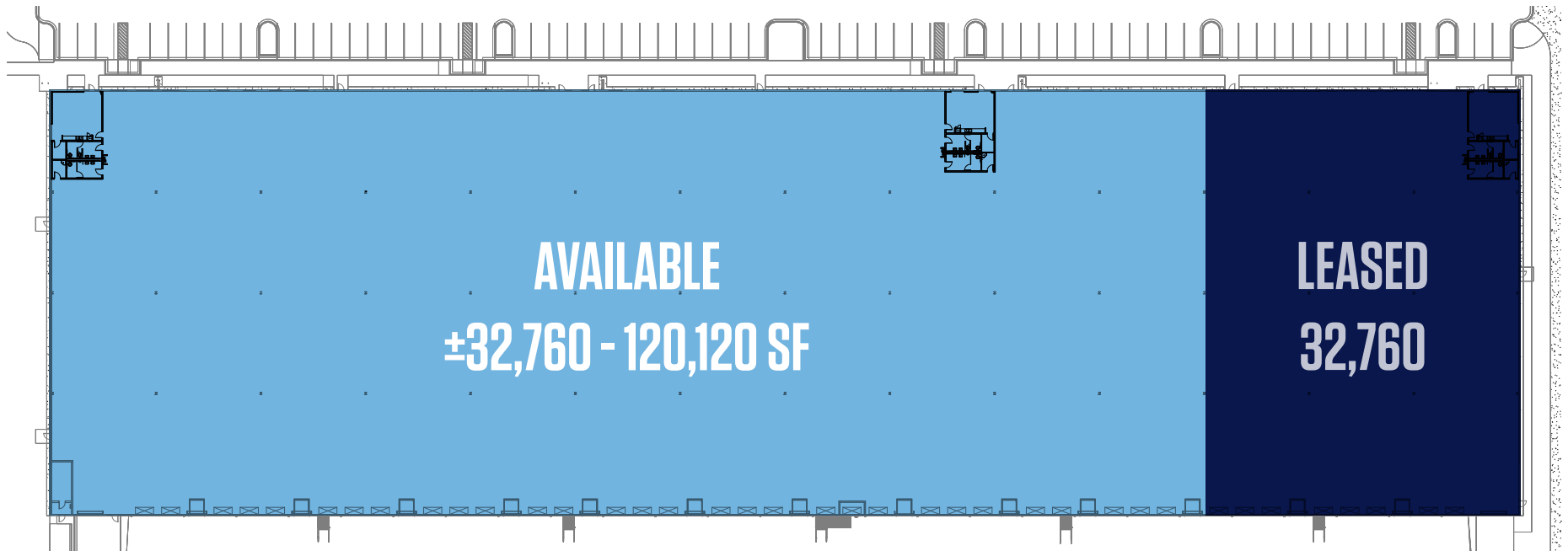
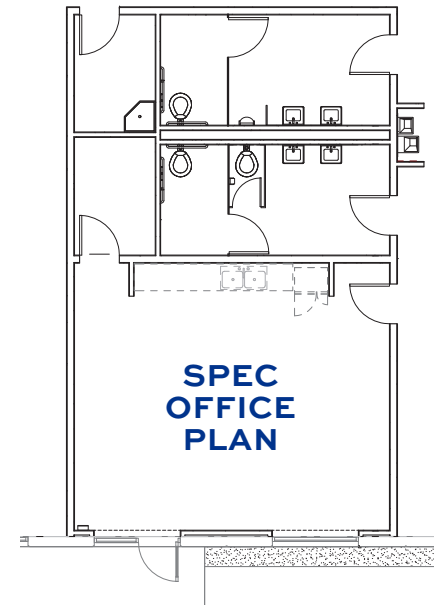

# Property Photos





# Camp Hall Master Plan



6,800+ TOTAL ACRES



2,600+ ACRES OF PRESERVED LAND



# VOLVO CAR USA

In 2015, **Volvo Car USA** selected Camp Hall for its **first-ever U.S. manufacturing plant**

A SELECTION THAT WILL ULTIMATELY CREATE NEARLY

**4,000 LOCAL JOBS**

**\$4.8B IN ECONOMIC IMPACT**

- **\$1.1 billion** campus at Camp Hall
- S60 Sedan Production **2018**
- Volvo Car University **2022**
- XC90 SUV Production **2024**
- Battery Manufacturing Plant **2024**
- Polestar **2024**

# REDWOOD MATERIALS

- » Redwood's New Battery Campus in the heart of the "Battery Belt"
- » Commenced Q4 2024 and up and running Q3 2025, creating a closed loop battery supply chain

**1,500 LOCAL JOBS**

**\$3.5B IN ECONOMIC IMPACT**



# INCENTIVES

- » Automotive manufacturing
- » Consumer goods distribution
- » Refrigerated/frozen exports
- » Transloading resin & grain
- » Tire manufacturing & distribution

## STATE INCENTIVES

### JOB TAX CREDIT – STATUTORY

- Purpose: Reduce corporate income tax liability for new or expanding companies creating jobs in the state
- Value: Tax credit given annually for 5 years for each new job if requirements are satisfied

### CORPORATE HEADQUARTERS CREDITS – STATUTORY

- Income tax credits to partially reimburse for real and personal property expenditures associated with new headquarters related jobs

### INVESTMENT TAX CREDIT – STATUTORY

- A one-time credit against a company's corporate income tax of up to 2.5% of a company's investment in new production equipment

### PORT VOLUME INCREASE CREDIT – NEGOTIATED AND DESCRESINCARY

- Possible income tax credit or withholding tax credit to manufacturers or distributors or companies engaged in warehousing, freight forwarding, freight handling, goods processing, cross docking, transloading or wholesale of goods

## COUNTY INCENTIVES

### FEE-IN-LIEU OF PROPERTY TAX – NEGOTIATED

- Purpose: Reward substantial investment by reducing tax burden over the long-term
- Value: Approximately 42% tax reduction annually for 20 years on new capital investment occurring in a 5-year investment window

### SPECIAL SOURCE REVENUE CREDIT – NEGOTIATED

- Reduces property taxes paid by business

## RECRUITMENT AND TRAINING SUPPORT

### READYSC

- No cost recruitment, screening, testing and pre-employment training when hiring 15-20 new production workers; on-the-job training reimbursement possible when hiring less than 15 new employees

### ENTERPRISE ZONE RETRAINING CREDITS

- Cash match of up to \$2,000 per employee over 5 years for retraining of existing production employees

# CHARLESTON BENEFITS

## Did You Know?

- #5 Industrial Park 2023 — Business Facilities
- #1 Economic Development Incentives — Industry Experts
- #2 Best State for Doing Business 2024 — Area Development
- #5 Best State for Business Climate 2014 — Site Selection

## Why Charleston

- » Panama Canal expansion is now complete
- » 29 Days from Shanghai to Memphis
- » Consumers are demanding faster, cheaper delivery
- » 80% savings on inland distribution to key Eastern metro areas
- » Improved delivery times and cost for Eastern E-com orders

## Key Industrial Influences



Boeing Aviation



Volvo Automotive



Port of Charleston



Walmart Distribution 3M SF

- » 100,000-Lb. GVW limit
- » 72% of US consumers live within a 2-day drive of CHS
- » Max allowable Hours of Service
- » Large-Reliable supply of empty containers
- » OpGrowing Population = Labor Capacity
- » Most productive ports = Low and stable

151 PLUG IN DRIVE | RIDGEVILLE, SC 29472



# Vantage Point 2

FOR MORE INFORMATION OR TO SCHEDULE A TOUR, PLEASE CONTACT:

**Bob Barrineau**

Senior Vice President

T +1 843 270 7851

robert.barrineau@cbre.com

**Brendan Redeyoff, SIOR**

Senior Vice President

T +1 843 793 8839

brendan.redeyoff@cbre.com

**MAGNUS**

**CBRE**

© 2026 CBRE, Inc. All rights reserved. This information has been obtained from sources believed reliable, but has not been verified for accuracy or completeness. You should conduct a careful, independent investigation of the property and verify all information. Any reliance on this information is solely at your own risk. CBRE and the CBRE logo are service marks of CBRE, Inc. All other marks displayed on this document are the property of their respective owners, and the use of such logos does not imply any affiliation with or endorsement of CBRE. Photos herein are the property of their respective owners. Use of these images without the express written consent of the owner is prohibited.