

# Available

4811 - 4813 Nashville Road  
Bowling Green, KY 42101



## Property features:

- 598,624 SF available in two buildings
- 34.06 acres
- Zoned H-I
- Two diesel generators
- 243 parking spaces
- 27 docks
- 16 levelers
- One 15' x 15' drive-in door
- Rail line adjacent

## Building 1

- 260,800 SF
- 24' - 26' clear height
- 2000 KVA power
- Ample parking
- Air conditioning equipment available
- Built in 1990
- Tornado shelter (interior)
- Eight Blue Giant warehouse fans

## Building 2

- 337,824 SF
- 25,000 SF office (2 story)
- 36' - 40' clear height
- 50' x 90' column spacing
- TPO roof
- 750 KVA power
- Built in 2015

4811 - 4813 Nashville Road  
Bowling Green, KY 42101

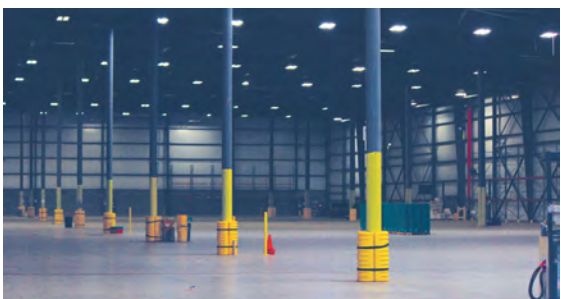
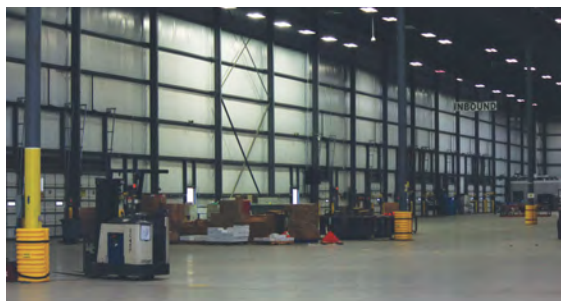

4811 - 4813 Nashville Road  
Bowling Green, KY 42101

Building 1

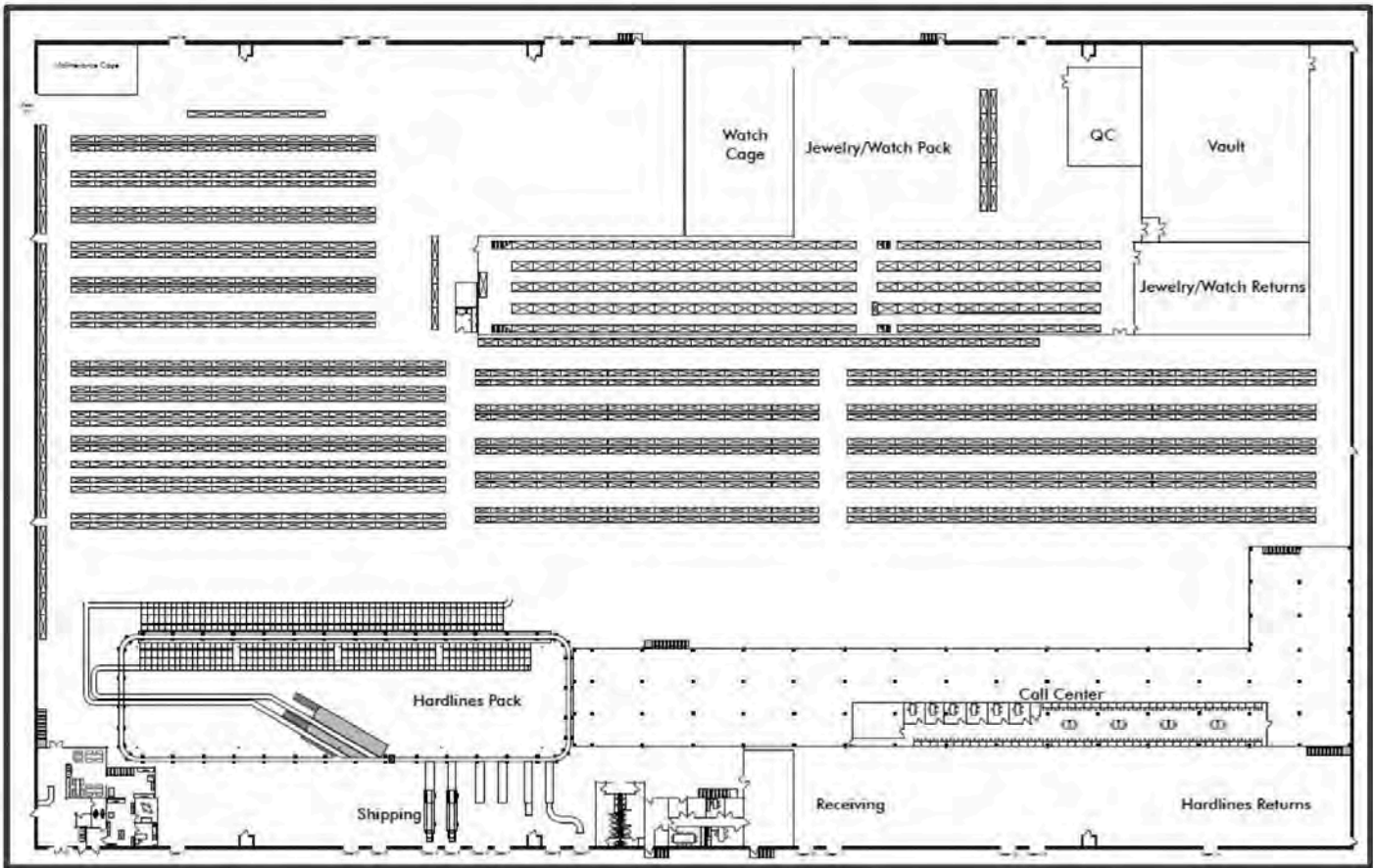

Building 2 Office

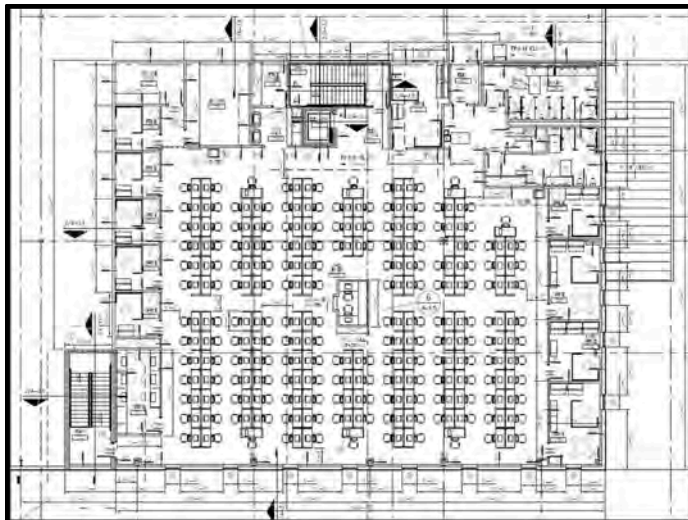

Building 2



4111 - 4813 Nashville Road  
Bowling Green, KY 42101

Property is located between Nashville and Louisville with excellent access to I-65.

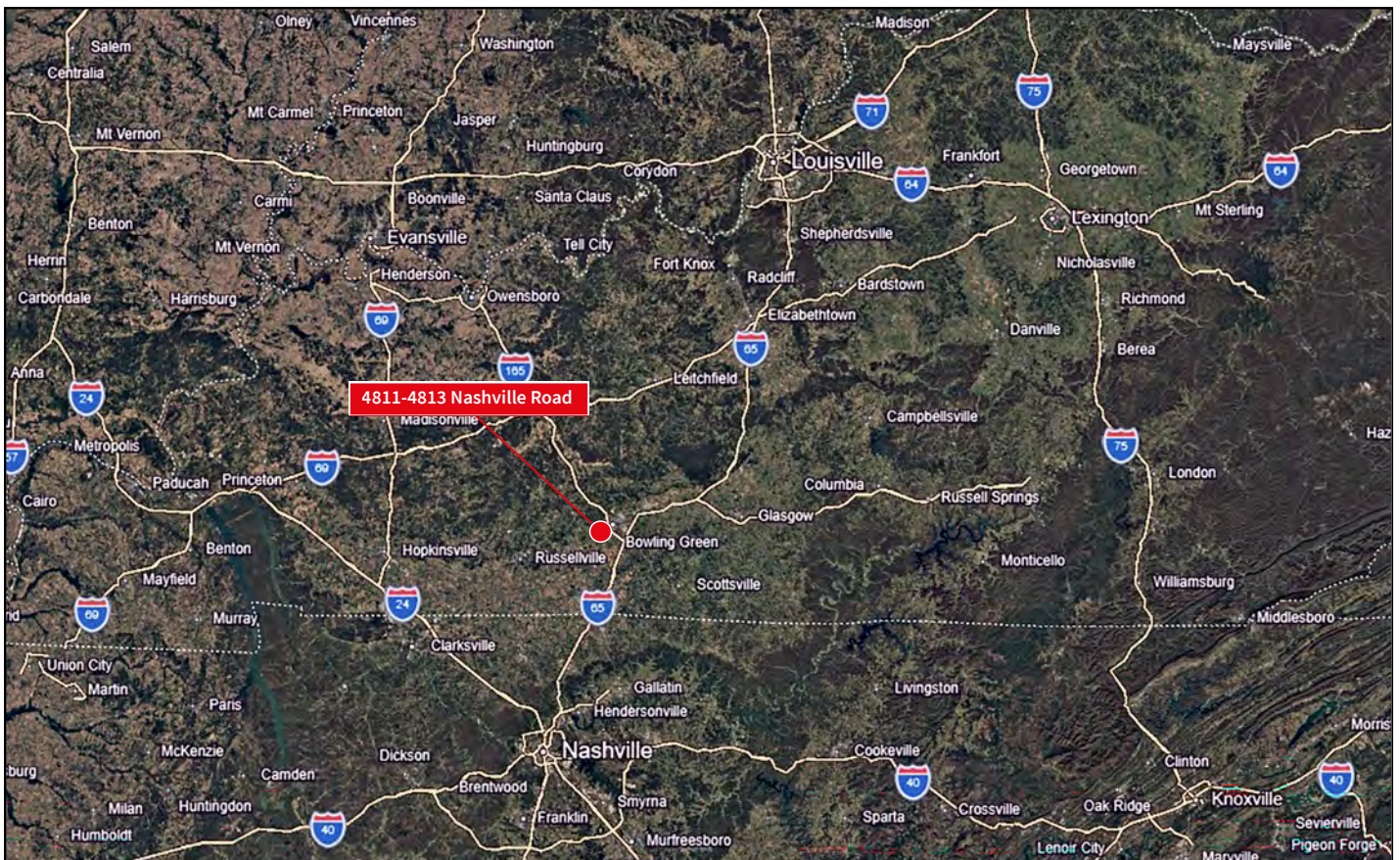

**Chris Beard, CCIM**  
chris.beard@jll.com  
+1 502 394 2513