

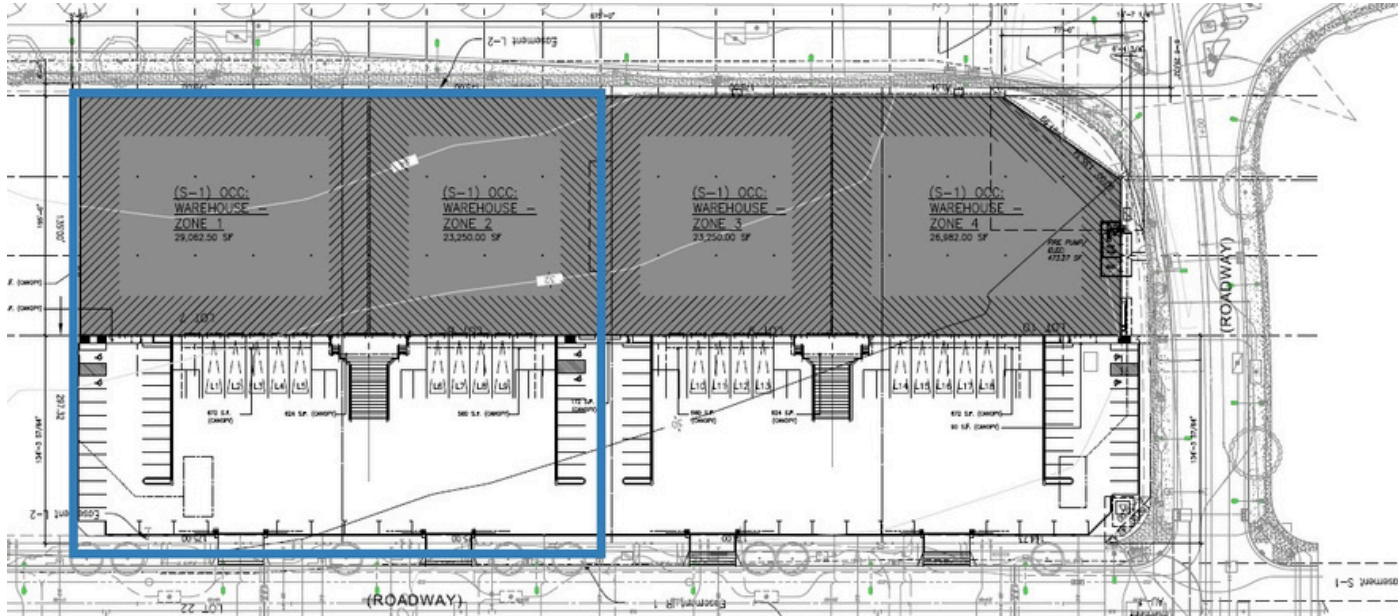

# For Sublease

Industrial Warehouse | 52,313 RSF Available

# Property Overview



## Property Features

- Brand new construction (2025)
- 40 parking stalls
- (2) 14' x 14' drive in doors
- (9) 10' x 12' elevated dock doors w/ levelers
- ESFR fire sprinkler system
- Large exclusive yard and truck parking area
- Premium location in growing Kapolei Harborside Industrial Park
- Term: through 6/30/2034

# 9/2

Loading Docks/Drive Ins

# 32'

Clear Height

<b>Address</b>	1001 Ko'oloa'ula Street Kapolei, Hawaii 96707
<b>TMK</b>	9-1-0014:042 Lots 7, 8, 9 & 10
<b>Zoning</b>	I-2
<b>Available SF</b>	52,313
<b>Base Rent</b>	\$1.75/sft/mo
<b>CAM</b>	\$0.25/sft/mo



# Property Photos





# Property Photos



# Thank you

## About JLL

For over 200 years, JLL (NYSE: JLL), a leading global commercial real estate and investment management company, has helped clients buy, build, occupy, manage and invest in a variety of commercial, industrial, hotel, residential and retail properties. A Fortune 500® company with annual revenue of \$20.9 billion and operations in over 80 countries around the world, our more than 103,000 employees bring the power of a global platform combined with local expertise. Driven by our purpose to shape the future of real estate for a better world, we help our clients, people and communities SEE A BRIGHTER WAY<sup>SM</sup>. JLL is the brand name, and a registered trademark, of Jones Lang LaSalle Incorporated. For further information, visit [jll.com](https://jll.com).

For more information, please contact:

### **Cullen S. Oesterly (S) CCIM**

Vice President, Industrial Brokerage

Lead

[cullen.oesterly@jll.com](mailto:cullen.oesterly@jll.com)

+1.808.203.5710

[jll.com](https://jll.com)