

**AVAILABLE FOR SUBLEASE: MOVE-IN READY OFFICE**

**10664 FOREST HILL BLVD**

**4,400 SF**

**WELLINGTON, FL 33414**



**CUSHMAN &  
WAKEFIELD**

# PROPERTY HIGHLIGHTS

- Located in Publix anchored center at Wellington Green Square
- Move-in ready
- Ideal for financial services, brokerage, or sales office
- Fully Furnished Office with Large Reception area
- Conference room that can seat 15-20+
- 5 Large Offices with Desks and 65" TVs
- Rear conference room/training room that can fit 20+ people
- Workstation area with 20 seats
- 2 interior discussion pods
- Large Breakroom
- Private Restrooms
- Ample surface parking
- Other tenants include: Douglas Elliman, Carmela Coffee, and Sicilian Oven
- Lease Rate: Call for Pricing
- Sublease Term through 2033

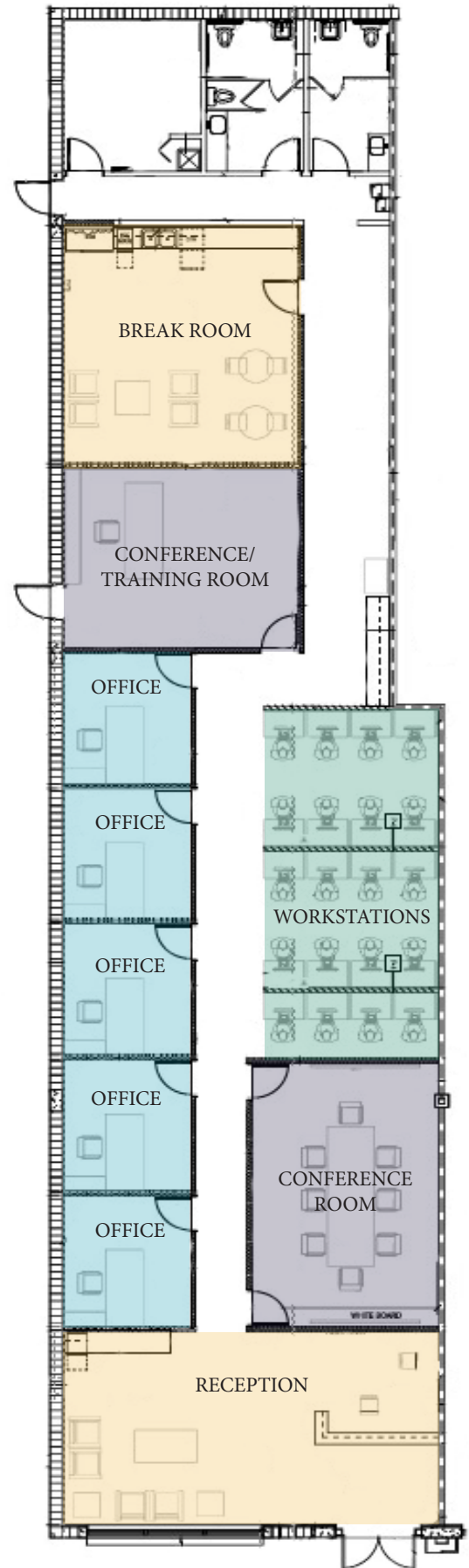



# PROPERTY PHOTOS





# LOCATION OVERVIEW

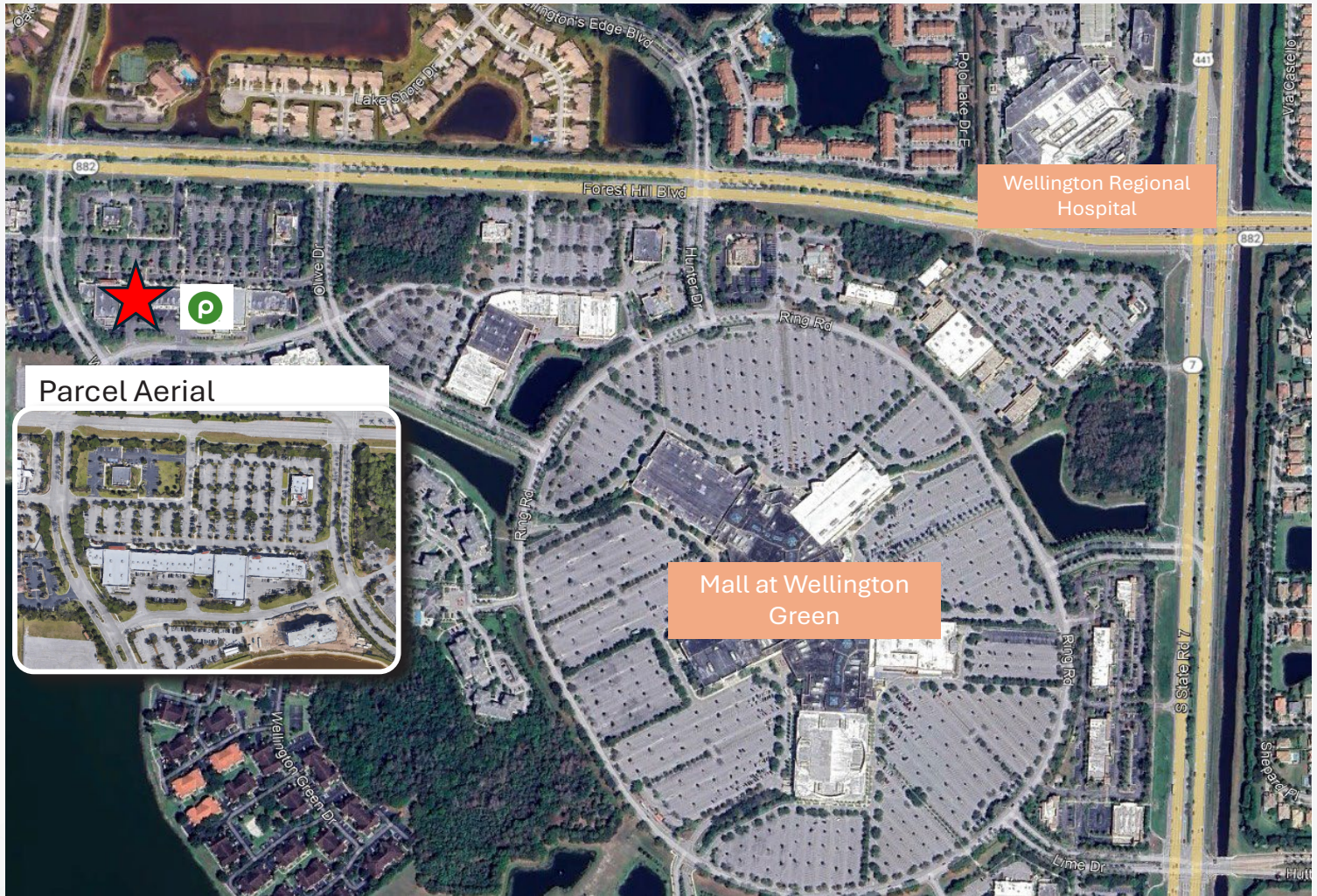

FOR MORE INFORMATION,

## PLEASE CONTACT:

**MICHAEL H. FELDMAN, CCIM**  
Senior Director  
Commercial Brokerage/  
South Florida Healthcare Advisory Practice  
Direct: +1 561 227 2063  
Mobile: +1 561 207 0852  
[michael.feldman@cushwake.com](mailto:michael.feldman@cushwake.com)

**Office Address:**  
3801 PGA Blvd., Suite 104  
Palm Beach Gardens  
Florida 33410 | USA  
[cushmanwakefield.com](http://cushmanwakefield.com)

©2025 Cushman & Wakefield. All rights reserved. The information contained in this communication is strictly confidential. This information has been obtained from sources believed to be reliable but has not been verified. No warranty or representation, express or implied, is made as to the condition of the property (or properties) referenced herein or as to the accuracy or completeness of the information contained herein, and same is submitted subject to errors, omissions, change of price, rental or other conditions, withdrawal without notice, and to any special listing conditions imposed by the property owner(s). Any projections, opinions or estimates are subject to uncertainty and do not signify current or future property performance.