



1506 – 1516 INDUSTRIAL PARK DR.

MAYSVILLE, KY 41056

AVAILABLE FOR SUBLEASE

Rod MacEachen
(513) 675-5764
Rod@SqFtCommercial.com

Roddy MacEachen, SIOR
(513) 739-3985
Roddy@SqFtCommercial.com

Jared Wagoner, SIOR
(812) 890-1768
Jared@SqFtCommercial.com

Amy Castaneda
(503) 310-9768
Amy@SqFtCommercial.com

Sarah Kern
(513) 426-4864
Sarah@SqFtCommercial.com

© 2024 SqFt Commercial LLC. All rights reserved. No warranty or representation, express or implied, is made to the accuracy or completeness of the information contained herein, and same is submitted subject to errors, omissions, change of price, rental or other conditions, withdrawal without notice, and to any special listing conditions imposed by the property owner(s). As applicable, we make no representation as to the condition of the property (or properties) in question. This information has been obtained from sources believed reliable, but has not been verified for accuracy or completeness. You should conduct a careful, independent investigation of the property and verify all information. Any reliance on this information is solely at your own risk. SqFt Commercial and the SqFt Commercial logo are service marks of SqFt Commercial, Inc. All other marks displayed on this document are the property of their respective owners. Photos herein are the property of their respective owners. Use of these images without the express written consent of the owner is prohibited.

1506 – 1516 INDUSTRIAL PARK DR.

MAYSVILLE, KY 41056

INFO@SQFTCOMMERCIAL.COM
(513) 843-1600
SQFTCOMMERCIAL.COM



PROPERTY HIGHLIGHTS

15,477 – 72,992 SqFt

- Located in City of Maysville direct access to AA Highway; 1hr to Cincinnati, OH, 90-min to Lexington, KY, 45-min to I-64 & SR-32.
- Spaces available 15,447 – 72,992 SqFt
- Sublease through 2/28/2026, direct deal with landlord (Phoenix Investors) available
- Available for immediate occupancy
- Lease rate: \$2.95/SqFt modified gross + utilities

PROPERTY DETAILS

Total SqFt:	72,992
Warehouse SqFt:	69,992
Office SqFt:	3,000
Clear Height:	21'-29.5'
Year Built:	1993
Type Construction:	Pre-engineered metal & masonry
Lighting:	LED, T-5/T-8's
Column Spacing:	25'x50'
Dock door:	Ten (10) - 8.5" x 10'
Drive-in door:	One (1) - 10'x12'
Sprinkler:	100% sprinklered; Dry System
Electrical Service:	3-phase, 200-amps
Heat:	Natural gas
Roof:	Galvanized metal with skylights
Truck court:	Asphalt and concrete +/- 85'-100' depth
Parking Lot:	Approximately 100 spaces (expandable)
Restrooms:	Two (2) sets and One (1) uni-sex
Mason County - Maysville Zoning:	I-1A Light Industrial
Mason County Parcel ID's:	530-0060-0044-00
Link to Google Street View:	https://maps.app.goo.gl/DwYG6mJXmmfjobnc6

1506 - 1516 INDUSTRIAL PARK DR.

MAYSVILLE, KY 41056

INFO@SQFTCOMMERCIAL.COM
(513) 843-1600
SQFTCOMMERCIAL.COM



FLOOR PLAN

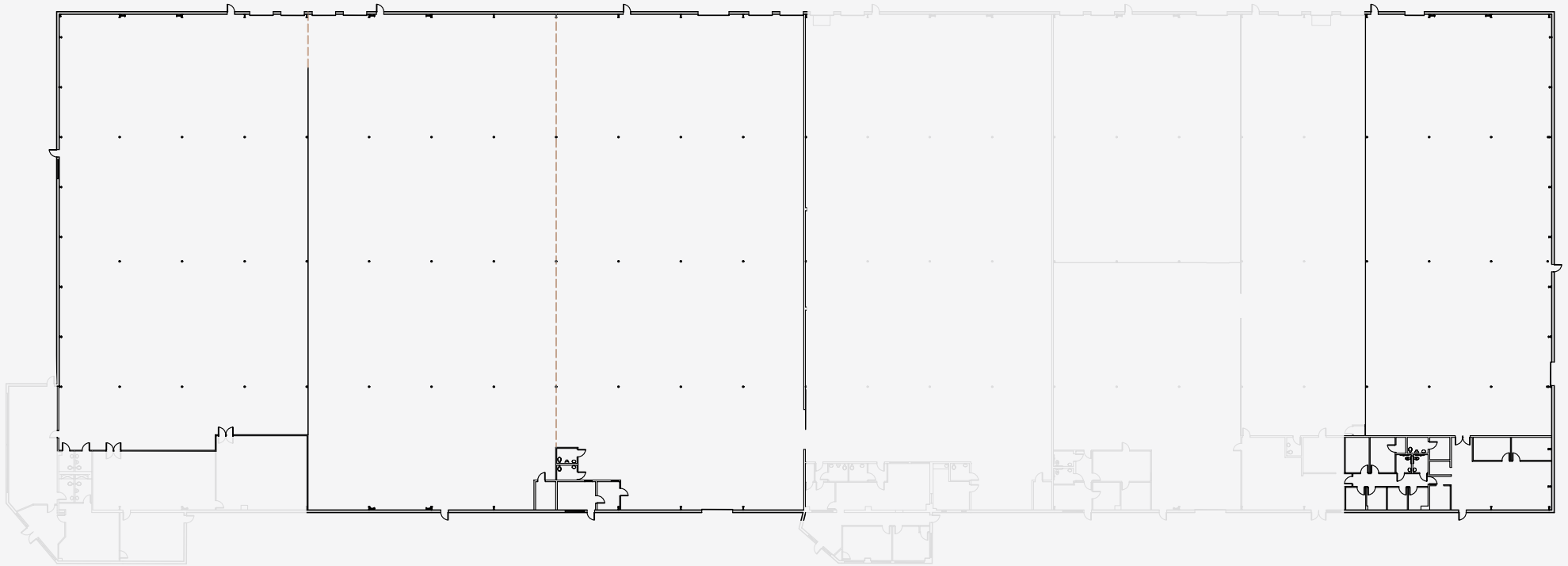

1506 - 1516 INDUSTRIAL PARK DR.

MAYSVILLE, KY 41056

INFO@SQFTCOMMERCIAL.COM

(513) 843-1600

SQFTCOMMERCIAL.COM



DISTANCE MAP

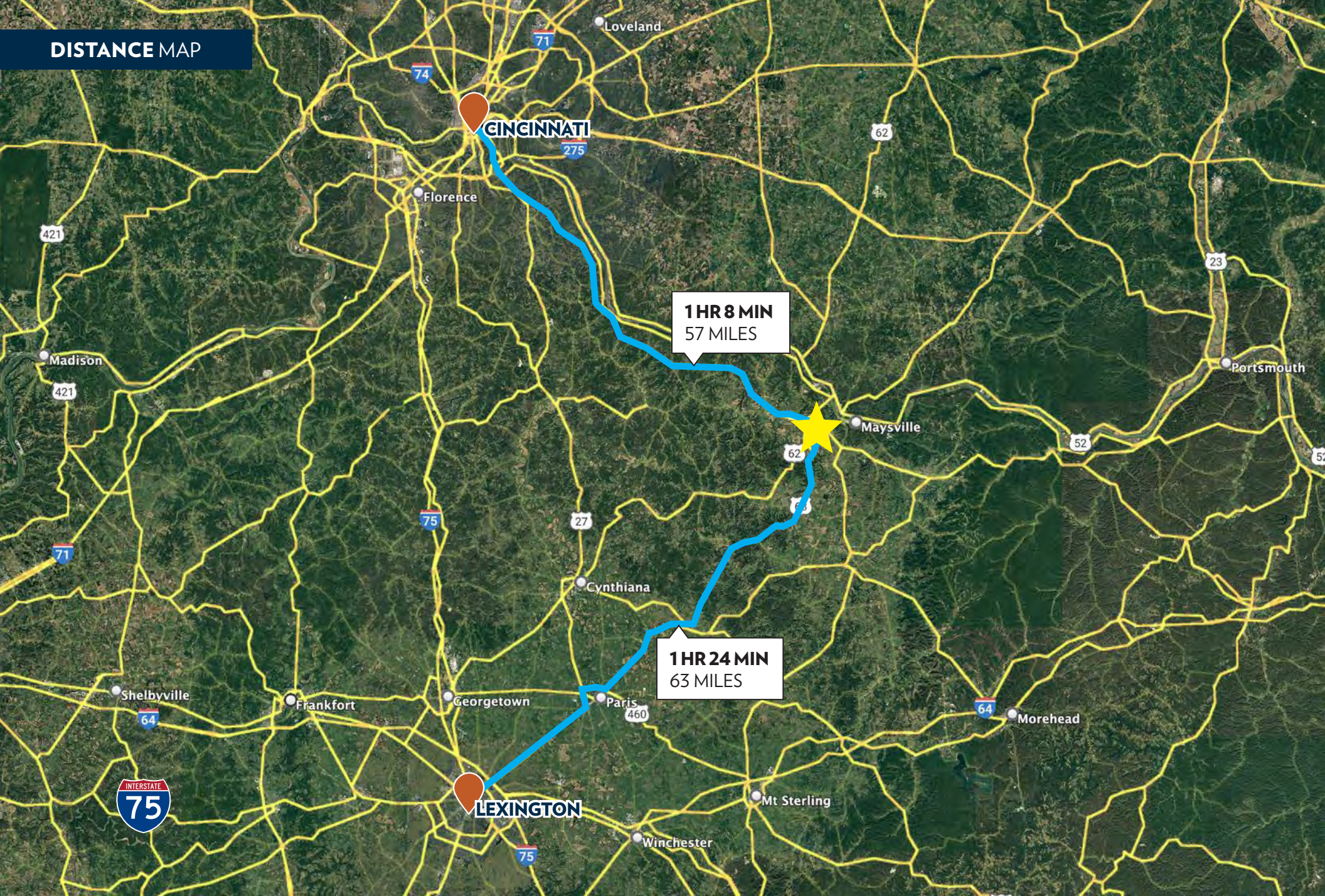

1506 - 1516 INDUSTRIAL PARK DR.

MAYSVILLE, KY 41056

INFO@SQFTCOMMERCIAL.COM
(513) 843-1600
SQFTCOMMERCIAL.COM

