

# FOR LEASE

I-215 & RAINBOW BLVD NWC  
LAS VEGAS, NV 89113

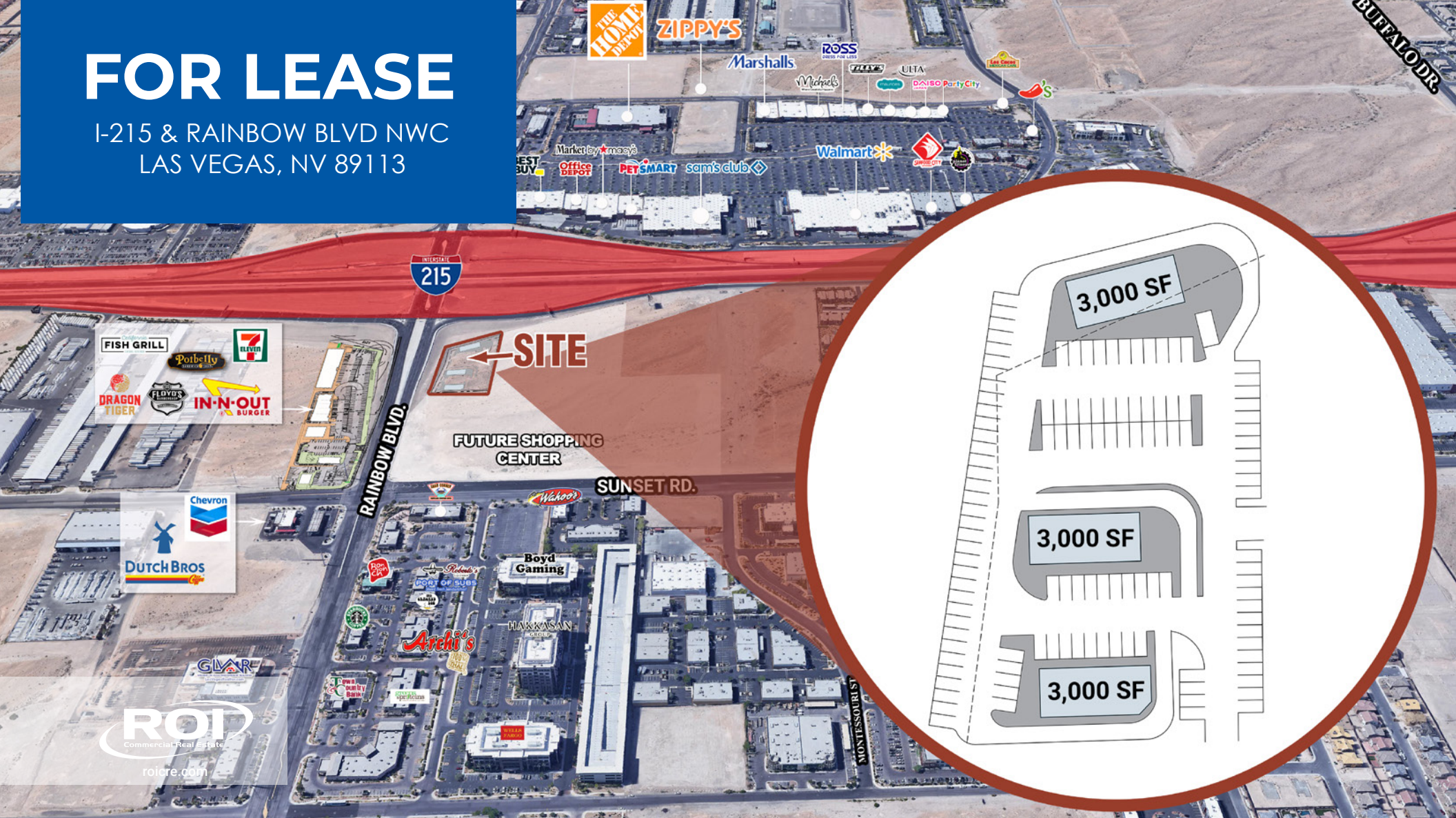

## CONTACT US

### KIT GRASKI

Director

702.570.5377

kgraski@roicre.com

NV License # BS.0015934.LLC

### GEORGE OKINAKA

Executive Vice President

702.570.5376

gokinaka@roicre.com

NV License # S.0045747

### MAUREEN PARCHIA

Vice President

702.570.5124

maureen@roicre.com

NV License # S.0169395

### JONATHAN SERRANO, MBA

Senior Associate

702.570.5099

jonathan@roicre.com

NV License # S.0183243



graski retail team



# PROPERTY HIGHLIGHTS

±3,000 SF Pads Available

We are excited to announce the opportunity to lease a property on the northwest corner of the I-215 Beltway and Rainbow Boulevard in Las Vegas, NV.

- Located next to the I-215 & Rainbow Blvd. Interchange for easy access to the Las Vegas Valley.
- Major traffic generators including: retail, automotive dealerships, restaurants, corporate office headquarters, and many industrial buildings.
- Adjacent to a planned future shopping center development.

 **±1.55 AC**  
LAND AREA

 **CORRIDOR MIXED-USE (CM)**  
ZONING

 **176-03-501-013**  
APN

## NEARBY RETAILERS





# TRADE AREA AERIAL

**RETAIL PADS AVAILABLE**  
I-215 & Rainbow Blvd NWC  
Las Vegas, NV 89113

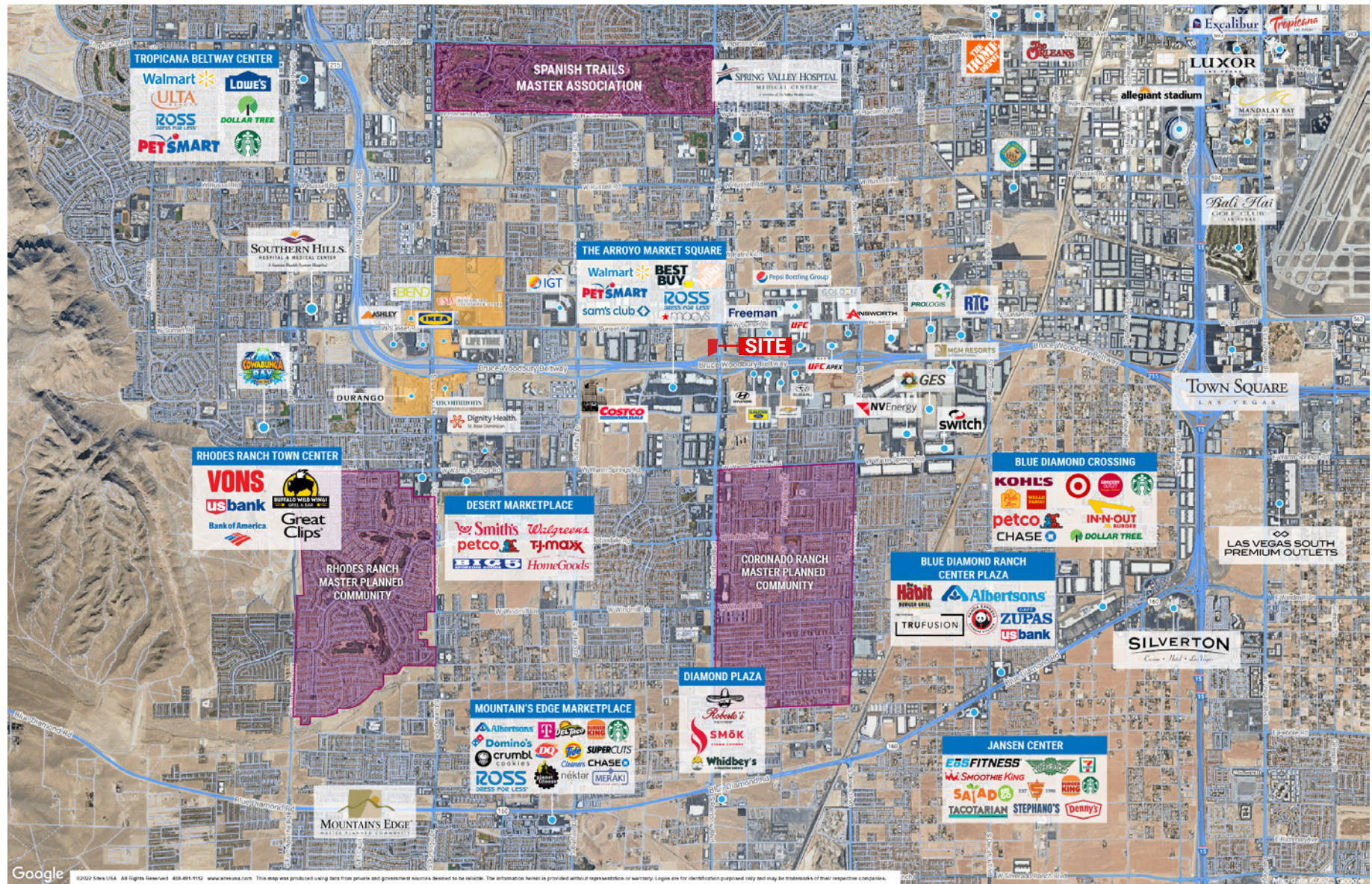

Google

©2022 5th USA. All Rights Reserved. 488-891-1112 www.roicre.com. This map was produced using data from private and government sources deemed to be reliable. The information herein is provided without representation or warranty. Logos are for identification purposes only and may be trademarks of their respective companies.

roicre.com

All information contained herein is from sources we deem reliable, and we have no reason to doubt its accuracy; however, no guarantee or responsibility is assumed thereof, and it shall not form any part of future contracts. Properties are submitted subject to errors and omissions and all information should be carefully verified. \*All measurements quoted herein are approximate





# SITE PLAN

**RETAIL PADS AVAILABLE**  
I-215 & Rainbow Blvd NWC  
Las Vegas, NV 89113

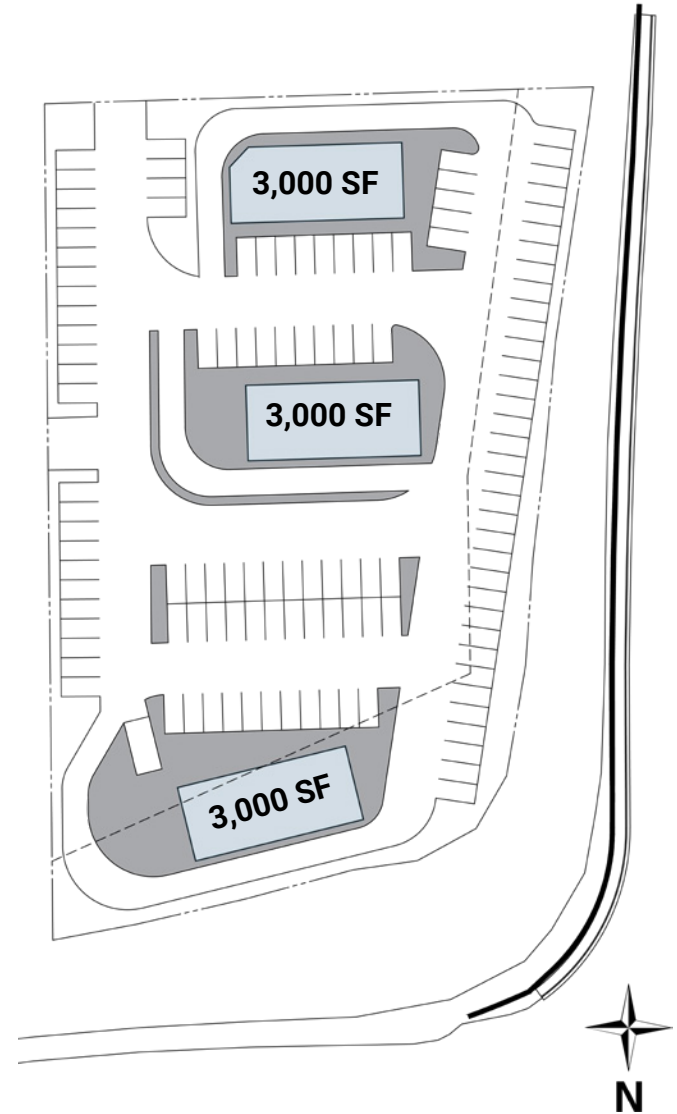
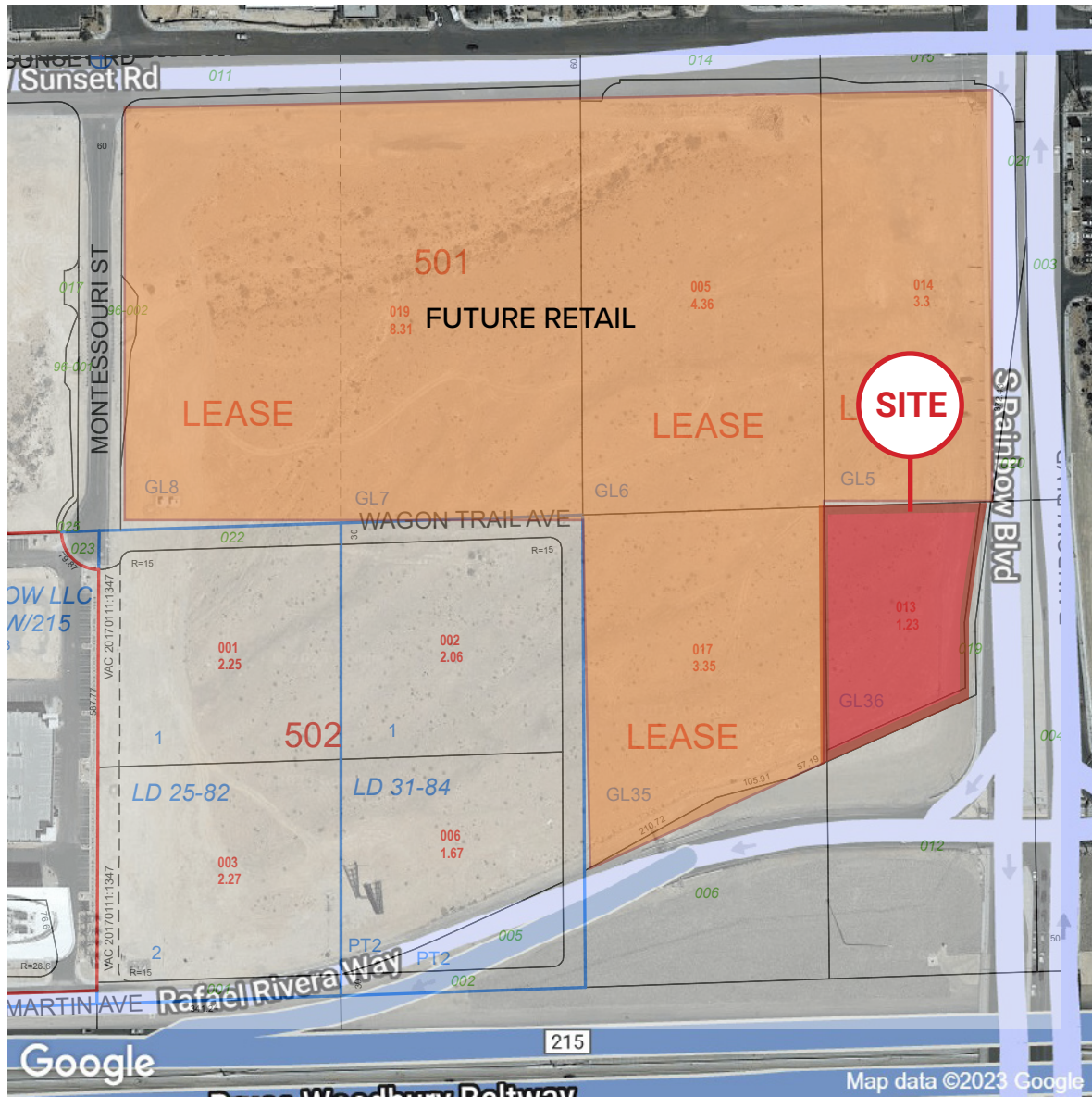

roicre.com

All information contained herein is from sources we deem reliable, and we have no reason to doubt its accuracy; however, no guarantee or responsibility is assumed thereof, and it shall not form any part of future contracts. Properties are submitted subject to errors and omissions and all information should be carefully verified. \*All measurements quoted herein are approximate



# AREA DEMOGRAPHICS



## POPULATION

| 1 MILE | 3 MILES | 5 MILES |
|--------|---------|---------|
| 4,686  | 144,211 | 386,735 |



## AVERAGE HOUSEHOLD INCOME

| 1 MILE    | 3 MILES   | 5 MILES    |
|-----------|-----------|------------|
| \$130,257 | \$113,597 | \$3115,107 |



## DAYTIME POPULATION

| 1 MILE | 3 MILES | 5 MILES |
|--------|---------|---------|
| 12,424 | 63,757  | 166,464 |



## TRAFFIC COUNTS

| S RAINBOW BLVD | US I-215    |
|----------------|-------------|
| 23,300 VPD     | 206,000 VPD |

Source:  
SitesUSA 2025  
TRINA, NV DOT 2024

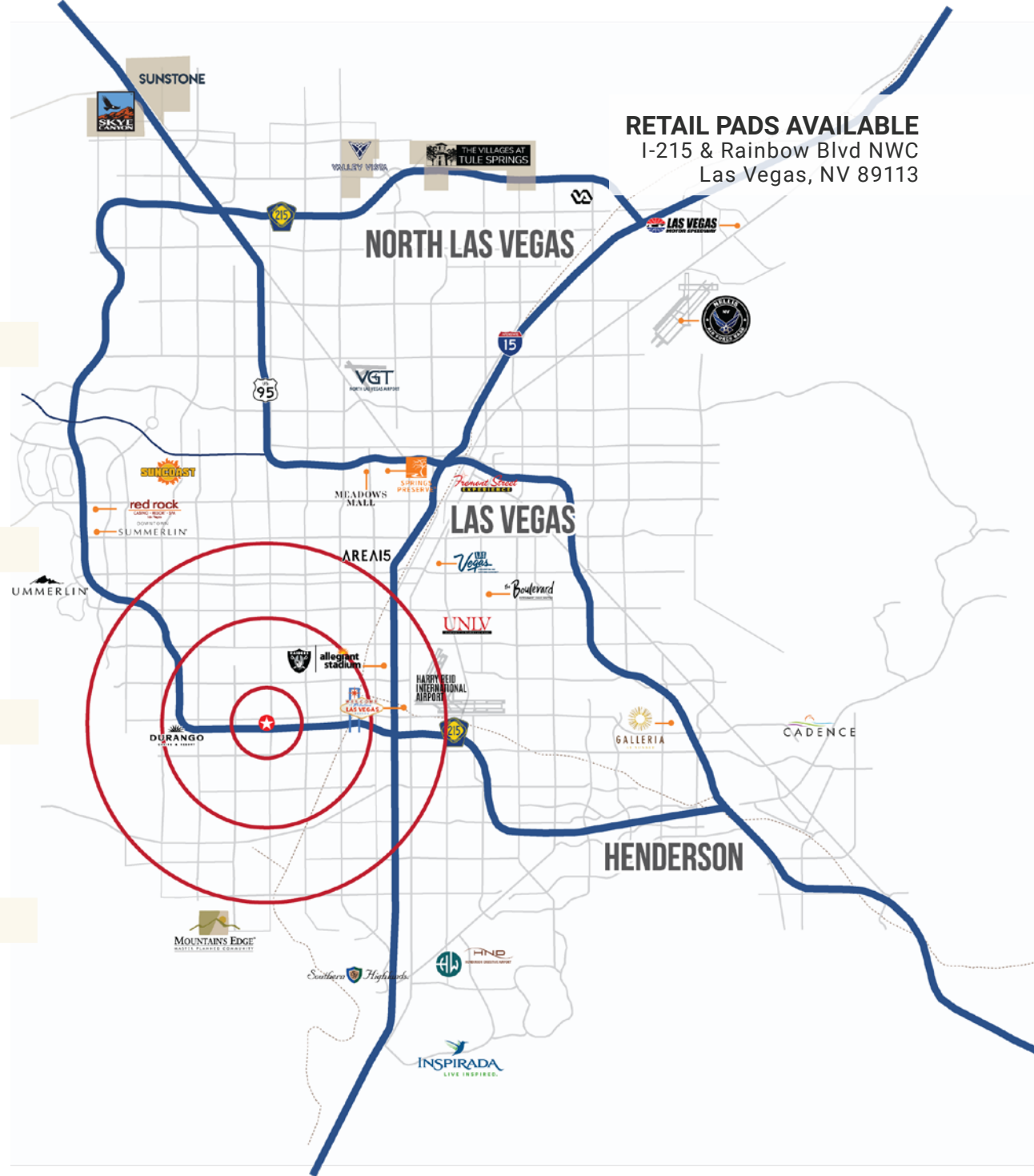

**RETAIL PADS AVAILABLE**  
I-215 & Rainbow Blvd NWC  
Las Vegas, NV 89113

[roicre.com](http://roicre.com)

All information contained herein is from sources we deem reliable, and we have no reason to doubt its accuracy; however, no guarantee or responsibility is assumed thereof, and it shall not form any part of future contracts. Properties are submitted subject to errors and omissions and all information should be carefully verified. \*All measurements quoted herein are approximate

