

# FOR LEASE

## SUN RESEARCH PARK



## SUN RESEARCH PARK

27301-27335 WEST 11 MILE ROAD, SOUTHFIELD, MI  
48034

### PROPERTY FEATURES:

- New ownership and management
- Premier office and R&D tech center
- 15,878 SF available for immediate occupancy
- Easily divisible with the direct access into the Tenant's space
- 18' floor to deck clear heights
- 10' floor to drop ceiling throughout office
- Floor to ceiling glass windows for maximum natural light throughout.
- Ability to add overhead doors
- Building generators and heavy power available with DTE substation located across the street
- Building façade signage and premium ground monument signage available
- Abundant surface parking with a 4.5/1000 ratio
- Located in the heart of Southfield with easy access to all area freeways (I-696, M-10, and Southfield Fwy)
- Safe and healthy work environment with Covid-19 protocols in place

The information provided herein along with any attachment(s) was obtained from sources believed to be reliable, however, Friedman Real Estate makes no guarantees, warranties, or representations as to the completeness or accuracy of such information and legal counsel is advised. All information provided is subject to verification and no liability for reliance on such information or errors or omissions is assumed. The presentation of this property is submitted subject to errors, omissions, change of price or conditions, prior sale or lease, or withdrawal without notice. Copyright © 2023 Friedman Real Estate. All rights reserved.

## FOR MORE INFORMATION PLEASE CONTACT:



**ROBERT GAGNIUK**  
robert.gagniuik@freg.com



**JORDAN FRIEDMAN**  
jordan.friedman@freg.com

**248.324.2000**

**eCODE 219**

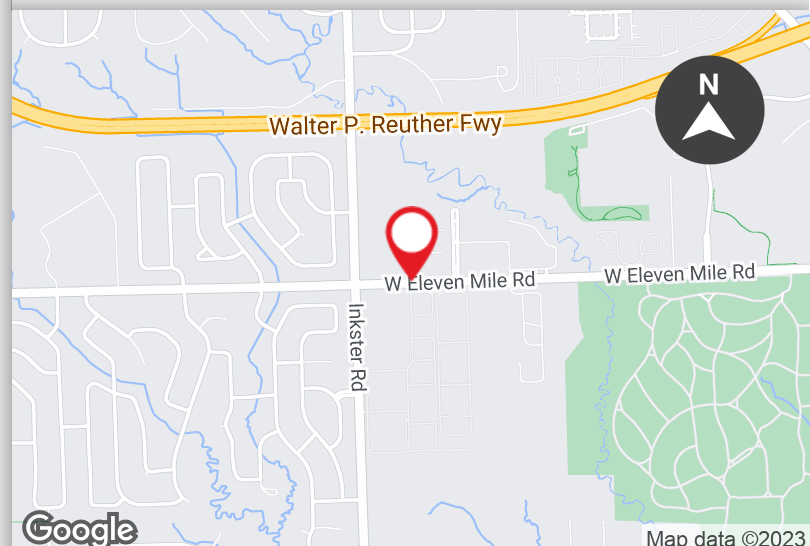



**SUN RESEARCH PARK**  
**AVAILABLE SPACES**



**AVAILABLE SUITES**

SPACE	SPACE USE	LEASE RATE	LEASE TYPE	SIZE (SF)	TERM
27365	Office Building	\$12.50 SF/yr	NNN	15,878 SF	Negotiable



# SUN RESEARCH PARK PROPERTY FLOOR PLAN

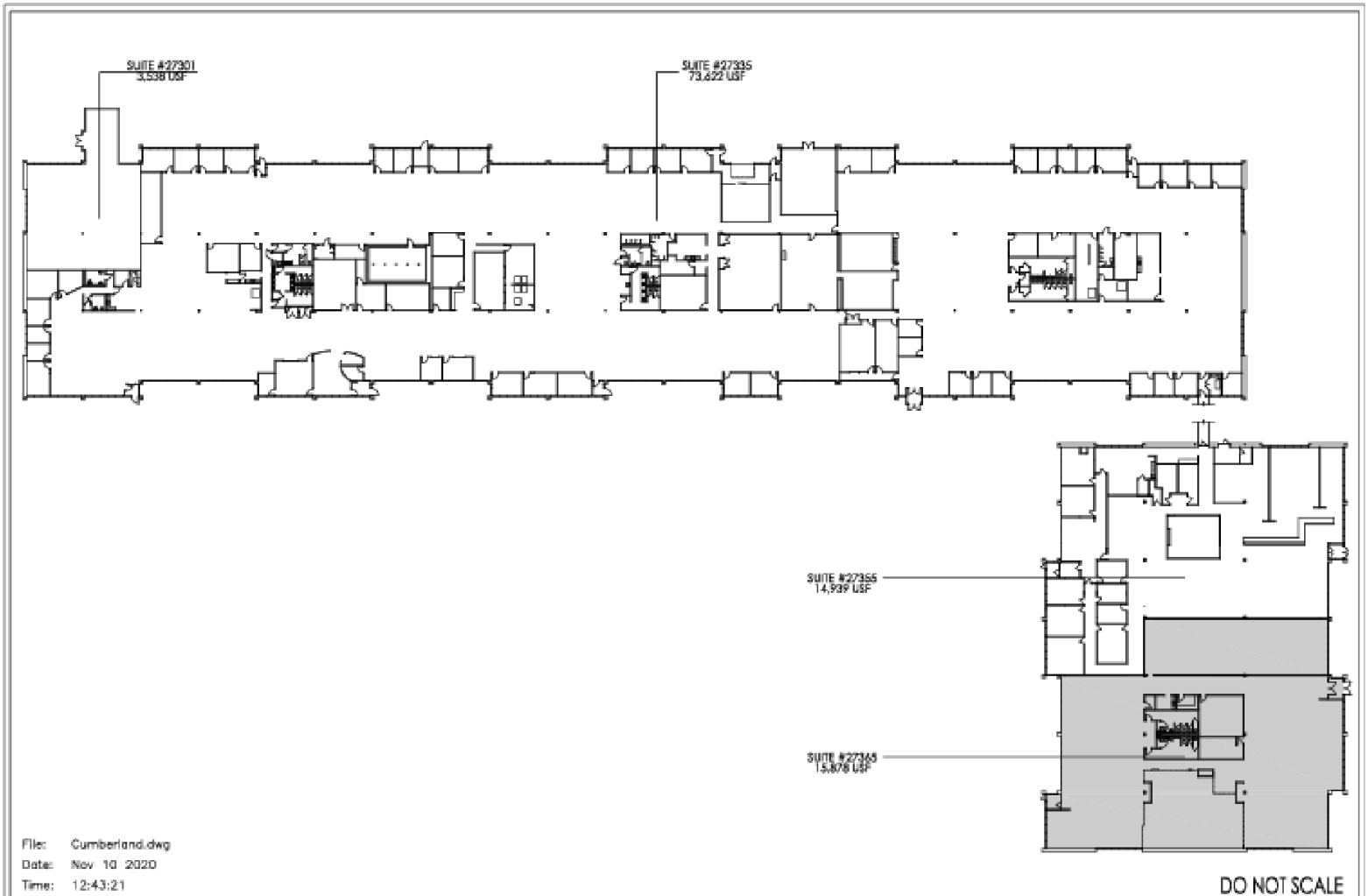

File: Cumberland.dwg  
Date: Nov 10 2020  
Time: 12:43:21