

SHORELINE BUSINESS PARK

INDUSTRIAL SPACE FOR LEASE | 547 E ACCESS STREET | KUNA, ID 83634



Unit has exposure to Access Street.

Highly desirable, centrally located industrial space in Kuna.

Flexible suite layouts.

Directory signage available.

Close proximity to restaurants and services.

NNN expenses include internet services.

| SPACE: | RSF: | RATE: | AVAILABLE: |
|-----------|----------|---------------|--------------|
| Suite 101 | 2,880 SF | \$1.10/SF/Mo. | July 1, 2025 |
| Suite 121 | 1,440 SF | \$1.10/SF/Mo. | July 1, 2025 |

| | | | |
|--------------------|------------|----------------------|--|
| LEASE TYPE: | NNN | CLEAR HEIGHT: | 16' |
| LEASE TERM: | 3-5 Years | DOCK DOORS: | None |
| PARKING: | 2/1,000 | GRADE LEVEL: | 12' x 14' |
| EST. NNN'S: | \$0.29 PSF | POWER: | 100 Amps /220 Volts / 3 Phase Per Bay |

CONTACT

CHRIS PEARSON, SIOR

208.947.0859

chris@tokcommercial.com

MIKE ARNOLD

208.957.5609

mikea@tokcommercial.com

HIGHLIGHTS



DETAILS



UPDATED: 4.1.2025

THIS PROPERTY IS EXCLUSIVELY MARKETING BY TOK BOISE LLC DBA TOK COMMERCIAL
This information was obtained from sources believed reliable but cannot be guaranteed. Any opinions or estimates are used for example only.



AVAILABLE SPACE

| SPACE: | RSF: | RATE: | AVAILABLE: |
|-----------|----------|---------------|--------------|
| Suite 101 | 2,880 SF | \$1.10/SF/Mo. | July 1, 2025 |
| Suite 121 | 1,440 SF | \$1.10/SF/Mo. | July 1, 2025 |

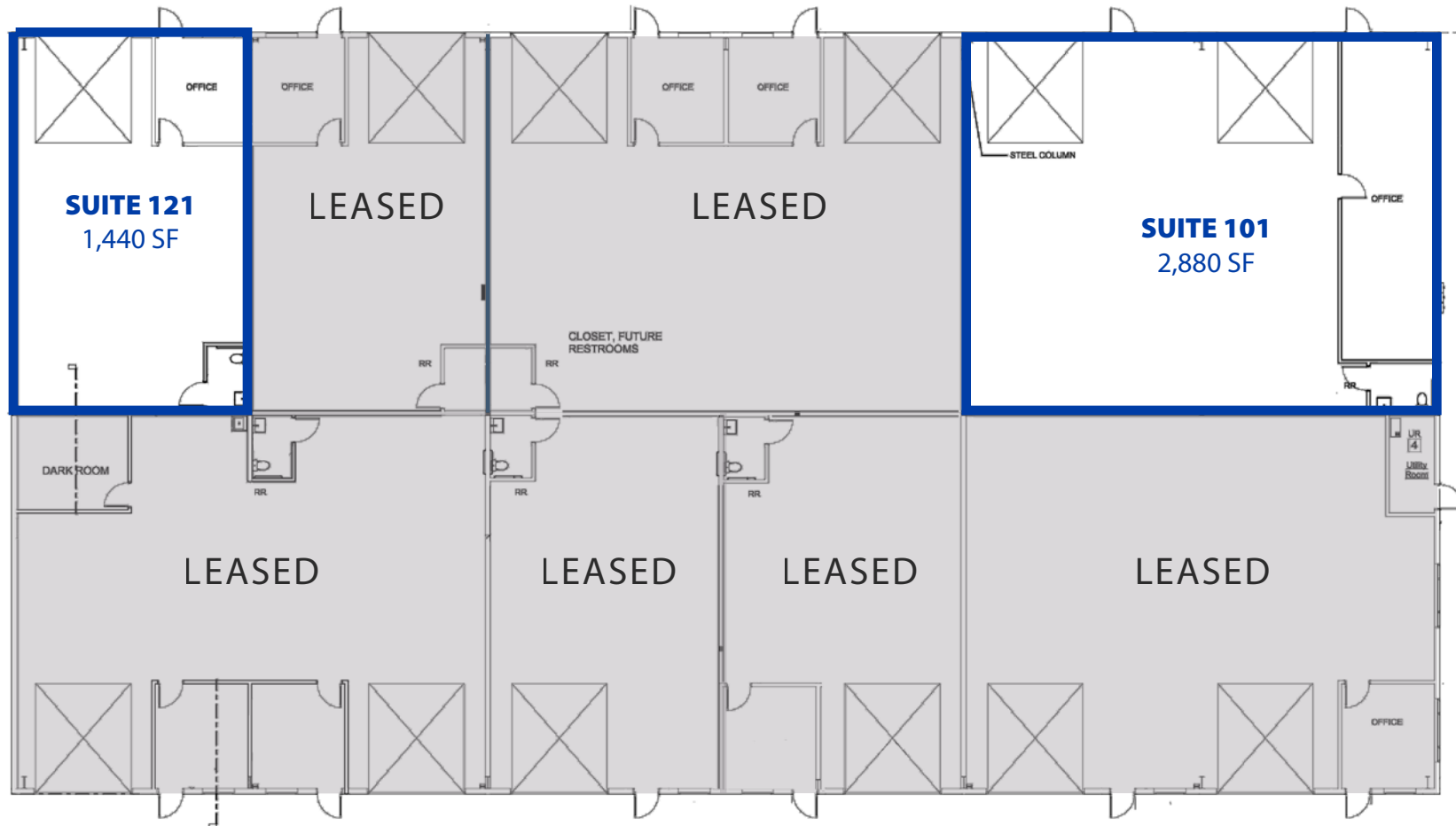

FLOOR PLAN



SITE LOCATOR

UPDATED: 4.1.2025

THIS PROPERTY IS EXCLUSIVELY MARKETING BY TOK BOISE LLC DBA TOK COMMERCIAL
This information was obtained from sources believed reliable but cannot be guaranteed. Any opinions or estimates are used for example only.