

EXECUTIVE SUMMARY

OFFERING SUMMARY

Available SF:	4.65 Acres
Lease Rate:	Negotiable Rate
Lot Size:	4.65 Acres
Available SF (Min - Max):	202554 - 202554
County:	Cumberland
Township / Municipality:	East Pennsboro Township
Zoning:	C-1
Cross Streets:	Wertzville Road and East Penn Drive
Traffic Count - Wertzville Road:	13,137 ADT
Traffic Count 0 E Penn Drive:	6,617 ADT

PROPERTY OVERVIEW

Highly visible 4 ac corner lot across from Pennsboro Commons & East Penn Center Retail Plaza. Close proximity to many residential developments (within 3 miles there are 18,658 Households and a population of 45,744), Central Penn College and Highmark Blue Shield. Zoning allows for restaurants, banks, retail, and more. Located minutes from I-81 corridor.

PROPERTY HIGHLIGHTS

- Highly visible, signalized intersection in East Pennsboro Township
- Approximately 1,000 sq. ft. of road frontage
- Close proximity to I-81



Justin Shoemaker
Executive Vice President
717.731.1990
justin@landmarkcr.com

425 N. 21st Street, Suite 302, Camp Hill, PA 17011

LANDMARKCR.com

747 Wertzville Road

LAND PROPERTY FOR LEASE
747 Wertzville Road Enola, PA 17025

LOTS A & B

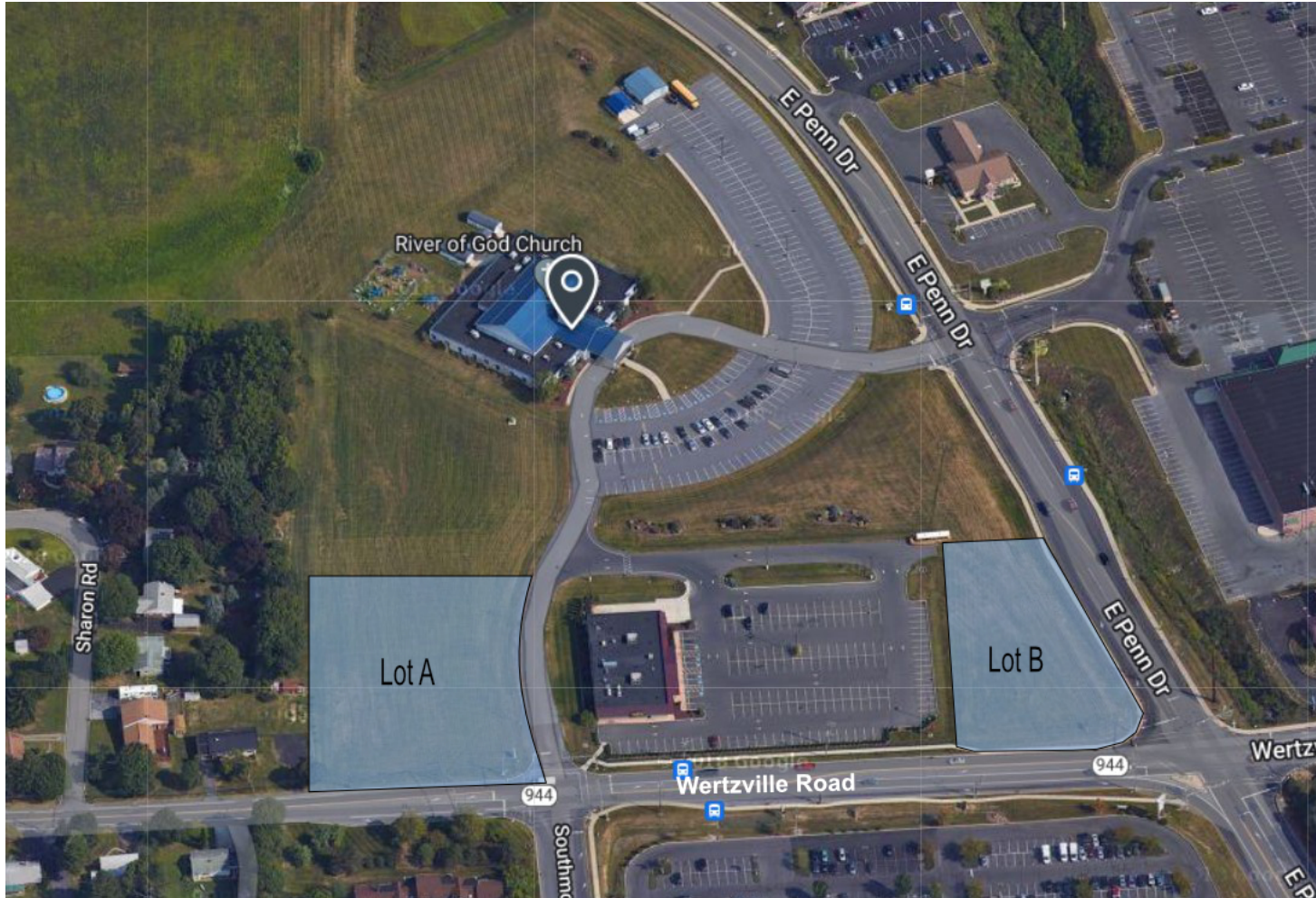

Justin Shoemaker
Executive Vice President
717.731.1990
justin@landmarkcr.com

425 N. 21st Street, Suite 302, Camp Hill, PA 17011

LANDMARKCR.com

747 Wertzville Road

LAND PROPERTY FOR LEASE

747 Wertzville Road Enola, PA 17025

TRADE AERIAL



Justin Shoemaker
Executive Vice President
717.731.1990
justin@landmarkcr.com

425 N. 21st Street, Suite 302, Camp Hill, PA 17011

LANDMARKCR.com

DEMOGRAPHICS MAP & REPORT

POPULATION	1 MILE	3 MILES	5 MILES
Total Population	4,922	45,744	120,590
Average Age	38.4	39.0	39.4
Average Age (Male)	39.1	38.7	37.6
Average Age (Female)	37.5	39.2	40.9

HOUSEHOLDS & INCOME	1 MILE	3 MILES	5 MILES
Total Households	1,946	18,658	52,365
# of Persons per HH	2.5	2.5	2.3
Average HH Income	\$73,885	\$81,490	\$72,697
Average House Value	\$200,316	\$181,071	\$169,534

* Demographic data derived from 2020 ACS - US Census

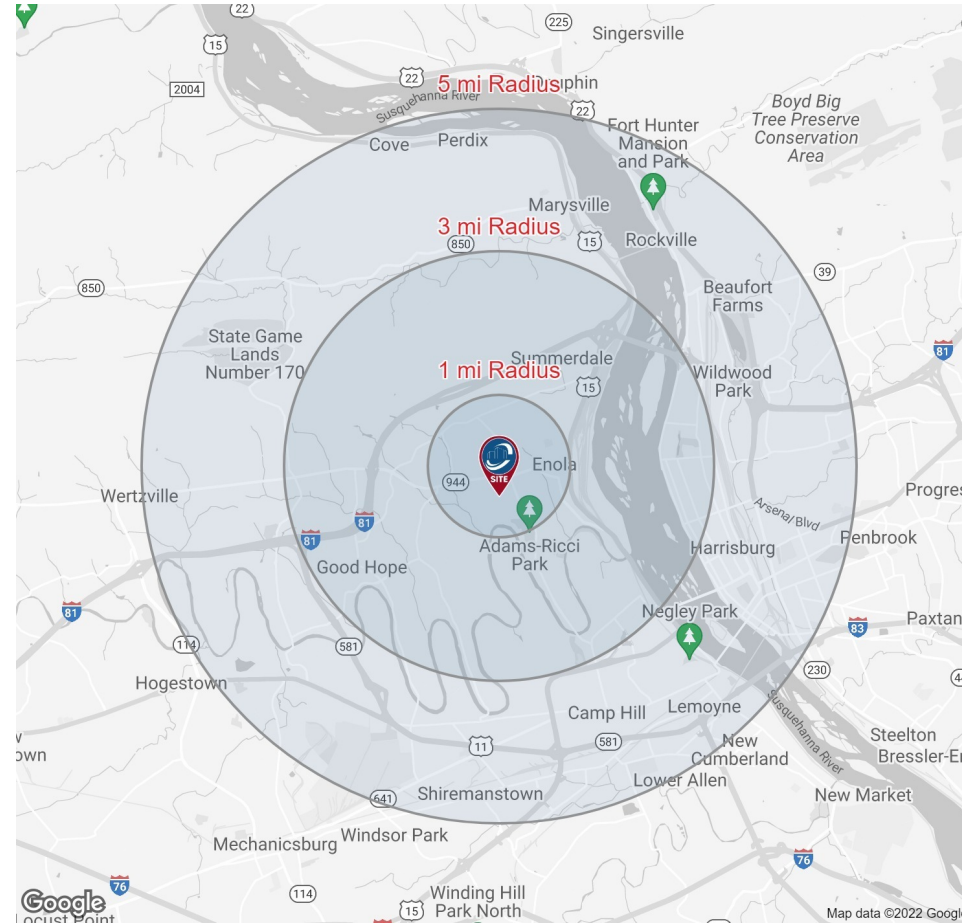

Justin Shoemaker
 Executive Vice President
 717.731.1990
 justin@landmarkcr.com

425 N. 21st Street, Suite 302, Camp Hill, PA 17011