

33200 FISHER DRIVE  
ST. CLAIR SHORES, MICHIGAN

INDUSTRIAL FOR SALE OR LEASE  
75,661 Square Feet Available



**SIGNATURE  
ASSOCIATES**  
KNOW SIGNATURE | KNOW RESULTS



## PROPERTY FEATURES

- 75,661 square foot building
- 15,496 square feet office
- 14' – 21' clear height
- (6) 12x14 grade level doors & (6) truckwells
- 2500/4000 amps, 480/280 volts
- Located on 5.600 acres
- Prime freestanding building
- I-94 frontage
- Additional parking available
- Metal garage on south side of site
- Sale Price: \$4,950,000 (\$68.42/sq. ft.)
- Asking Lease Rate: \$7.50/sf NNN



For more information, please contact:

**JOHN BOYD**  
(248) 948 0102  
jboyd@signatureassociates.com

**PAUL HOGE**  
(248) 948 0103  
paulhoge@signatureassociates.com

**SIGNATURE ASSOCIATES**  
One Towne Square, Suite 1200  
Southfield, MI 48076  
www.signatureassociates.com

# 33200 Fisher Drive – St. Clair Shores, Michigan

## Industrial For Sale or Lease

75,661  
Square Feet  
AVAILABLE

### Site Plan



For more information, please contact:

**JOHN BOYD**  
(248) 948 0102  
jboyd@signatureassociates.com

**PAUL HOGE**  
(248) 948 0103  
paulhoge@signatureassociates.com

**SIGNATURE ASSOCIATES**  
One Towne Square, Suite 1200  
Southfield, MI 48076  
www.signatureassociates.com

# 33200 Fisher Drive – St. Clair Shores, Michigan

## Industrial For Sale or Lease

75,661  
Square Feet  
AVAILABLE

### Floor Plan

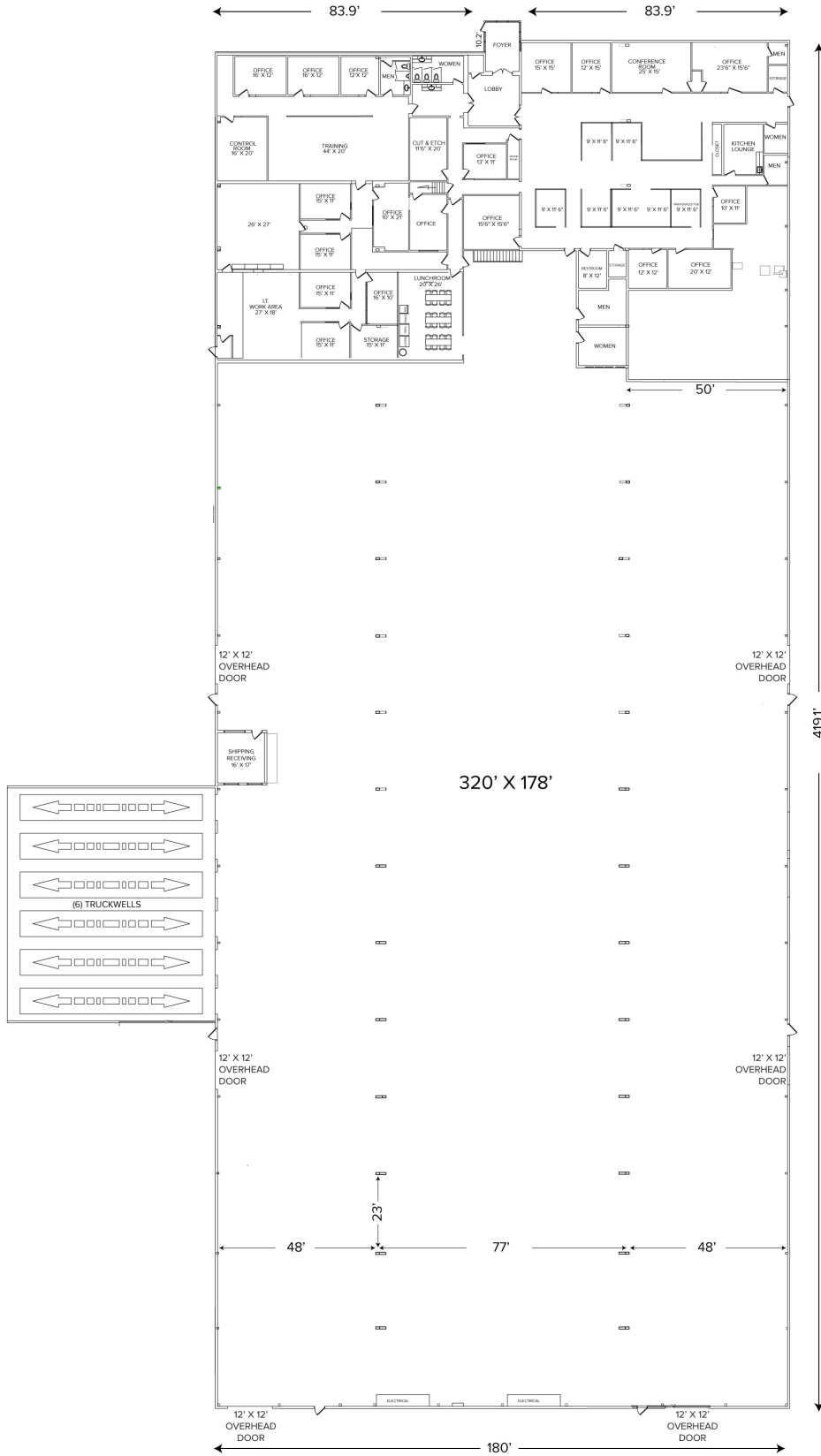

For more information, please contact:

**JOHN BOYD**  
(248) 948 0102  
jboyd@signatureassociates.com

**PAUL HOGE**  
(248) 948 0103  
paulhoge@signatureassociates.com

**SIGNATURE ASSOCIATES**  
One Towne Square, Suite 1200  
Southfield, MI 48076  
www.signatureassociates.com

Information is subject to verification and no liability for errors or omissions is assumed. Price is subject to change and listing withdrawal.

# 33200 Fisher Drive – St. Clair Shores, Michigan

Industrial For Sale or Lease

75,661  
Square Feet  
AVAILABLE

Aerial



For more information, please contact:

**JOHN BOYD**  
(248) 948 0102  
jboyd@signatureassociates.com

**PAUL HOGE**  
(248) 948 0103  
paulhoge@signatureassociates.com

**SIGNATURE ASSOCIATES**  
One Towne Square, Suite 1200  
Southfield, MI 48076  
www.signatureassociates.com