



Executive Office Space for Lease

- First Floor Suites:
 - Suite 102 - ±449 sf
 - Suite 104 - ±225 sf
 - Suite 107 - ±209 sf
- Second Floor Suites:
 - Suite 215 - ±183 sf
 - Suite 216 - ±225.5 sf
- Suite 102 & 107 can be combined to make ±658 sf
- Suite 215 & 216 can be combined to make +408.5 sf
- Medical uses allowed
- Close to amenities
- Property has two parking lots
- Asking rate \$4.75 Full Service



±209 - ±658 square feet



Easy access to El Camino Real



6 offices configurations



Market ready

**Get more
information**

Brian Mason SIOR
1.408.913.6928
brian.mason@avisonyoung.com
License No. 01229363

Site Plan



Get more
information

Brian Mason SIOR
1.408.913.6928
brian.mason@avisonyoung.com
License No. 01229363

Floorplan - First Floor

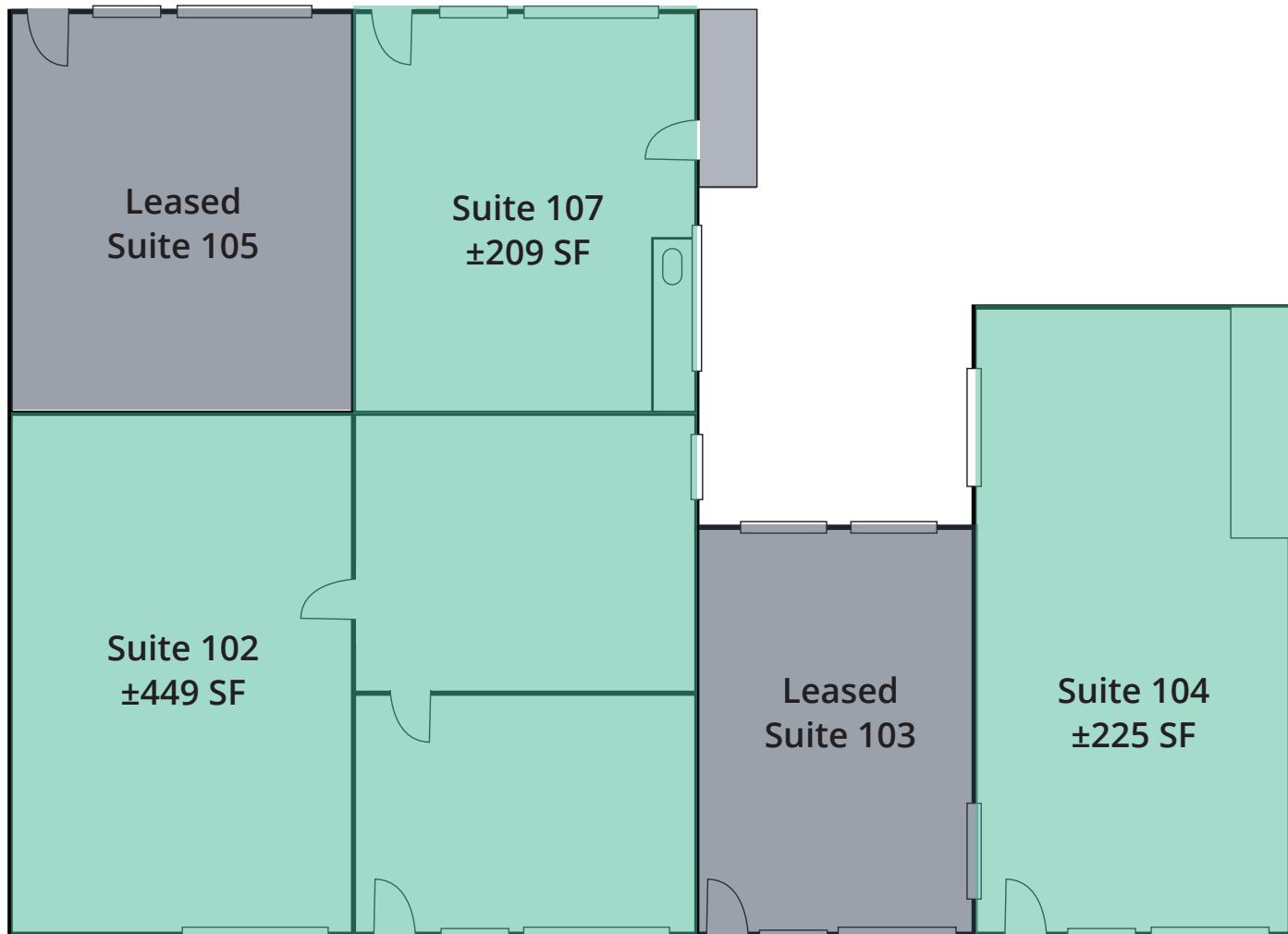

**Get more
information**

Brian Mason SIOR
1.408.913.6928
brian.mason@avisonyoung.com
License No. 01229363

Floorplan - Second Floor

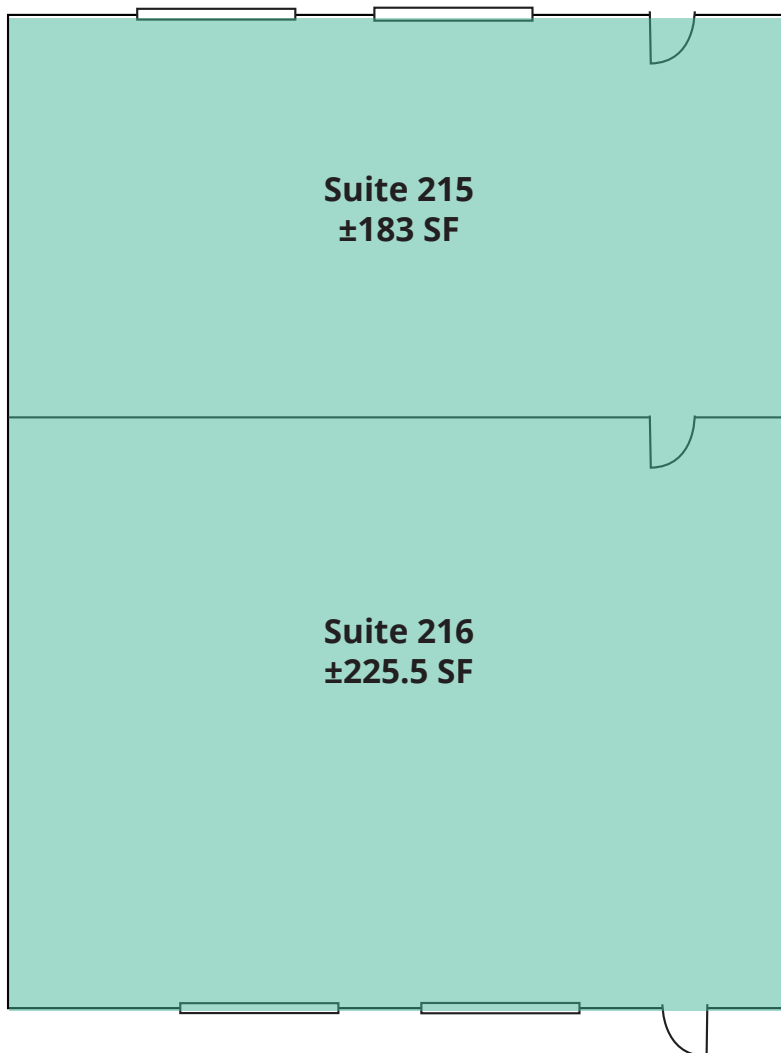

**Get more
information**

Brian Mason SIOR
1.408.913.6928
brian.mason@avisonyoung.com
License No. 01229363

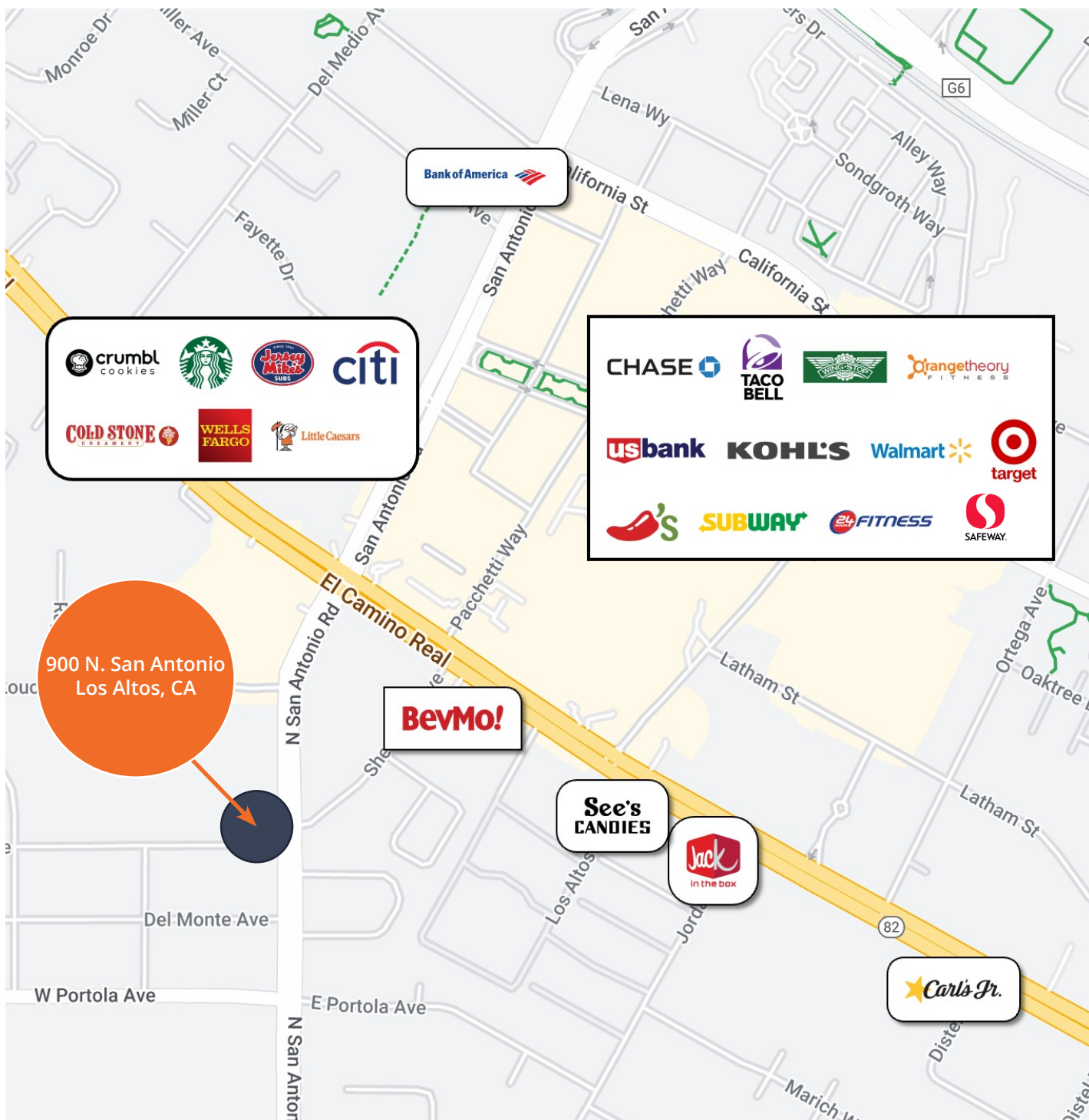

Get more
information

Brian Mason SIOR
1.408.913.6928
brian.mason@avisonyoung.com
License No. 01229363