

Industrial Building with Yard

601 West Truck Bypass
Drumright, OK 74030
www.cbre.com

Property Features

- + 6,000± SF Main Building
 - 1,800± SF Office
 - 4,200± SF Shop
 - 1,000± SF Mezzanine (not included in SF)
- + 15± Total Acres
 - 3.5± Acres Fenced & Gravel Yard
- + 14' Clear Height
- + (2) 14' x 14' Drive-In Doors
- + 30' x 50' Covered Storage
- + 80' x 30' Storage
- + Great for Trucking / Oil & Gas Related Industries
- + 35 Miles to Stillwater; 44 Miles to Tulsa; 76 Miles to OKC

*Source: Owner



601 West Truck Bypass | Drumright, OK 74030

For Sale or Lease

Floor Plan

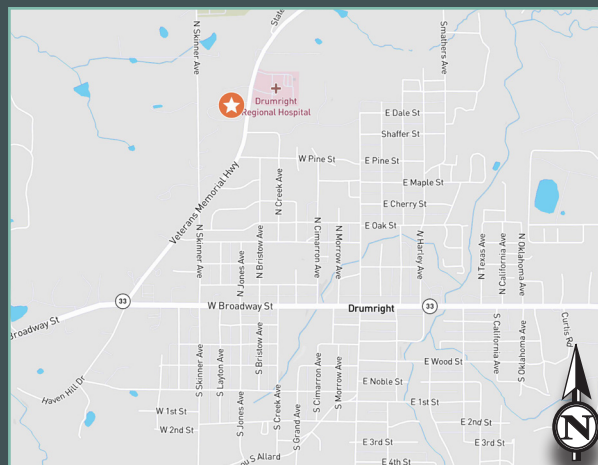
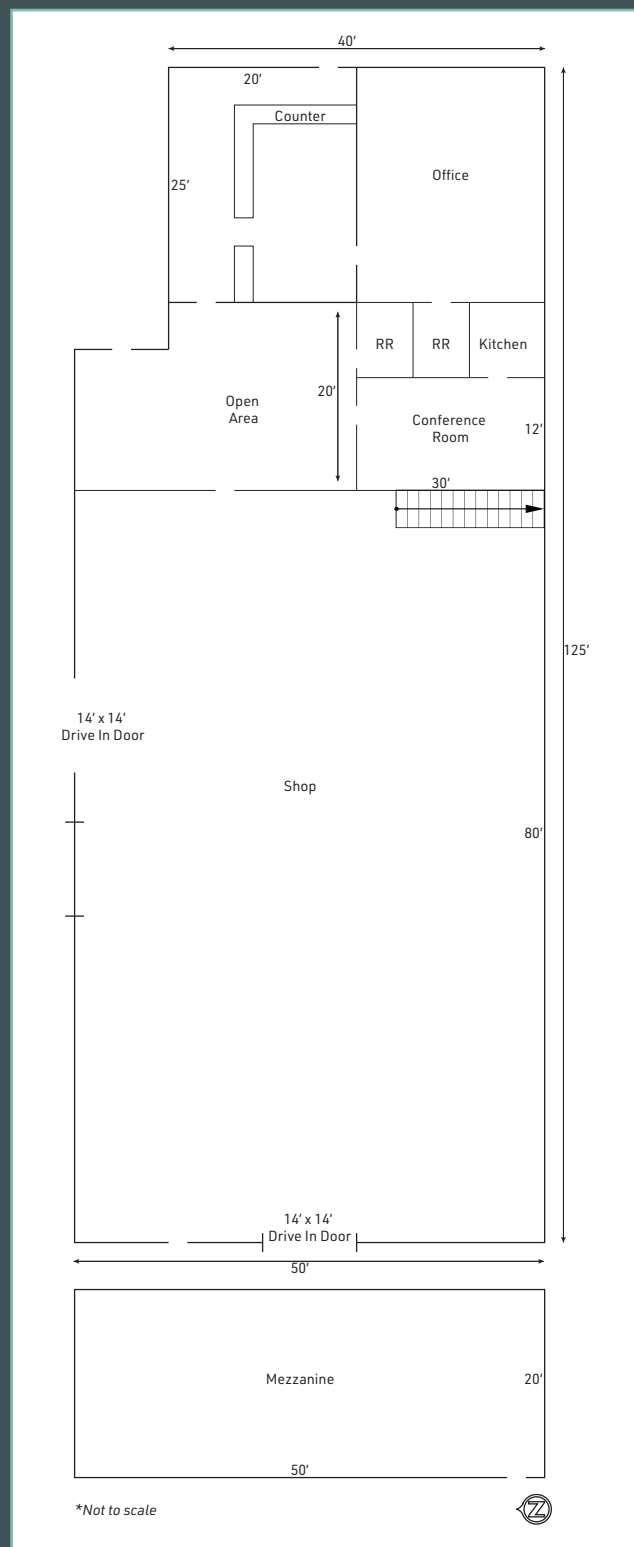

Contact Us

Dwayne Flynn, SIOR, CCIM
Senior Vice President
+1 918 392 7249
dwayne.flynn@cbre.com

Ryan Shaffer, SIOR, CCIM
First Vice President
+1 918 392 7203
ryan.shaffer@cbre.com

© 2026 CBRE, Inc. All rights reserved. This information has been obtained from sources believed reliable, but has not been verified for accuracy or completeness. You should conduct a careful, independent investigation of the property and verify all information. Any reliance on this information is solely at your own risk. CBRE and the CBRE logo are service marks of CBRE, Inc. All other marks displayed on this document are the property of their respective owners, and the use of such logos does not imply any affiliation with or endorsement of CBRE. Photos herein are the property of their respective owners. Use of these images without the express written consent of the owner is prohibited.

www.cbre.com/tulsa

CBRE