

RCR Taylor Logistics Park

201 FM 3349 | Taylor, TX 76574

A Master Planned Rail-Served Logistic & Industrial Park With Dual Rail Service by Union Pacific & BNSF
Taylor, TX (Texas State Highway 79 @ Farm to Market Road 3349)

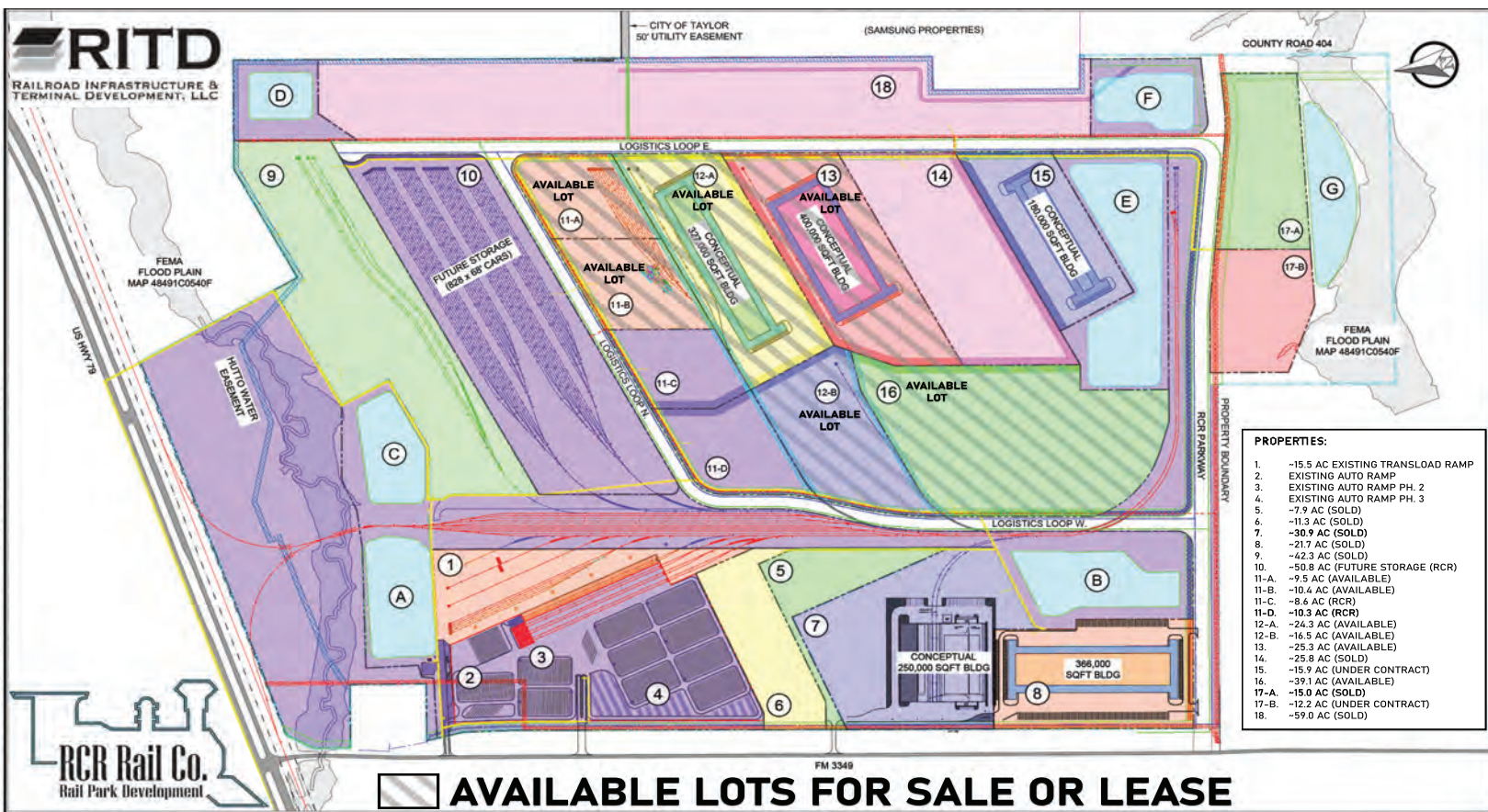

Located between Taylor & Hutto, Texas | Serving the Greater Austin Area

750 AC Rail-Served Industrial Park

Lots Available - 10-30 AC Rail-Served Commercial Sites

Property Features

Land Size

750 AC Park - Lots Available 10-30 AC. Rail Served Commercial Sites.

Location

5 miles from Toll Road 130, 12.5 miles from Round Rock, 35 miles from Austin Central Business District and ideally located between D/FW Metroplex and Mexico

Highway Access

Conveniently located on Texas State Highway 79 for easy access to Toll Road 130 and Interstate 35

Rail service

Union Pacific | www.up.com
BNSF | www.bnsf.com



Building Sizes

Ranging from 50,000 sq ft to 1,000,000+ sq ft

Water Service

City of Taylor

Electrical Service

Provided by Oncor: 20 megawatt with 300 megawatt excess capacity; 138 KVA transmission line within quarter-mile of site

Fiber Optics

Three providers with robust service

Labor

Located near competitively priced labor

Services

Manifest and Unit Train Rail Service, Rail Car Storage, Transloading, Commodity Storage, Rail Car Switching, Auto Ramp, Controlled Park Access & Security



Visit taylor.rcrrailco.com



www.mcalisterassets.com



www.rcrrailco.com

Hydie McAlister

Real Estate | McAlister Assets
713.501.4802 | hydie@mcalisterassets.com