

# FOR SUBLEASE (DIRECT DEAL POSSIBLE)

±1,400 - 2,800 SF AVAILABLE

10802 CAPITAL AVE., STE. 6G/H, GARDEN GROVE



## PROPERTY FEATURES

- ±2,800 Square Foot Industrial Unit (can be divided into two ±1,400 SF units)
- ±16' Minimum Warehouse Clearance (verify)
- Fire Sprinklered
- Two (2) GL Doors (One for each unit)
- Minimum Office
- PUD Zoning (Verify)
- High Identity Location in Excellent Garden Grove Area (Euclid, Hazard are closest cross streets)
- Lease Expiration: 3/31/2026
- Available within 30 Days
- Direct Deal Possible

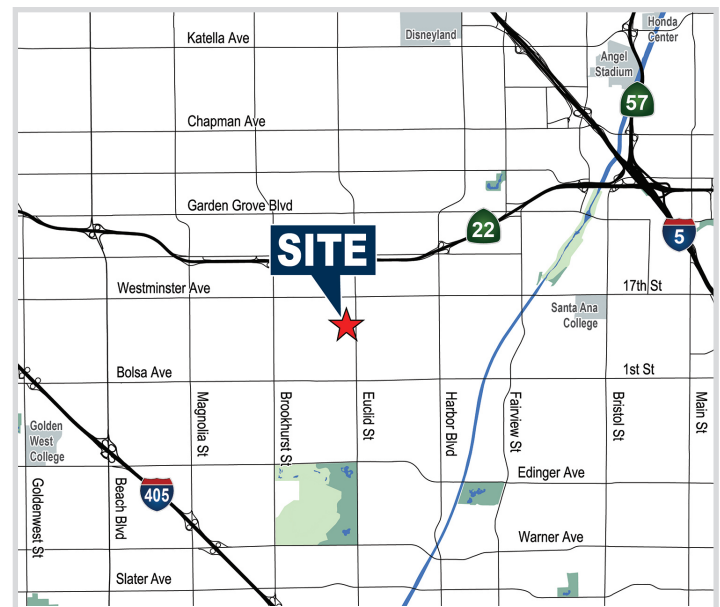

**DYLAN SHERSHENOVICH**

Associate

714.935.2312

dshershenovich@voitco.com

Lic #02151453

**Voit**

REAL ESTATE SERVICES

# FOR SUBLEASE (DIRECT DEAL POSSIBLE)

±1,400 - 2,800 SF AVAILABLE

10802 CAPITAL AVE., STE. 6G/H, GARDEN GROVE

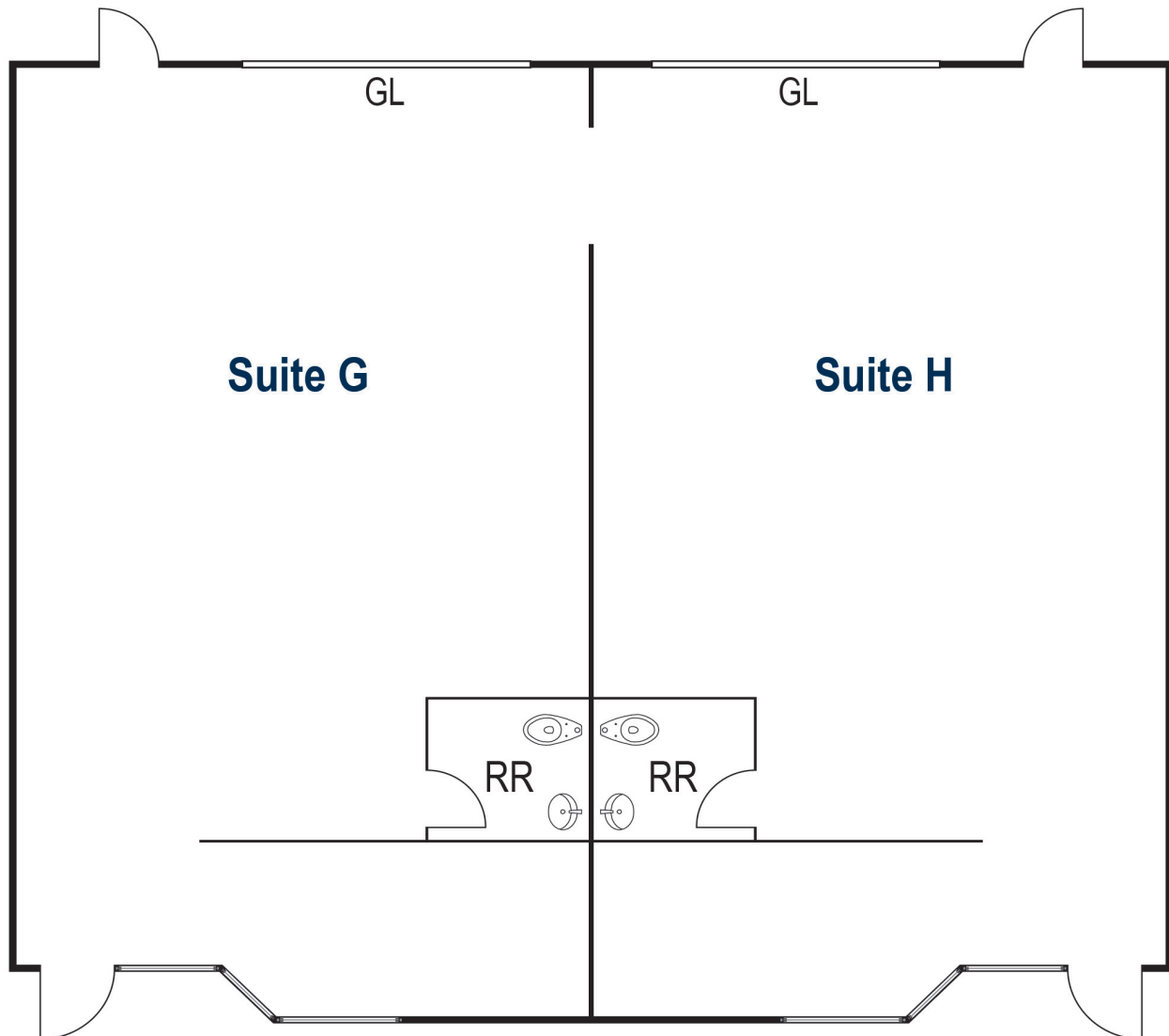

\*Floor plan not to scale



**DYLAN SHERSHENOVICH**  
Associate  
714.935.2312  
dshershenovich@voitco.com  
Lic #02151453

**Voit**  
REAL ESTATE SERVICES