



MIDDLETOWN MARKETPLACE

498 Middletown Warwick Road
Middletown, DE 19709

RETAIL SPACE FOR LEASE



PROPERTY DESCRIPTION

Last space available! Great opportunity to join Food Lion, McDonalds, Chase Bank, Panera Bread and IHOP! Middletown retailers benefit greatly from this location due to the growing economic market as well as the surrounding major retail concentration.

3,300 SF of inline retail space is available situated between Food Lion and IHOP. The Center is in the heart of the markets commercial district with excellent visibility, easy access and high daytime population numbers. The space can be accessed from Middletown Warwick Road and from the signalized entrance to Main Street.

PROPERTY DETAILS

- **Available:** 3,300 SF (30' x 110')
- **Lease Rate:** \$25.00/SF/NNN
- Ample parking
- Highly populated area with excellent demographics
- Great tenant mix: Food Lion, Chase Bank, McDonalds, Panera & IHOP

DEMOGRAPHICS

POLYGON AREA

Population	117,049
Daytime Population	91,713
Average HH Income	\$91,574
Total Households	39,662
Median Age	39.0



For More Information, Contact:

Andy Fox
afox@dsmre.com
302.283.1800 Office
302.229.1304 Cell

Davis Mitchell
dmitchell@dsmre.com
302.283.1800 Office
302.530.2512 Cell

DSM Commercial
Real Estate Services
3304 Old Capitol Trail
Wilmington, DE 19808
dsmre.com

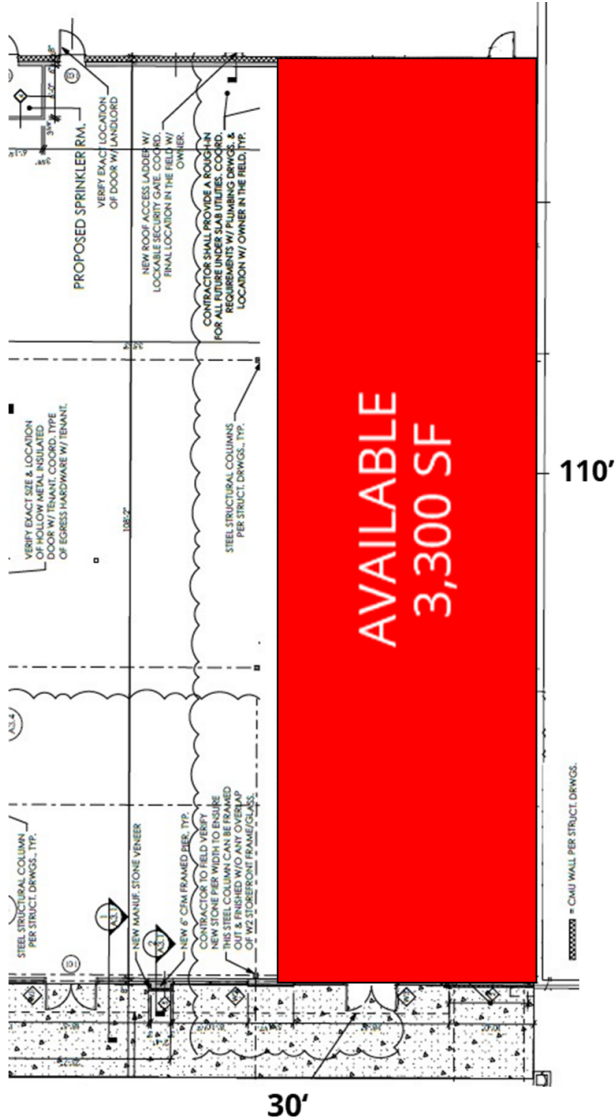

For More Information, Contact:

Andy Fox
afox@dsmre.com
302.283.1800 Office
302.229.1304 Cell

Davis Mitchell
dmitchell@dsmre.com
302.283.1800 Office
302.530.2512 Cell

DSM Commercial
Real Estate Services
3304 Old Capitol Trail
Wilmington, DE 19808
dsmre.com

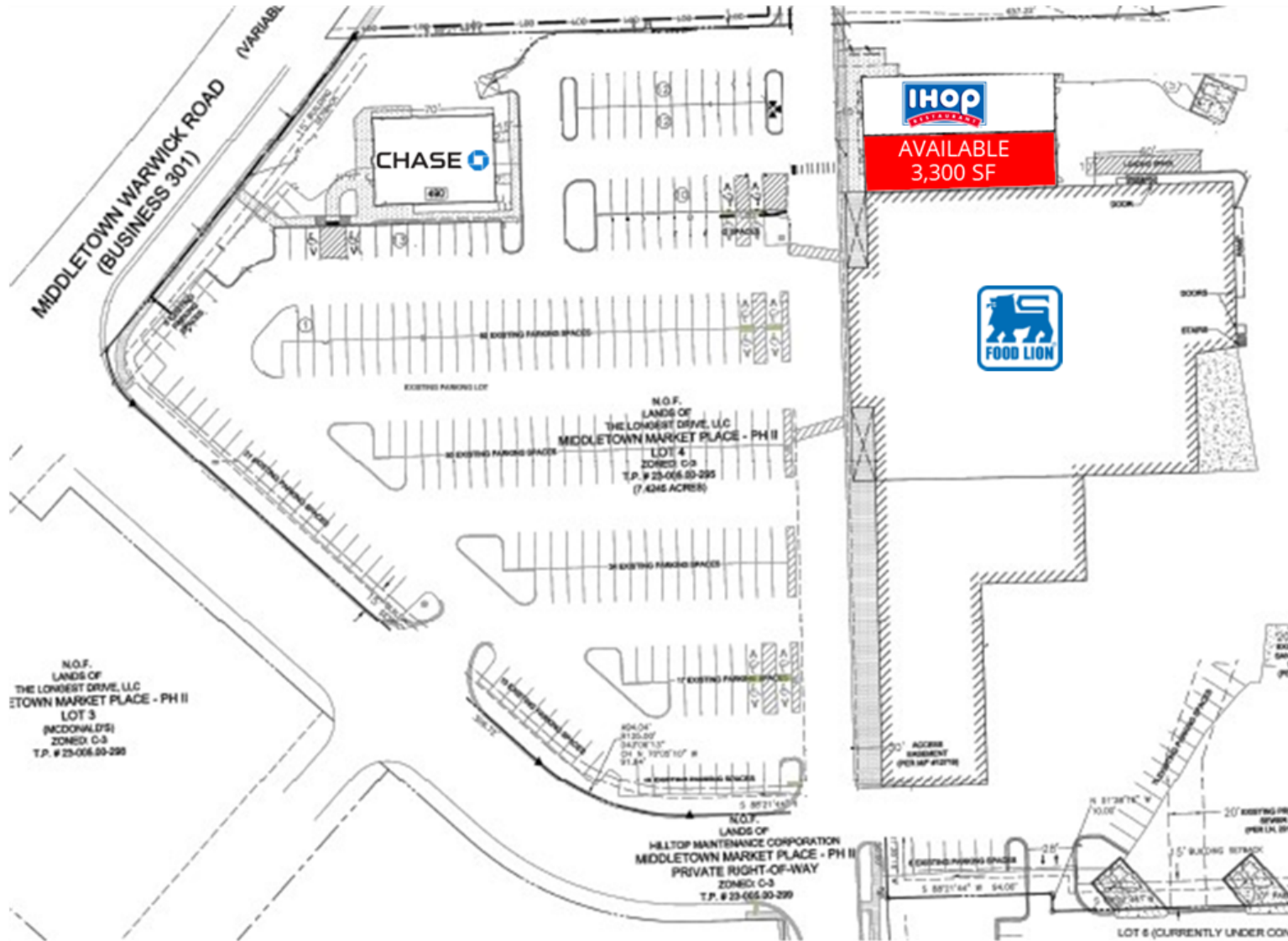

For More Information, Contact:

Andy Fox
afox@dsmre.com
302.283.1800 Office
302.229.1304 Cell

Davis Mitchell
dmitchell@dsmre.com
302.283.1800 Office
302.530.2512 Cell

DSM Commercial
Real Estate Services
3304 Old Capitol Trail
Wilmington, DE 19808
dsmre.com



CHASE

AVAILABLE
3,300 SF
30'x110'

For More Information, Contact:

Andy Fox
afox@dsmre.com
302.283.1800 Office
302.229.1304 Cell

Davis Mitchell
dmitchell@dsmre.com
302.283.1800 Office
302.530.2512 Cell

DSM Commercial
Real Estate Services
3304 Old Capitol Trail
Wilmington, DE 19808
dsmre.com



For More Information, Contact:

Andy Fox
afox@dsmre.com
302.283.1800 Office
302.229.1304 Cell

Davis Mitchell
dmitchell@dsmre.com
302.283.1800 Office
302.530.2512 Cell

DSM Commercial
Real Estate Services
3304 Old Capitol Trail
Wilmington, DE 19808
dsmre.com



MIDDLETOWN MARKETPLACE

498 Middletown Warwick Road
Middletown, DE 19709

RETAIL SPACE FOR LEASE

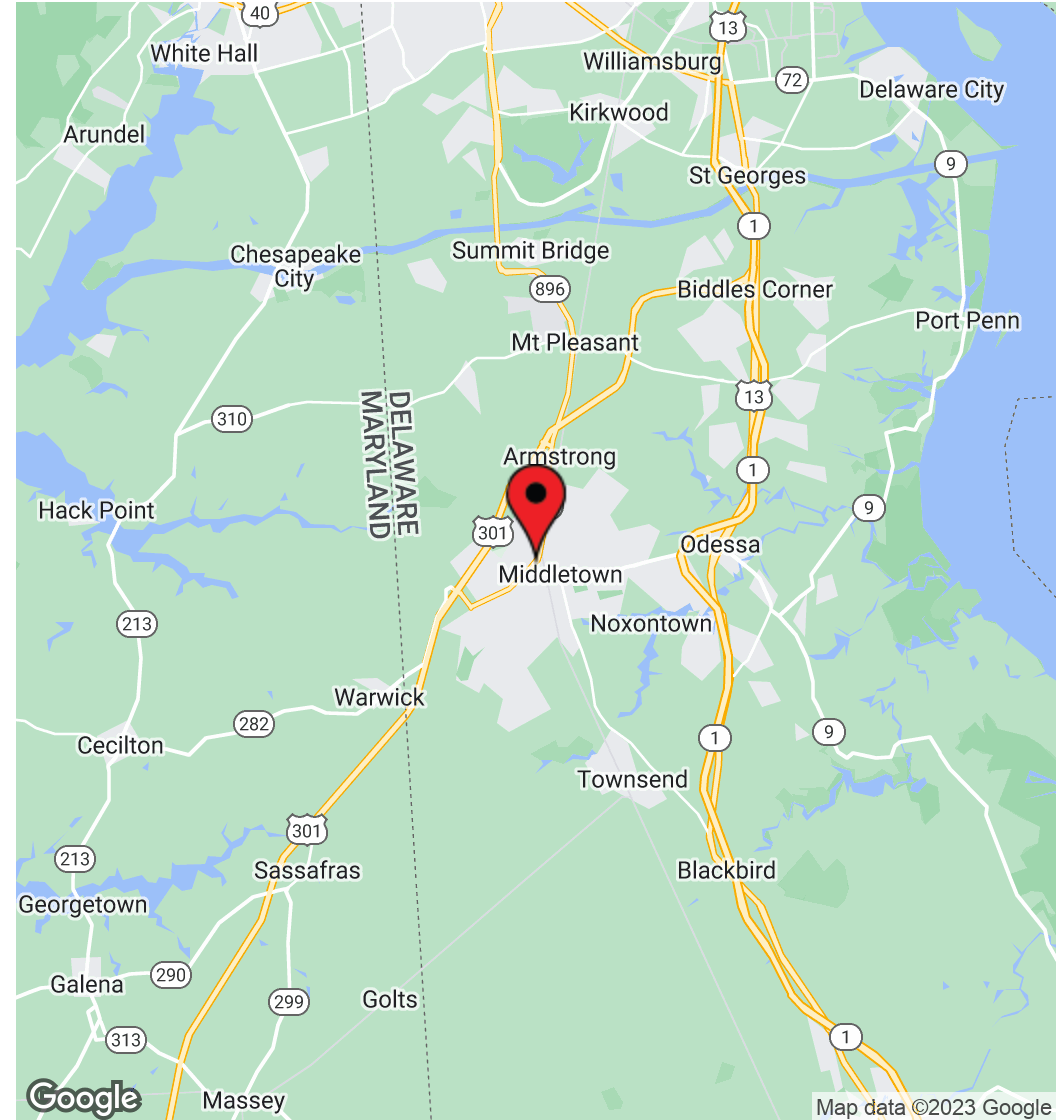
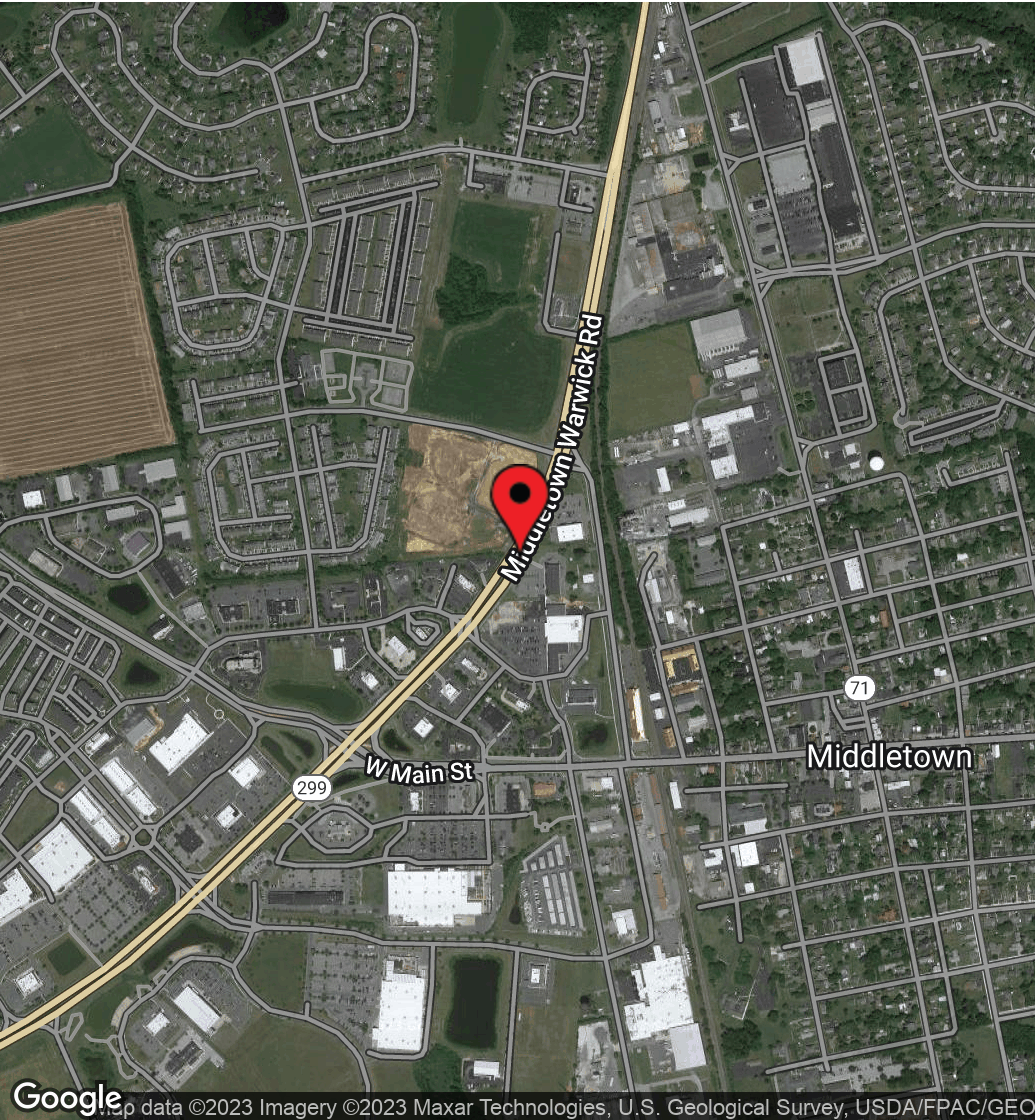

For More Information, Contact:

Andy Fox
afox@dsmre.com
302.283.1800 Office
302.229.1304 Cell

Davis Mitchell
dmitchell@dsmre.com
302.283.1800 Office
302.530.2512 Cell

DSM Commercial
Real Estate Services
3304 Old Capitol Trail
Wilmington, DE 19808
dsmre.com