

# KENTWOOD 303



## FOR SUBLEASE

6075 N Cotton Lane  
± 71,760 - 143,520 SF (divisible)

Sublease goes through September 30, 2032



Jones Lang LaSalle Americas, Inc. License #: CO50857700

## 6075 N COTTON LANE; BUILDING A

- ◆ ±143,520 SF (divisible)
- ◆ Clear height: 28'
- ◆ Building dimensions: 184' x 780'
- ◆ (14) (9' x 10') truck wells
- ◆ (14) (12' x 14') grade level doors
- ◆ 195' fully secured/concrete truck court
- ◆ Auto parking: 1.85/1000
- ◆ Sublease goes through September 30, 2032

## PROPERTY FEATURES

- ◆ EVAP and HVAC cooling in the warehouse
- ◆ Dock equipment in place
- ◆ Roof system: 3-Ply built up
- ◆ Roof insulation: R-30 under deck with scrim
- ◆ Flooring: 6" unreinforced over 4" ABC; 3,000 PSI
- ◆ Power: 3,000 Amps 277/480V
- ◆ LED lighting
- ◆ ESFR sprinkler system; K-25.2
- ◆ Interior walls painted white
- ◆ PAD zoning with industrial/flex overlay, City of Glendale

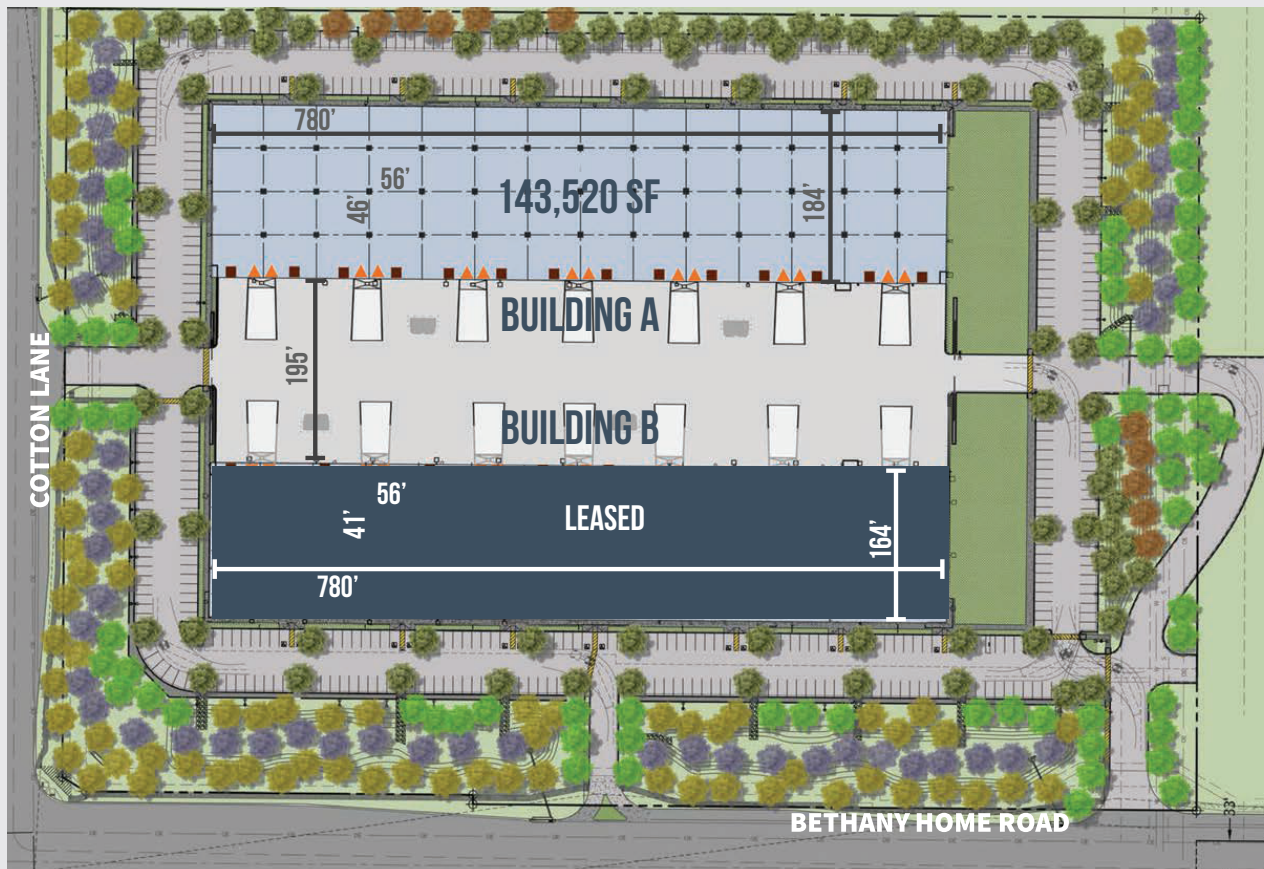

▲ Truck well door

■ Grade level door



## CITY OF GLENDALE

- ◆ Glendale is Arizona's 7th largest city with a population of over 252,000
- ◆ Glendale's Luke Air Force Base is home to F-35 training program, which is the newest jet in the Air Force
- ◆ Glendale is accessible to a workforce of 1.7 million within a 30 minute commute
- ◆ Home to six colleges and universities, including ASU West, Glendale Community College and Midwestern University
- ◆ Glendale's colleges and universities provide an economic impact of \$771 million

## LOCATION FEATURES

- ◆ Accessible via Loop 303 full diamond interchanges at Bethany Home Road and Glendale Avenue
- ◆ ±2 miles south of Northern Parkway
- ◆ ±4 miles north of Interstate 10

## KENTWOOD 303



# FLOOR PLAN

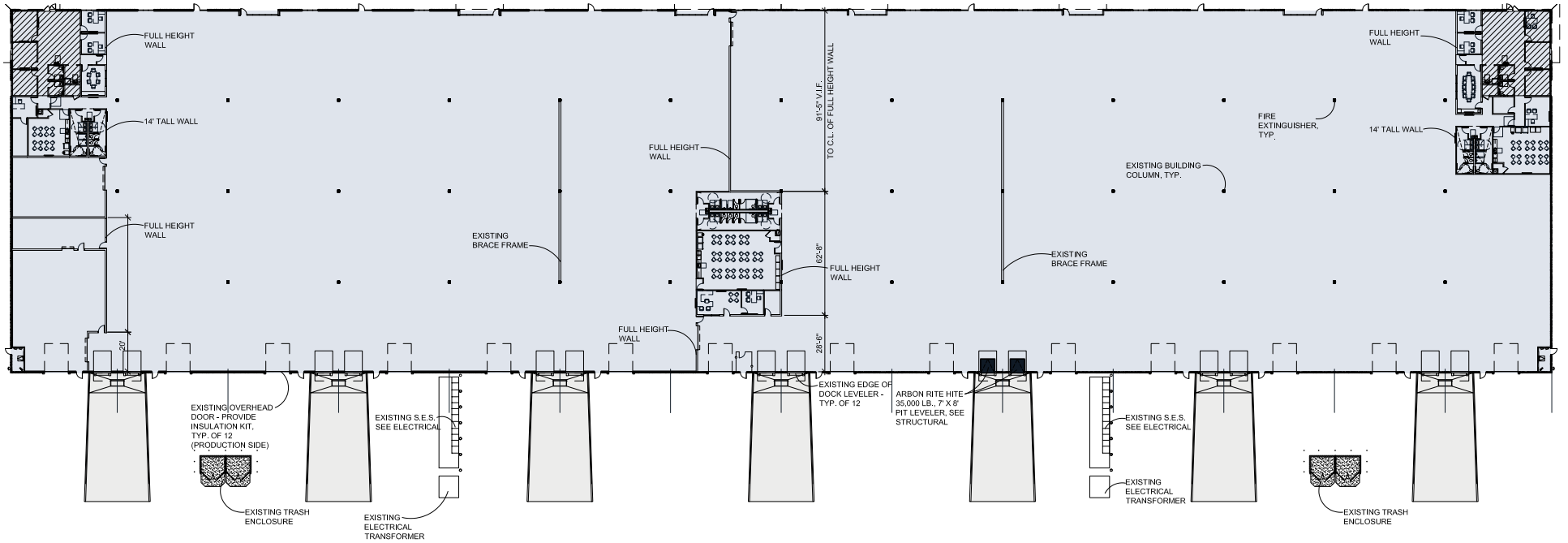



## DEMOGRAPHICS

	15 min	25 min	35 min
Estimated population (2020)	337,106	1,013,181	1,945,133
Projected population (2025)	376,717	1,103,066	2,094,586
Daytime population	292,988	904,090	1,867,817
Average Household Income	\$93,334	\$78,667	\$77,012
Median Age	35	34.7	34
Median Home Value	\$269,546	\$233,479	\$231,376

Although information has been obtained from sources deemed reliable, JLL does not make any guarantees, warranties or representations, express or implied, as to the completeness or accuracy as to the information contained herein. Any projections, opinions, assumptions or estimates used are for example only. There may be differences between projected and actual results, and those differences may be material. JLL does not accept any liability for any loss or damage suffered by any party resulting from reliance on this information. If the recipient of this information has signed a confidentiality agreement with JLL regarding this matter, this information is subject to the terms of that agreement. ©2024 Jones Lang LaSalle Brokerage, Inc. All rights reserved.

## FOR ADDITIONAL INFORMATION

**John Lydon**  
Senior Managing Director  
+1 602 282 6326  
john.lydon@jll.com

**Hagen Hyatt**  
Vice President  
+1 602 282 6275  
hagen.hyatt@jll.com

