



FIRST HAWAIIAN CENTER

999 Bishop Street, Honolulu, HI



CBRE



FIRST HAWAIIAN CENTER

999 Bishop Street, Honolulu, HI

First Hawaiian Center is Hawaii's premier Class A office complex located in the Central Business District of Honolulu. The building is an efficient, state-of-the-art headquarters for Hawaii's oldest bank; First Hawaiian Bank. First Hawaiian Center differentiates itself with high quality finishes throughout featuring granite, marble, stainless steel, glass/air conditioned exterior elevators, a fine line ceiling grid, and higher and more luxurious ceiling heights than any other building in Hawaii.

AN ARCHITECTURAL BREAKTHROUGH

First Hawaiian Center symbolizes Honolulu's modern commercial society. Views from the building capture panoramic scenes of Oahu and the Pacific Ocean. Architect William Pedersen of the New York firm of Kohn Pedersen Fox Associates designed the structure to fit into the unique setting that is Honolulu. It is triangular in shape, with a low "podium" along the Bishop and King Street faces with a "prow" on the Bishop Street side that is reminiscent of a sailing ship.

The colors and lines of the building evoke the mountains and the sea. The vertical patterns on the mauka side of the tower along King Street reflect the strong vertical influence of the Koolau Mountain Range. The tones on the makai side fronting Merchant Street and the sail-like "prow" along Bishop Street both acknowledge the nearby ocean. Unlike traditional high-rises, the "prow" gets larger as the building gets taller.

A DOWNTOWN PARK.

First Hawaiian Center provides new open space and greenery around the central intersection of Bishop and King Streets in Honolulu's Financial District. A total of 43% of the block – 24,000 square feet – is open plazas, landscaping and water features.

AN ART GALLERY.

The soaring, 44-foot-high banking hall of First Hawaiian Center features the downtown gallery of the Honolulu Museum of Art. It is a unique marriage of commerce and the arts, a showplace for the creative talents of Hawaii's people. The 90-foot sculptural glass wall and grand marble staircase lend a dramatic backdrop to the business of banking and the work of local artists displayed in the museum gallery.

A VOTE OF CONFIDENCE IN HAWAII

"This building says we believe in the future of our company, and we believe in Hawaii," said Walter A. Dods, Jr., retired Chairman, President and Chief Executive Officer of First Hawaiian Bank.

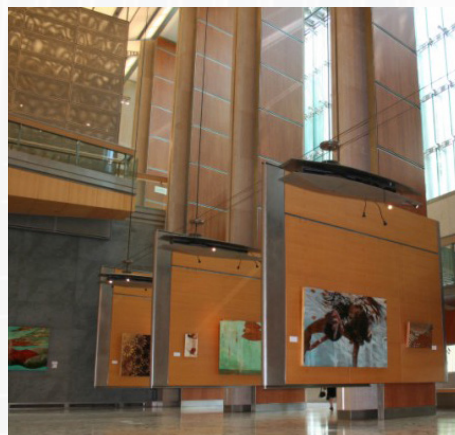

James C. Shipman (B)

+1 808 541 5184

James.Shipman@cbre.com

CBRE



BUILDING AMENITIES

Security

First Hawaiian Center has security on site allowing for 24-hour accessibility.

The Center Club

The Center Club is downtown Honolulu's finest Fitness Club. Offering a full range of equipment and services for total body wellness, The Center Club membership is accessible to First Hawaiian Center tenants and their employees on an exclusive basis. The Center Club has convenient hours Monday through Friday from 5:00 a.m. to 7:30 p.m.

First Hawaiian Bank

First Hawaiian Bank (a state of Hawaii chartered bank) was founded in 1858 and is the oldest, and largest, financial institution in the state. Offering 57 branch location across Hawaii, three in Guam and two in Saipan, First Hawaiian Bank provides commercial and consumer banking services, engages in equipment and vehicle leasing, and offers trust, investment and insurance products. First Hawaiian Center is the fourth corporate headquarters for First Hawaiian since its origination as Bishop & Co.

The Bankers Club

Dine in elegance at The Bankers Club. This exclusive restaurant located at the top of First Hawaiian Center on the 30th floor offers spectacular panoramic views of downtown Honolulu mauka to makai and a superb dining experience. It's an exclusive, invite-only club for First Hawaiian Bank employees and their clients, however membership is extended to Tenants' executive staff only, subject to First Hawaiian Bank approval.



LISTING SUMMARY

Available Space

- Suite 1701: 3,870 RSF

Base Rent

- Negotiable

OP EXP (est 2025)

- \$1.51/RSF/Month

Building Hours

- Monday to Friday: 7:00 a.m. to 7:00 p.m.

Building Air Conditioning Hours

(subject to change)

- Monday to Friday: 7:00 a.m. to 6:00 p.m.
- Saturday: 7:30 a.m. to 12:00 p.m.

Parking (1/750 RSF)

- Unreserved - \$235.60 (including tax)
- Reserved - \$340.31 (including tax)

Public Parking

- \$5.00 per 1/2 hour (or fraction thereof)
- \$5.00 Flat Rate (after 5:00 p.m., weekends, and bank holidays)
- 10 minute grace period

Parking Validations

- \$450.00 for a book of 100 30-minute stamps
- \$900.00 for a book of 100 1-hour stamps





FIRST HAWAIIAN CENTER

999 Bishop Street, Honolulu, HI

HONOLULU | CENTRAL BUSINESS DISTRICT

FIRST HAWAIIAN CENTER

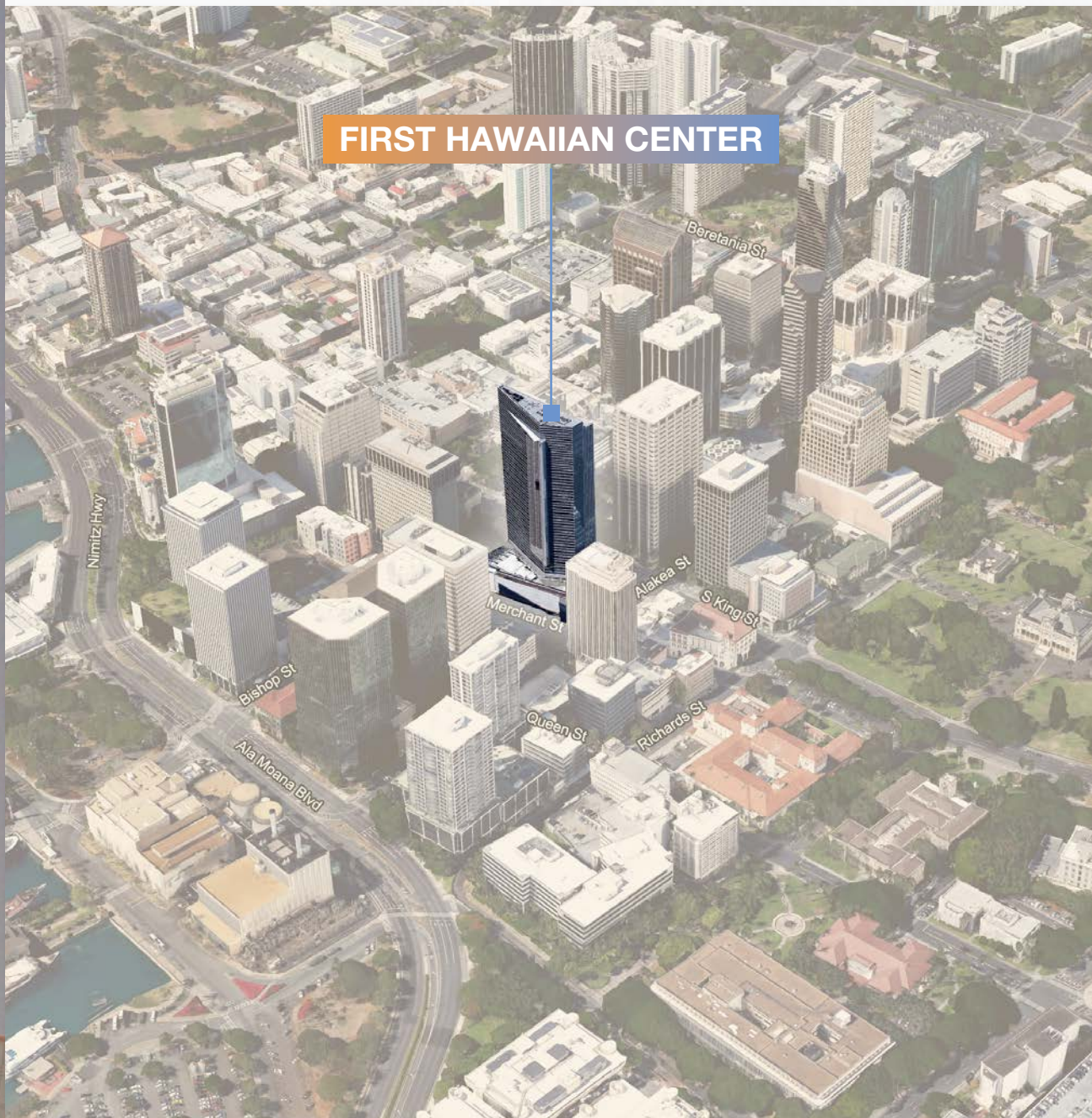

James C. Shipman (B)

+1 808 541 5184

James.Shipman@cbre.com

© 2025 CBRE, Inc. This information has been obtained from sources believed reliable. We have not verified it and make no guarantee, warranty or representation about it. Any projections, opinions, assumptions or estimates used are for example only and do not represent the current or future performance of the property. You and your advisors should conduct a careful, independent investigation of the property to determine to your satisfaction the suitability of the property for your needs.

JS:RMP_OF84First_Hawaiian_Center_03.11.25

CBRE



FIRST HAWAIIAN CENTER

999 Bishop Street, Honolulu, HI

17TH FLOOR

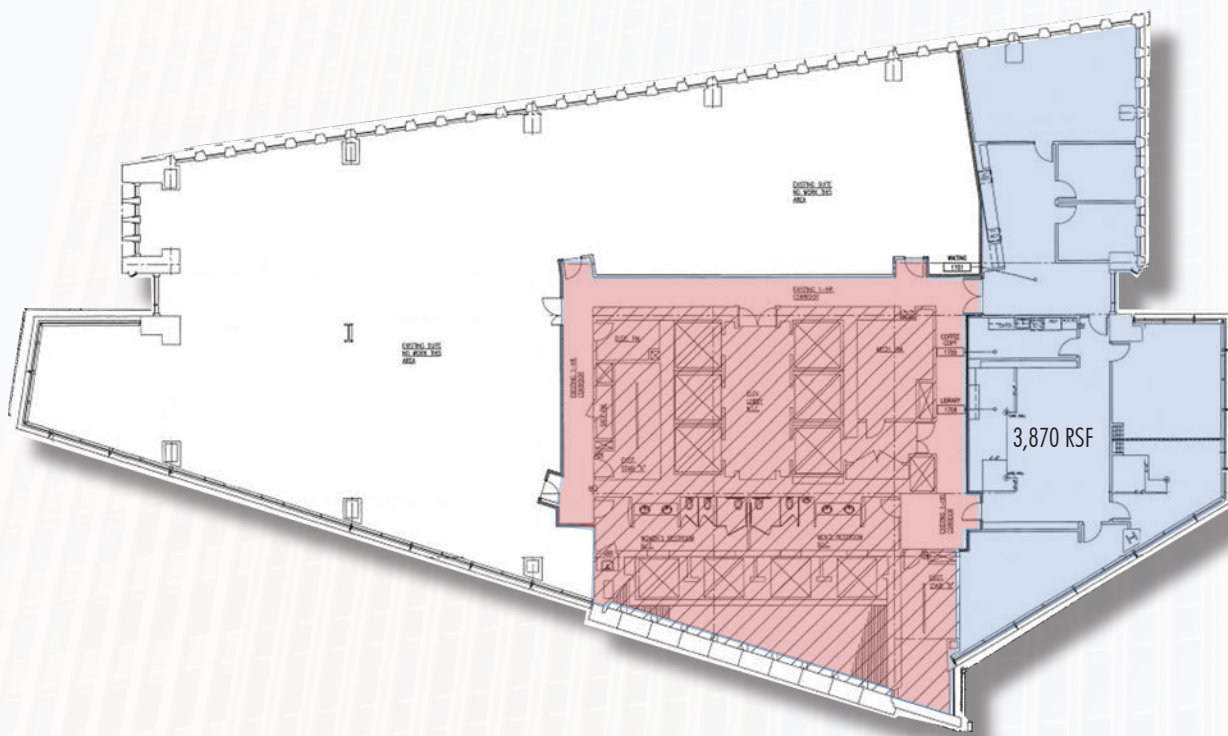

Floor/Suite	Square Feet	Comments
Suite 1701	3,870 RSF	5 offices, 1 conference room, coffee bar, work areas, located on the Diamond Head side of the floor with windows on 3 sides of the space.

James C. Shipman (B)

+1 808 541 5184

James.Shipman@cbre.com



FIRST HAWAIIAN CENTER

999 Bishop Street, Honolulu, HI

SUITE 1701

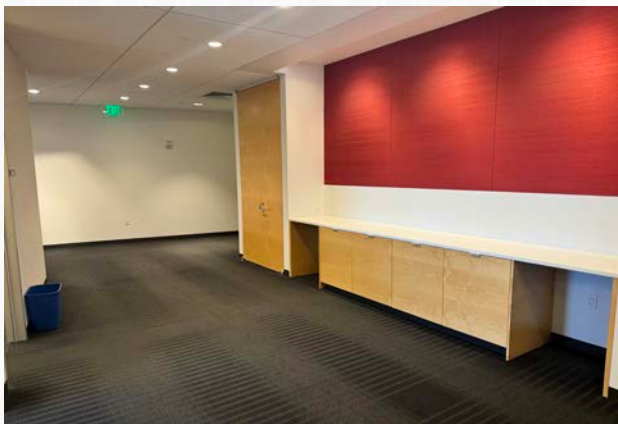

CBRE