

BUILDING AREA	
EXISTING CONDITIONED AREA:	53,191 Square Feet
SUITE 'A'	
CONDITIONED AREA:	16,291 Square Feet
UNCOVERED COURTYARD:	3,952 Square Feet
TOTAL AREA:	20,249 Square Feet
SUITE 'B'	
CONDITIONED AREA:	16,848 Square Feet
COVERED COURTYARD:	3,448 Square Feet
TOTAL AREA:	20,296 Square Feet
SUITE 'C'	
CONDITIONED AREA:	20,451 Square Feet

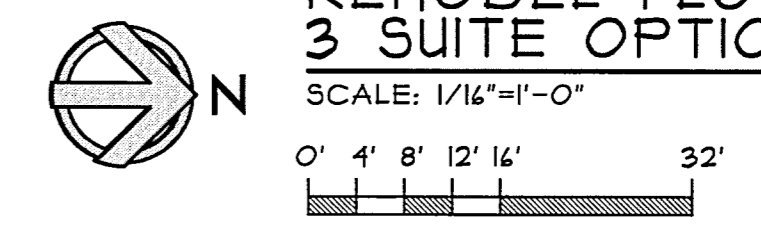

REMODEL FLOOR PLAN
3 SUITE OPTION
SCALE: 1/16"=1'-0"

Revisions:
Plot Date: 9/4/2024

GARY HAWKINS ARCHITECT
(530) 892-2700
gary@gharch.com
3045 Ceres Ave., Ste 135
Chico, CA 95973

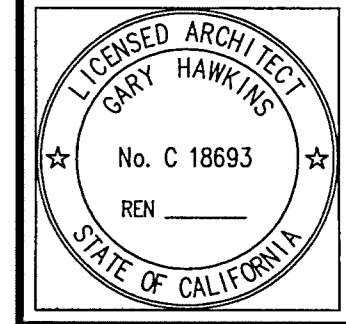

Commercial Infill for: APN: 005-570-010-000
GECCo Development, LLC
2445 Carmichael Dr. Chico, Ca.

Date: 8-2024
Drawn: GC
Job No: 24-050
SHEET NAME:
REMODEL FLOOR PLAN

SHEET NUMBER:
A1.1
of