

CLASS A MEDICAL OFFICE | LEASE OPPORTUNITY | UP TO 9,708 SF AVAILABLE

8400

RED BUG LAKE ROAD

OVIEDO | 32765
OVIEDO MEDICAL OFFICE BUILDING



PROPERTY HIGHLIGHTS

- Class A Medical Office in the heart of Oviedo
- Prime Location on campus of HCA's Oviedo Medical Center
- Excellent Visibility
- Easy Access to SR 426 & SR 417
- AADT of 42,413 vehicles at Red Bug Lake Rd and Eastern Beltway W
- Covered Patient Drop Off Area
- Very Generous TI Allowance
- Rental Rate: \$34.00 - \$40.00 SF Full Service
- Full Service Rental Rate Includes All expenses, counting utilities & In-suite Janitorial

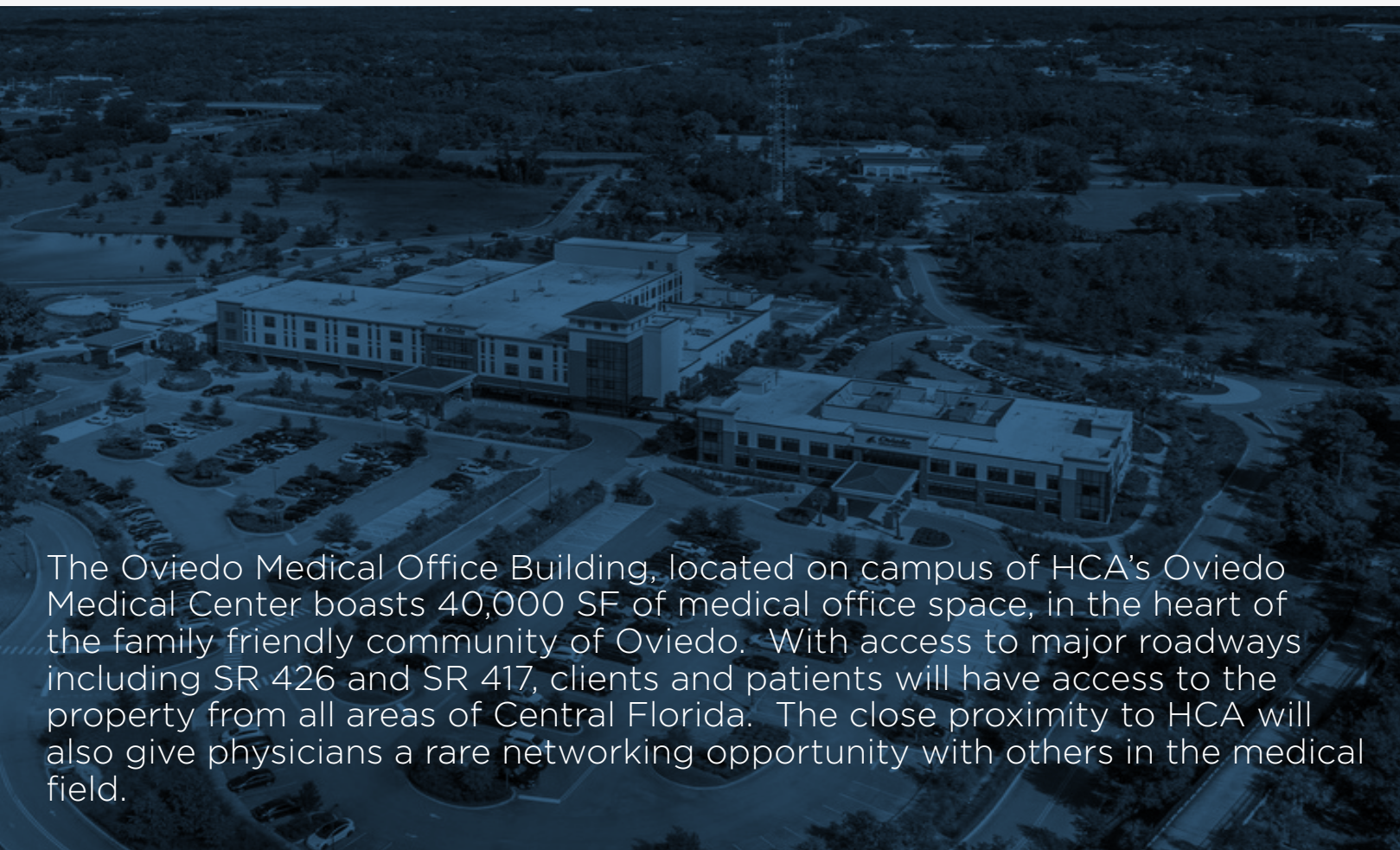

The Oviedo Medical Office Building, located on campus of HCA's Oviedo Medical Center boasts 40,000 SF of medical office space, in the heart of the family friendly community of Oviedo. With access to major roadways including SR 426 and SR 417, clients and patients will have access to the property from all areas of Central Florida. The close proximity to HCA will also give physicians a rare networking opportunity with others in the medical field.

STACKING PLANS

1ST FLOOR

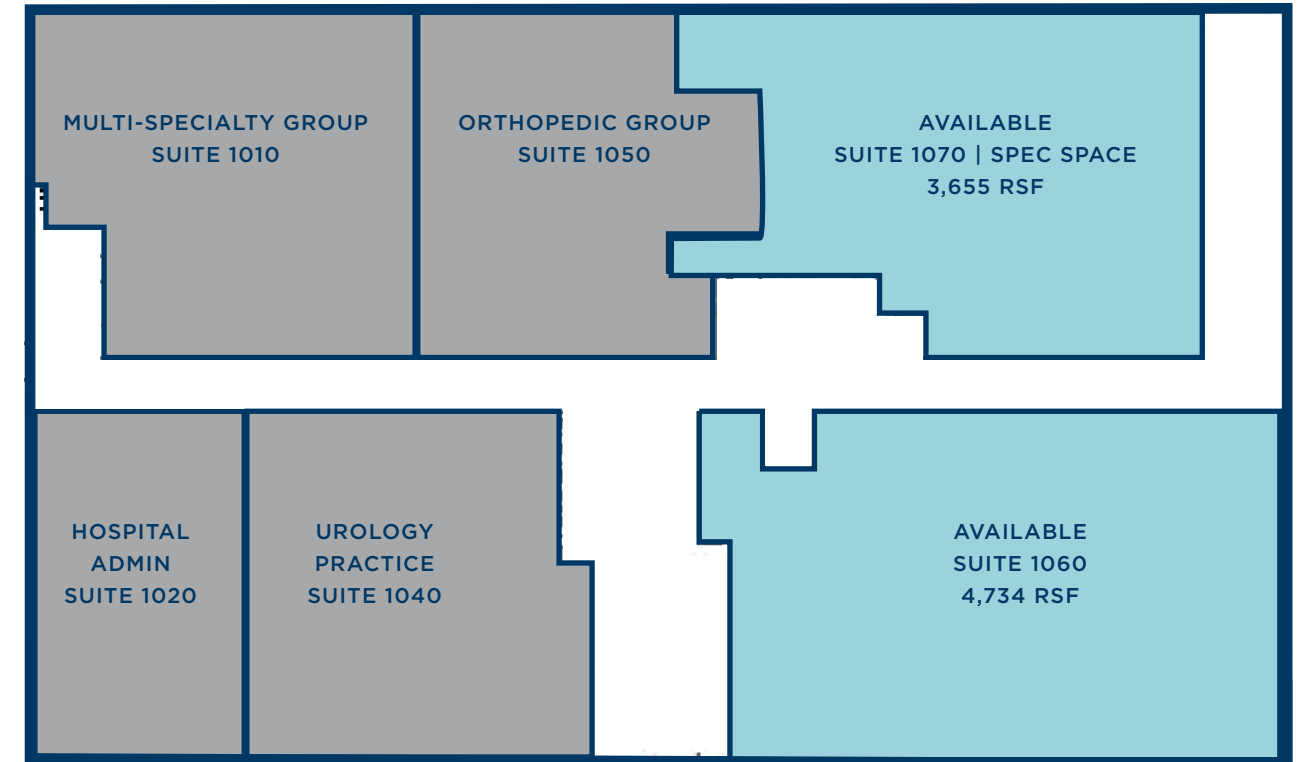

2ND FLOOR

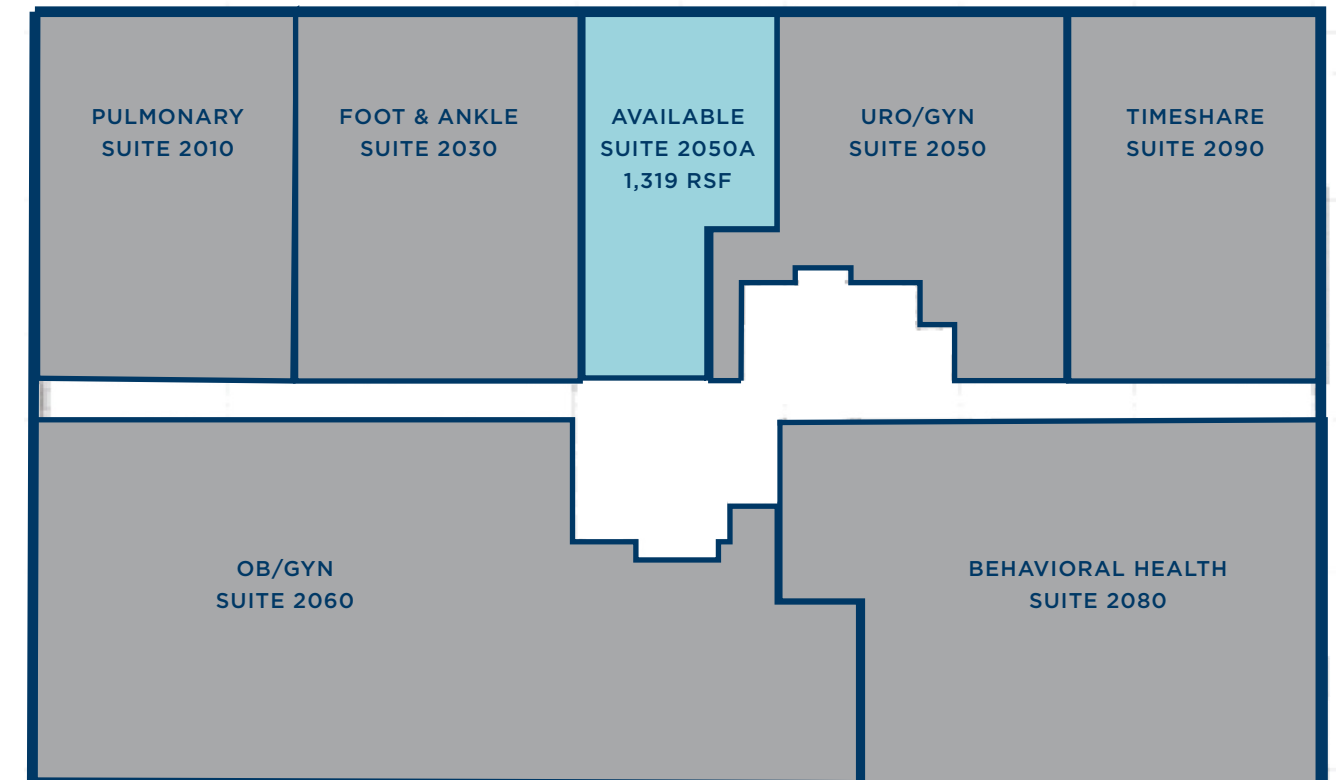

8400

RED BUG LAKE ROAD



FOR MORE INFORMATION,

PLEASE CONTACT:

ANNE SPENCER, MCR

Florida Healthcare Advisory Practice

Direct: +1 407 541 4434

Mobile: +1 407 461 0825

Email: anne.spencer@cushwake.com