



Blue Diamond

 **NORTH AMERICAN**
COMMERCIAL

FOR LEASE



LEASE RATE
\$5.00 PSF



DRIVE THRU'S
Two (2)



PRODUCT TYPE
Retail



LEASE TYPE
Triple NNN



BUILDING SIZE
2,500 - 3,200 RSF



CONSTR. YEAR
EST. Q1 2025

PROPERTY SUMMARY

North American Commercial is proud to exclusively market Retail Pads 1 & 2 for Lease. The subject properties feature Two (2) stunning Class-A Retail buildings located on Blue Diamond Road & Chieftain in the Southwest area. Both pads are expected to feature a Drive-Thru and will start anywhere from 2,800 Square Feet for pad one (1) and 2,100 Square Feet for Pad Two (2).

The development also displays direct frontage on Blue Diamond which services Tens of Thousands of drivers every day in an irreplaceable location. Ownership is also open to entertaining a Ground Lease between both pads as well as a build-to-suit option (depending on the lease rate).

PRICING

\$5.00 PSF, CAM TBD

PROPERTY DETAILS

- Parcel - 176-19-601-027
- 2,100 SF - 3,200 SF Available
- Blue Diamond Frontage
- Potential Build to Suit Available
- Potential Ground Lease Available
- Two (2) Drive Thru's
- Southwest Corridor

PROPERTY PHOTOS



FLOOR PLAN

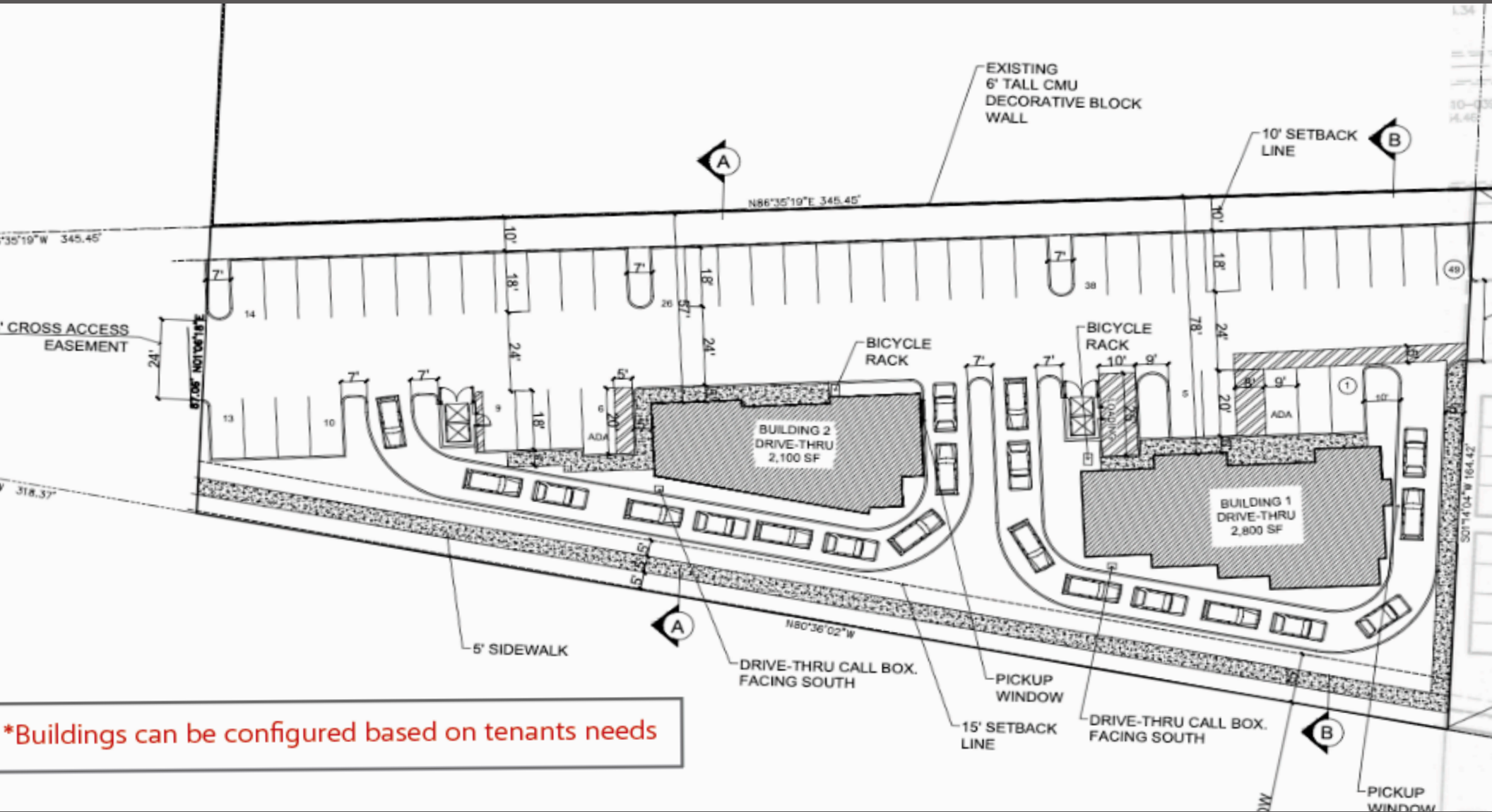

*Buildings can be configured based on tenants needs

AREA MAP



DISCLAIMER & NON-ENDORSEMENT



DISCLAIMER

THIS PROPERTY PROSPECTUS IS INTENDED TO HIGHLIGHT PROPERTY FEATURES AND INFORMATION AND SHOULD NOT BE CONSIDERED AS AN ALL-INCLUSIVE PRESENTATION OF FACTS. PROSPECTIVE BUYERS ARE ENCOURAGED TO PERFORM THEIR OWN INVESTIGATIONS AND DUE DILIGENCE TO CONFIRM INFORMATION CONTAINED HEREIN. Although effort was made to obtain information from sources deemed reliable, we give no representations or warranties, express or implied. North American Commercial, its affiliates or subsidiaries, or any affiliated agent has not made any investigation, determination, warranty or representation, with respect to any of the following: the financial condition or business prospects of any tenant, or such tenants intent to continue or renew its tenancy in the property; the legality of the present or any possible future use of the property under any federal, state, or local law; pending or possible future action by any governmental entity or agency which may affect the property; the physical condition of the property, including but not limited to, soil conditions, the structural integrity of the improvements, and the presence or absence of fungi or wood-destroying organisms; the accuracy or completeness of income/expense information and projections, square footage figures, and texts of leases, options, and other agreements affecting the property; the possibility that lease, options or other documents exist which affect or encumber the property which have not been provided or disclosed by Seller/Landlord; the presence of location of any hazardous materials on or about the property, including, but not limited to asbestos, PCB s, or toxic, hazardous or contaminated substances, and underground storage tanks.

NON-ENDORSEMENT

All product names, company names, and logos are trademarks™ and registered trademarks® of their respective holder. Use of any product names, company names, and logos does not imply affiliation, sponsorship, or endorsement. Any presence of such is included solely for the purpose of providing information about this listing to prospective clients and/or customers.

Non-Endorsement North American Commercial and its logo is a registered trademark of NAC Las Vegas, LLC.

All design, artwork, and photos contained herein are prohibited from being copied or utilized without the prior written consent of North American Commercial, and/or its affiliates.

NAC Las Vegas, LLC © 2021. All rights reserved.