

# FOR SALE

9645 SW Beaverton Hillsdale-Highway, Beaverton, Oregon 97005

*Price Reduced to \$1,000,000*



*Tastefully Remodeled with ADA Upgrades*

- +/-2,740 SF Building on +/-10,454 SF Lot
- Separate Rental Unit and Billboard Income, plus Pylon Sign
- Owner/User Opportunity for: Medical, Dental, Veterinary, Professional Services, Fitness, Daycare, & More. NS Zoning.

*NS stands for Neighborhood Service, City of Beaverton. Call for Zoning Table.*

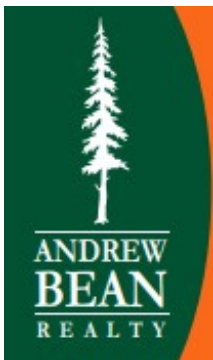

**Andrew Bean, SIOR**

**503-819-5381**

**[andrew@andrewbeanrealty.com](mailto:andrew@andrewbeanrealty.com)**

PO Box10104

Portland, Oregon 97296

*This information has been obtained by others and deemed to be reliable. However, a prospective purchaser or lessee is expected to verify all information to their own satisfaction.*

# FOR SALE

9645 SW Beaverton Hillsdale-Highway, Beaverton, Oregon 97005



*Photos: Main level entrance area; Workspace area; Showroom/kitchen area; ADA bathroom, Lower level open office area and entrance.*

**Main level has a mix of Workspace, Showroom, Two Bathrooms (one fully ADA). Lower level has Storage Space for main level and Separate Rental Unit with Two Private Offices, Open Area, and ADA Bathroom.**



Andrew Bean, SIOR  
503-819-5381

[andrew@andrewbeanrealty.com](mailto:andrew@andrewbeanrealty.com)



# FOR SALE

9645 SW Beaverton Hillsdale-Highway, Beaverton, Oregon 97005

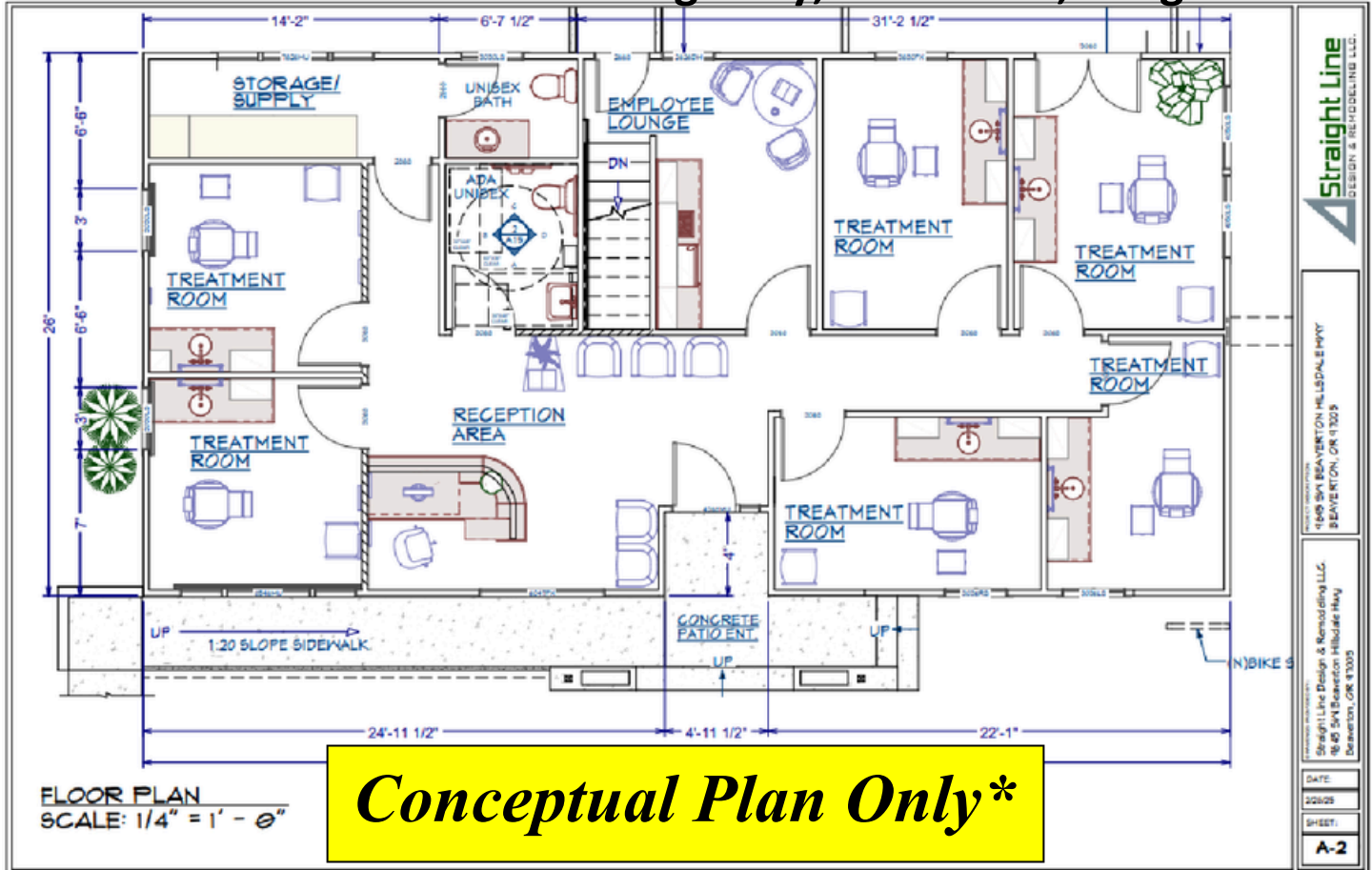

*\*Conceptual plan for Medical/Dental/Vet uses. Both bathrooms, including ADA are existing.*

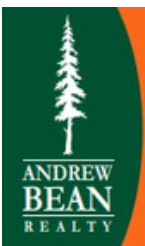
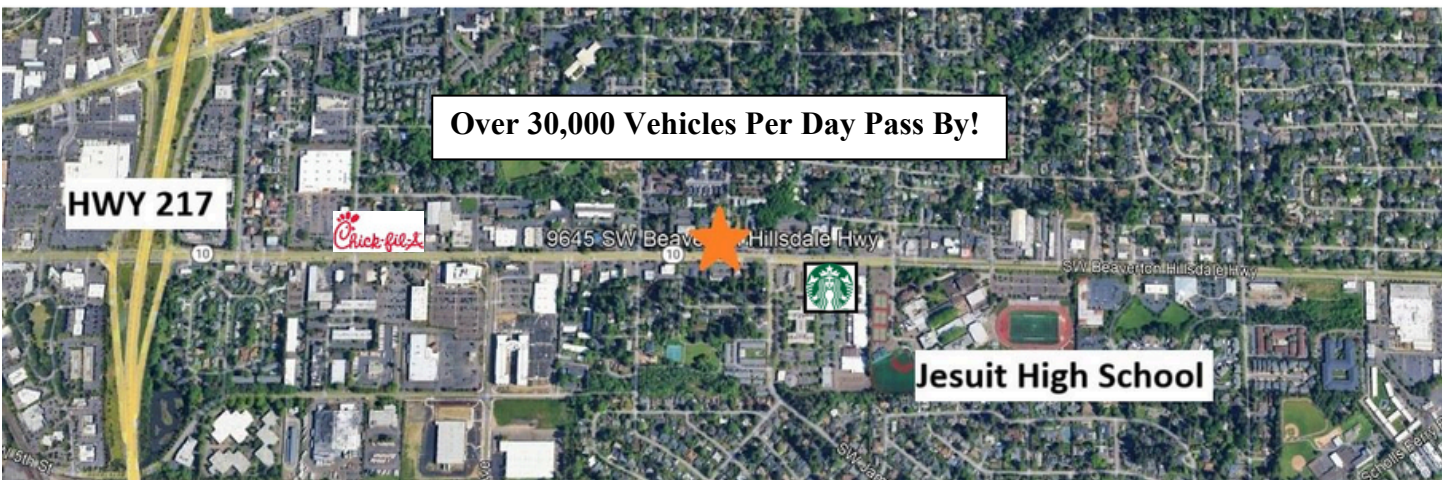

**Andrew Bean, SIOR**  
**503-819-5381**  
**[andrew@andrewbeanrealty.com](mailto:andrew@andrewbeanrealty.com)**  
PO Box 10104  
Portland, Oregon 97296

*This information has been obtained by others and deemed to be reliable. However, a prospective purchaser or lessee is expected to verify all information to their own satisfaction.*