

PRIVATE OFFICE SUITE FOR SUB LEASE



1129 NORTHERN BLVD - MANHASSET

SUITE 406

\$ 950/ Monthly

PRIVATE OFFICE SUITE FOR SUBLEASE IN A-CLASS, HANDICAPPED FRIENDLY BUILDING WITH AMPLE PARKING UNMATCHED BY ANY OTHER IN THE AREA. PREVIOUSLY USED AS A WELLNESS CONSULTANT OFFICE. MOVE IN READY, AVAILABLE RIGHT AWAY.

STRATEGICALLY LOCATED ON THE BORDER OF GREAT NECK AND MANHASSET. LESS THAN 15 MINUTES WALK TO THE MANHASSET LIRR STATION, APPROX. 25 MIN. RIDE TO MANHATTAN, AND CLOSE TO ALL RETAILS EATERIES, SCHOOLS, CAFES, BANKS, HOSPITALS AND PUBLIC TRANSPORT.



ROZITA SOOMEKH

LICENSED REAL ESTATE BROKER
Rozita.Soomekh@elliman.com

516.205.2279



CLICK HERE

LOCATING IN PRIME LOCATION

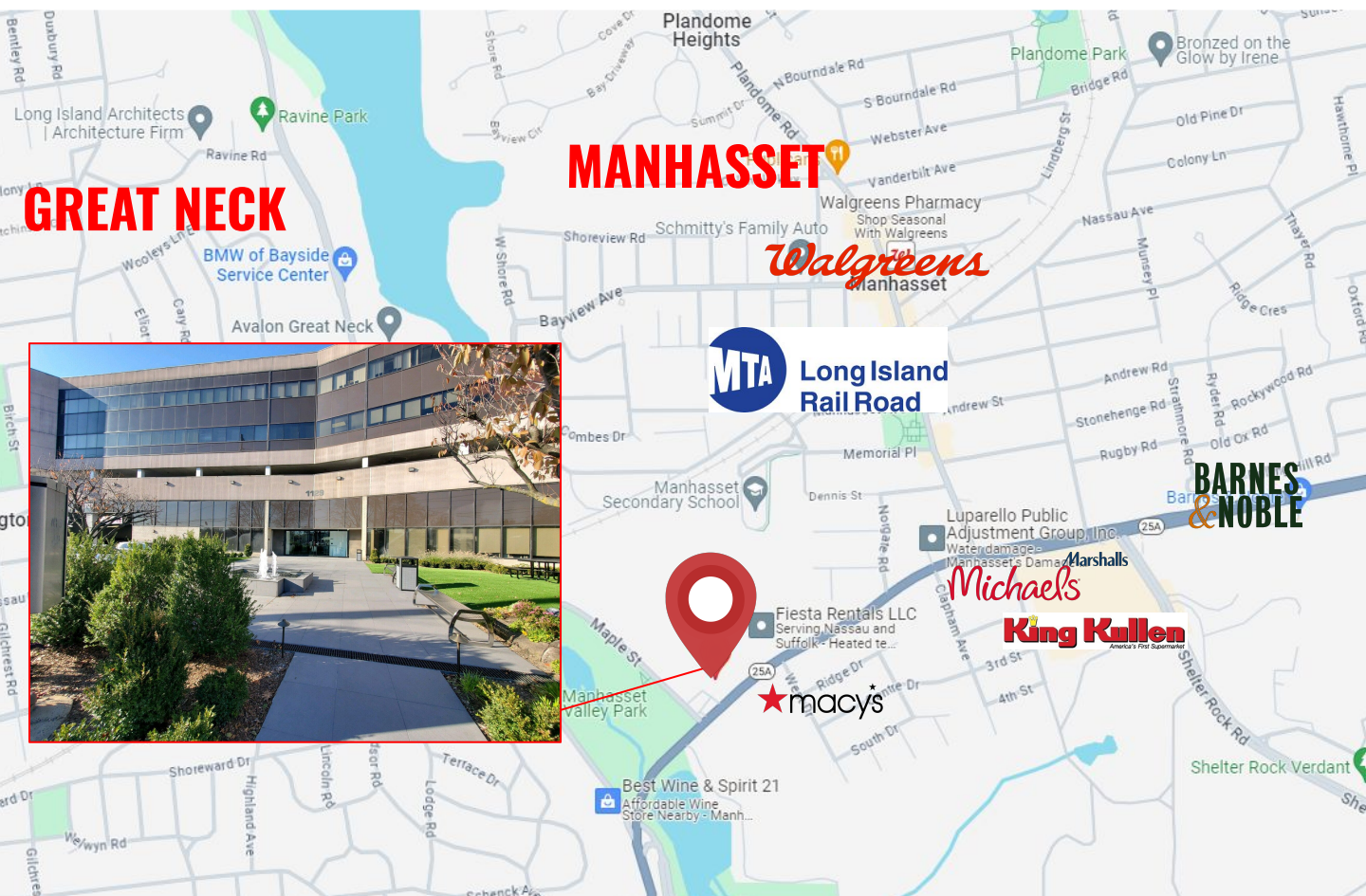

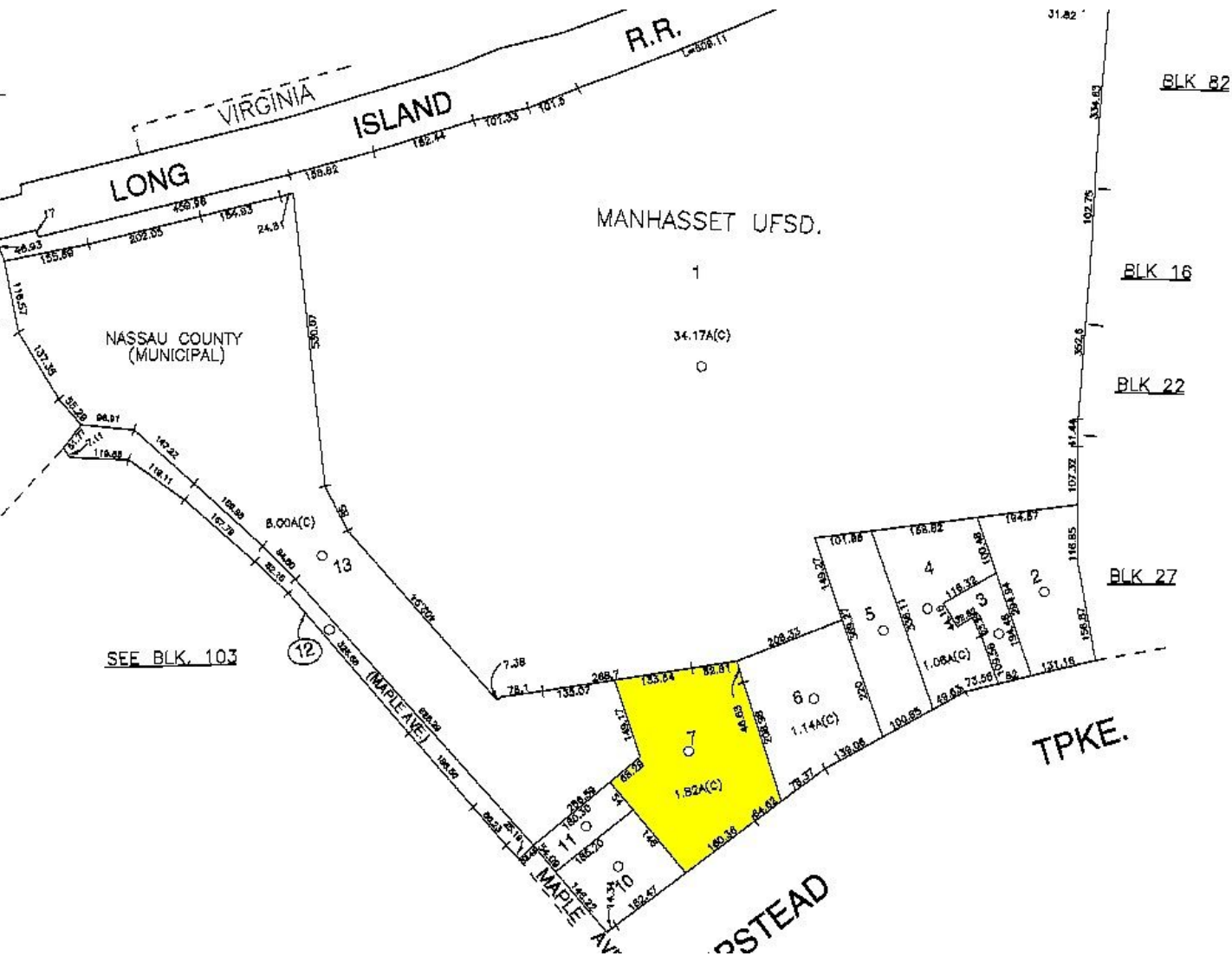

CONTACT OUR EXCLUSIVE AGENTS:



ROZITA SOOMEKH
Licensed Real Estate Broker
Rozita.Soomekh@elliman.com
516.205.2279

 **THE ROZITA SOOMEKH TEAM**
at Douglas Elliman Real Estate