

DOOR SCHEDULE												
MARK	RM NAME	DOOR			FRAME			HARDWARE GROUP	DETAILS			COMMENTS
		W" X H"	TYPE	RATING	MATERIAL	TYPE	RATING		MATERIAL	HEAD	JAMB	
100A	EXTERIOR	34 X 80	--	---	--	--	--	--	--	--	--	EXISTING TO REMAIN
100B	EXTERIOR	34 X 80	--	---	--	---	--	--	--	--	--	EXISTING TO REMAIN
100C	EXTERIOR	69 X 80	--	---	--	---	--	--	--	--	--	EXISTING TO REMAIN
100D	EXTERIOR	34 X 80	--	---	--	---	--	--	--	--	--	EXISTING TO REMAIN
102	PRIVATE DINING	36 X 80	A	---	HM	1	---	HM	01	5 / A1.1	4 / A1.1	--
104	OFFICE	34 X 80	A	---	HM	1	---	HM	02	5 / A1.1	4 / A1.1	--
105	MEN	34 X 80	--	---	--	---	--	--	--	--	--	--
105A	MEN TLT	34 X 80	A	---	HM	1	---	HM	01	5 / A1.1	4 / A1.1	--
106	WOMEN	34 X 80	A	---	HM	1	---	HM	02	5 / A1.1	4 / A1.1	--
106A	WOMEN TLT	34 X 80	--	---	--	---	--	--	--	--	--	--
106B	WOMEN TLT	34 X 80	A	---	HM	1	---	HM	01	5 / A1.1	4 / A1.1	--
107A	DISH AREA	36 X 80	A	---	HM	1	---	HM	02	5 / A1.1	4 / A1.1	--
107B	DISH AREA	52 X 80	--	---	--	---	--	--	--	--	--	--

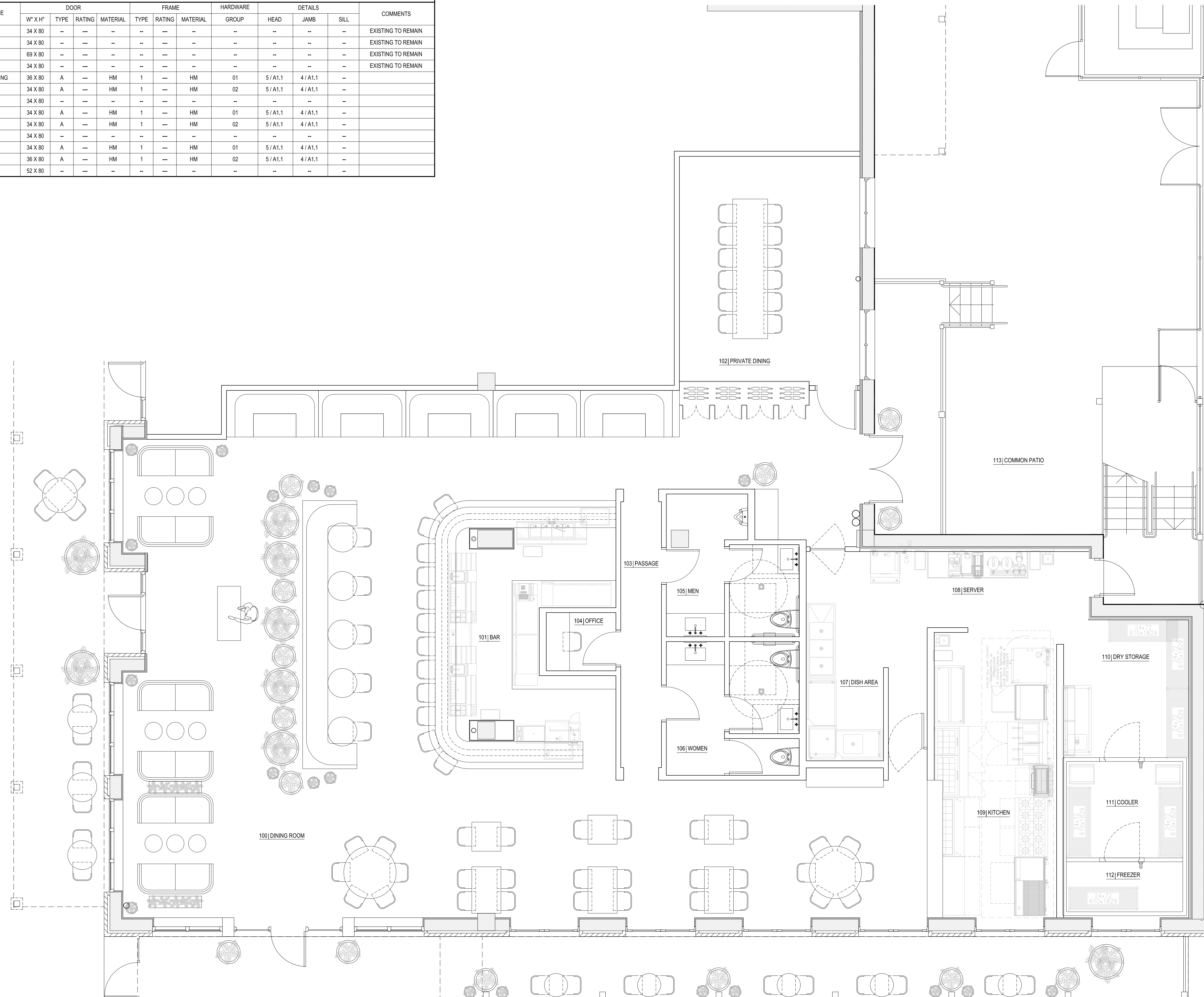

**GENERAL NOTES**

- ALL NEW GYPSUM BOARD PARTITIONS SHALL BE TAPED AND SANDED SMOOTH WITH NO VISIBLE JOINTS, LEVEL 3 MIN.
- ALL WORK SHALL BE ERECTED AND INSTALLED PLUMB, LEVEL, SQUARE, AND TRUE, AND IN PROPER ALIGNMENT.
- REFER TO REFLECTED CEILING PLANS FOR SOFFIT AND CEILING HEIGHTS.
- OBTAIN APPROVAL FROM ARCHITECT PRIOR TO MODIFYING BUILDING COMPONENTS, SYSTEMS, AND ITEMS NOT IDENTIFIED PRIOR TO ADJUSTING ANY AND ALL OTHER FIELD CONDITIONS REQUIRED TO FIT PLANS.
- TRIM THE BOTTOMS OF DOORS TO CLEAR THE TOP OF FINISHED FLOOR, AS APPLICABLE, BY 1/2" MAXIMUM, UNLESS OTHERWISE NOTED. WHERE VARIATIONS IN FLOOR ELEVATION EXIST, DOORS SHALL BE ORDERED WITH BOTTOM STILE SIZED TO ACCOMMODATE UNDERCUT CONDITIONS.
- FULL HEIGHT PARTITIONS SHALL BE INSTALLED TIGHT TO DECK; WITH NO JOINTS VARYING MORE THAN 1/8" OVER 6'-0" AND NO JOINTS GREATER THAN 3/16" U.O.N.
- ALL DOORS SHALL HAVE 1'-6" CLEAR ON STRIKE/PULL SIDE OF DOOR, VERIFY AND REPORT TO ARCHITECT OF EXCEPTIONS PRIOR TO CLOSING PARTITIONS.
- HAVE MILLWORK, GRAB BARS, BUILT-INS, TV BRACKETS, ETC TO HAVE WOOD BLOCKING. ALL BLOCKING SHALL BE SIZED ACCORDING TO ITEMS SUPPORTING.
- REFER TO INDEX SHEET FOR ADDITIONAL NOTES, LEGENDS, SYMBOLS, ABBREVIATIONS, PRODUCT APPROVALS AND SCHEDULES.

**DRAWING LEGEND**

- ROOM NUMBER ROOM NAME
- NOT IN SCOPE
- DOOR NUMBER - SEE SHEET A6.1
- GLAZING ELEVATIONS - SEE SHEET A6.1
- FLOOR DRAIN, REFER TO PLUMBING DWGS.

**PARTITION TYPE**

- EXISTING EXTERIOR WALL FINISHED WITH INSULATION AND GWB.
- 5/8" MARINE GRADE PLYWOOD OVER EXISTING EXTERIOR WALL.
- 5/8" MARINE GRADE PLYWOOD OVER 1-5/8" 20 GA. (0.0312") METAL STUDS OVER EXISTING EXTERIOR WALL.
- TYP INTERIOR WALL UON, 3-5/8" 20 GA. (0.0312") METAL STUDS 24" O.C. WITH ONE LAYER OF 5/8" GWB ON EACH SIDE, FILLED FULL WITH SOUND ATTENUATION BLANKET, EXTEND TO CEILING.
- 6" 20 GA. (0.0312") METAL STUDS 24" O.C. WITH ONE LAYER OF 5/8" GWB ON EACH SIDE, FILLED FULL WITH SOUND ATTENUATION BLANKET, EXTEND TO CEILING.
- UL 415, 4" 20 GA. (0.0345") METAL CHANNEL STUDS 24" O.C. WITH 1" GWB ON EXTERIOR SIDE AND TWO LAYERS OF 5/8" GWB ON INTERIOR SIDE, FILLED FULL WITH SOUND ATTENUATION BLANKET, EXTEND TO BOTTOM OF DECK.

**NOTE:**  
4" HIGH CEMENT BACKER BOARD TO BE PROVIDED IN PLACE OF GWB ALONG ALL WET AREAS UNLESS OTHERWISE SPECIFIED.

**SPECIFIC NOTES**

- xxxxxxx