

FOR LEASE

COURTLANDS OF WILLIAMS RANCH

4511 WILLIAMS WAY BOULEVARD
RICHMOND, TX 77469



SHAWN ACKERMAN
PRESIDENT
(713) 386-1088 Direct
shawnackerman@henrysmiller.com

HENRY S. MILLER BROKERAGE, LLC | HOUSTON
900 Threadneedle St, Suite 120
Houston, Texas 77079
www.henrysmiller.com



PROPERTY HIGHLIGHTS

COURTLANDS OF WILLIAMS RANCH

4511 WILLIAMS WAY BOULEVARD, RICHMOND, TX 77469

LOCATION

4511 Williams Way Boulevard
Richmond, TX 77469

DESCRIPTION

- 14,130 SF available for pre-lease
- SEC Southwest Freeway & Williams Way Blvd
- \$159,091 Avg. Household Income w/in 1-mile radius
- 90,000+ VPD
- 96 Spaces / 6.86 Ratio
- Delivery: Q3 2025

HIGHLIGHTS

Located just 30 miles from Houston, Richmond and Rosenberg are dynamic business hubs offering a prime commercial real estate landscape. With an impressive transportation network, diverse industries, a skilled workforce, and a supportive community, these cities provide an ideal environment for your business to flourish. From office spaces to retail properties, there are diverse commercial real estate options to choose from. Discover the opportunities that await your business in Richmond and Rosenberg, where success thrives. Contact us today to seize your place in this vibrant business community.

PRICING

- Contact Broker for Details



SHAWN ACKERMAN
PRESIDENT
(713) 386-1088 Direct
shawnackerman@henrysmiller.com

HENRY S. MILLER BROKERAGE, LLC | HOUSTON
900 Threadneedle St, Suite 120
Houston, Texas 77079
www.henrysmiller.com

PHOTOS

COURTLANDS OF WILLIAMS RANCH

4511 WILLIAMS WAY BOULEVARD, RICHMOND, TX 77469



SHAWN ACKERMAN
PRESIDENT
(713) 386-1088 Direct
shawnackerman@henrysmiller.com

HENRY S. MILLER BROKERAGE, LLC | HOUSTON
900 Threadneedle St, Suite 120
Houston, Texas 77079
www.henrysmiller.com

SITE PLAN

COURTLANDS OF WILLIAMS RANCH

4511 WILLIAMS WAY BOULEVARD, RICHMOND, TX 77469

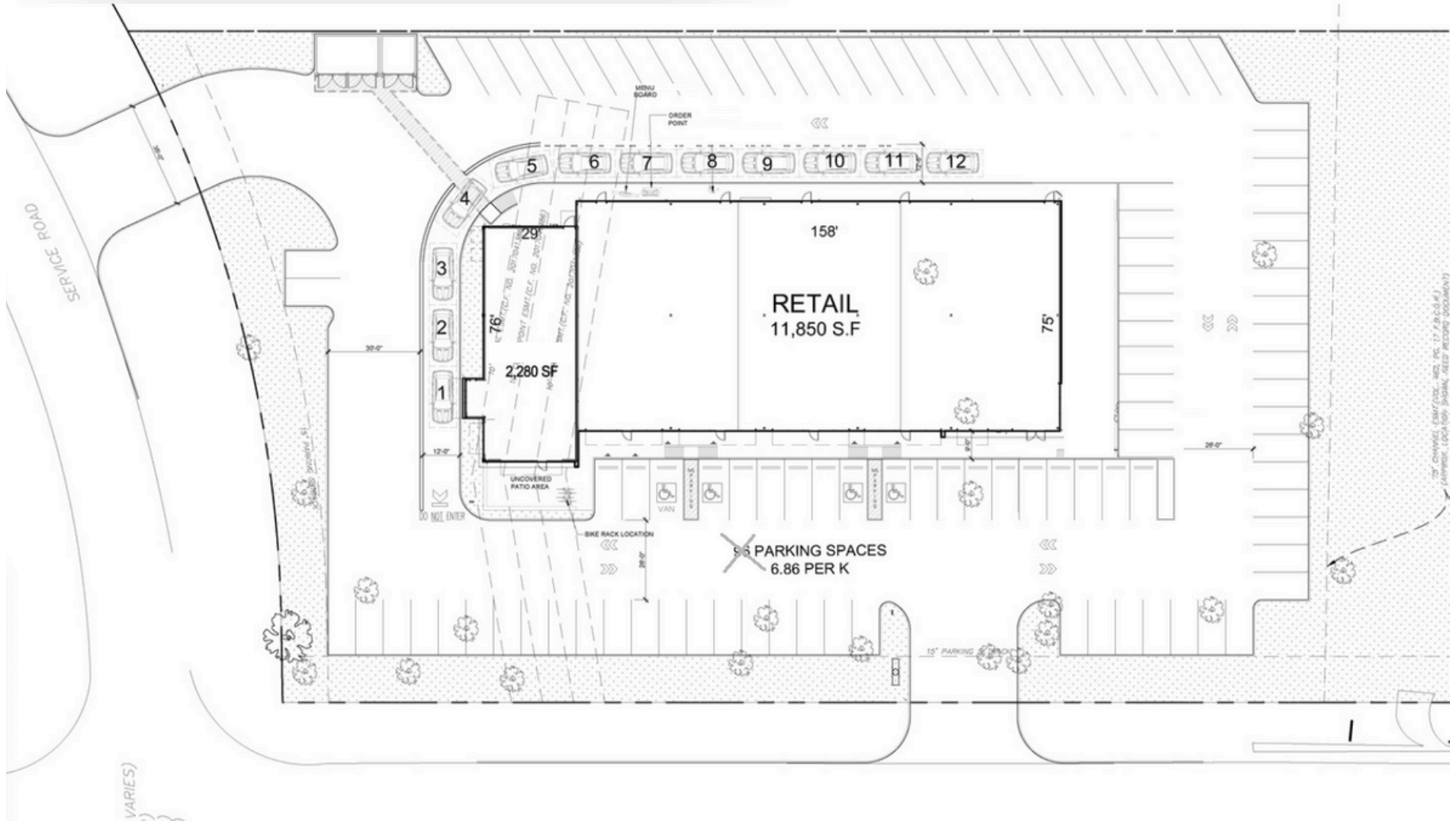

SHAWN ACKERMAN
PRESIDENT
(713) 386-1088 Direct
shawnackerman@henrysmiller.com

HENRY S. MILLER BROKERAGE, LLC | HOUSTON
900 Threadneedle St, Suite 120
Houston, Texas 77079
www.henrysmiller.com



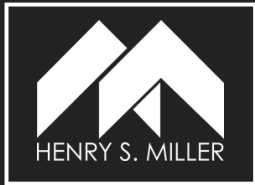

SHAWN ACKERMAN
 PRESIDENT
 (713) 386-1088 Direct
 shawnackerman@henrysmiller.com

HENRY S. MILLER BROKERAGE, LLC | HOUSTON
 900 Threadneedle St, Suite 120
 Houston, Texas 77079
 www.henrysmiller.com

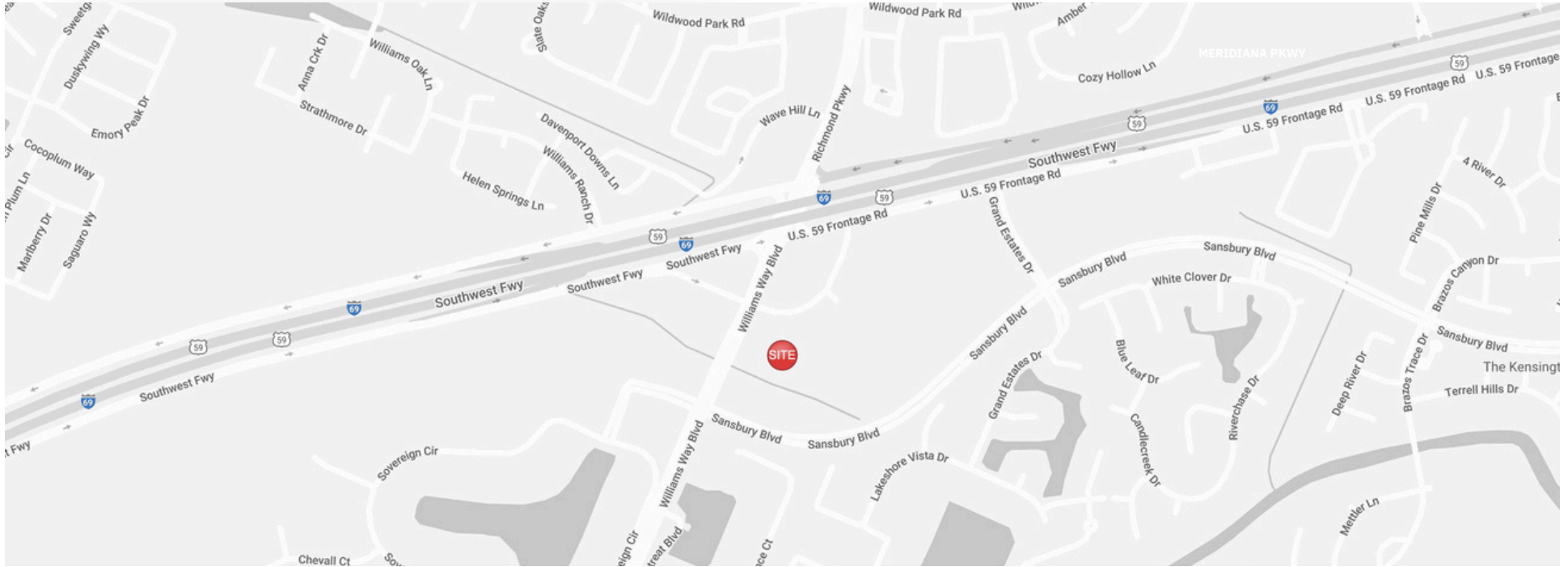

**2022
ESTIMATED
POPULATION**

1 MILE	10,816
3 MILES	64,114
5 MILES	139,682



**2022
ESTIMATED
HOUSEHOLDS**

1 MILE	3,680
3 MILES	21,369
5 MILES	46,075



**2022
ESTIMATED AVERAGE
HOUSEHOLD INCOME**

1 MILE	\$159,091
3 MILES	\$149,313
5 MILES	\$142,803



**2022
ESTIMATED
TOTAL BUSINESSES**

1 MILE	333
3 MILES	2,498
5 MILES	5,710



**2022
ESTIMATED
TOTAL EMPLOYEES**

1 MILE	1,463
3 MILES	12,649
5 MILES	33,168



SHAWN ACKERMAN
PRESIDENT
(713) 386-1088 Direct
shawnackerman@henrysmiller.com

HENRY S. MILLER BROKERAGE, LLC | HOUSTON
900 Threadneedle St, Suite 120
Houston, Texas 77079
www.henrysmiller.com

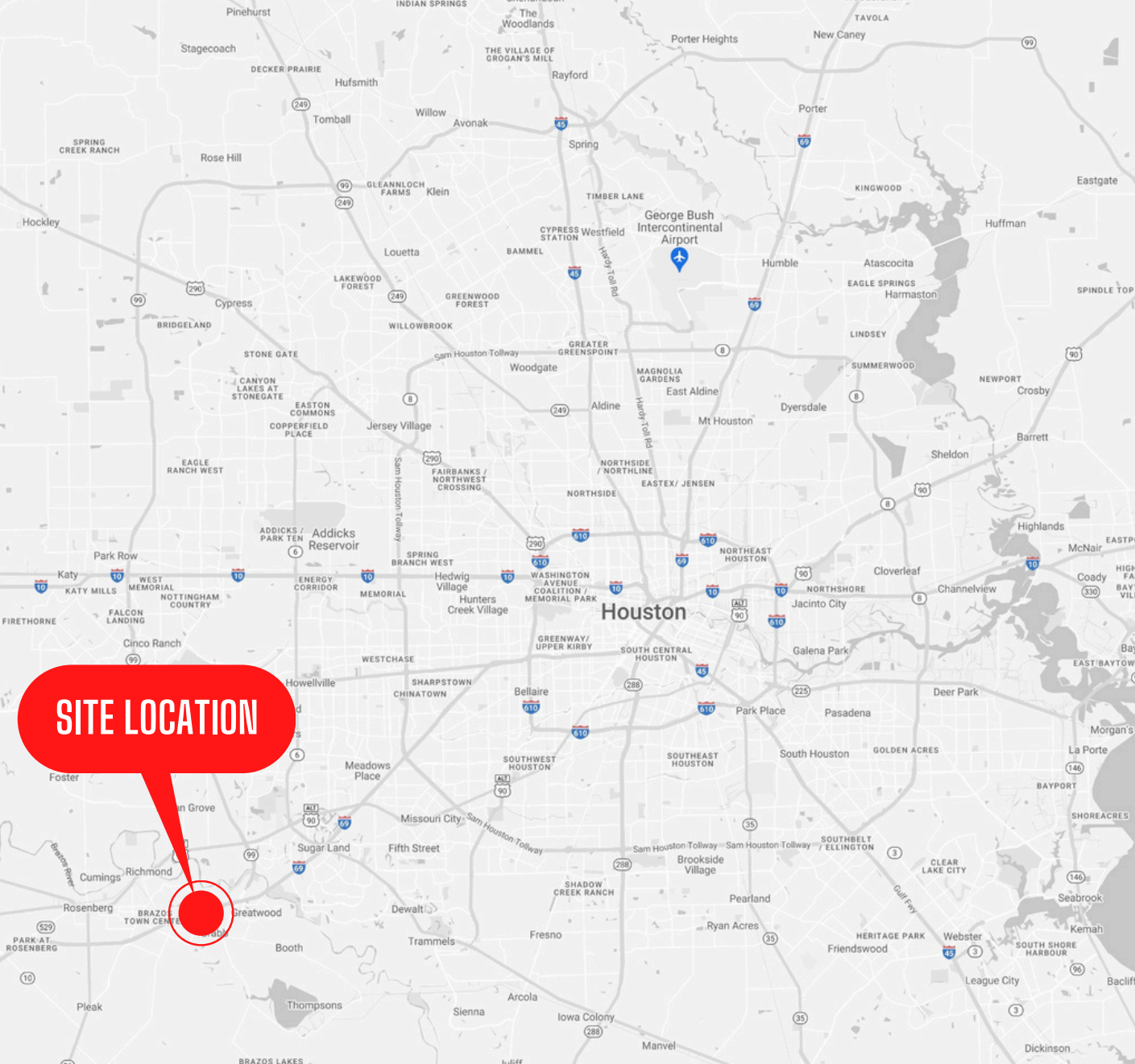

CONTACT OUR TEAM

SHAWN ACKERMAN
PRESIDENT
(713) 386-1088 Direct
shawnackerman@henrysmiller.com

HENRY S. MILLER BROKERAGE, LLC | HOUSTON
900 Threadneedle St, Suite 120
Houston, Texas 77079
www.henrysmiller.com

NOTICE & DISCLAIMER: The enclosed information is from sources believed to be reliable, but Henry S. Miller Brokerage, LLC has not verified the accuracy of the information. Henry S. Miller Brokerage, LLC makes no guarantee, warranty or representation as to the information, and assumes no responsibility for any error, omission or inaccuracy. The information is subject to the possibility of errors, omissions, changes of condition, including price or rental, or withdrawal without notice. Any projections, assumptions or estimates are for illustrative purposes only. Recipients should conduct their own investigation.

GROUND BREAKING

SEC SW Frwy & Williams Way Blvd
Richmond, TX







GROUND BREAKING
SEC SW Frwy & Williams Way Blvd
Richmond, TX