

Strategically Located Retail For Lease



BESTBUY SHOPS AT

Metro North

2737 West Thunderbird Road  
Phoenix, AZ 85053



±210,342 VPD



Thunderbird Road; ±45,488 VPD

AVAILABLE INLINE SPACE FOR LEASE:	3,900 SF
LEASE RATE:	Negotiable
BUILDING SIZE:	18,721 SF
YEAR BUILT:	2007
ZONING:	C-2, Phoenix
PARKING RATIO:	9.4:1,000 SF
CROSS STREETS:	SWC I-17 & Thunderbird Road
TRAFFIC COUNT:	±255,830 VPD (I-17 + Thunderbird Rd)

For More Information, Please Contact:

MICHAEL ACHTMAN  
480.887.0597 (O)  
480.694.3453 (C)  
michael.achtman@orionprop.com

JENNIFER EGGERT  
480.565.3772 (O)  
480.205.7681 (C)  
jennifer.eggert@orionprop.com



www.ORIONprop.com

HIGHLIGHTS:

- Suites 103-104 Available (3,900 SF Demisable)
- Space is a Former Gym
- Easy Access to Interstate 17
- Access to the Area's Dense Employer Base & Strong Middle Class Demographic
- Newer Property; 2007 Construction

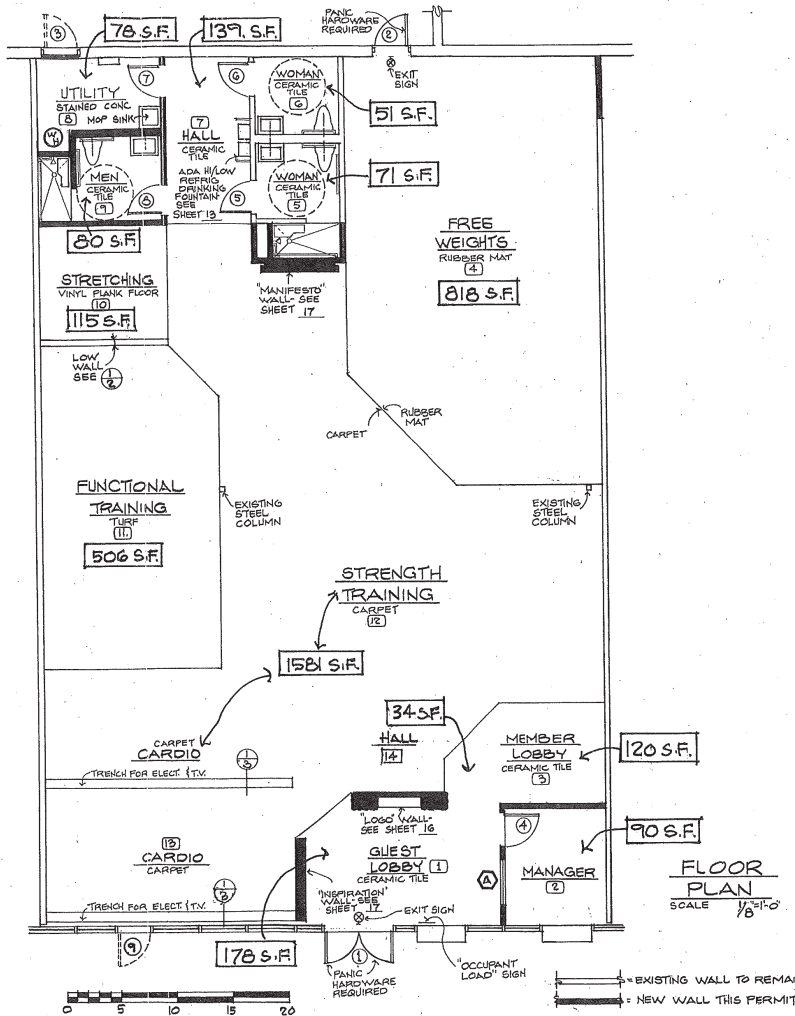





JENNIFER EGGERT | 480.565.3772 (O) | 480.205.7681 (C) | jennifer.eggert@orionprop.com  
 MICHAEL ACHTMAN | 480.887.0597 (O) | 480.694.3453 (C) | michael.achtman@orionprop.com

