

Up to 42,073 square feet of contiguous space

**NOW AVAILABLE!**



# Eureka Mall

800 W. Harris Street, Eureka, CA 95503



- Over 60% of Humboldt County's food sales are at the Eureka Mall WinCo Foods—which does over 35,000 transactions per week.
- Eureka is a unique market featuring high consumer demand with minimal competition.
- \$320 Million dollar tourist industry in Humboldt County
- Education level is higher than the U.S. average
- Excellent mix of co-tenants including:

WinCo  
Dollar Tree  
AutoZone  
Subway

CVS/pharmacy  
Provident Credit Union  
Tri Counties Bank  
State Fund Insurance

Michaels  
Tuesday Morning  
Happy Donuts  
VA Clinic  
Cosmo Prof



1200 W. Harris Street, Eureka, CA 95503  
(707) 268-1800  
(707) 268-1801 Fax

greg.p@piersoncompany.com  
www.piersoncompany.com/Available Space  
www.theeurekamall.com

## Eureka Mall Trade Area

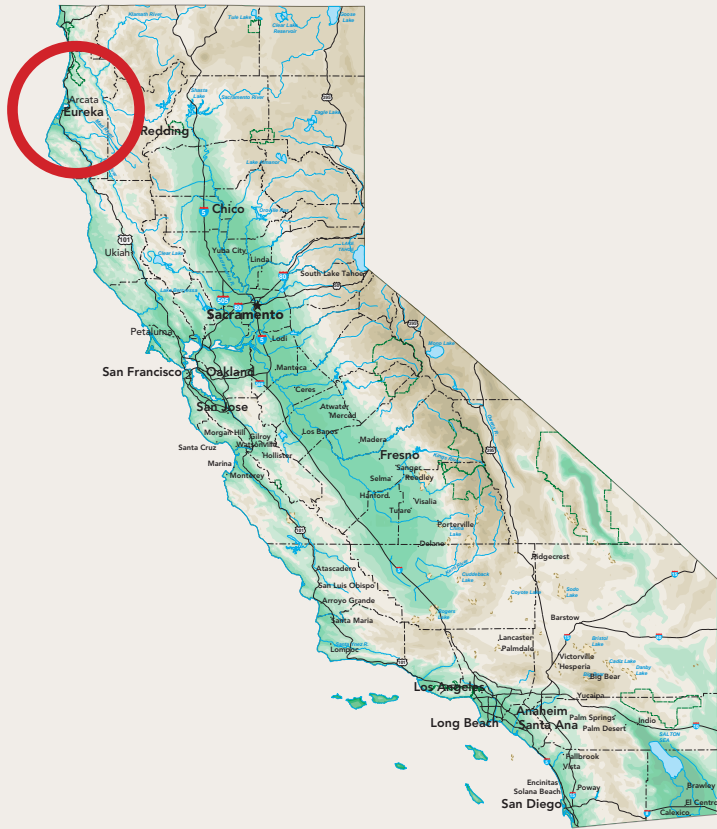

### Traffic Counts (cars per day)

W. Henderson @ Central:	10,050
Central @ Harris:	3,200
W. Harris @ Central:	11,200

### 2016 Demographic Information

#### Household Income:

Trade Area .....	\$59,588
Estimated to increase in the next 5 years to ....	\$65,438

#### Population:

Trade Area .....	105,795
------------------	---------

#### Consumer Spending (Trade Area, Annual):

Grocery & Alcohol (for home consumption) .....	\$387,321,848
Apparel .....	\$200,957,428
Photo, Video, Audio & Computer .....	\$76,206,655



1200 W. Harris Street, Eureka, CA 95503  
 (707) 268-1800  
 (707) 268-1801 Fax

greg.p@piersoncompany.com  
[www.piersoncompany.com/Available Space](http://www.piersoncompany.com/Available Space)  
[www.theeurekamall.com](http://www.theeurekamall.com)

# Eureka Mall

tri counties bank

**WinCo FOODS**

Tuesday Morning  
Everything 50% to 80% Off

**Michaels**  
Where Creativity Happens™

**DOLLAR TREE**

**SUBWAY**

**CVS/pharmacy**  
Expect something extra.™

Department of Veterans Affairs

**AutoZone**



**Broadway Sign.** Sign on US Highway 101 with excellent visibility in both directions

## Bayshore Mall

**Walmart**  
Save money. Live better.

**KOHL'S**  
expect great things

**PETCO**  
Where the pets go.

**Sears**

**BED BATH & BEYOND**  
Beyond any store of its kind.®

**Pier 1 imports**

**ROSS**  
DRESS FOR LESS

**T.J. maxx**

**SPORTS AUTHORITY**

**STAPLES**

**Party City**

**planet fitness**

**ULTA BEAUTY**



City of Eureka

# Up to 42,073 s.f. of contiguous space available!

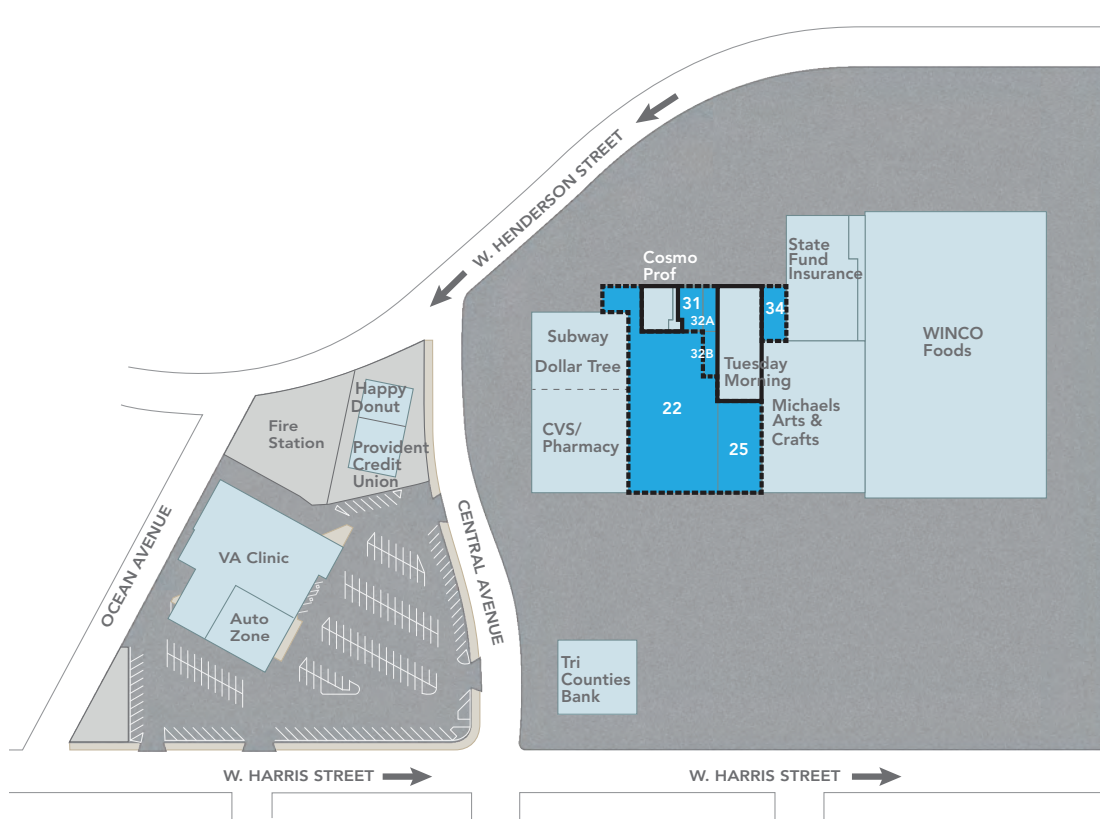
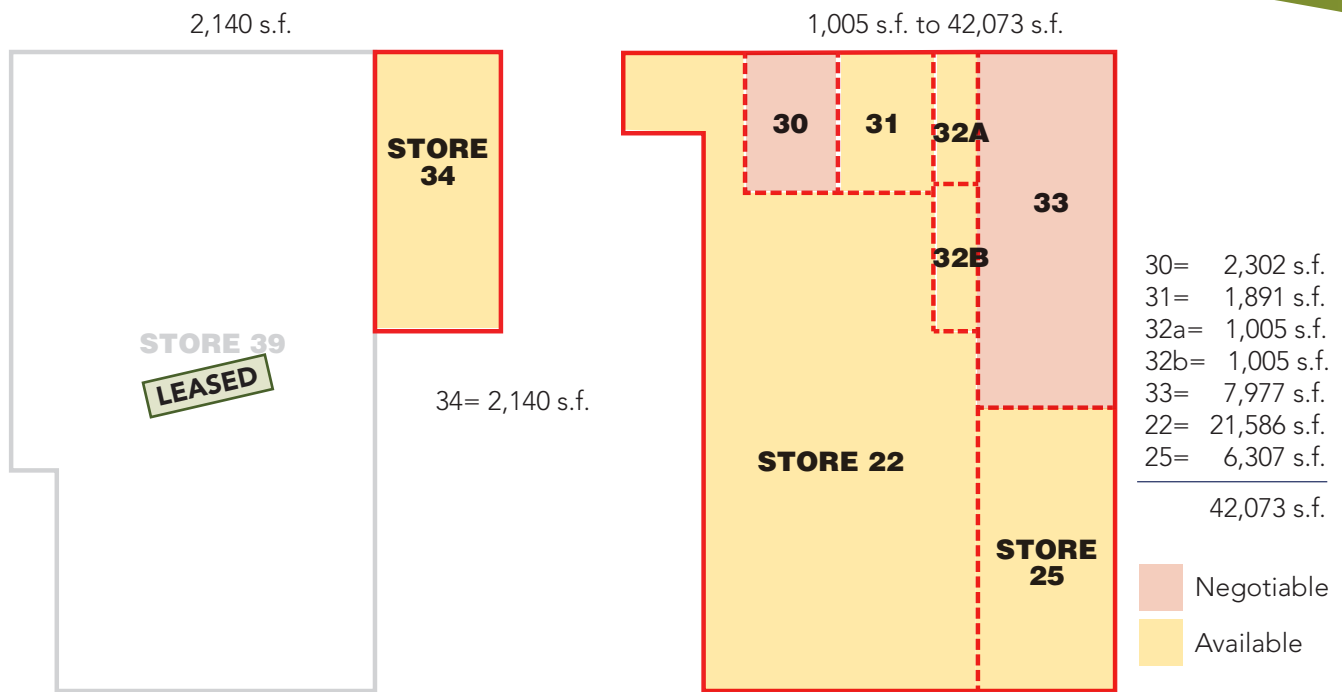

For leasing information call: (707) 268-1800 Ext. 11  
[www.piersoncompany.com/Available Space](http://www.piersoncompany.com/Available Space)  
[www.theeurekamall.com](http://www.theeurekamall.com)

# Eureka Mall

800 W. Harris Street, Eureka, CA 95503



1200 W. Harris Street, Eureka, California 95503  
 Tel. (707) 268-1800 Fax. (707) 268-1801  
 greg.p@piersoncompany.com  
 www.piersoncompany.com/Available Space  
 www.theeurekamall.com





LANDLORD WILL BE REBUILDING THIS SECTION WITH 23,761 S.F. ROOF AND ONLY 4 COLUMNS. ALSO - 19' CLEARANCE BELOW BOTTOM OF BAR JOISTS. DESIGN YOUR FACADE NOW!

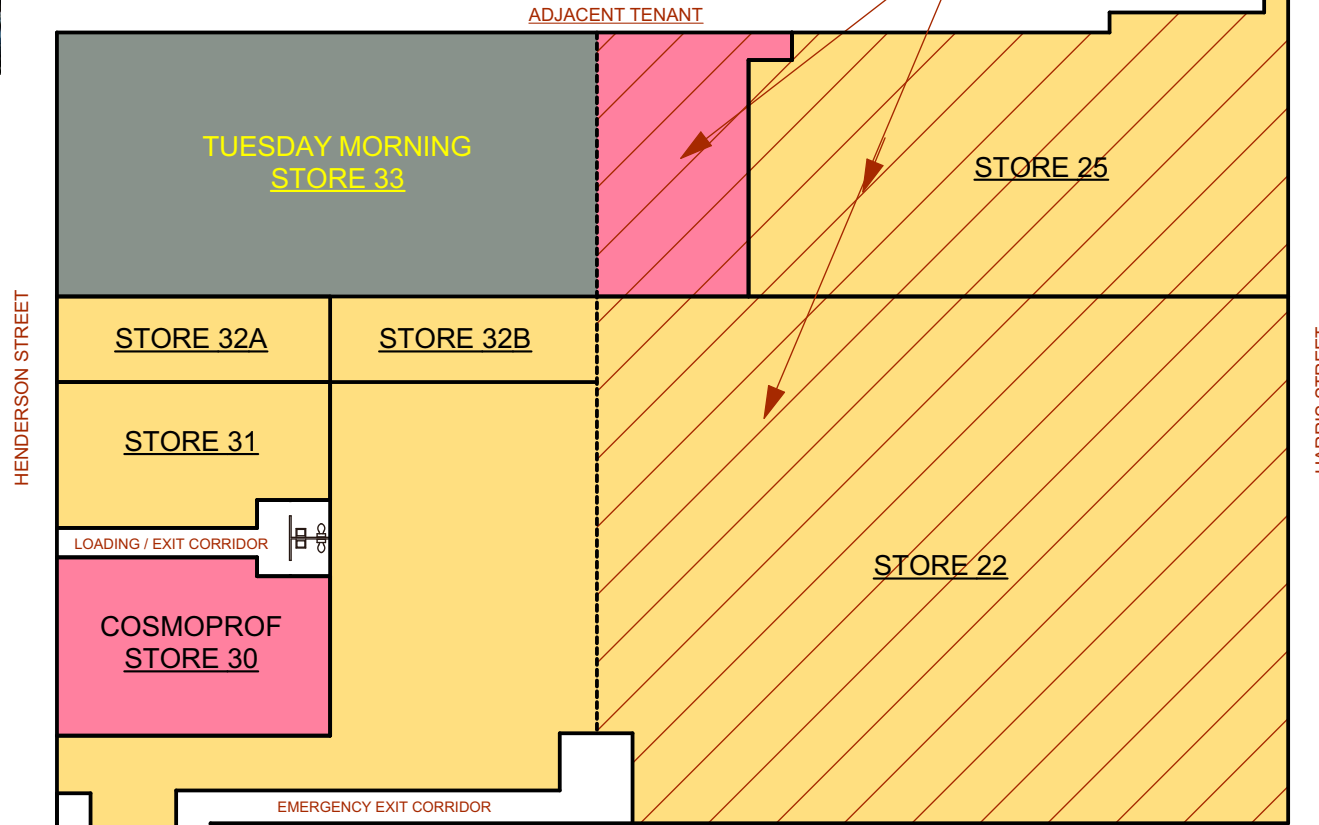
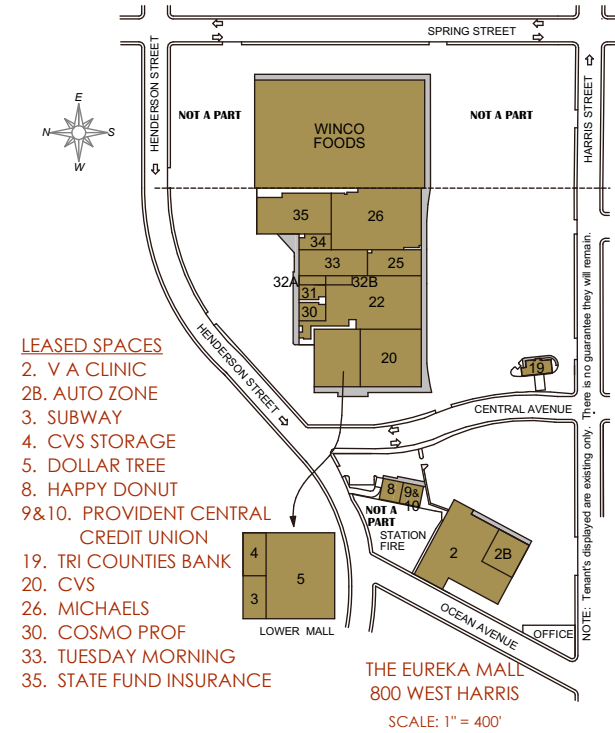

AREA SUMMARY	NET	GROSS	CURRENT CONDITION
STORE 22.....	21,347 S.F.	21,586 S.F.	STORE 22: Vacant
STORE 25.....	6,203 S.F.	6,307 S.F.	STORE 25: Vacant
STORE 30.....	2,258 S.F.	2,302 S.F.	STORE 30: Negotiable (Relocation Possible)
STORE 31.....	1,852 S.F.	1,891 S.F.	STORE 31: Vacant
STORE 32A.....	966 S.F.	1,005 S.F.	STORE 32A: Unfinished, Storage
STORE 32B.....	966 S.F.	1,005 S.F.	STORE 32B: Unfinished, Storage
STORE 33.....	7,860 S.F.	7,977 S.F.	STORE 33: Negotiable (Relocation Possible)
<b>TOTAL.....</b>	<b>41,452 S.F.</b>	<b>42,073 S.F.</b>	

1200 West Harris St.  
Eureka, CA 95501

T: (707) 268-1800  
www.piersoncompany.com

800 West Harris St.  
Eureka, CA 95501