

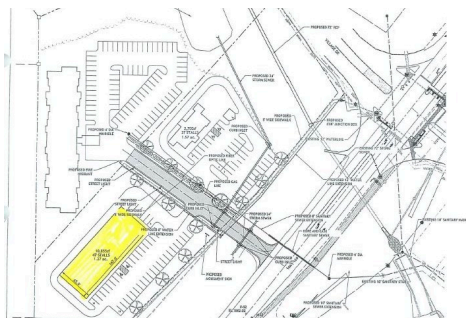

4720 ROCHESTER RD.

ST. JOSEPH, MO

PHASE II



PROPERTY FEATURES

Phase II, Tuscany Village - Spring 2025

- #1 - 10,788 SF - Similar to Phase I - See above photo**
- #2 - Household Income within 1 mile - \$103,000**
- #3 - 4120 people, 1700 households within 1 mile**
- #4 - 152,981 people, 61,019 households within 30 miles**
- #5 - Household income within 30 miles - \$81,025**
- #6 - Adjoining Retail at Shoppes at North Village of 1.3 million SF**
- #7 -- Adjoining future residential development land of 199 acres**
- #8 - AADT OF 40,000 on I-29, 11,000 on US 169 Hwy**
- #9 - NW Corner of US HWY 169 & N Village Drive**

Tenants in Phase I are Hotworx, Daisy Nail & Spa, Oasis Face Bar, Swing 365, and KC Roasters Coffee. Hundreds of residential rooftops in area subdivisions including Greystone, Lake at 12 Oaks, Carriage Oaks, Wilshire Place, and Northridge.



Raymond Sisson

Director of Commercial Services

816-390-7478

ray@raysisson.net

www.raysisson.net

MO Lic #: 1999020688, KS Lic #: BR00003466

**BERKSHIRE
HATHAWAY**
HOMESERVICES

STEIN & SUMMERS
REAL ESTATE
COMMERCIAL

MO Lic #: 1999020688, KS Lic #: BR00003466
1007 E. St. Maartens Dr. Saint Joseph, MO 64506

©2024 BHH Affiliates, LLC. Real Estate Brokerage Services are offered through the network member franchisees of BHH Affiliates, LLC. Most franchisees are independently owned and operated. Berkshire Hathaway HomeServices and the Berkshire Hathaway HomeServices symbol are registered service marks of Columbia Insurance Company, a Berkshire Hathaway affiliate. Information not verified or guaranteed. If your property is currently listed with a Broker, this is not intended as a solicitation. Equal Housing Opportunity.

4720 Rochester Rd., Saint Joseph, MO 64506