

# TCR Ranch

13661 E HIGHWAY 90, KINGSBURY, TX 78638

# FOR SALE

155 acres + Residence



## PROPERTY DESCRIPTION

155± acres in Kingsbury offering a rare blend of luxury ranch living and prime development potential. For investors and developers, a conceptual plan with 7 lots (12-30 acres) has been created for potential subdivision options - smaller tracts could be suitable for ranchette-style residential development or mixed-use opportunities. Hwy 90 frontage provides visibility and access for potential future commercial sites, while interior tracts offer privacy and strong end-user appeal. Property may be purchased as a whole or with subdivision options - contact broker for more information and individual pricing.

The property features a 4,000± SF custom home with separate guest suites, a resort-style pool, a 3,000± SF barn/storage building with small apartment, plus an additional mobile home on the east side of the ranch. Rolling terrain, mature trees, and long-range views create an exceptional setting for personal use, income-producing venue, or future development opportunities.

## OFFERING SUMMARY

Sale Price:	\$5,600,000
Lot Size:	155 acres

## PROPERTY HIGHLIGHTS

- Offered as a whole or with subdivision options
- 155+ ac in Kingsbury Tx
- 4,000± SF main home with separate guest suites
- Resort-style pool and outdoor living areas
- 3,000± SF barn/storage building with small apartment
- Additional mobile home on east side of ranch
- Rolling terrain, mature trees, and expansive views
- Concept plan for 7 tracts (12-30 acres)
- Residential and commercial development potential along US Hwy 90



**Mark Haynie**  
BROKER  
830.481.9533  
mark.haynie@sperrycga.com  
TX #644160

Each office independently owned and operated.

We obtained the information above from sources we believe to be reliable. However, we have not verified its accuracy and make no guarantee, warranty or representation about it. It is submitted subject to the possibility of errors, omissions, change of price, rental or other conditions, prior sale, lease or financing, or withdrawal without notice. We include projections, opinions, assumptions or estimates for example only, and they may not represent current or future performance of the property. You and your tax and legal advisors should conduct your own investigation of the property and transaction.

# TCR Ranch

13661 E HIGHWAY 90, KINGSBURY, TX 78638

# FOR SALE

Ranch

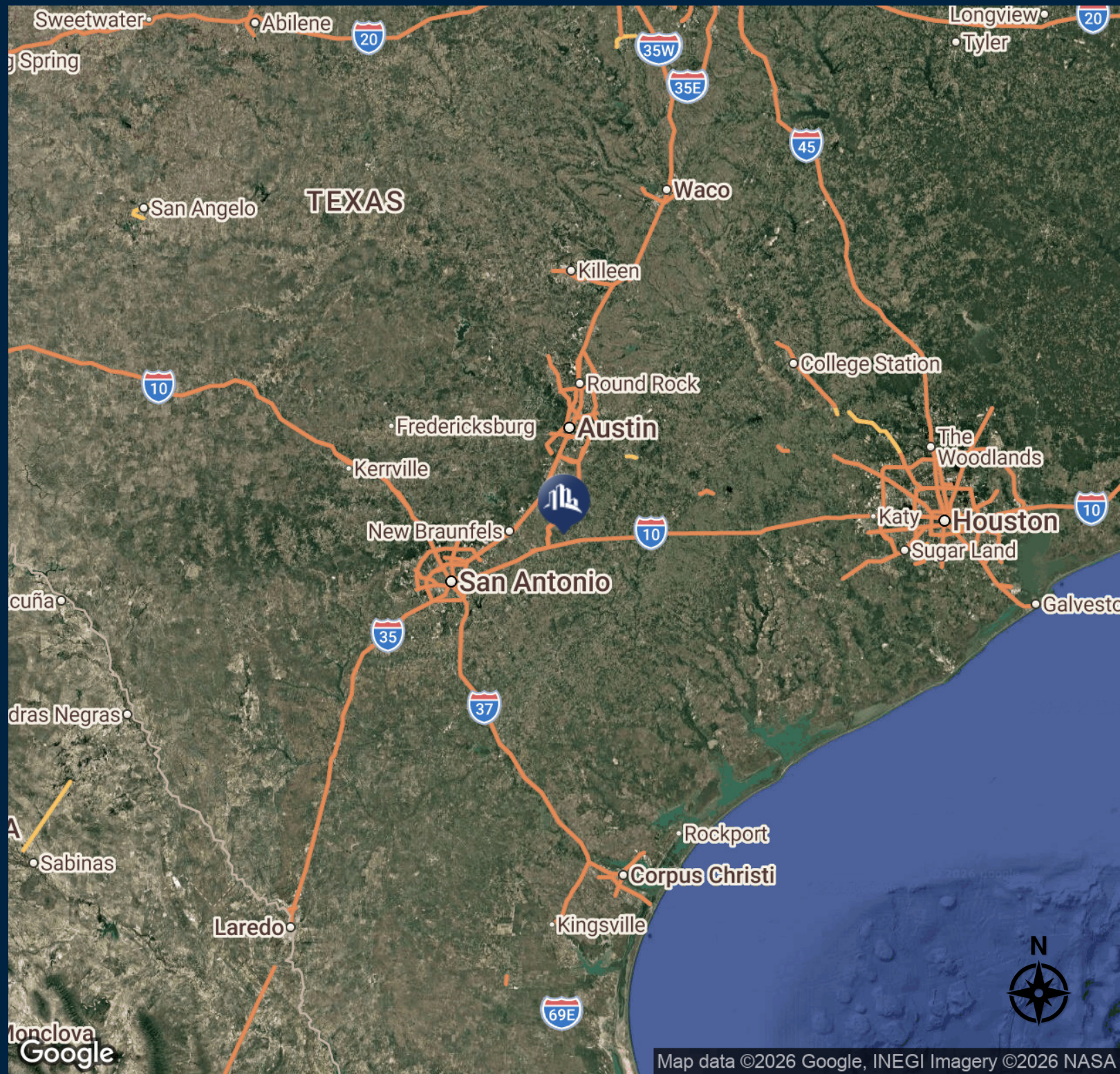

Map data ©2026 Google, INEGI Imagery ©2026 NASA



**Mark Haynie**  
BROKER  
830.481.9533  
mark.haynie@sperrycga.com  
TX #644160

Each office independently owned and operated.

We obtained the information above from sources we believe to be reliable. However, we have not verified its accuracy and make no guarantee, warranty or representation about it. It is submitted subject to the possibility of errors, omissions, change of price, rental or other conditions, prior sale, lease or financing, or withdrawal without notice. We include projections, opinions, assumptions or estimates for example only, and they may not represent current or future performance of the property. You and your tax and legal advisors should conduct your own investigation of the property and transaction.

[www.SperryCGA.com](http://www.SperryCGA.com)

# TCR Ranch

13661 E HIGHWAY 90, KINGSBURY, TX 78638

# FOR SALE

Ranch

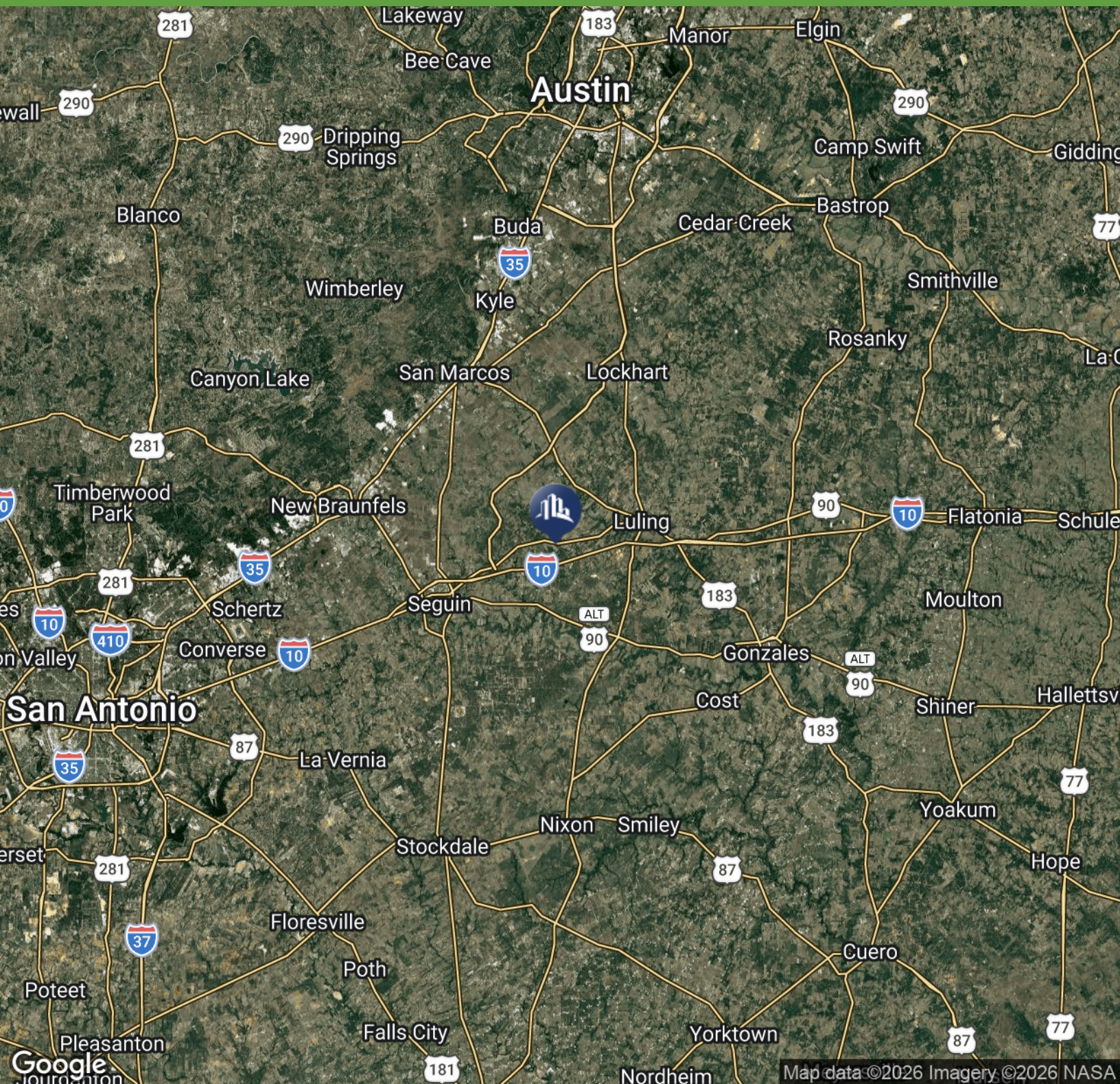

**Mark Haynie**  
BROKER  
830.481.9533  
mark.haynie@sperrycga.com  
TX #644160

Each office independently owned and operated.

We obtained the information above from sources we believe to be reliable. However, we have not verified its accuracy and make no guarantee, warranty or representation about it. It is submitted subject to the possibility of errors, omissions, change of price, rental or other conditions, prior sale, lease or financing, or withdrawal without notice. We include projections, opinions, assumptions or estimates for example only, and they may not represent current or future performance of the property. You and your tax and legal advisors should conduct your own investigation of the property and transaction.

# TCR Ranch

13661 E HIGHWAY 90, KINGSBURY, TX 78638

# FOR SALE

Ranch

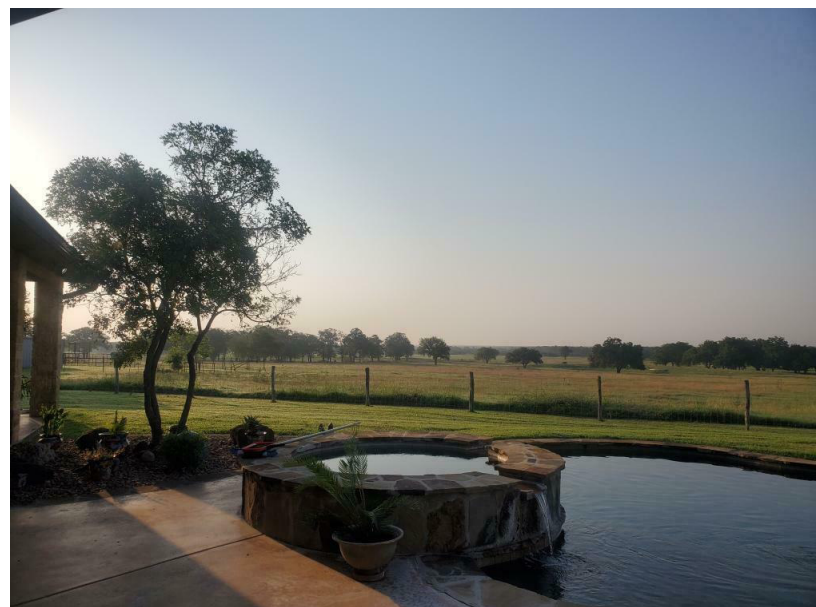
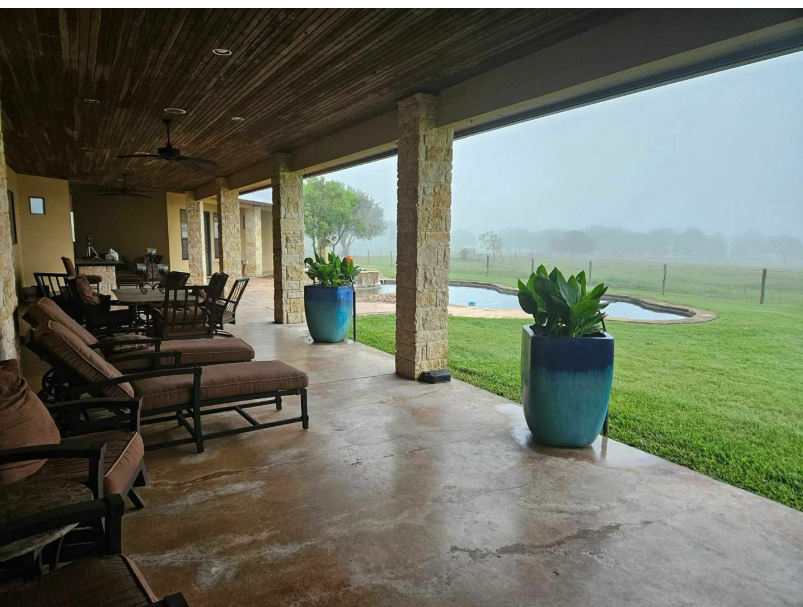

**Mark Haynie**  
BROKER  
830.481.9533  
mark.haynie@sperrycga.com  
TX #644160

Each office independently owned and operated.

We obtained the information above from sources we believe to be reliable. However, we have not verified its accuracy and make no guarantee, warranty or representation about it. It is submitted subject to the possibility of errors, omissions, change of price, rental or other conditions, prior sale, lease or financing, or withdrawal without notice. We include projections, opinions, assumptions or estimates for example only, and they may not represent current or future performance of the property. You and your tax and legal advisors should conduct your own investigation of the property and transaction.

[www.SperryCGA.com](http://www.SperryCGA.com)

# TCR Ranch

13661 E HIGHWAY 90, KINGSBURY, TX 78638

# FOR SALE

Ranch

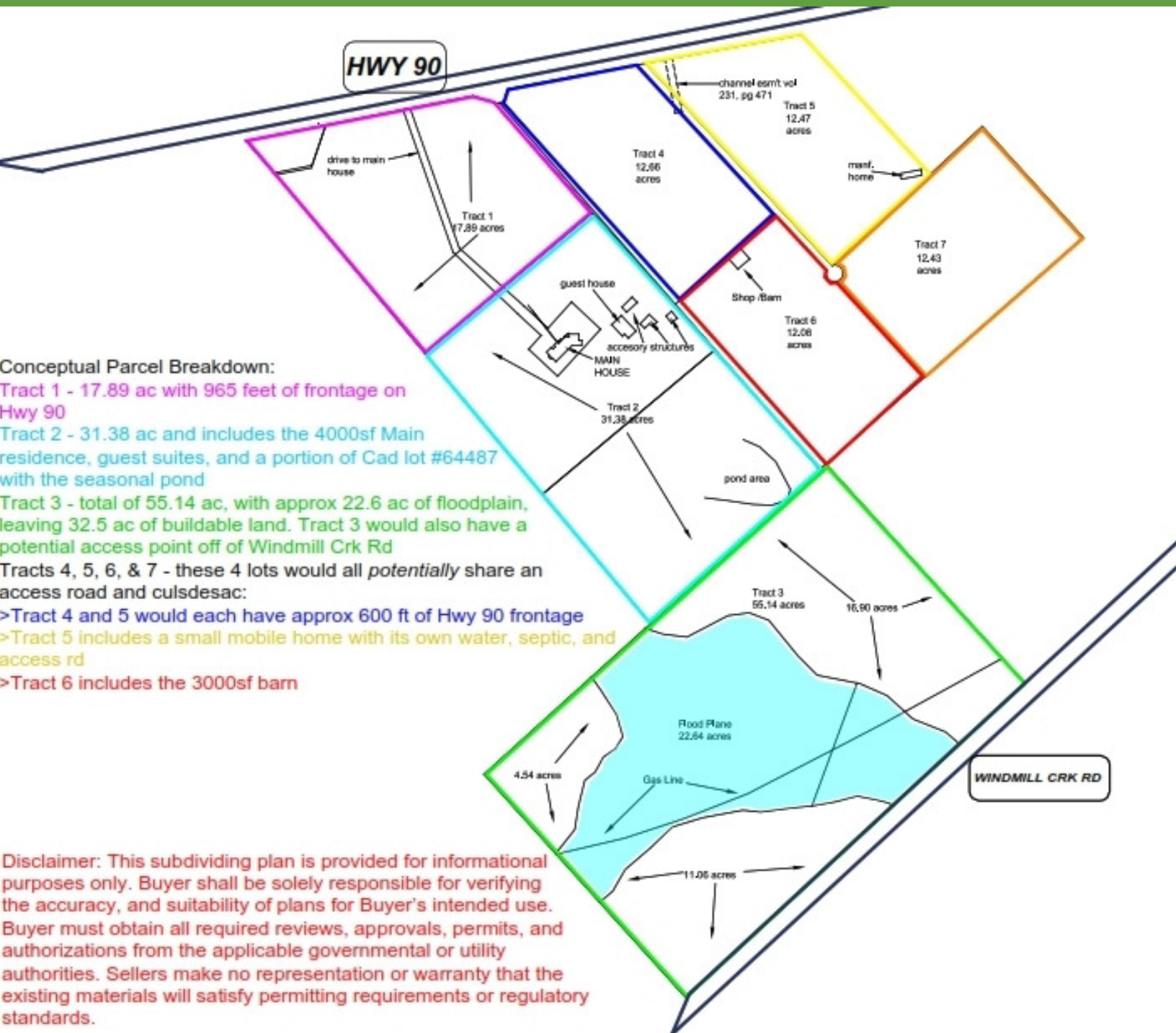

**Mark Haynie**  
BROKER  
830.481.9533  
mark.haynie@sperrycga.com  
TX #644160

Each office independently owned and operated.

We obtained the information above from sources we believe to be reliable. However, we have not verified its accuracy and make no guarantee, warranty or representation about it. It is submitted subject to the possibility of errors, omissions, change of price, rental or other conditions, prior sale, lease or financing, or withdrawal without notice. We include projections, opinions, assumptions or estimates for example only, and they may not represent current or future performance of the property. You and your tax and legal advisors should conduct your own investigation of the property and transaction.

You can choose a new flood map or move the location pin by selecting a different location on the locator map below or by entering a [Go To NFHL Viewer »](#) new location in the search field above. It may take a minute or more during peak hours to generate a dynamic FIRMette.



<p><b>PIN</b></p> <ul style="list-style-type: none"> <li> Approximate location based on user input and does not represent an authoritative property location</li> </ul>	<p><b>SPECIAL FLOOD HAZARD AREAS</b></p> <ul style="list-style-type: none"> <li> Without Base Flood Elevation (BFE) Zone A, V, A99</li> <li> With BFE or Depth</li> <li> Regulatory Floodway Zone AE, AD, AH, VE, AR</li> </ul>	<p><b>OTHER AREAS OF FLOOD HAZARD</b></p> <ul style="list-style-type: none"> <li> 0.2% Annual Chance Flood Hazard, Areas of 1% annual chance flood with average depth less than one foot or with drainage areas of less than one square mile Zone X</li> <li> Future Conditions 1% Annual Chance Flood Hazard Zone X</li> <li> Area with Reduced Flood Risk due to Levee. See Notes. Zone X</li> <li> Area with Flood Risk due to Levee Zone D</li> </ul>	<p><b>OTHER FEATURES</b></p> <ul style="list-style-type: none"> <li> <b>20.2</b> Cross Sections with 1% Annual Chance</li> <li> <b>17.5</b> Water Surface Elevation</li> <li> Coastal Transect</li> <li> Base Flood Elevation Line (BFE)</li> <li> Limit of Study</li> <li> Jurisdiction Boundary</li> <li> Coastal Transect Baseline</li> <li> Profile Baseline</li> <li> Hydrographic Feature</li> </ul>
<p><b>MAP PANELS</b></p> <ul style="list-style-type: none"> <li> Selected FloodMap Boundary</li> <li> Digital Data Available</li> <li> No Digital Data Available</li> <li> Unmapped</li> </ul>	<p><b>OTHER AREAS</b></p> <ul style="list-style-type: none"> <li> <b>NO SCREEN</b> Area of Minimal Flood Hazard Zone X</li> <li> Effective LOMRs</li> <li> Area of Undetermined Flood Hazard Zone D</li> <li> Otherwise Protected Area</li> <li> Coastal Barrier Resource System Area</li> </ul>	<p><b>GENERAL STRUCTURES</b></p> <ul style="list-style-type: none"> <li> Channel, Culvert, or Storm Sewer</li> <li> Levee, Dike, or Floodwall</li> </ul>	