



FOR LEASE

LONG STREET LOFTS

2744 SE LONG STREET, PORTLAND, OR 97202

LEASE RATE

\$1.85 SF/month (Gross)

AVAILABLE SF

2,550 SF

ROD BROKENSHERE

503.972.7281

rod@macadamforbes.com



PROPERTY DESCRIPTION

New industrial loft available in Southeast Portland's Brooklyn Neighborhood. The building was completed in 2023.

LOCATION DESCRIPTION

The Brooklyn neighborhood offers a mix of everything. The residential portion is complete with numerous shops, bars, and restaurants. The industrial portion includes the Brooklyn Intermodal Rail Yard and is home to TriMet.

PROPERTY HIGHLIGHTS

- Clear height ranges from 16' to 25'
- Grade doors are 14' x 14'
- Dock door is 10' x 10'
- Energy efficient all-electric construction with 200 amps, 480 volt, three-phase, and 200 amps, 120/240 volt, single-phase

OFFERING SUMMARY

Lease Rate:	\$1.85 SF/month (Gross)
Available SF:	2,550 SF
Building Size:	11,650 SF

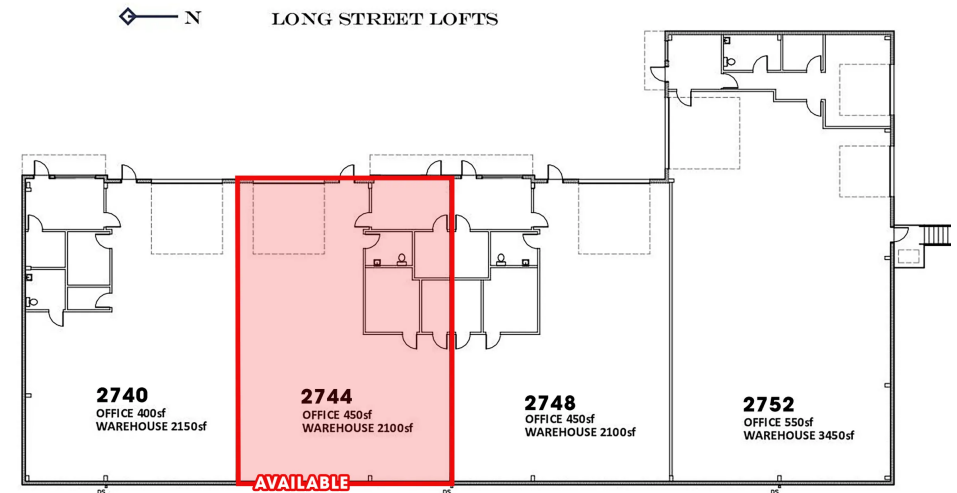

ROD BROKENSHIRE

503.972.7281 | rod@macadamforbes.com