

3421 Olympia Dr

Raleigh, NC 27603

OFFICE **FOR LEASE**

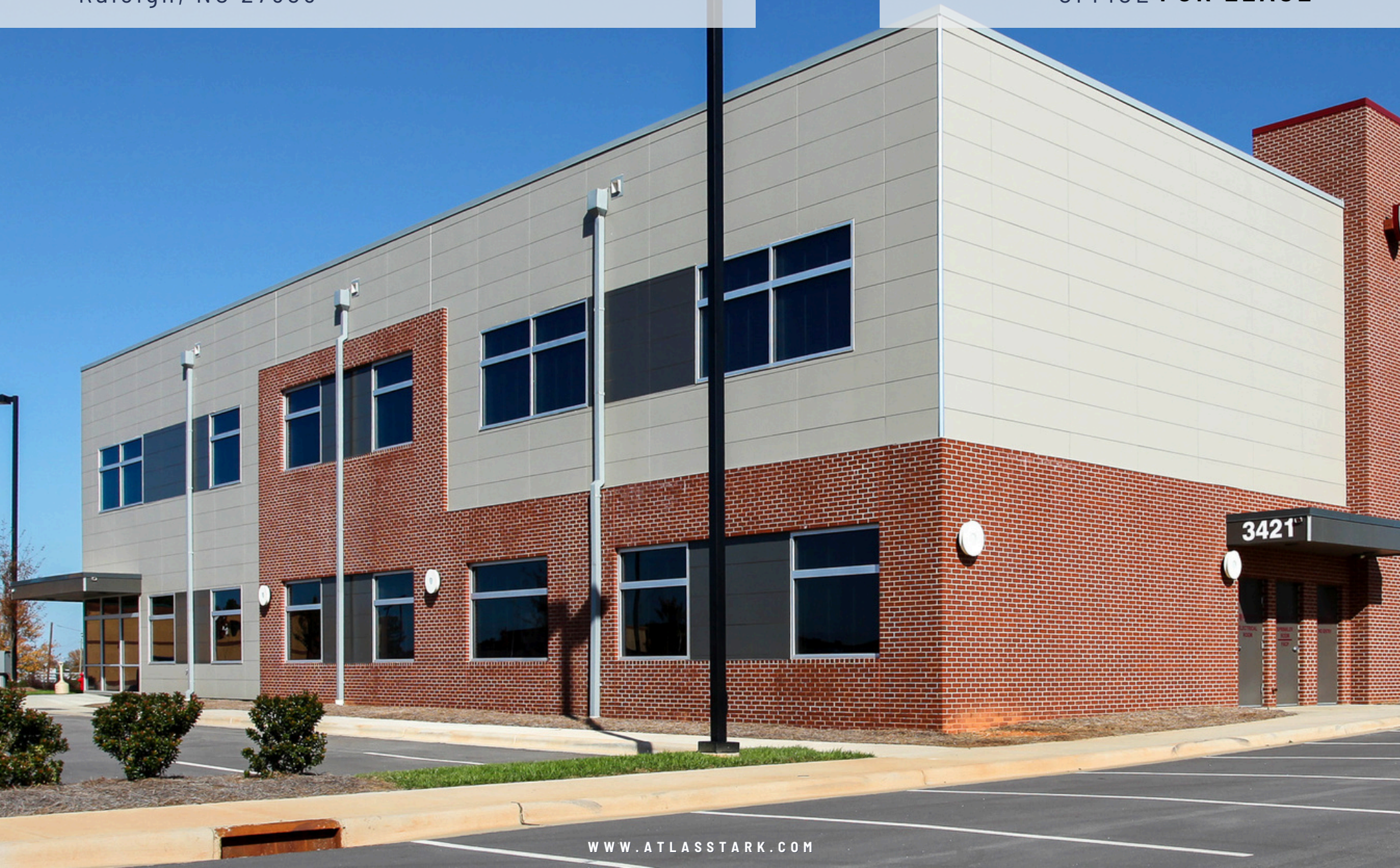



PROPERTY SUMMARY

RATE	\$35/SF NNN
ADDRESS	3421 Olympia Dr
SUITE	100
AREA SF	8,750 SF
AVAILABLE	Now

HIGHLIGHTS

- Modern open-concept office suite with flexible layout
- Potential to subdivide
- Prime South Raleigh location just off Fayetteville Road
- Surrounded by established medical, dental, and educational tenants
- Adjacent to Altitude Raleigh Apartments and nearby retail amenities
- Easy access to downtown Raleigh and major highways
- Ample surface parking for staff and clients

FLOORPLAN

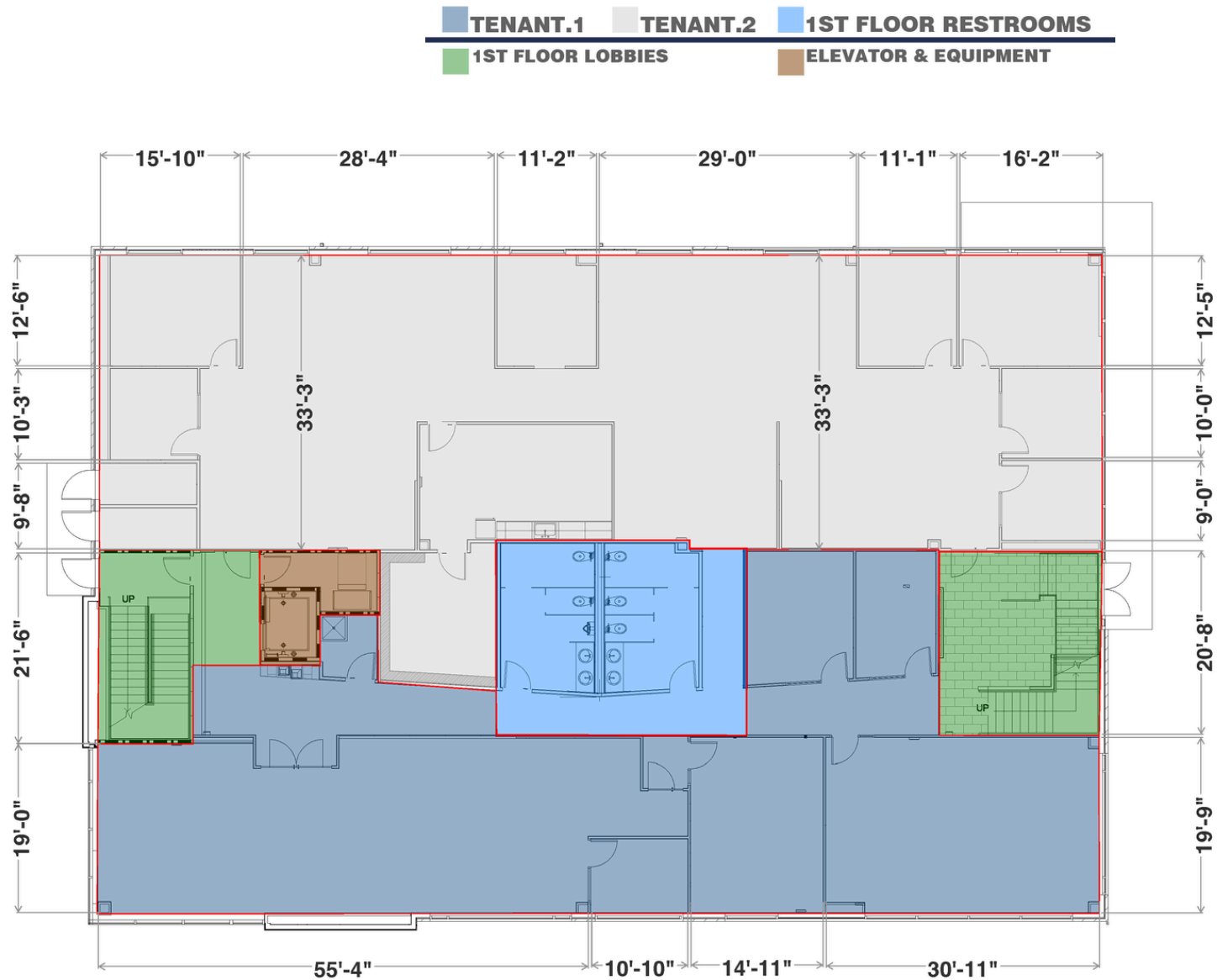



NEIGHBORHOOD OVERVIEW

DOWNTOWN RALEIGH

STATE FARMERS MARKET

RENAISSANCE PARK

NEW RESIDENTIAL DEVELOPMENT

- 881 HOUSING UNITS
- MASTER-PLANNED DEVELOPMENT

DOWNTOWN SOUTH

COMING SOON

- 140 ACRES
- MIXED-USE DEVELOPMENT
- 3 MILLION SQ FT OF OFFICE IN TOTAL PROJECT PLAN
- 240,000 SQ FT OF RETAIL IN TOTAL PROJECT PLAN

SITE

Fayetteville Rd

CONTACT

Trent Ragland

Broker

M: 919.815.8414

tragland@atlasstark.com

Tyler Christensen

Broker

M: 828.999.9459

tchristensen@atlasstark.com



Atlas Stark Holdings LLC

2020 Progress Ct, Suite 130A, Raleigh, NC

