

FREESTANDING RETAIL **OPPORTUNITY**

Renovated Single/Dual Retail Asset in Prime Culver City Corridor



Copyright © Lee & Associates. All rights reserved. No part of this work may be reproduced or distributed without written permission of the copyright owner. The information contained in this report was gathered by Lee & Associates from sources believed to be reliable. Lee & Associates, however, makes no representation concerning the accuracy or completeness of such information and expressly disclaims any responsibility for any inaccuracy contained herein.



LEE & ASSOCIATES
COMMERCIAL REAL ESTATE SERVICES

MAXIMILLIAN CESENA ROBLES

Senior Associate | DRE LIC 02057317

e || mrobles@leelalb.com

p || 949.244.2200

Lee & Associates Los Angeles - Long Beach Inc. || DRE License 01069854 || 5000 E Spring St., Suite 600, Long Beach, CA 90815

CONNECT WITH US ON OUR SOCIALS!

 @leeassociateslab

 @leeassociateslab

 @LeeAssociatesLA

 www.lee-associates.com





PROPERTY OVERVIEW

Lee & Associates is pleased to present 11018 Washington Boulevard, a freestanding retail property located in the highly desirable Culver City submarket of Los Angeles. This irreplaceable asset is positioned within one of Southern California's most dynamic and sought-after neighborhoods. The property features approximately ±3,595 square feet of building situated on ±4,491 square feet of land, offering excellent street exposure with roughly 60 feet of frontage along Washington Boulevard. Originally constructed in 1947, the premise was fully renovated in 2023, with benefits from a fresh exterior and strong visual presence along one of Culver City's most active retail corridors.

The asset is currently configured as a single-tenant retail building, making it well suited for an owner-user or investor seeking a foothold in a dense and affluent West Los Angeles market. With a walk score of 87 and bike score of 80, the location benefits from strong vehicle traffic, excellent connectivity to surrounding neighborhoods, and close proximity to major employment centers throughout Culver City and the greater West Los Angeles area.

Centrally located just minutes from Downtown Culver City, the property is surrounded by a diverse mix of established retailers, restaurants, and major tech/media and entertainment employers. Nearby tenants and companies include NFL Network, Sony Pictures, Trader Joe's, Erewhon, Sephora, Mendocino Farms, Laurel Grill, Apple, Amazon Studios, HBO, The Culver Hotel along with many others. The area continues to experience significant growth, highlighted by Apple's new 550,000-square-foot office campus and Apple TV headquarters, along with thousands of new multifamily units currently under construction/recently completed.

OFFERING SUMMARY

Property Address	11018 Washington Blvd, Culver City, CA 90232
Property Type	Freestanding Retail
Building Size	±3,595 SF
Land Area	±4,491 SF (±0.10 AC)
Zoning	CG - Commercial General
Year Built Renovated	1947 2023
Tenancy	Single Tenant
Frontage	±60 FT on Washington Blvd
APN	4213-008-020
Walk Score	87
Bike Score	80

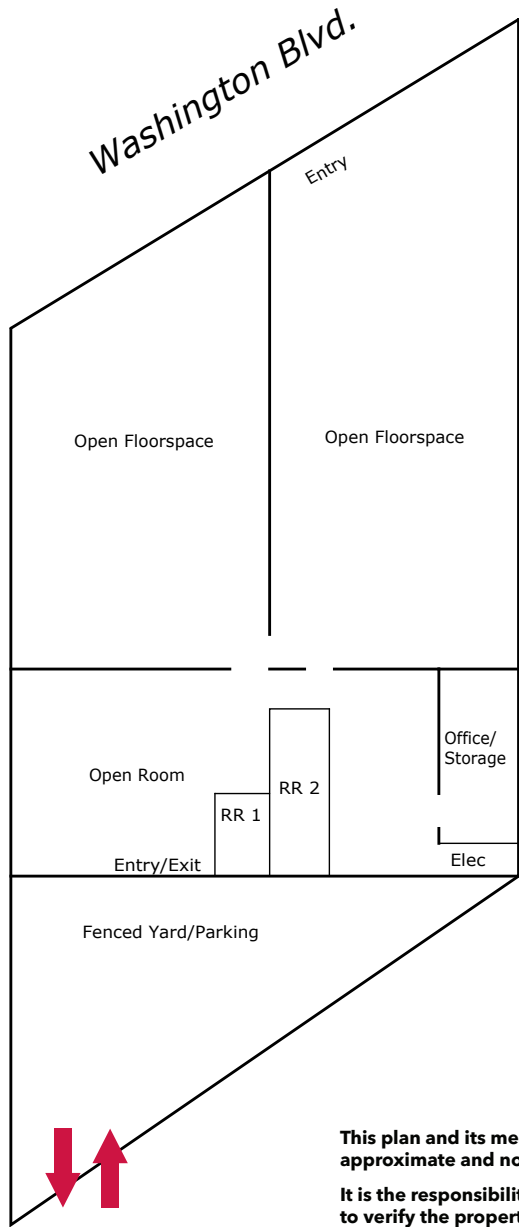

This plan and its measurements are approximate and not up to scale. It is the responsibility of the buyer/lessor to verify the property's measurements independently.









FREESTANDING RETAIL **OPPORTUNITY**

Renovated Single/Dual Retail Asset in Prime Culver City Corridor

11018 WASHINGTON BLVD | CULVER CITY, CA 90232



BRAVE STAR

SALES & SERVICE

DENIM & WORKWEAR

LOCAL EXPERTISE. INTERNATIONAL REACH. WORLD CLASS.



Maximillian Cesena Robles

Senior Associate | DRE LIC 02057317
mrobles@leelalb.com
(949) 244-2200

CONNECT WITH US ON OUR SOCIALS!

