



INDUSTRIAL PROPERTY // FOR LEASE

3,107 SF INDUSTRIAL SPACE AVAILABLE AT KELLY/GROESBECK TECH CENTER

33755 - 33789 GROESBECK HWY

FRASER, MI 48026



- Unit 33773: 3,107 SF Industrial Unit w/300 SF Office
- 18" Clear Height
- One (1) 12' x 14; Overhead Door
- Groesbeck frontage
- 200 AMP | 220 Volt
- Minutes from I-94 and I-696
- Unit located in the rear of complex



P.A. COMMERCIAL
Corporate & Investment Real Estate

We obtained the information above from sources we believe to be reliable. However, we have not verified its accuracy and make no guarantee, warranty or representation about it. It is submitted subject to the possibility of errors, omissions, change of price, rental or other conditions, prior sale, lease or financing, or withdrawal without notice. We include projections, opinions, assumptions or estimates for example only, and they may not represent current, past or future performance of the property. You and your tax and legal advisors should conduct your own investigation of the property and transaction.

26555 Evergreen Road, Suite 1500
Southfield, MI 48076
248.358.0100
pacommercial.com

33755 - 33789 GROESBECK HWY, FRASER, MI 48026 // FOR LEASE

EXECUTIVE SUMMARY



Lease Rate

**\$10.25 SF/YR
(GROSS)**

OFFERING SUMMARY

Building Size:	55,960 SF
Available SF:	3,107 - 6,214 SF
Lot Size:	3.17 Acres
Year Built:	1988
Renovated:	2023
Zoning:	Light Industrial
Market:	Detroit
Submarket:	Groesbeck Central Ind

PROPERTY OVERVIEW

Unit 33773: 3,107 SF industrial unit with 300 SF office with 18' clear height, one (1) 12' x 14' overhead door, and 200 AMP / 220 Volt. Ideal uses include warehouse and manufacturing; located at Kelly Rd and Groesbeck Hwy, close to I-696 & I-94. An attractive low gross lease rate includes taxes, insurance, snow removal, and landscaping.

LOCATION OVERVIEW

Located on the Northwest corner of Groesbeck and Kelly Rd in an industrial/retail area. Close to I-94 and I-696 expressway.

PROPERTY HIGHLIGHTS

- Unit 33773: 3,107 SF Industrial Unit w/300 SF Office
- 18' Clear Height
- One (1) 12' x 14' Overhead Door
- 200 Amp | 220 Volt
- Groesbeck Frontage
- Unit is located in the rear of the complex



P.A. COMMERCIAL
Corporate & Investment Real Estate

We obtained the information above from sources we believe to be reliable. However, we have not verified its accuracy and make no guarantee, warranty or representation about it. It is submitted subject to the possibility of errors, omissions, change of price, rental or other conditions, prior sale, lease or financing, or withdrawal without notice. We include projections, opinions, assumptions or estimates for example only, and they may not represent current, past or future performance of the property. You and your tax and legal advisors should conduct your own investigation of the property and transaction.

John T. Arthurs PRINCIPAL
D: 248.663.0506 | **C:** 248.563.3225
johna@pacommercial.com

33755 - 33789 GROESBECK HWY, FRASER, MI 48026 // FOR LEASE

LEASE SPACES



LEASE INFORMATION

Lease Type:	Gross	Lease Term:	Negotiable
Total Space:	3,107 SF	Lease Rate:	\$10.25 SF/yr

AVAILABLE SPACES

SUITE	TENANT	SIZE (SF)	LEASE TYPE	LEASE RATE	DESCRIPTION
33773 Groesbeck Hwy	Available	3,107 SF	Gross	\$10.25 SF/yr	Industrial Unit

33755 - 33789 GROESBECK HWY, FRASER, MI 48026 // FOR LEASE

INDUSTRIAL DETAILS

Property Type:	Industrial
Building Size:	55,960 SF
Space Available:	3,107 SF
Shop SF:	2,807 SF
Office SF:	300 SF
Mezzanine:	300 SF
Occupancy:	Immediate
Zoning:	Light Industrial
Parking Spaces:	4
Fenced Yard:	No
Trailer Parking:	No
Year Built / Renovated:	1989 / 2024
Construction Type:	Block
Clear Height:	18'
Overhead Doors:	One (1) 12 x 14
Truckwells/Docks:	None
Cranes:	None
Column Spacing:	40'
Power:	200 AMP 220 Volt
Buss Duct:	No
Air Conditioning:	Office Only
Heat Type:	Gas Unit
Lighting:	Fluorescent
Sprinklers:	Yes
Floor Drains:	No
Taxes:	Landlord Pays



P.A. COMMERCIAL
Corporate & Investment Real Estate

We obtained the information above from sources we believe to be reliable. However, we have not verified its accuracy and make no guarantee, warranty or representation about it. It is submitted subject to the possibility of errors, omissions, change of price, rental or other conditions, prior sale, lease or financing, or withdrawal without notice. We include projections, opinions, assumptions or estimates for example only, and they may not represent current, past or future performance of the property. You and your tax and legal advisors should conduct your own investigation of the property and transaction.

John T. Arthurs PRINCIPAL
D: 248.663.0506 | C: 248.563.3225
johna@pacommercial.com

33755 - 33789 GROESBECK HWY, FRASER, MI 48026 // FOR LEASE

ADDITIONAL PHOTOS



33755 - 33789 GROESBECK HWY, FRASER, MI 48026 // FOR LEASE

FLOOR PLANS

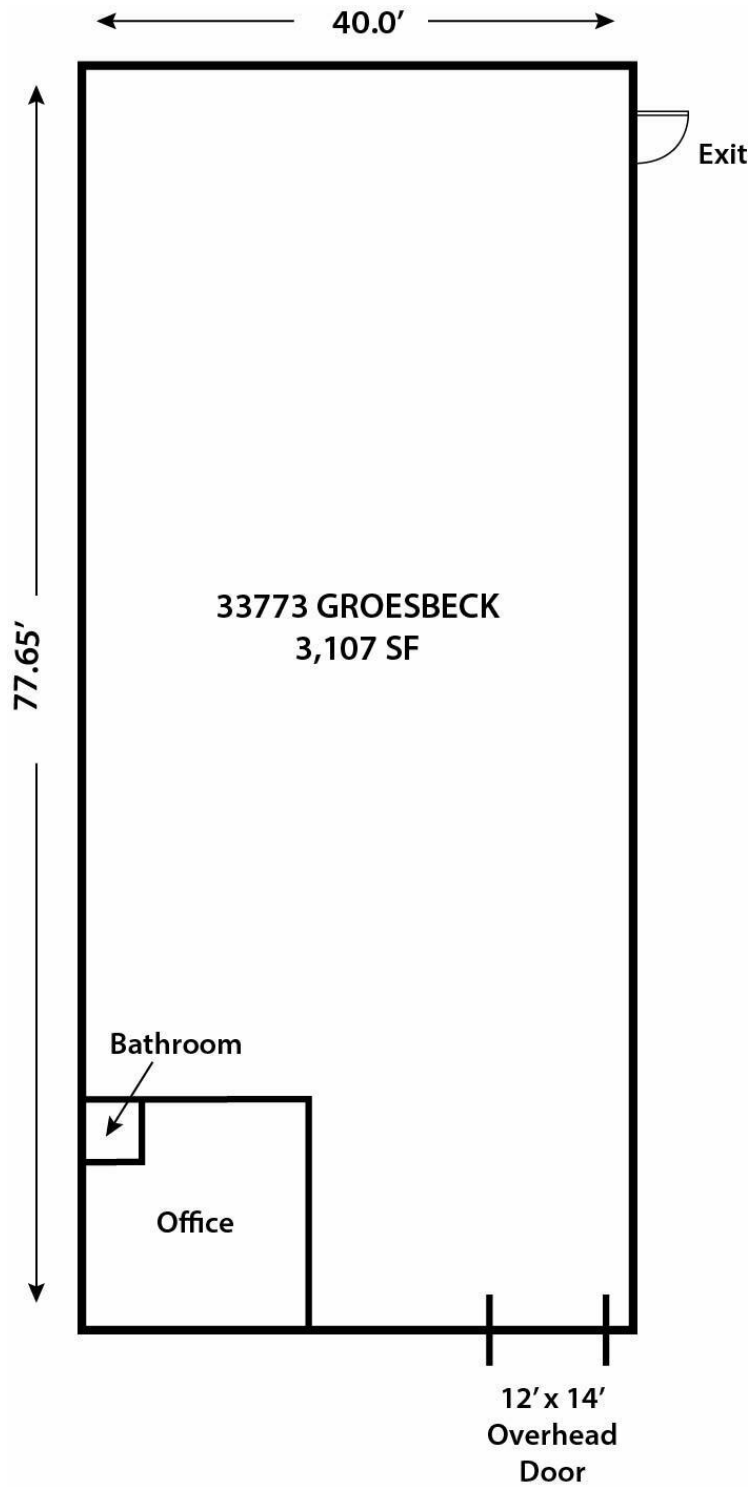

Unit 33773



P.A. COMMERCIAL
Corporate & Investment Real Estate

We obtained the information above from sources we believe to be reliable. However, we have not verified its accuracy and make no guarantee, warranty or representation about it. It is submitted subject to the possibility of errors, omissions, change of price, rental or other conditions, prior sale, lease or financing, or withdrawal without notice. We include projections, opinions, assumptions or estimates for example only, and they may not represent current, past or future performance of the property. You and your tax and legal advisors should conduct your own investigation of the property and transaction.

John T. Arthurs PRINCIPAL
D: 248.663.0506 | C: 248.563.3225
johna@pacommercial.com

33755 - 33789 GROESBECK HWY, FRASER, MI 48026 // FOR LEASE

LOCATION MAP

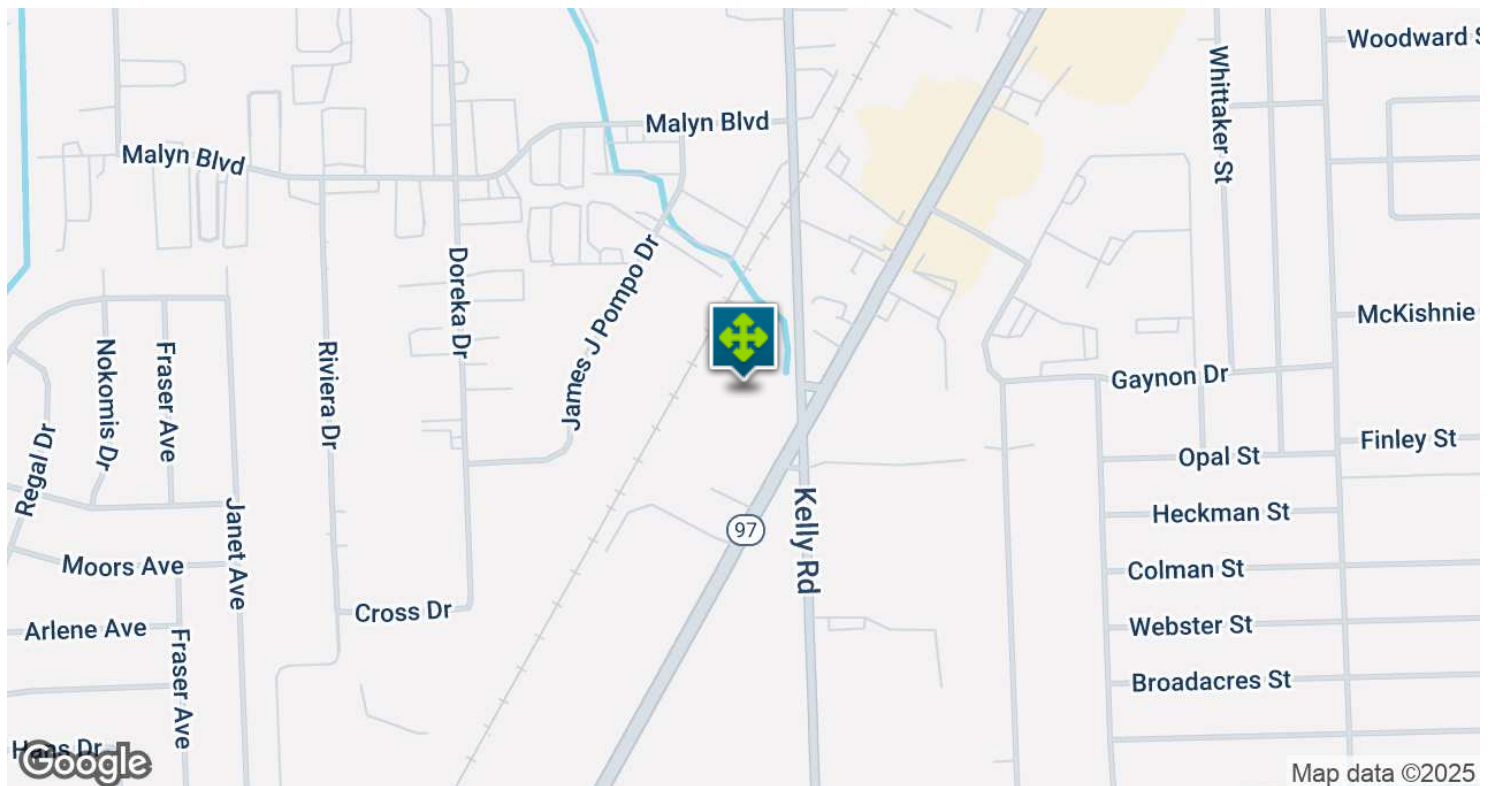
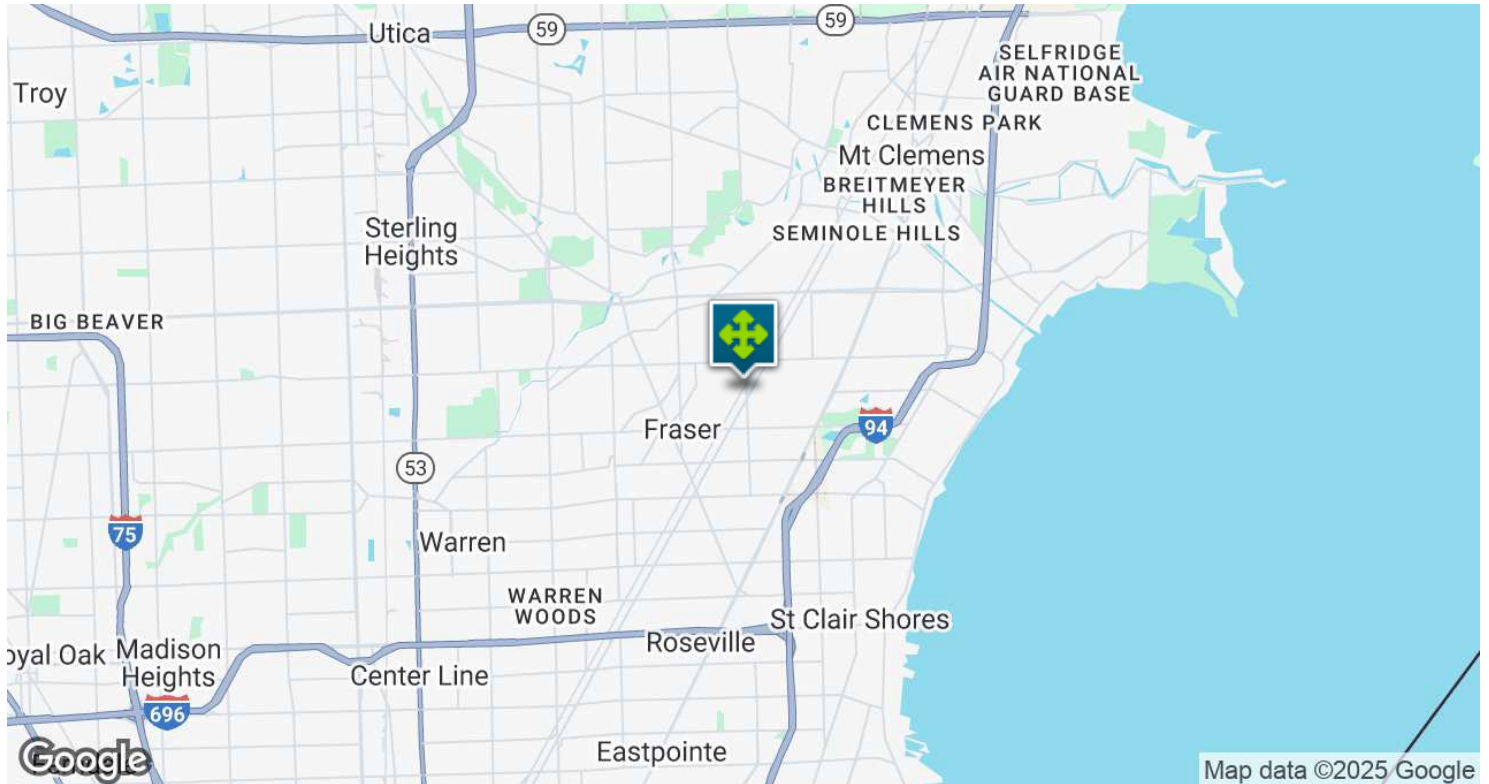

33755 - 33789 GROESBECK HWY, FRASER, MI 48026 // FOR LEASE

DEMOGRAPHICS MAP & REPORT

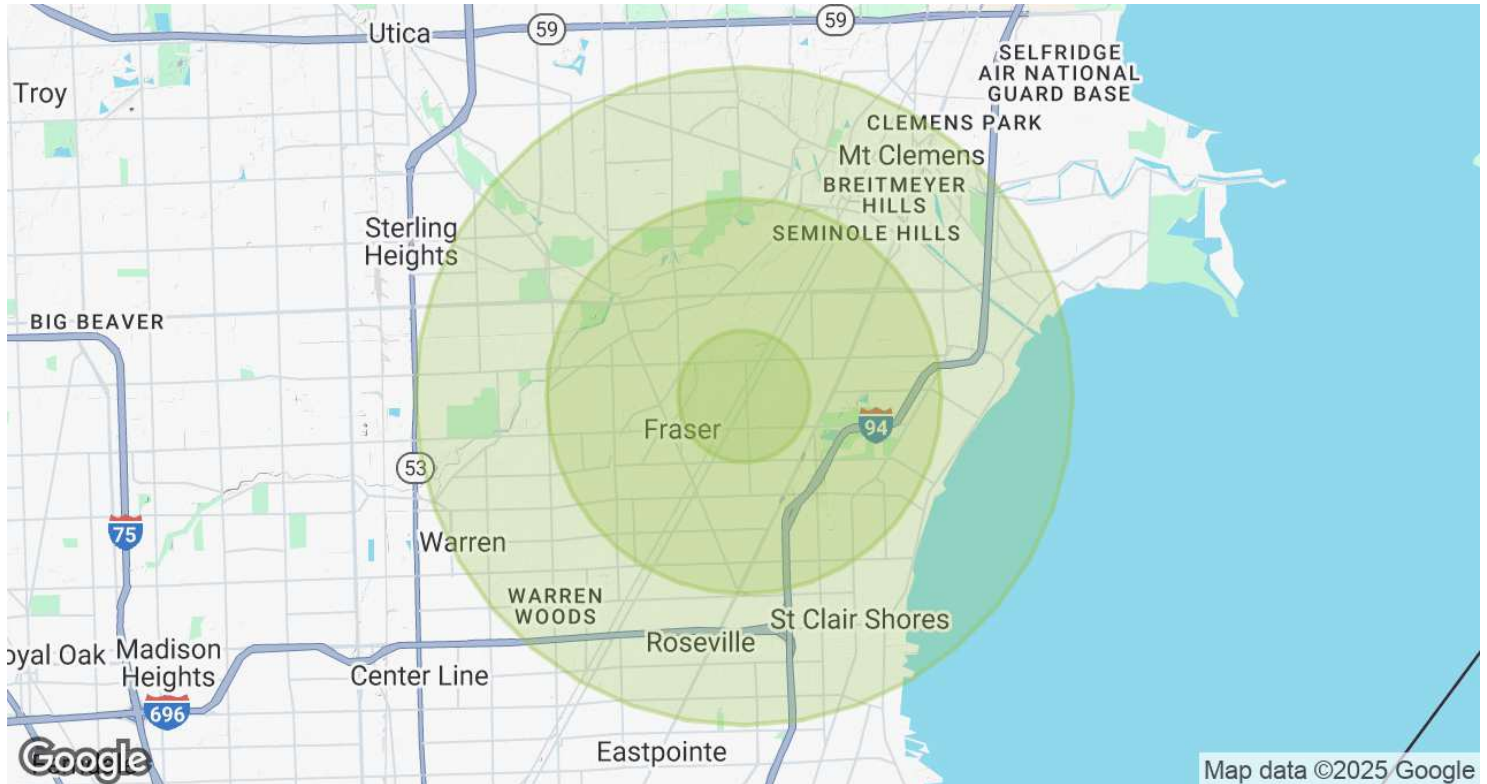

POPULATION	1 MILE	3 MILES	5 MILES
Total Population	10,782	106,892	310,417
Average Age	38.0	40.4	40.9
Average Age (Male)	37.0	38.1	39.1
Average Age (Female)	39.1	42.4	42.4

HOUSEHOLDS & INCOME	1 MILE	3 MILES	5 MILES
Total Households	4,326	45,200	130,225
# of Persons per HH	2.5	2.4	2.4
Average HH Income	\$54,830	\$58,602	\$60,554
Average House Value	\$133,655	\$146,257	\$150,585

2020 American Community Survey (ACS)

33755 - 33789 GROESBECK HWY, FRASER, MI 48026 // FOR LEASE

CONTACT US



FOR MORE INFORMATION, PLEASE CONTACT:



John T. Arthurs
PRINCIPAL

D: 248.663.0506

C: 248.563.3225

johna@pacommercial.com

P.A. Commercial

26555 Evergreen Road, Suite 1500
Southfield, MI 48076

P: 248.358.0100

F: 248.358.5300

pacommercial.com

Follow Us!



P.A. COMMERCIAL
Corporate & Investment Real Estate

We obtained the information above from sources we believe to be reliable. However, we have not verified its accuracy and make no guarantee, warranty or representation about it. It is submitted subject to the possibility of errors, omissions, change of price, rental or other conditions, prior sale, lease or financing, or withdrawal without notice. We include projections, opinions, assumptions or estimates for example only, and they may not represent current, past or future performance of the property. You and your tax and legal advisors should conduct your own investigation of the property and transaction.