

← OAK AIRPORT

\$1 per SF

Bonus to Broker*

880

Coliseum Way

PORT OF OAK →

19,040 SF - 222,934 SF AVAILABLE FOR LEASE

6195-6201 Coliseum Way

Oakland

CONTACT US

Nick Ousman, SIOR

Executive Vice President
+1 510 433 5820
nick.ousman@colliers.com

Greig Lagomarsino, SIOR

Vice Chairman
+1 510 409 9199
greig.lago@colliers.com

Chris Stauber

Senior Associate
+1 510 287 3121
chris.stauber@colliers.com

**BERKELEY
PARTNERS**



Accelerating success.

Coliseum Logistics Center | Class A High-Cube Industrial Available

Project Highlights

- ±355,332 Square Feet of Warehouse/Distribution space in two buildings
- ±66,000 Square Feet of Yard space
- Flexible suite size ranges throughout
- Secured Multi-Tenant Industrial Park
- Immediate access to I-880 via 66th Ave
- ESFR Sprinklers in both buildings
- Dock and grade level loading
- ±24' clear height
- Upgraded LED lighting in all vacancies
- Opportunity for unobstructed Freeway visibility and signage.
- CIX-2 Zoning
- Call to arrange a tour

In addition to the full fee, broker incentive applies with a minimum 60 month deal signed before 12/31/25

FOR LEASE

6195-6201 Coliseum Way

Oakland



BERKELEY
PARTNERS



This document/email has been prepared by Colliers for advertising and general information only. Colliers makes no guarantees, representations or warranties of any kind, expressed or implied, regarding the information including, but not limited to, warranties of content, accuracy and reliability. Any interested party should undertake their own inquiries as to the accuracy of the information. Colliers excludes unequivocally all inferred or implied terms, conditions and warranties arising out of this document and excludes all liability for loss and damages arising there from. This publication is the copyrighted property of Colliers and /or its licensor(s). © 2024. All rights reserved. This communication is not intended to cause or induce breach of an existing listing agreement. Colliers International.

FOR LEASE

6195-6201 Coliseum Way

Oakland



BERKELEY
PARTNERS

BUILDING 6195

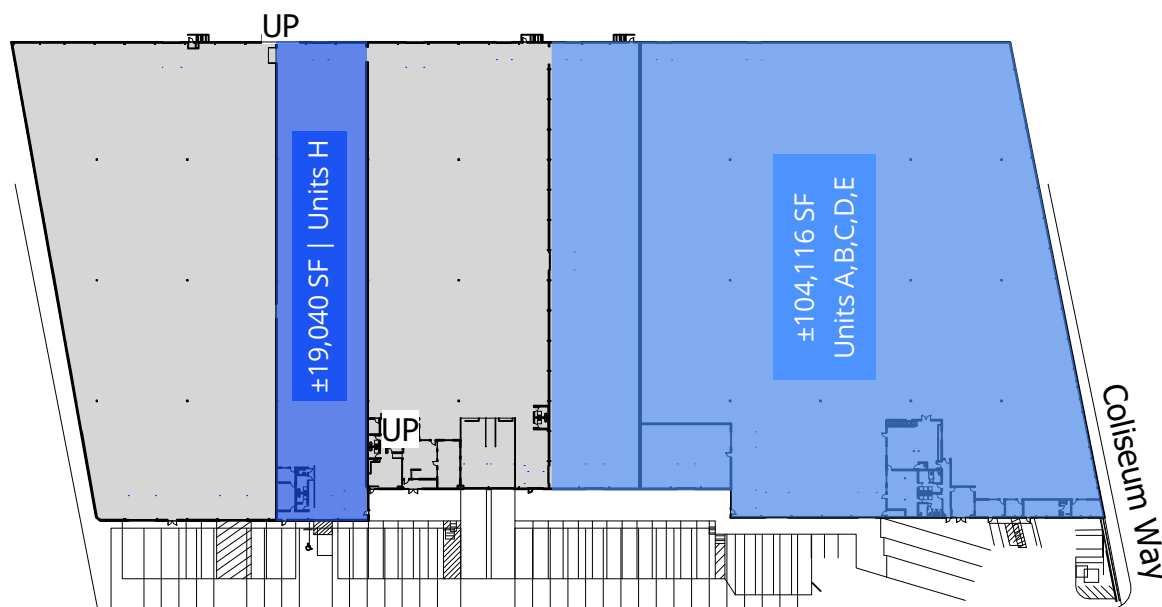

BUILDING 6201

FOR LEASE

6195-6201 Coliseum Way

Oakland



BERKELEY
PARTNERS

6195 UNITS A,B,C,D,E

- ±104,116 SF
- ±100,489 SF Warehouse
- ±3,627 SF Office
- 19 Dock High Loading Positions
- 5 Drive In Doors
- 24' clear height
- High image corner unit
- LED lighting
- ESFR sprinklers

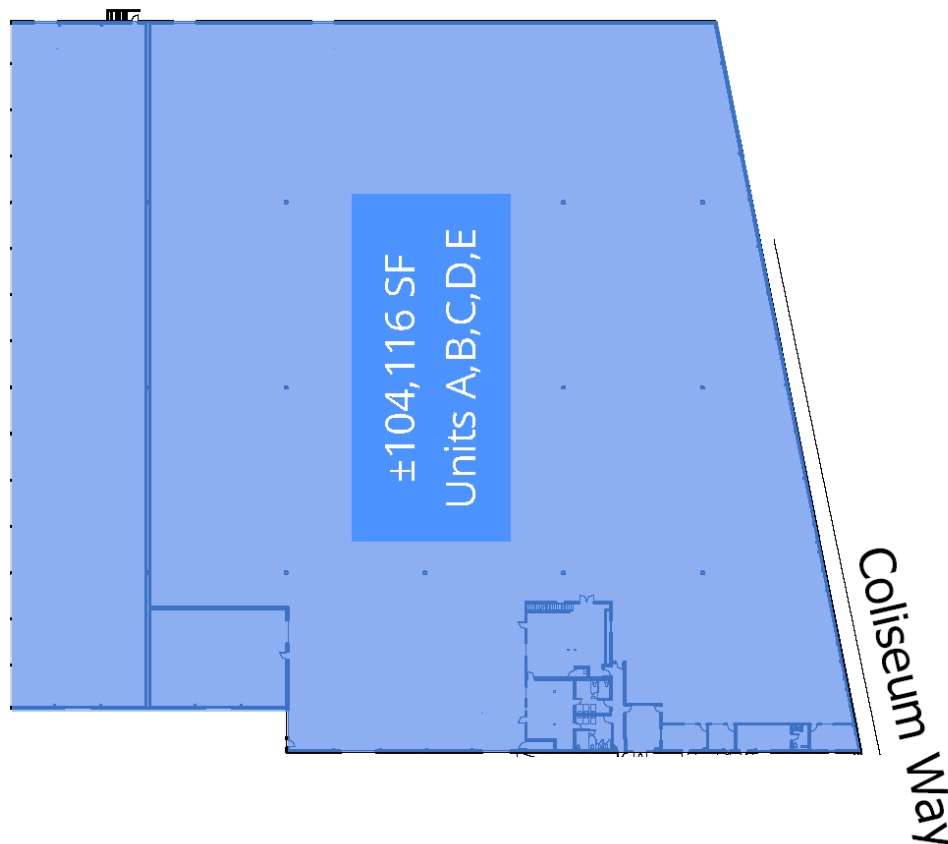

FOR LEASE

6195-6201 Coliseum Way

Oakland



BERKELEY
PARTNERS

6195 UNIT H

- ±19,040 SF
- 2 Dock Positions
- 2 Grade level doors
- 24' clear height
- LED lighting
- 200 amps @480V
- Minimal office
- ESFR sprinklers



FOR LEASE



BERKELEY
PARTNERS

6195-6201 Coliseum Way

Oakland

6201 UNITS C,D,E,F,G,H

- ±80,006 SF
- 20 Loading docks
- 45 Parking spaces
- 24' clear height
- LED lighting
- ESFR sprinklers

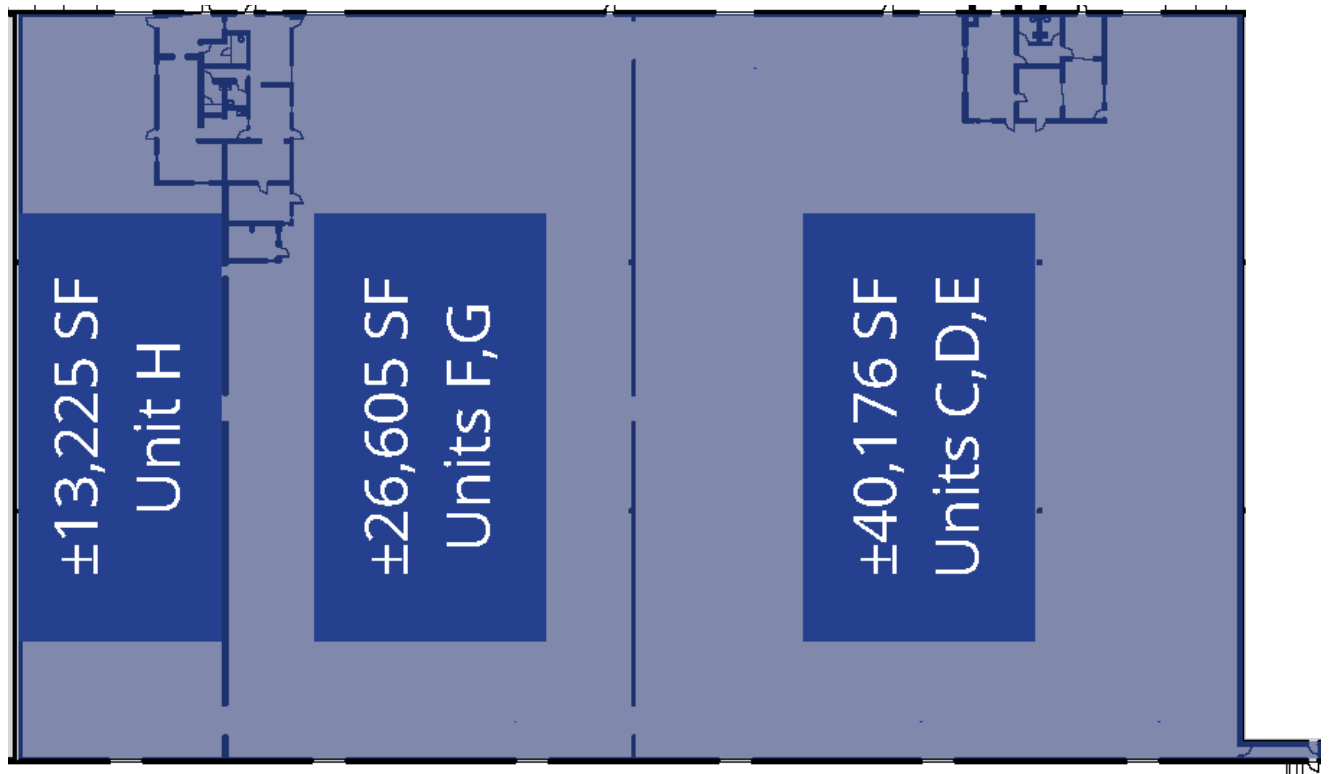

FOR LEASE



BERKELEY
PARTNERS

6195-6201 Coliseum Way

Oakland

6201 UNIT J

- ±19,772 SF
- ±18,984 SF Warehouse
- ±788 SF Office
- 4 dock spaces
- 24' clear height
- LED lighting
- ESFR sprinklers

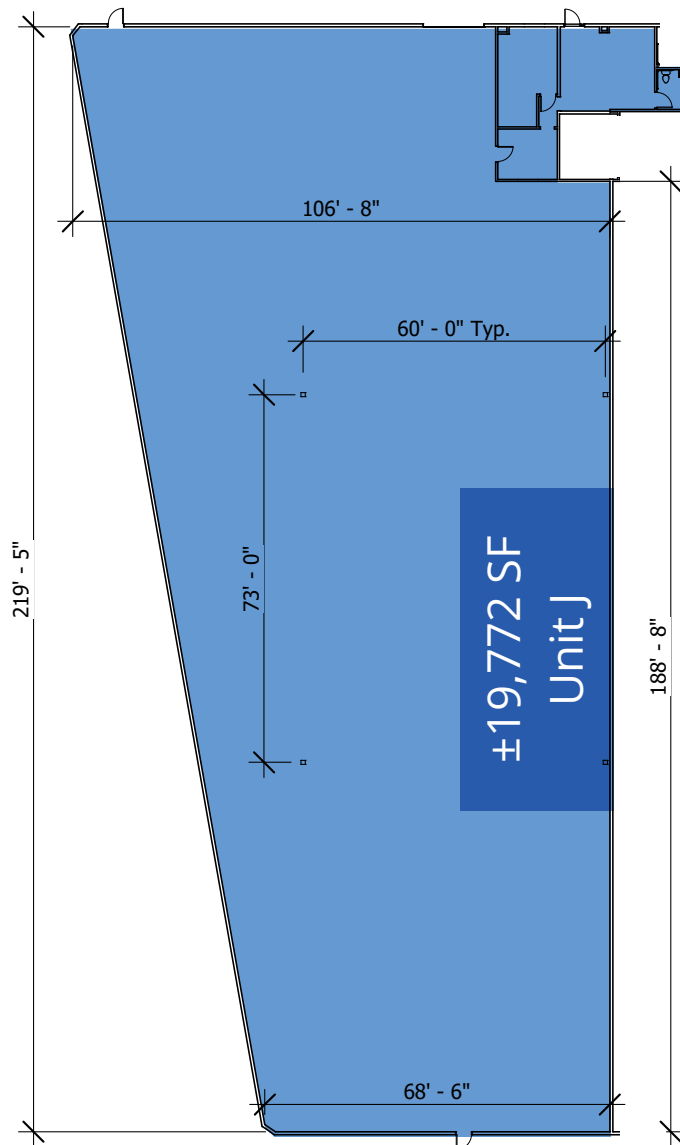

FOR LEASE



BERKELEY
PARTNERS

6195-6201 Coliseum Way

Oakland

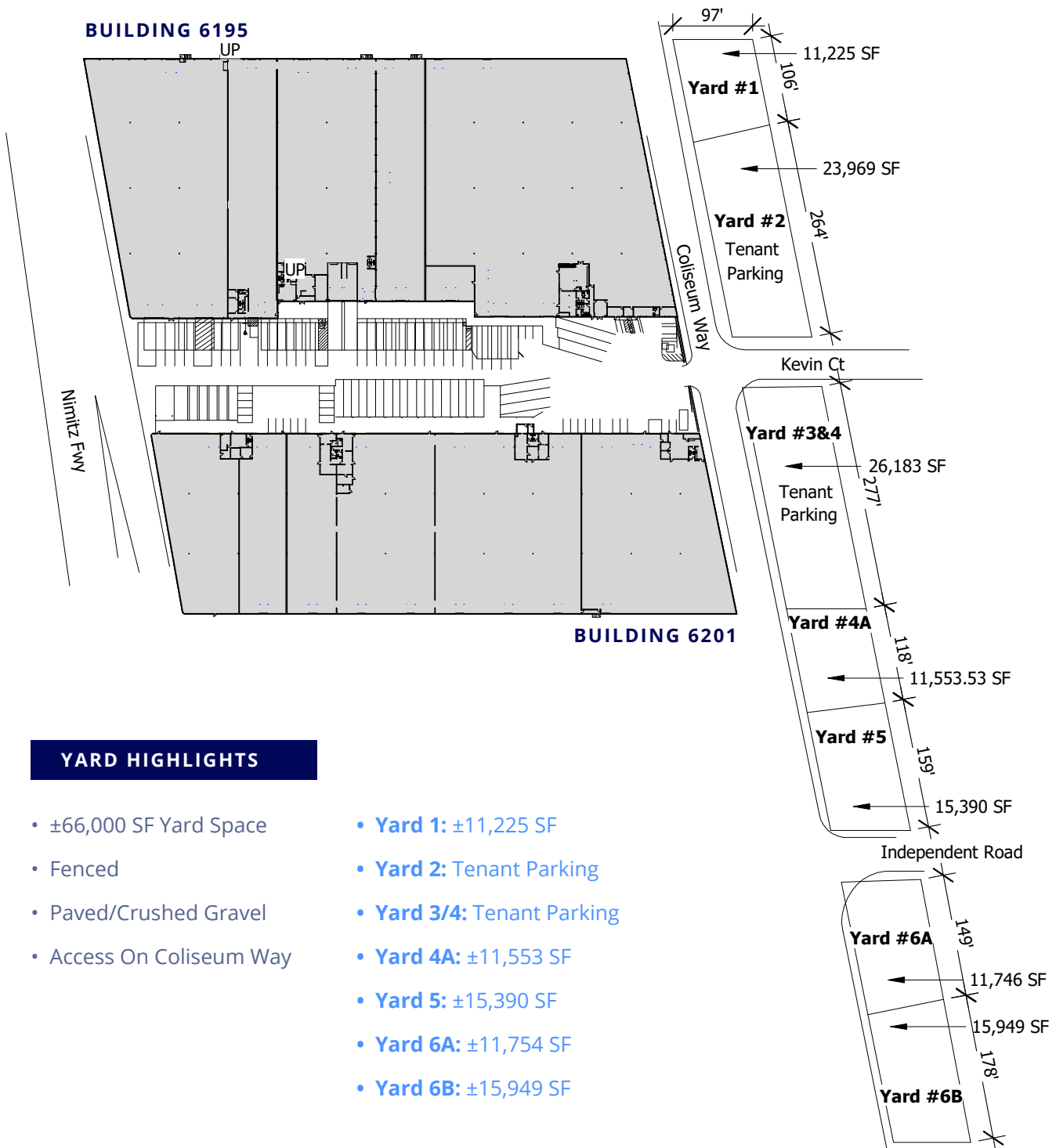

FOR LEASE

6195-6201 Coliseum Way

Oakland



BERKELEY
PARTNERS



0.9 Mile to Fruitvale BART Station
0.8 Mile to Coliseum BART Station



3.6 Miles to Oakland International Airport



5.8 Miles to Port of Oakland



17.5 Miles to San Francisco



28 Miles to San Francisco International Airport

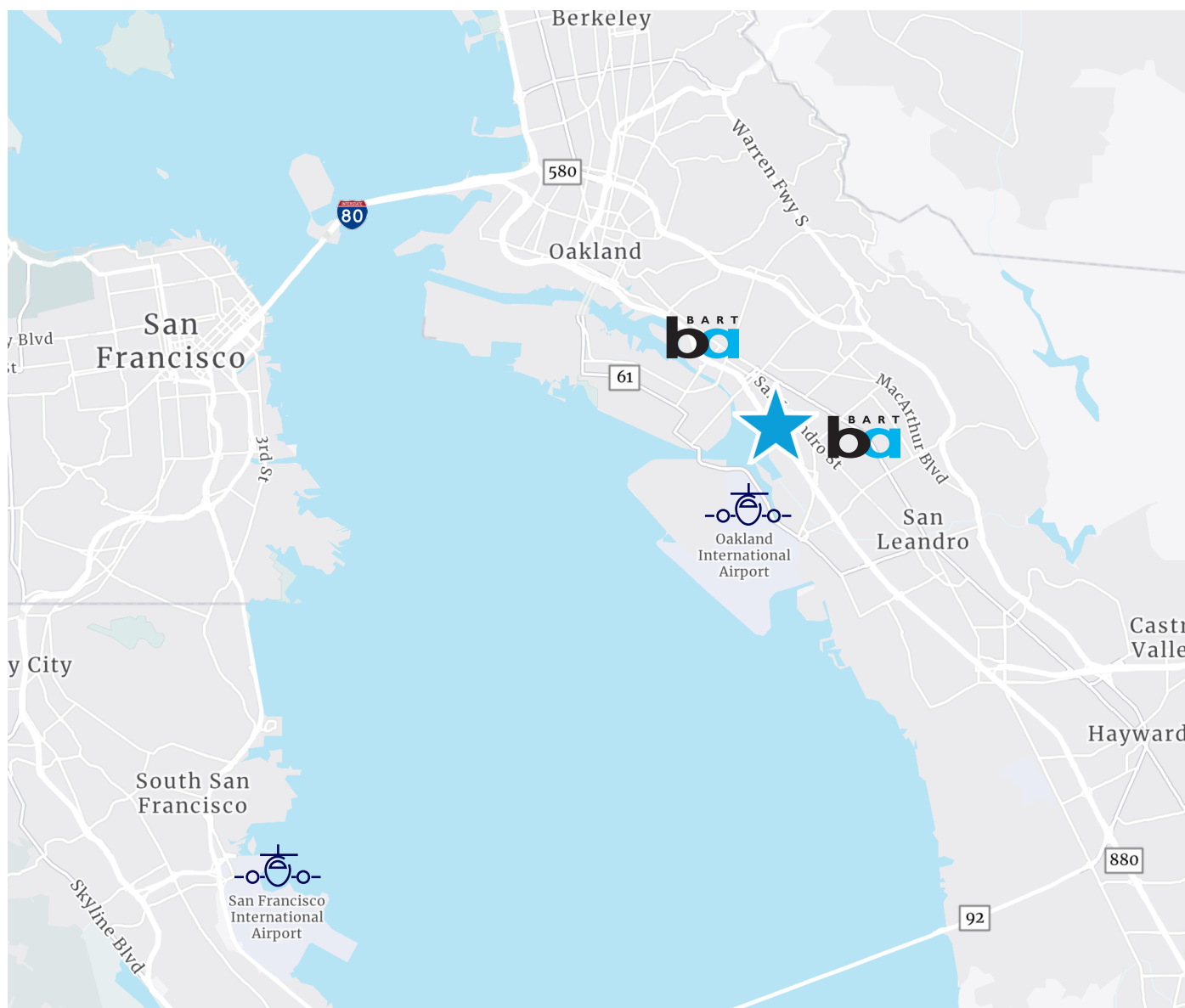

This document/email has been prepared by Colliers for advertising and general information only. Colliers makes no guarantees, representations or warranties of any kind, expressed or implied, regarding the information including, but not limited to, warranties of content, accuracy and reliability. Any interested party should undertake their own inquiries as to the accuracy of the information. Colliers excludes unequivocally all inferred or implied terms, conditions and warranties arising out of this document and excludes all liability for loss and damages arising there from. This publication is the copyrighted property of Colliers and /or its licensor(s). © 2024. All rights reserved. This communication is not intended to cause or induce breach of an existing listing agreement. Colliers International.