



**SW** MANAGEMENT  
& REALTY  
A Seagate Development Group Company



# WESTLINKS BUSINESS PARK

## BUILDING 3

12751 WESTLINKS DRIVE, FORT MYERS, FL 33913

8,320 SF OFFICE SPACE FOR LEASE

### CONTACT US:

**BRAD BERZINS, SIOR**

Brad.Berzins@jll.com

+1 239 673 2765

**HALEY BLORSTAD**

Haley.Blorstad@jll.com

+1 239 571 5681

Jones Lang LaSalle Brokerage, Inc.,  
a licensed real estate broker

**MATT PRICE**

MPrice@seagatedevelopmentgroup.com

+1 239 707 1542

**HEATHER RUMBOLD**

HRumbold@seagatedevelopmentgroup.com

+1 239 738 7848

SW Management & Realty,  
a licensed real estate broker

# PROPERTY FEATURES & FLOOR PLAN

Available immediately, Westlinks 3 is one of 11 buildings in Westlinks Business Park which sits just east of I-75 on Daniels Parkway. This professionally landscaped business park is the largest in Southwest Florida and contains over 346,000 SF, with amenities in walking distance and the Gateway planned community surrounding the back of the project. The park is minutes from Southwest Florida International Airport (RSW) and offers immediate access to I-75 and Daniels Parkway.

Westlinks 3 is a 29,900 square foot multi-tenant office building. There is ample dedicated office parking in front and the sides of the building. The Landlord will negotiate Tenant Improvements on a deal specific basis.

## BUILDING FEATURES

<b>SIZE</b>	29,900 SF	<b>PARKING</b>	2.50/1,000 SF
<b>AVAILABLE FOR LEASE</b>	8,320 SF	<b>HVAC</b>	Roof-mounted units throughout
<b>YEAR BUILT</b>	2000	<b>FIRE PROTECTION</b>	Wet sprinkler
<b>OFFICE SPACE</b>	Turnkey office space	<b>ASKING RENT</b>	\$14.50 NNN
<b>BUILDING TYPE</b>	Concrete tilt-up		

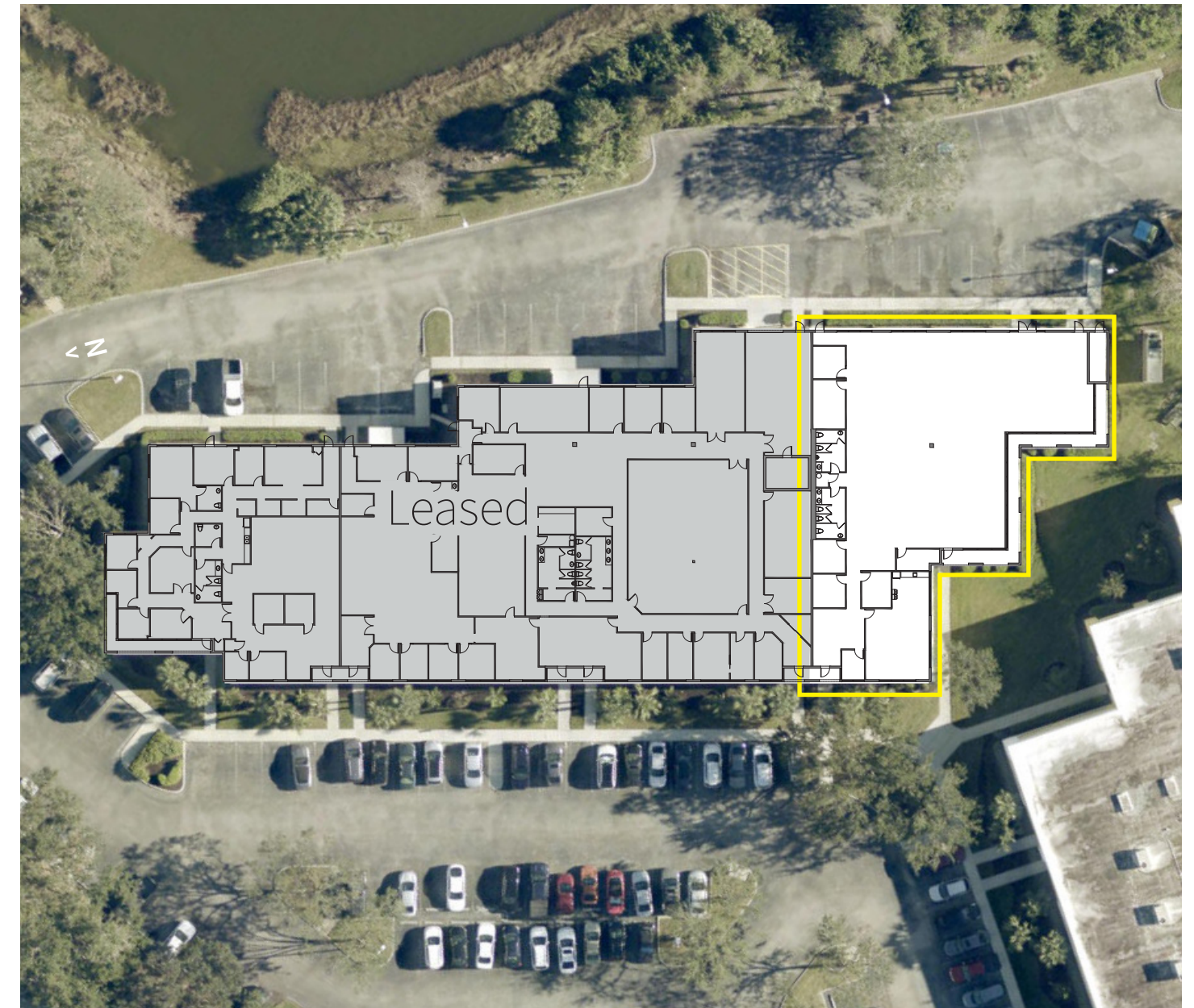

# PROPERTY MAP

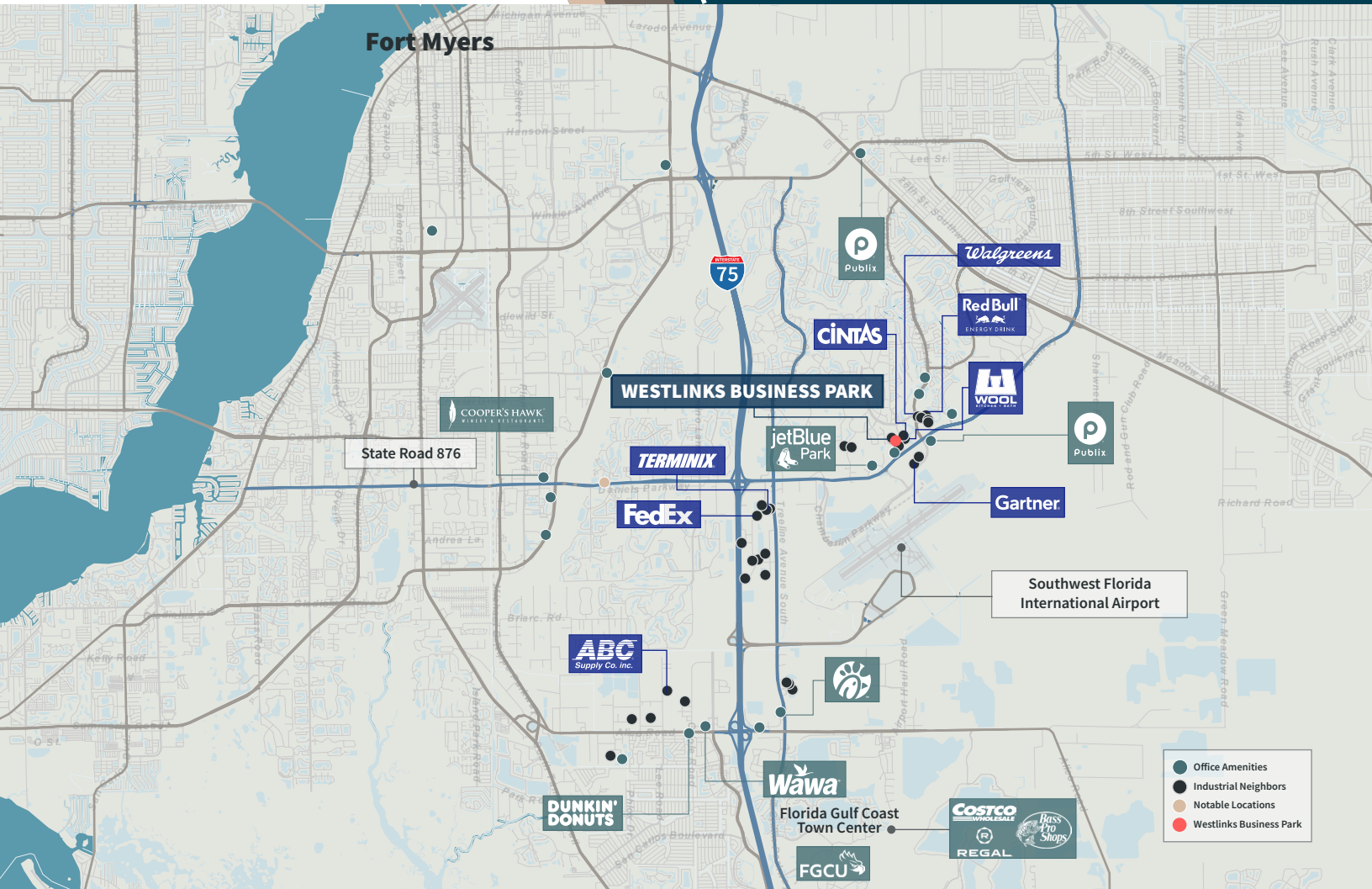

<b>SW FL INTL AIRPORT</b>	1.5 miles
<b>SR-82</b>	3 miles
<b>I-75</b>	3.2 miles

<b>TAMPA</b>	138 miles
<b>MIAMI</b>	140 miles
<b>ORLANDO</b>	165 miles

**BUILDING 3**  
**12751 WESTLINKS DRIVE, FORT MYERS, FL 33913**



**SW MANAGEMENT & REALTY**  
 A Seagate Development Group Company

## CONTACT US:

**BRAD BERZINS, SIOR** Brad.Berzins@jll.com +1 239 673 2765

**HALEY BLORSTAD** Haley.Blorstad@jll.com +1 239 571 5681

**MATT PRICE** MPrice@seagatedevelopmentgroup.com +1 239 707 1542

**HEATHER RUMBOLD** HRumbold@seagatedevelopmentgroup.com +1 239 738 7848

Although information has been obtained from sources deemed reliable, neither Owner nor JLL makes any guarantees, warranties or representations, express or implied, as to the completeness or accuracy as to the information contained herein. Any projections, opinions, assumptions or estimates used are for example only. There may be differences between projected and actual results, and those differences may be material. The Property may be withdrawn without notice. Neither Owner nor JLL accepts any liability for any loss or damage suffered by any party resulting from reliance on this information. If the recipient of this information has signed a confidentiality agreement regarding this matter, this information is subject to the terms of that agreement. © 2024 Jones Lang LaSalle IP, Inc. All rights reserved.