

1ST. AVE. S.

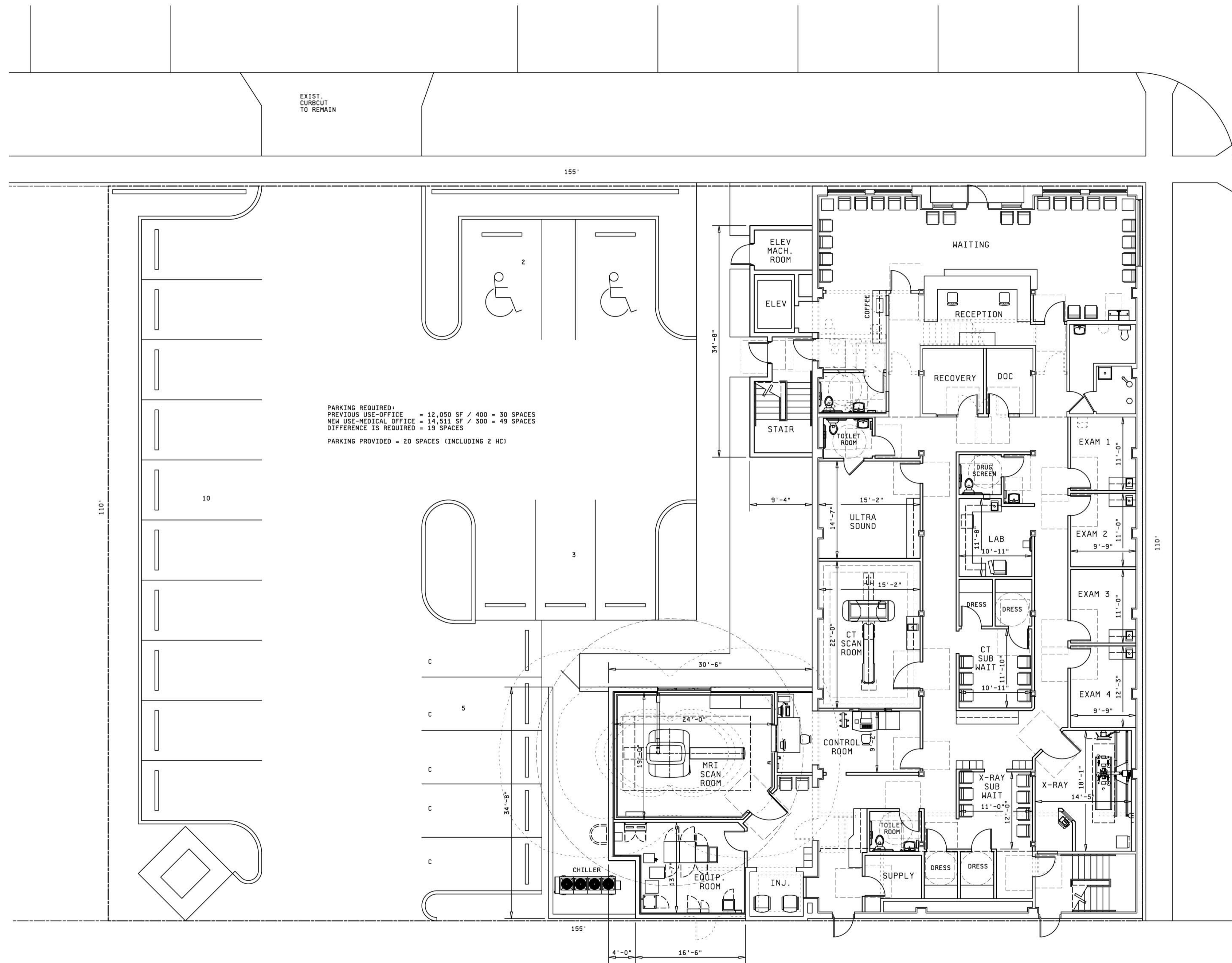

EXIST. CURBCUT TO REMAIN

PARKING REQUIRED:
 PREVIOUS USE-OFFICE = 12,050 SF / 400 = 30 SPACES
 NEW USE-MEDICAL OFFICE = 14,511 SF / 300 = 49 SPACES
 DIFFERENCE IS REQUIRED = 19 SPACES
 PARKING PROVIDED = 20 SPACES (INCLUDING 2 HC)

1 PROPOSED FIRST FLOOR PLAN
 A2.1 SCALE: 1/8"=1'-0" NORTH

INTERIOR ALTERATION FOR:
 GATEWAY RADIOLOGY
 2100 1ST. AVENUE S.
 ST. PETERSBURG, FLORIDA

Revisions:

FIRST FLOOR PLAN

Project Number
12000

Date
10-26-12

Sheet Number
A2.1

Jovanovic & Lyons, LLC
 275 Collins Avenue, Suite 301
 St. Petersburg, FL 33713 (727) 882-7111
 FL Lic. AA2600985
 www.jovanoviclyons.com
 Architectural Planning & Design

© 2012 Jovanovic & Lyons, LLC
 Donald J. Lyons
 AR0014753