

RETAIL SPACE FOR LEASE

1235 Columbus Avenue
Lebanon, OH 45036

\$12/sf + NNN*

*\$3.25/sf NNN includes but not limited to Real Estate Taxes, Insurance, and CAM (such as parking lot maintenance, snow removal, lawn care, etc.)

Aerial – Site View



Demographic Data

	1 mi	5 mi	10 mi
Estimated Population (2024)	2,352	34,979	206,565
Projected Population (2029)	2,560	36,955	219,753
Estimated Households (2024)	951	13,511	77,303
Projected Households (2029)	1,050	14,488	83,245
Estimated Average Household Income (2024)	\$92,810	\$125,452	\$139,260
Projected Average Household Income (2029)	\$95,557	\$130,164	\$145,068
Total Businesses	125	1,021	5,128
Total Employees	1,028	11,482	57,759

Space Details



Join Tractor Supply in the former Kroger building (moved to new building just North of site)

Up to 25,198 sf available (can be reduced as needed per tenant needs)
Bank coming soon to Outparcel

Small center adjacent to building includes tenants Edward Jones Financial Advisors, Asian Gourmet, Tobacco Discounters, Dougie’s Hangout, Healthsource Ohio, and Picture Perfect Haircuts

Large ample parking lot and tenant pylon sign available

COCCA DEVELOPMENT, LTD
100 DEBARTOLO PLACE SUITE 400 BOARDMAN, OHIO 44512
(330) 729-1010
WWW.COCCADEVELOPMENT.COM

\\cd-file-01\Engineering\Land Projects\2006 Drawing After 6-12\Lebanon, OH (TSC 2023)\Drawings\05 Preliminary\24-07 10 - TSC Layout.dwg, 7/10/2024 11:18:18 AM, _A

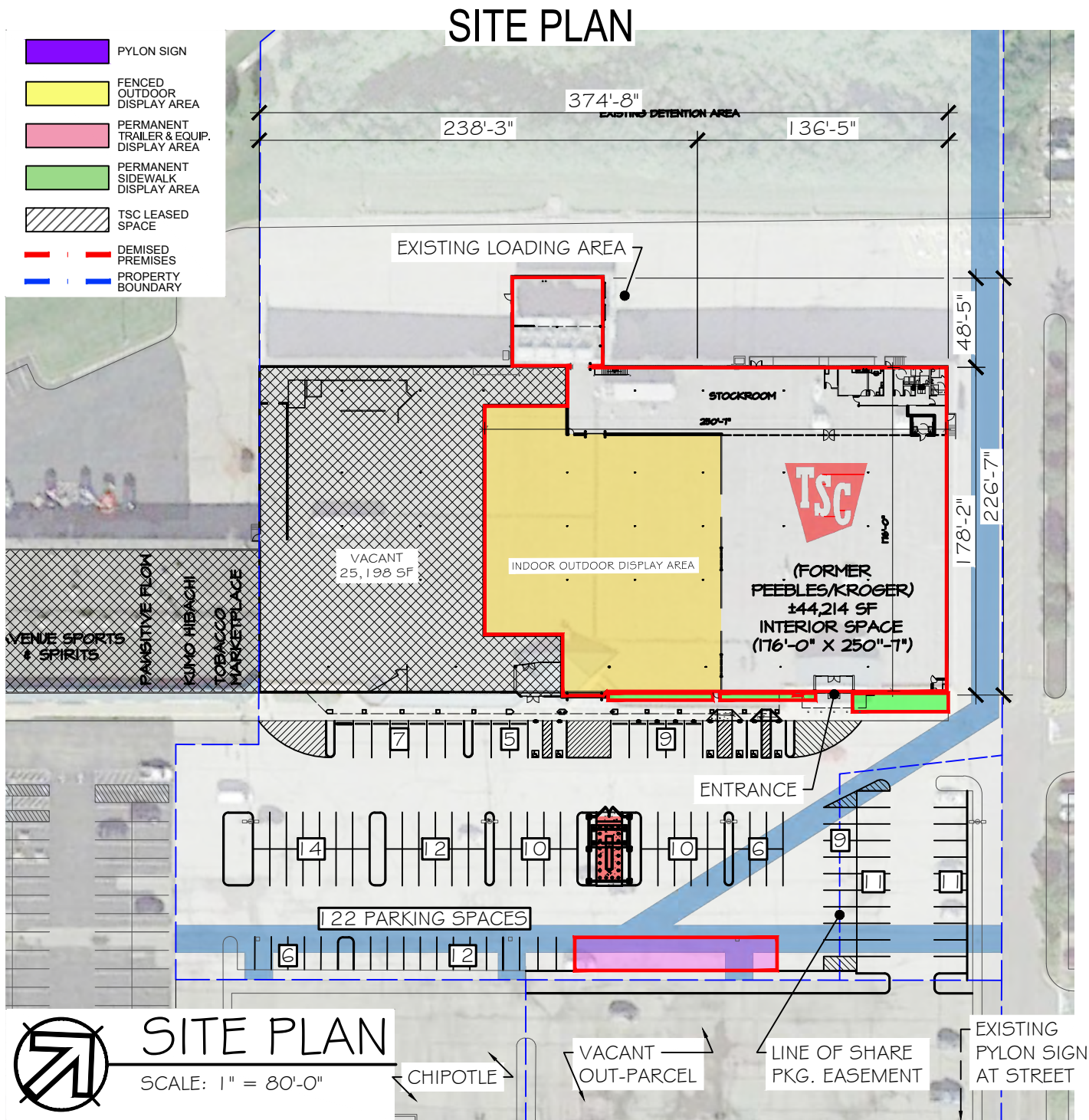

COLOR CODED SITE PLAN		SITE LOCATION: 1235 COLUMBUS AVENUE * LEBANON, OH 45036 WARREN COUNTY (* EXISTING BUILDING ADDRESS)	
TENANT: TRACTOR SUPPLY CO.	DEVELOPER	DESIGNER	DATE:
TSC BLDG AREA: 44,214 SF	COMPANY: COCCA DEVELOPMENT	COMPANY: COCCA DEVELOPMENT	10/11/23
FENCED AREA SIZE: (INT.) 20,002 SF	NAME: ANTHONY COCCA	NAME: BILL SCHROEDER	10/30/23
TRAILER DISPLAY: 1,980 SF	PHONE #: 330-729-1010	PHONE #: 330-729-1010	10/31/23
SIDEWALK DISPLAY: 933 SF	TSC- S.F. AREA		7/10/24
LIVE GOODS CENTER 0 SF			
FORAGE SHED 0 SF	SALES AREA (# VESTIBULE) 15,514 S.F.		
ACREAGE: (+/-) 5.34 AC	OFFICE CORE 950 S.F.		
PARKING SPACES: (TOTAL) 122 SPACES	STOCKROOM # FEED CTR. 7,669 S.F.		
	INDOOR OUTDOOR DISPLAY 20,002 S.F.		
	STRUCTURAL WALLS 79 S.F.		
	TOTAL AREA: 44,214 S.F.		

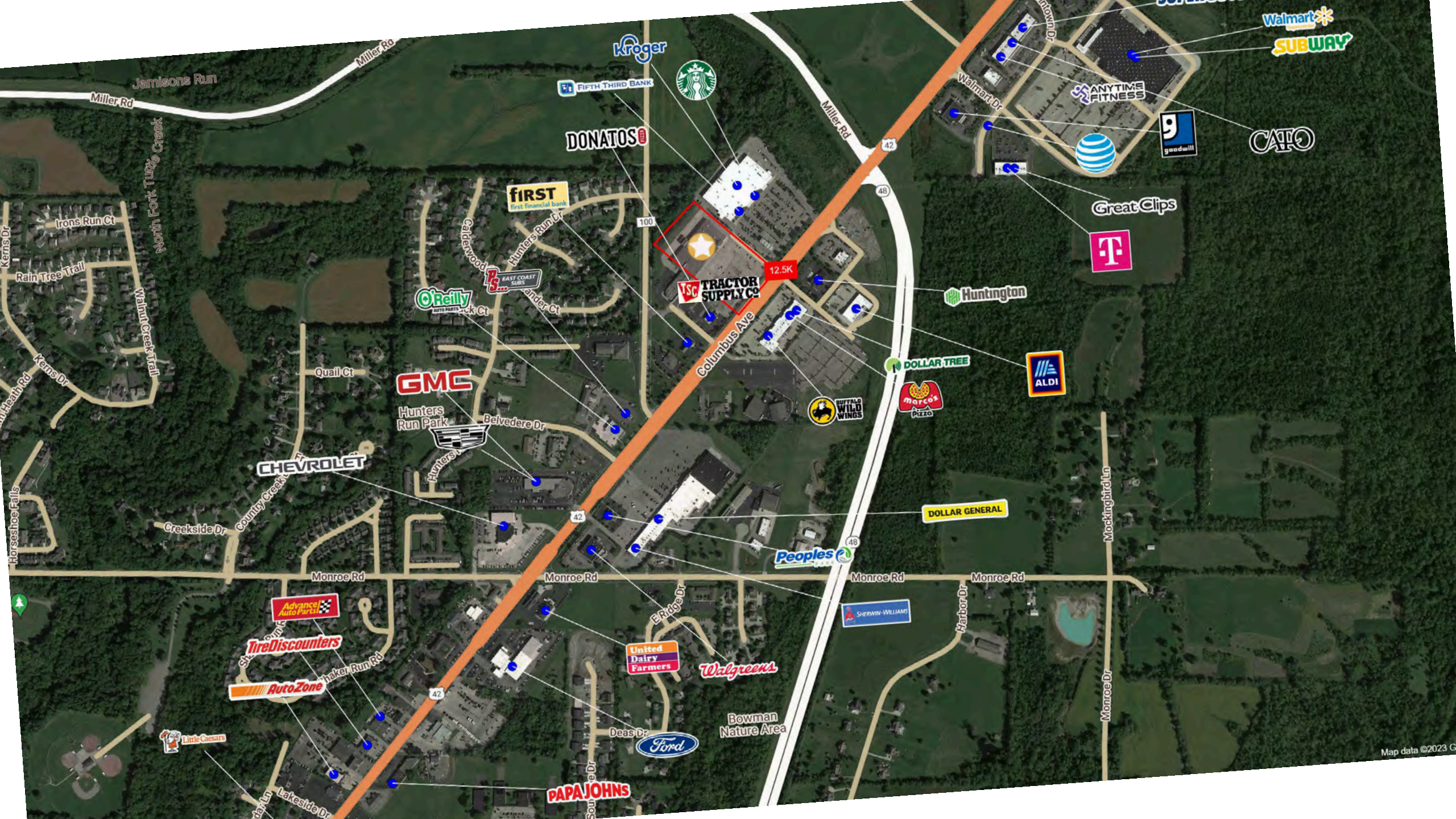

Lat/Lon: 39.4531/-84.1815

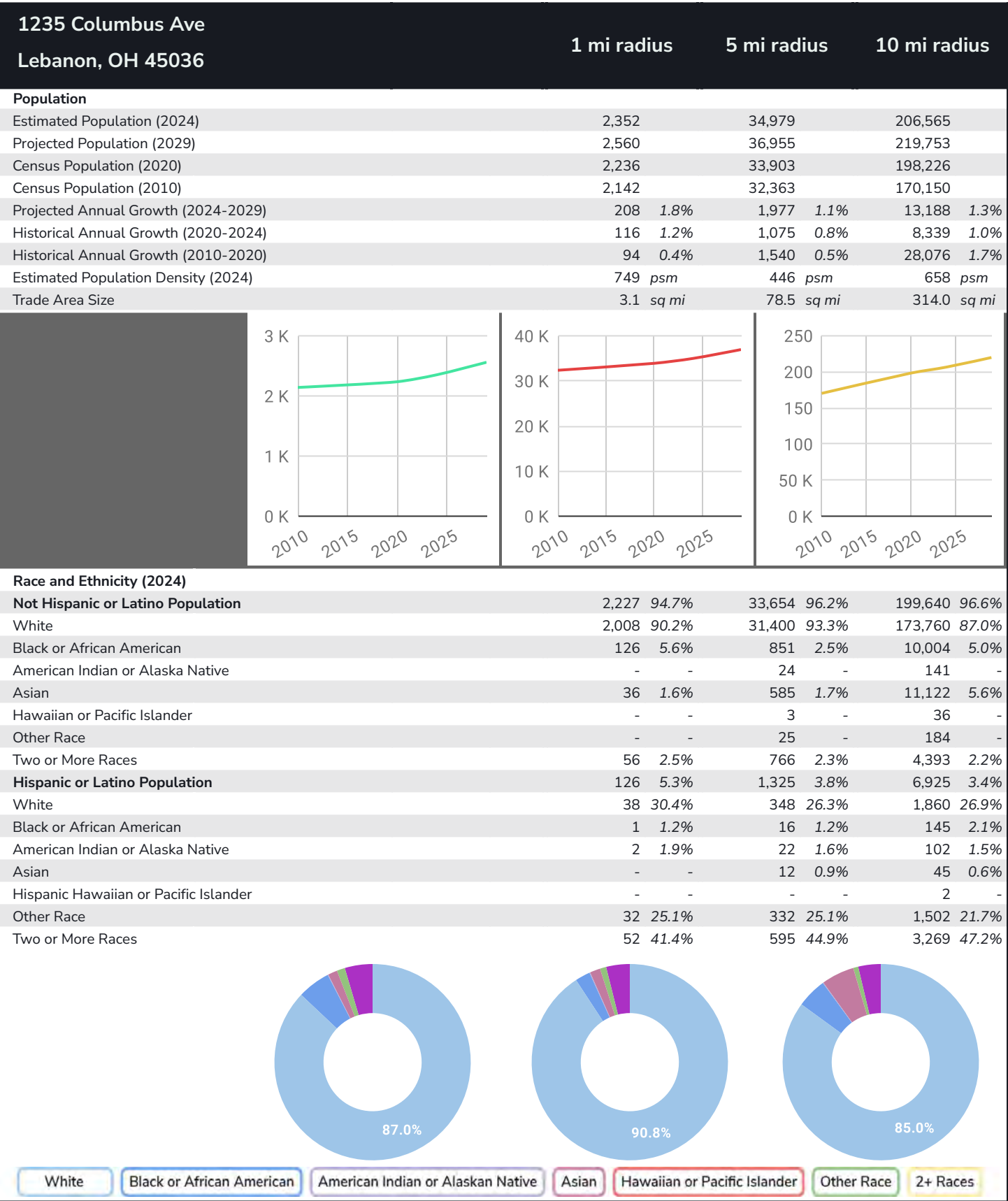

Lat/Lon: 39.4531/-84.1815

1235 Columbus Ave Lebanon, OH 45036		1 mi radius		5 mi radius		10 mi radius	
Age Distribution (2024)							
Age Under 5 Years	145	6.1%	1,820	5.2%	11,336	5.5%	
Age 5 to 9 Years	179	7.6%	2,287	6.5%	13,816	6.7%	
Age 10 to 14 Years	173	7.3%	2,456	7.0%	14,840	7.2%	
Age 15 to 19 Years	159	6.8%	2,569	7.3%	14,264	6.9%	
Age 20 to 24 Years	140	5.9%	2,138	6.1%	11,878	5.8%	
Age 25 to 29 Years	154	6.5%	1,834	5.2%	10,606	5.1%	
Age 30 to 34 Years	142	6.1%	1,858	5.3%	12,322	6.0%	
Age 35 to 39 Years	147	6.3%	2,213	6.3%	14,074	6.8%	
Age 40 to 44 Years	135	5.7%	2,159	6.2%	14,786	7.2%	
Age 45 to 49 Years	117	5.0%	2,254	6.4%	13,556	6.6%	
Age 50 to 54 Years	126	5.4%	2,574	7.4%	14,575	7.1%	
Age 55 to 59 Years	127	5.4%	2,474	7.1%	13,419	6.5%	
Age 60 to 64 Years	142	6.0%	2,512	7.2%	13,147	6.4%	
Age 65 to 69 Years	146	6.2%	2,017	5.8%	11,217	5.4%	
Age 70 to 74 Years	115	4.9%	1,597	4.6%	9,098	4.4%	
Age 75 to 79 Years	87	3.7%	1,078	3.1%	6,499	3.1%	
Age 80 to 84 Years	67	2.8%	661	1.9%	3,884	1.9%	
Age 85 Years or Over	52	2.2%	475	1.4%	3,250	1.6%	
Median Age	36.9		39.9		39.6		
Generation (2024)							
iGeneration (Age Under 15 Years)	496	21.1%	6,563	18.8%	39,991	19.4%	
Generation 9/11 Millennials (Age 15 to 34 Years)	595	25.3%	8,400	24.0%	49,069	23.8%	
Gen Xers (Age 35 to 49 Years)	399	17.0%	6,626	18.9%	42,415	20.5%	
Baby Boomers (Age 50 to 74 Years)	656	27.9%	11,174	31.9%	61,456	29.8%	
Silent Generation (Age 75 to 84 Years)	154	6.5%	1,740	5.0%	10,383	5.0%	
G.I. Generation (Age 85 Years or Over)	52	2.2%	475	1.4%	3,250	1.6%	

Graphic Profile

2010-2020 Census, 2024 Estimates with 2029 Projections
Calculated using Weighted Block Centroid from Block Groups

Lat/Lon: 39.4531/-84.1815

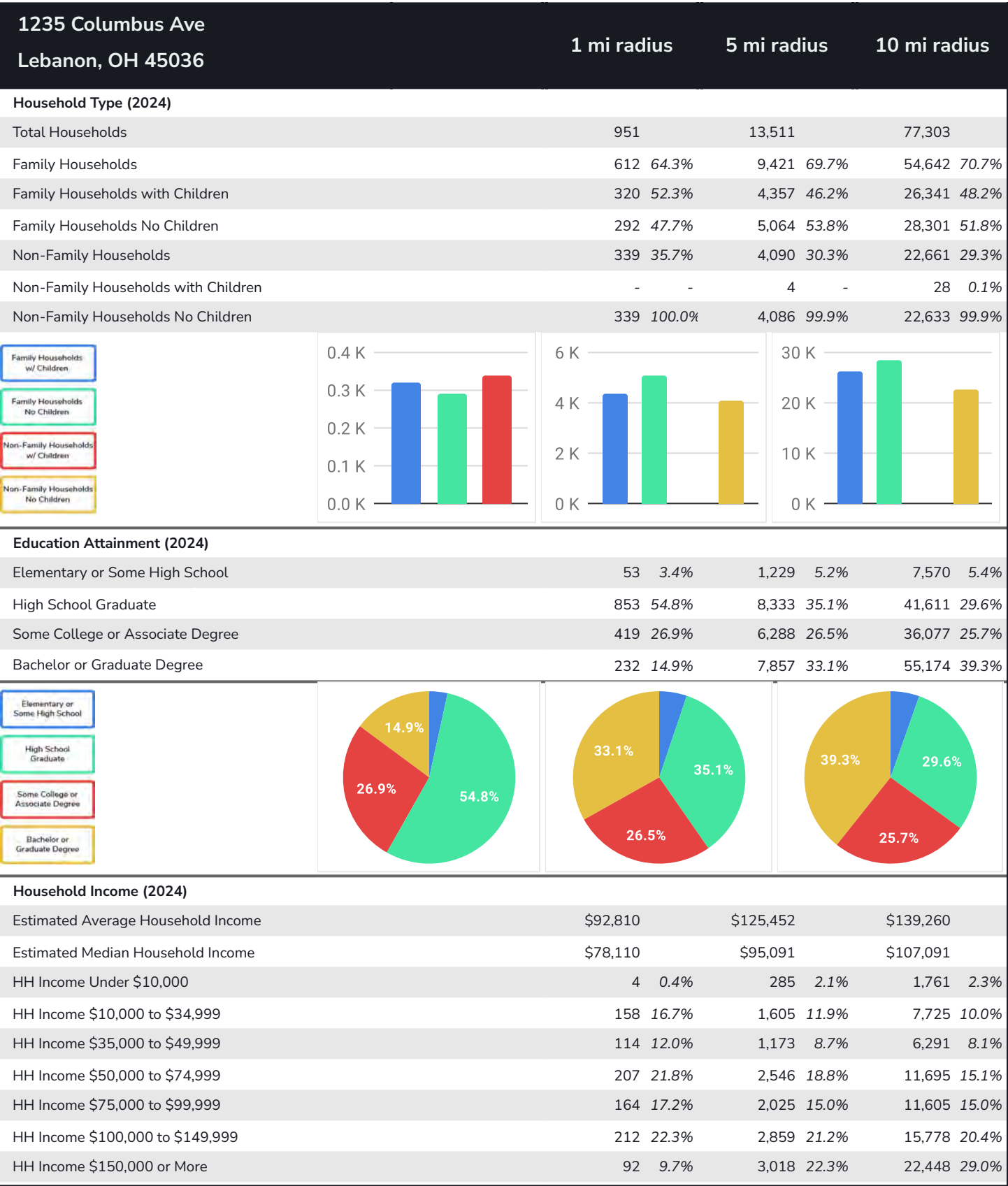

Expanded Profile

2010-2020 Census, 2024 Estimates with 2029 Projections
Calculated using Weighted Block Centroid from Block Groups

Lat/Lon: 39.4531/-84.1815

1235 Columbus Ave Lebanon, OH 45036	1 mi radius		5 mi radius		10 mi radius	
Population						
Estimated Population (2024)	2,352		34,979		206,565	
Projected Population (2029)	2,560		36,955		219,753	
Census Population (2020)	2,236		33,903		198,226	
Census Population (2010)	2,142		32,363		170,150	
Projected Annual Growth (2024 to 2029)	208	1.8%	1,977	1.1%	13,188	1.3%
Historical Annual Growth (2020 to 2024)	116	1.3%	1,075	0.8%	8,339	1.1%
Historical Annual Growth (2010 to 2020)	94	1.1%	1,540	1.2%	28,076	4.1%
Estimated Population Density (2024)	749	psm	446	psm	658	psm
Trade Area Size	3.1	sq mi	78.5	sq mi	314.0	sq mi
Households						
Estimated Households (2024)	951		13,511		77,303	
Projected Households (2029)	1,050		14,488		83,245	
Census Households (2020)	887		12,709		72,264	
Census Households (2010)	807		11,759		60,732	
Estimated Households with Children (2024)	320	33.7%	4,361	32.3%	26,369	34.1%
Estimated Average Household Size (2024)	2.44		2.56		2.62	
Average Household Income						
Estimated Average Household Income (2024)	\$92,810		\$125,452		\$139,260	
Projected Average Household Income (2029)	\$95,557		\$130,164		\$145,068	
Estimated Average Family Income (2024)	\$107,103		\$142,701		\$160,671	
Median Household Income						
Estimated Median Household Income (2024)	\$78,110		\$95,091		\$107,091	
Projected Median Household Income (2029)	\$78,472		\$96,042		\$110,338	
Estimated Median Family Income (2024)	\$83,842		\$114,234		\$127,063	
Per Capita Income						
Estimated Per Capita Income (2024)	\$37,646		\$48,516		\$52,165	
Projected Per Capita Income (2029)	\$39,278		\$51,083		\$54,999	
Estimated Per Capita Income 5 Year Growth	\$1,632	4.3%	\$2,567	5.3%	\$2,835	5.4%
Estimated Average Household Net Worth (2024)	\$682,373		\$1,074,733		\$1,294,257	
Daytime Demos (2024)						
Total Businesses	125		1,021		5,128	
Total Employees	1,028		11,482		57,759	
Company Headquarter Businesses	3	2.3%	25	2.4%	158	3.1%
Company Headquarter Employees	112	10.9%	1,362	11.9%	8,923	15.4%
Employee Population per Business	8.2		11.2		11.3	
Residential Population per Business	18.9		34.3		40.3	

Expanded Profile

2010-2020 Census, 2024 Estimates with 2029 Projections
Calculated using Weighted Block Centroid from Block Groups

Lat/Lon: 39.4531/-84.1815

1235 Columbus Ave		1 mi radius		5 mi radius		10 mi radius	
Lebanon, OH 45036							
Race & Ethnicity							
White (2024)	2,046	87.0%	31,748	90.8%	175,620	85.0%	
Black or African American (2024)	127	5.4%	867	2.5%	10,148	4.9%	
American Indian or Alaska Native (2024)	3	0.1%	46	0.1%	244	0.1%	
Asian (2024)	36	1.5%	597	1.7%	11,167	5.4%	
Hawaiian or Pacific Islander (2024)	-	-	3	-	38	-	
Other Race (2024)	32	1.3%	357	1.0%	1,686	0.8%	
Two or More Races (2024)	108	4.6%	1,361	3.9%	7,662	3.7%	
Not Hispanic or Latino Population (2024)	2,227	94.7%	33,654	96.2%	199,640	96.6%	
Hispanic or Latino Population (2024)	126	5.3%	1,325	3.8%	6,925	3.4%	
Not Hispanic or Latino Population (2029)	2,375	92.8%	34,957	94.6%	209,358	95.3%	
Hispanic or Latino Population (2029)	185	7.2%	1,998	5.4%	10,394	4.7%	
Not Hispanic or Latino Population (2020)	2,138	95.6%	32,613	96.2%	191,590	96.7%	
Hispanic or Latino Population (2020)	98	4.4%	1,290	3.8%	6,635	3.3%	
Not Hispanic or Latino Population (2010)	2,092	97.7%	31,478	97.3%	166,407	97.8%	
Hispanic or Latino Population (2010)	49	2.3%	885	2.7%	3,743	2.2%	
Projected Hispanic Annual Growth (2024 to 2029)	59	9.5%	673	10.2%	3,469	10.0%	
Historic Hispanic Annual Growth (2010 to 2024)	76	11.1%	440	3.5%	3,182	6.1%	
Age Distribution (2024)							
Age Under 5	145	6.1%	1,820	5.2%	11,336	5.5%	
Age 5 to 9 Years	179	7.6%	2,287	6.5%	13,816	6.7%	
Age 10 to 14 Years	173	7.3%	2,456	7.0%	14,840	7.2%	
Age 15 to 19 Years	159	6.8%	2,569	7.3%	14,264	6.9%	
Age 20 to 24 Years	140	5.9%	2,138	6.1%	11,878	5.8%	
Age 25 to 29 Years	154	6.5%	1,834	5.2%	10,606	5.1%	
Age 30 to 34 Years	142	6.1%	1,858	5.3%	12,322	6.0%	
Age 35 to 39 Years	147	6.3%	2,213	6.3%	14,074	6.8%	
Age 40 to 44 Years	135	5.7%	2,159	6.2%	14,786	7.2%	
Age 45 to 49 Years	117	5.0%	2,254	6.4%	13,556	6.6%	
Age 50 to 54 Years	126	5.4%	2,574	7.4%	14,575	7.1%	
Age 55 to 59 Years	127	5.4%	2,474	7.1%	13,419	6.5%	
Age 60 to 64 Years	142	6.0%	2,512	7.2%	13,147	6.4%	
Age 65 to 74 Years	261	11.1%	3,614	10.3%	20,315	9.8%	
Age 75 to 84 Years	154	6.5%	1,740	5.0%	10,383	5.0%	
Age 85 Years or Over	52	2.2%	475	1.4%	3,250	1.6%	
Median Age	36.9		39.9		39.6		
Gender Age Distribution (2024)							
Female Population	1,237	52.6%	17,561	50.2%	102,946	49.8%	
Age 0 to 19 Years	337	27.3%	4,436	25.3%	26,405	25.6%	
Age 20 to 64 Years	652	52.7%	10,050	57.2%	58,517	56.8%	
Age 65 Years or Over	248	20.0%	3,075	17.5%	18,024	17.5%	
Female Median Age	37.2		40.9		40.4		
Male Population	1,115	47.4%	17,418	49.8%	103,619	50.2%	
Age 0 to 19 Years	318	28.5%	4,697	27.0%	27,850	26.9%	
Age 20 to 64 Years	578	51.8%	9,967	57.2%	59,845	57.8%	
Age 65 Years or Over	219	19.6%	2,754	15.8%	15,924	15.4%	
Male Median Age	36.7		39.0		38.7		

Expanded Profile

2010-2020 Census, 2024 Estimates with 2029 Projections
Calculated using Weighted Block Centroid from Block Groups

Lat/Lon: 39.4531/-84.1815

1235 Columbus Ave Lebanon, OH 45036	1 mi radius		5 mi radius		10 mi radius	
Household Income Distribution (2024)						
HH Income \$200,000 or More	50	5.3%	1,535	11.4%	13,360	17.3%
HH Income \$150,000 to \$199,999	42	4.4%	1,483	11.0%	9,088	11.8%
HH Income \$100,000 to \$149,999	212	22.3%	2,859	21.2%	15,778	20.4%
HH Income \$75,000 to \$99,999	164	17.2%	2,025	15.0%	11,605	15.0%
HH Income \$50,000 to \$74,999	207	21.8%	2,546	18.8%	11,695	15.1%
HH Income \$35,000 to \$49,999	114	12.0%	1,173	8.7%	6,291	8.1%
HH Income \$25,000 to \$34,999	95	10.0%	700	5.2%	3,613	4.7%
HH Income \$15,000 to \$24,999	46	4.8%	589	4.4%	2,628	3.4%
HH Income Under \$15,000	21	2.2%	601	4.4%	3,245	4.2%
HH Income \$35,000 or More	789	83.0%	11,621	86.0%	67,817	87.7%
HH Income \$75,000 or More	468	49.2%	7,902	58.5%	49,831	64.5%
Housing (2024)						
Total Housing Units	983		13,936		79,904	
Housing Units Occupied	951	96.8%	13,511	97.0%	77,303	96.7%
Housing Units Owner-Occupied	473	49.8%	9,510	70.4%	59,598	77.1%
Housing Units, Renter-Occupied	478	50.2%	4,001	29.6%	17,706	22.9%
Housing Units, Vacant	32	3.3%	425	3.1%	2,601	3.4%
Marital Status (2024)						
Never Married	608	32.8%	7,639	26.9%	43,587	26.2%
Currently Married	827	44.5%	15,309	53.9%	92,942	55.8%
Separated	20	1.1%	571	2.0%	3,551	2.1%
Widowed	120	6.5%	1,449	5.1%	8,558	5.1%
Divorced	281	15.1%	3,448	12.1%	17,936	10.8%
Household Type (2024)						
Population Family	1,936	82.3%	29,631	84.7%	173,808	84.1%
Population Non-Family	382	16.2%	4,975	14.2%	28,645	13.9%
Population Group Quarters	35	1.5%	373	1.1%	4,112	2.0%
Family Households	612	64.3%	9,421	69.7%	54,642	70.7%
Non-Family Households	339	35.7%	4,090	30.3%	22,661	29.3%
Married Couple with Children	175	21.2%	3,209	21.0%	20,810	22.4%
Average Family Household Size	3.2		3.1		3.2	
Household Size (2024)						
1 Person Households	297	31.2%	3,473	25.7%	19,547	25.3%
2 Person Households	271	28.5%	5,578	41.3%	31,665	41.0%
3 Person Households	164	17.3%	1,826	13.5%	11,277	14.6%
4 Person Households	129	13.6%	1,541	11.4%	8,962	11.6%
5 Person Households	65	6.9%	750	5.5%	3,915	5.1%
6 or More Person Households	24	2.6%	343	2.5%	1,937	2.5%
Household Vehicles (2024)						
Households with 0 Vehicles Available	36	3.8%	340	2.5%	2,253	2.9%
Households with 1 Vehicles Available	282	29.7%	3,526	26.1%	19,312	25.0%
Households with 2 or More Vehicles Available	633	66.5%	9,646	71.4%	55,738	72.1%
Total Vehicles Available	1,810		28,185		162,584	
Average Vehicles Per Household	1.9		2.1		2.1	

Expanded Profile

2010-2020 Census, 2024 Estimates with 2029 Projections
Calculated using Weighted Block Centroid from Block Groups

Lat/Lon: 39.4531/-84.1815

1235 Columbus Ave		1 mi radius		5 mi radius		10 mi radius	
Lebanon, OH 45036							
Labor Force (2024)							
Estimated Labor Population Age 16 Years or Over	1,816		27,912		163,526		
Estimated Civilian Employed	1,200	66.1%	16,656	59.7%	99,051	60.6%	
Estimated Civilian Unemployed	8	0.5%	475	1.7%	3,709	2.3%	
Estimated in Armed Forces	-	-	53	0.2%	320	0.2%	
Estimated Not in Labor Force	607	33.4%	10,729	38.4%	60,447	37.0%	
Unemployment Rate	0.5%		1.7%		2.3%		
Occupation (2024)							
Occupation: Population Age 16 Years or Over	1,237		16,596		99,846		
Management, Business, Financial Operations	67	5.4%	2,498	15.1%	19,517	19.5%	
Professional, Related	236	19.1%	4,416	26.6%	29,567	29.6%	
Service	237	19.2%	2,475	14.9%	12,733	12.8%	
Sales, Office	279	22.6%	3,044	18.3%	18,127	18.2%	
Farming, Fishing, Forestry	109	8.8%	270	1.6%	563	0.6%	
Construct, Extraction, Maintenance	64	5.2%	1,428	8.6%	7,372	7.4%	
Production, Transport Material Moving	245	19.8%	2,464	14.8%	11,967	12.0%	
White Collar Workers	582	47.1%	9,959	60.0%	67,211	67.3%	
Blue Collar Workers	654	52.9%	6,637	40.0%	32,635	32.7%	
Consumer Expenditure (2024)							
Total Household Expenditure	\$58.76 M		\$1.07 B		\$6.67 B		
Total Non-Retail Expenditure	\$30.91 M	52.6%	\$567.45 M	52.8%	\$3.53 B	53.0%	
Total Retail Expenditure	\$27.84 M	47.4%	\$506.83 M	47.2%	\$3.14 B	47.0%	
Apparel	\$2.06 M	3.5%	\$38.11 M	3.5%	\$238.62 M	3.6%	
Contributions	\$1.87 M	3.2%	\$36.57 M	3.4%	\$234.55 M	3.5%	
Education	\$1.63 M	2.8%	\$33.96 M	3.2%	\$223.4 M	3.3%	
Entertainment	\$3.3 M	5.6%	\$62.01 M	5.8%	\$388.82 M	5.8%	
Food and Beverages	\$8.71 M	14.8%	\$156.5 M	14.6%	\$964.13 M	14.5%	
Furnishings and Equipment	\$2.05 M	3.5%	\$38.48 M	3.6%	\$240.72 M	3.6%	
Gifts	\$1.4 M	2.4%	\$27.6 M	2.6%	\$179 M	2.7%	
Health Care	\$5.02 M	8.5%	\$89.74 M	8.4%	\$548.98 M	8.2%	
Household Operations	\$2.28 M	3.9%	\$42.66 M	4.0%	\$267.99 M	4.0%	
Miscellaneous Expenses	\$1.11 M	1.9%	\$20.44 M	1.9%	\$127.35 M	1.9%	
Personal Care	\$788.4 K	1.3%	\$14.42 M	1.3%	\$89.48 M	1.3%	
Personal Insurance	\$401.83 K	0.7%	\$7.95 M	0.7%	\$50.72 M	0.8%	
Reading	\$127.45 K	0.2%	\$2.37 M	0.2%	\$14.79 M	0.2%	
Shelter	\$12.42 M	21.1%	\$225.01 M	20.9%	\$1.39 B	20.9%	
Tobacco	\$366.96 K	0.6%	\$5.92 M	0.6%	\$34.58 M	0.5%	
Transportation	\$10.85 M	18.5%	\$196.08 M	18.3%	\$1.21 B	18.1%	
Utilities	\$4.39 M	7.5%	\$76.47 M	7.1%	\$463.84 M	7.0%	
Educational Attainment (2024)							
Adult Population Age 25 Years or Over	1,557		23,708		140,432		
Elementary (Grade Level 0 to 8)	18	1.1%	526	2.2%	2,753	2.0%	
Some High School (Grade Level 9 to 11)	36	2.3%	703	3.0%	4,818	3.4%	
High School Graduate	853	54.8%	8,333	35.1%	41,611	29.6%	
Some College	240	15.4%	4,141	17.5%	24,278	17.3%	
Associate Degree Only	179	11.5%	2,147	9.1%	11,799	8.4%	
Bachelor Degree Only	138	8.9%	4,813	20.3%	32,110	22.9%	
Graduate Degree	93	6.0%	3,045	12.8%	23,064	16.4%	

Expanded Profile

2010-2020 Census, 2024 Estimates with 2029 Projections
Calculated using Weighted Block Centroid from Block Groups

Lat/Lon: 39.4531/-84.1815

1235 Columbus Ave Lebanon, OH 45036

1 mi radius

5 mi radius

10 mi radius

Units In Structure (2024)

1 Detached Unit	519	64.3%	9,604	81.7%	59,431	97.9%
1 Attached Unit	54	6.7%	702	6.0%	4,276	7.0%
2 to 4 Units	239	29.6%	1,336	11.4%	4,331	7.1%
5 to 9 Units	46	5.7%	611	5.2%	2,519	4.1%
10 to 19 Units	48	5.9%	832	7.1%	4,040	6.7%
20 to 49 Units	35	4.3%	267	2.3%	1,362	2.2%
50 or More Units	11	1.4%	149	1.3%	982	1.6%
Mobile Home or Trailer	-	-	11	-	350	0.6%
Other Structure	-	-	-	-	12	-

Homes Built By Year (2024)

Homes Built 2010 or later	91	11.2%	1,596	13.6%	14,556	24.0%
Homes Built 2000 to 2009	92	11.4%	2,891	24.6%	19,196	31.6%
Homes Built 1990 to 1999	167	20.7%	2,539	21.6%	13,227	21.8%
Homes Built 1980 to 1989	161	19.9%	1,106	9.4%	5,760	9.5%
Homes Built 1970 to 1979	129	16.0%	1,697	14.4%	7,280	12.0%
Homes Built 1960 to 1969	51	6.4%	814	6.9%	5,212	8.6%
Homes Built 1950 to 1959	169	20.9%	1,484	12.6%	6,621	10.9%
Homes Built Before 1949	91	11.3%	1,383	11.8%	5,450	9.0%

Home Values (2024)

Home Values \$1,000,000 or More	3	0.7%	93	1.0%	829	1.4%
Home Values \$500,000 to \$999,999	29	6.2%	1,468	15.4%	9,796	16.4%
Home Values \$400,000 to \$499,999	21	4.4%	1,390	14.6%	8,564	14.4%
Home Values \$300,000 to \$399,999	42	8.8%	1,923	20.2%	13,842	23.2%
Home Values \$200,000 to \$299,999	264	55.7%	2,743	28.8%	14,736	24.7%
Home Values \$150,000 to \$199,999	59	12.4%	934	9.8%	5,114	8.6%
Home Values \$100,000 to \$149,999	41	8.6%	608	6.4%	3,778	6.3%
Home Values \$70,000 to \$99,999	9	1.9%	125	1.3%	1,137	1.9%
Home Values \$50,000 to \$69,999	-	-	45	0.5%	423	0.7%
Home Values \$25,000 to \$49,999	-	-	84	0.9%	467	0.8%
Home Values Under \$25,000	4	0.9%	98	1.0%	911	1.5%
Owner-Occupied Median Home Value	\$244,271		\$320,811		\$326,825	
Renter-Occupied Median Rent	\$1,034		\$988		\$1,027	

Transportation To Work (2024)

Drive to Work Alone	969	78.4%	13,150	79.2%	75,492	75.6%
Drive to Work in Carpool	165	13.3%	1,366	8.2%	6,446	6.5%
Travel to Work by Public Transportation	1	-	102	0.6%	447	0.4%
Drive to Work on Motorcycle	-	-	-	-	39	-
Walk or Bicycle to Work	2	0.1%	144	0.9%	852	0.9%
Other Means	-	-	45	0.3%	486	0.5%
Work at Home	99	8.0%	1,789	10.8%	16,084	16.1%

Travel Time (2024)

Travel to Work in 14 Minutes or Less	565	45.7%	3,488	21.0%	16,965	17.0%
Travel to Work in 15 to 29 Minutes	310	25.1%	5,410	32.6%	32,809	32.9%
Travel to Work in 30 to 59 Minutes	255	20.7%	5,347	32.2%	29,485	29.5%
Travel to Work in 60 Minutes or More	7	0.6%	562	3.4%	4,503	4.5%
Average Minutes Travel to Work	14.5		24.5		25.0	