



FOR LEASE up to 27,305 sf

80 Spring Lane
Plainville, Connecticut



BUILDING SPECIFICATIONS

Building Size:	43,444 Square Feet		
Available:	8,611 to 27,305 SF (can combine or subdivide)		
Land:	8.2 acres	Zoning:	RI (Industrial)
Ceiling Height:	14'		
Parking:	291 paved spaces		
Year Built:	1984 / 1987 (expansion)		
Loading:	Drive-in Door, Dock-High Possible		
Construction:	Walls:	Masonry / Brick / Glass	
	Columns:	52 'x 52' & 32' x 50'	
	Roof:	Membrane	
	Floor:	Concrete	
Mechanicals:	Heat:	Gas Fired, Variable Air Volume Heating	
	AC:	100% 7 Roof top mounted TRANE units	
	Electrical:	1,200 amps @ 480/277 volts, 3-Phase	
	Sprinkler:	Wet System	
	Lighting:	Fluorescent	
	Generator:	On-site	
Taxes:	\$1.38 per SF		
Asking Rent:	\$8.00 NNN		



80 SPRING LANE
Plainville, Connecticut



80 SPRING LANE PLAINVILLE, CONNECTICUT

AVAILABLE
Up to 27,305 sf

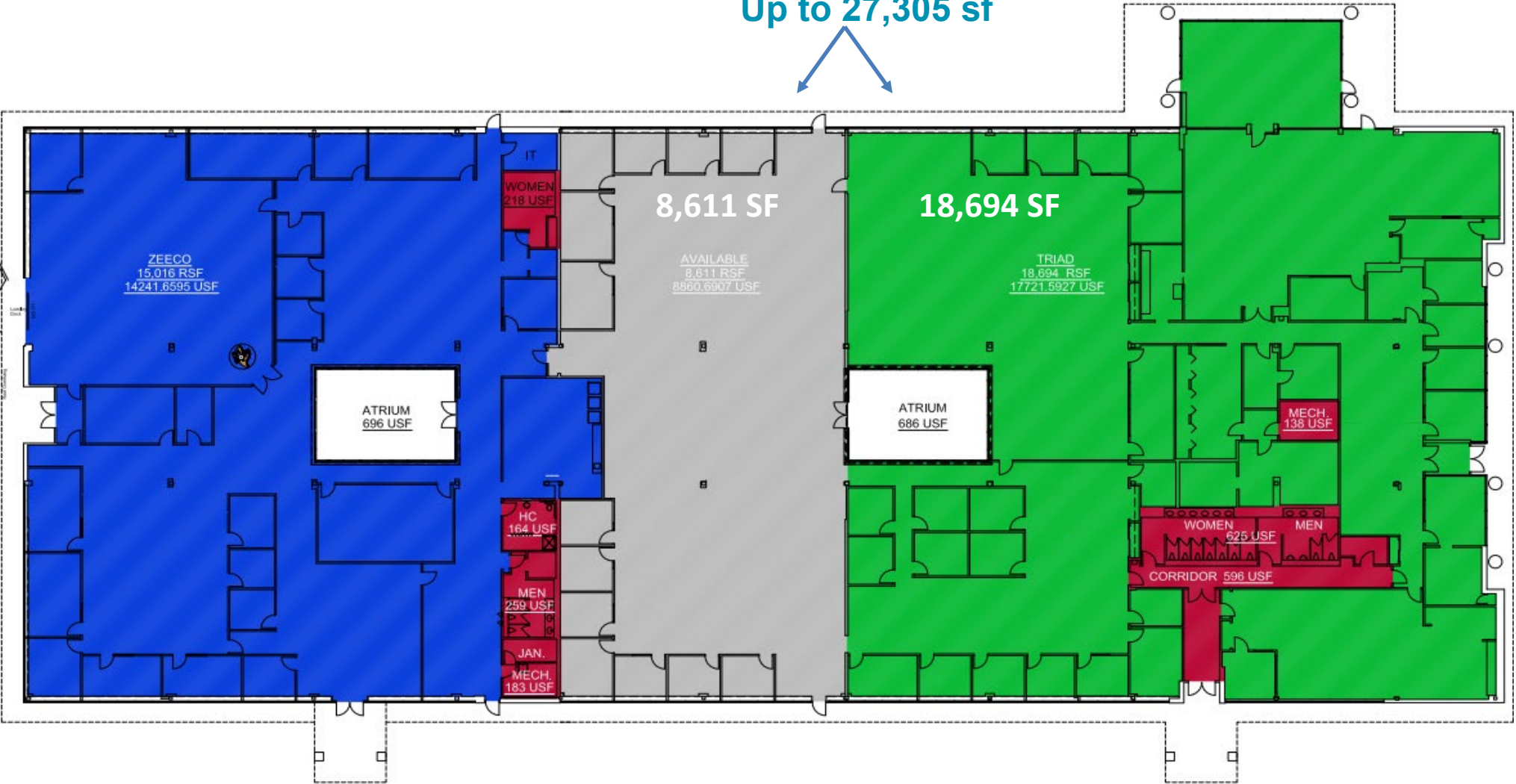

- Located in the Farmington Industrial Park
- Multi-purpose office/flex facility adaptable for a variety of uses and easily subdivided
- Flexible suites of 18,694 SF and 8,611 SF, may be subdivided or combined
- Two interior landscaped courtyards
- Easy access to I-84, CT 72, & CT 9

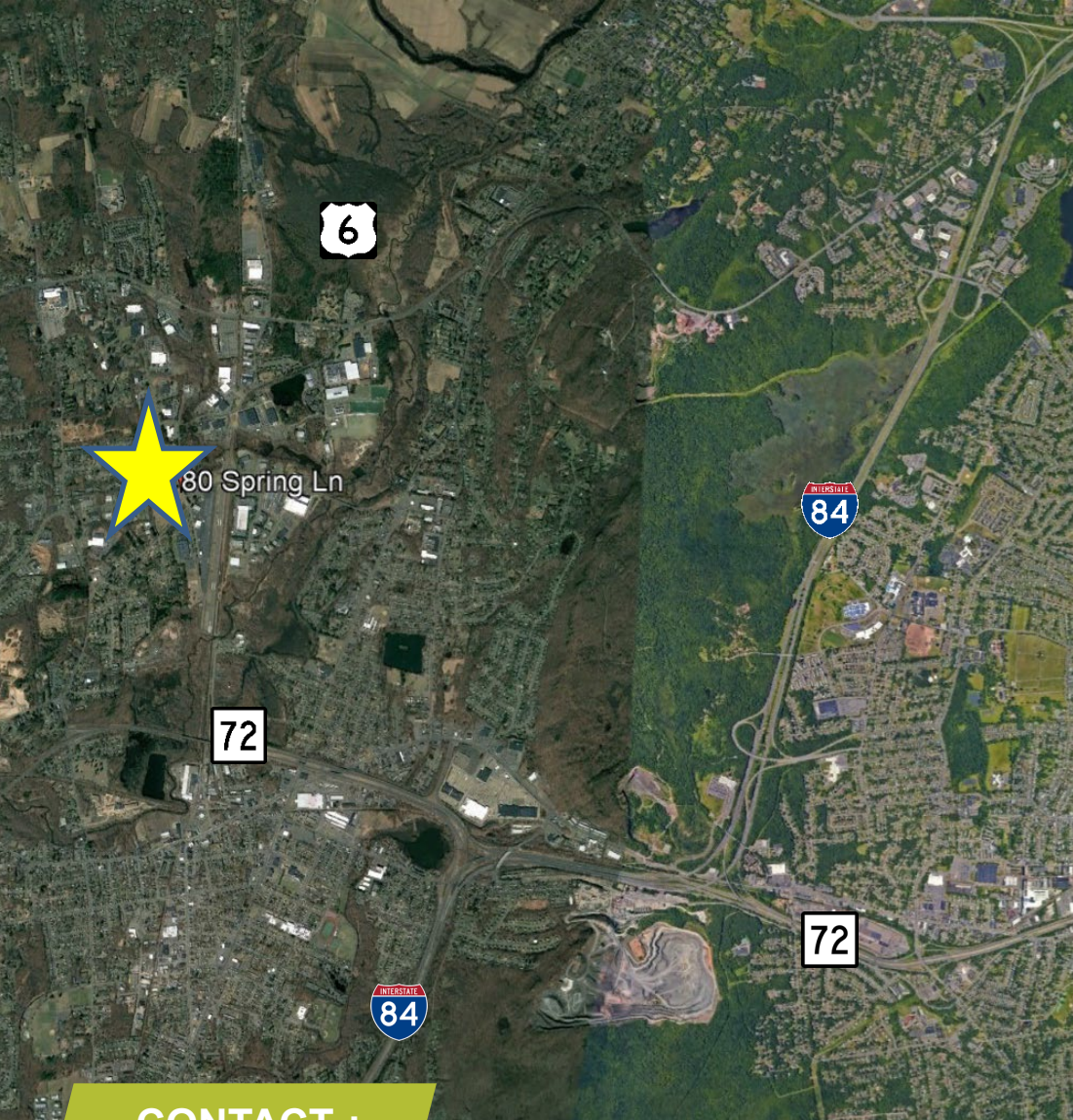

CONTACT :

SEAN DUFFY
Executive Director
+1 860 616 1435
Sean.Duffy@cushwake.com

DAMON BOWERS
Director
+1 860 616 1433
Damon.Bowers@cushwake.com

©2023 Cushman & Wakefield. All rights reserved. The material in this presentation has been prepared solely for information purposes and is strictly confidential. Any disclosure, use, copying or circulation of this presentation (or the information contained within it) is strictly prohibited, unless you have obtained Cushman & Wakefield's prior written consent. The views expressed in this presentation are the views of the author and do not necessarily reflect the views of Cushman & Wakefield. Neither this presentation nor any part of it shall form the basis of, or be relied upon in connection with any offer, or act as an inducement to enter into any contract or commitment whatsoever. NO REPRESENTATION OR WARRANTY IS GIVEN, EXPRESS OR IMPLIED, AS TO THE ACCURACY OF THE INFORMATION CONTAINED WITHIN THIS PRESENTATION, AND CUSHMAN & WAKEFIELD IS UNDER NO OBLIGATION TO SUBSEQUENTLY CORRECT IT IN THE EVENT OF ERRORS.

