



Zach Roski
Senior Vice President
+1 804 267 7256
zach.roski@colliers.com

1415 Eastridge Rd., Richmond, VA

Located in the heart of the West End and near
the reinvigorated Regency Mall

- Approximately 2,500 SF
- Zoning B-1
- 24 striped parking spaces, additional parking available on site
- Lot size is approximately 2/3 of an acre
- Great signage potential

2221 Edward Holland Dr
Suite 600 | Richmond, VA
P: +1 804 320 5500
colliers.com/richmond

Approximately 2,500 SF

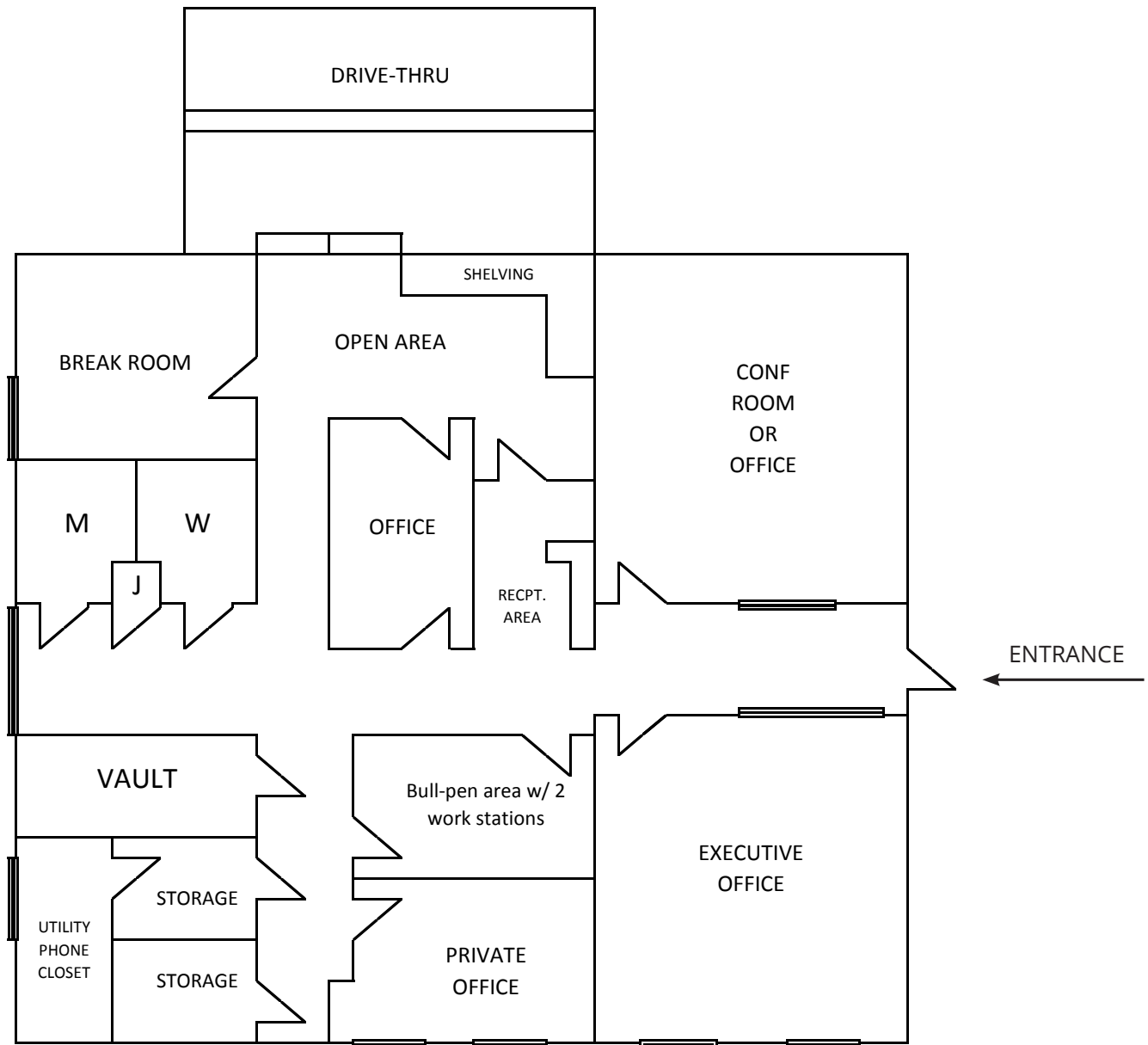

1415 Eastridge Rd



1415 Eastridge Rd



New Media Systems, Inc.
804.397.3420
www.newmediasystems.net



Contact us:

Zach Roski

Senior Vice President

+1 804 267 7256

zach.roski@colliers.com

Colliers

2221 Edward Holland Dr

Suite 600 | Richmond, VA

P: +1 804 320 5500