

3225 Third Avenue

CORNER OF 163RD & 3RD | MELROSE

Over 7,500 SF
Prime Retail Corner
Available for Lease



3225 Third Avenue
Corner of 163rd & 3rd | Melrose

Corner of 163rd & 3rd | Melrose

SIZE: 7,500 SF Ground Floor

FRONTAGE: 100' Wraparound

CEILING HEIGHT: 10'+

POSSESSION: Arranged

TRANSPORTATION: 2 5

HIGHLIGHTS:

- Former Duane Reade
- Heavy foot traffic corner
- Adjacent to Bx6, Bx15, and Bx21 bus stops
- Short walk from Prospect Ave subway station

Neighbors include:



CONTACT OUR BROKERS FOR MORE INFORMATION:

MARC SITT

MSitt@ksrny.com
917.757.8863

MILES SABBAGH

Miles@ksrny.com
646.894.3176



All information supplied in this marketing presentation and/or flyer is from sources deemed reliable and is furnished subject to errors, omissions, modifications, removal of listings from sale/lease and to any listing condition. Any square footage, dimensions, floor plans and/or technical data set forth are approximations and are subject to further elaboration/confirmation.

3225 Third Avenue

Corner of 163rd & 3rd | Melrose

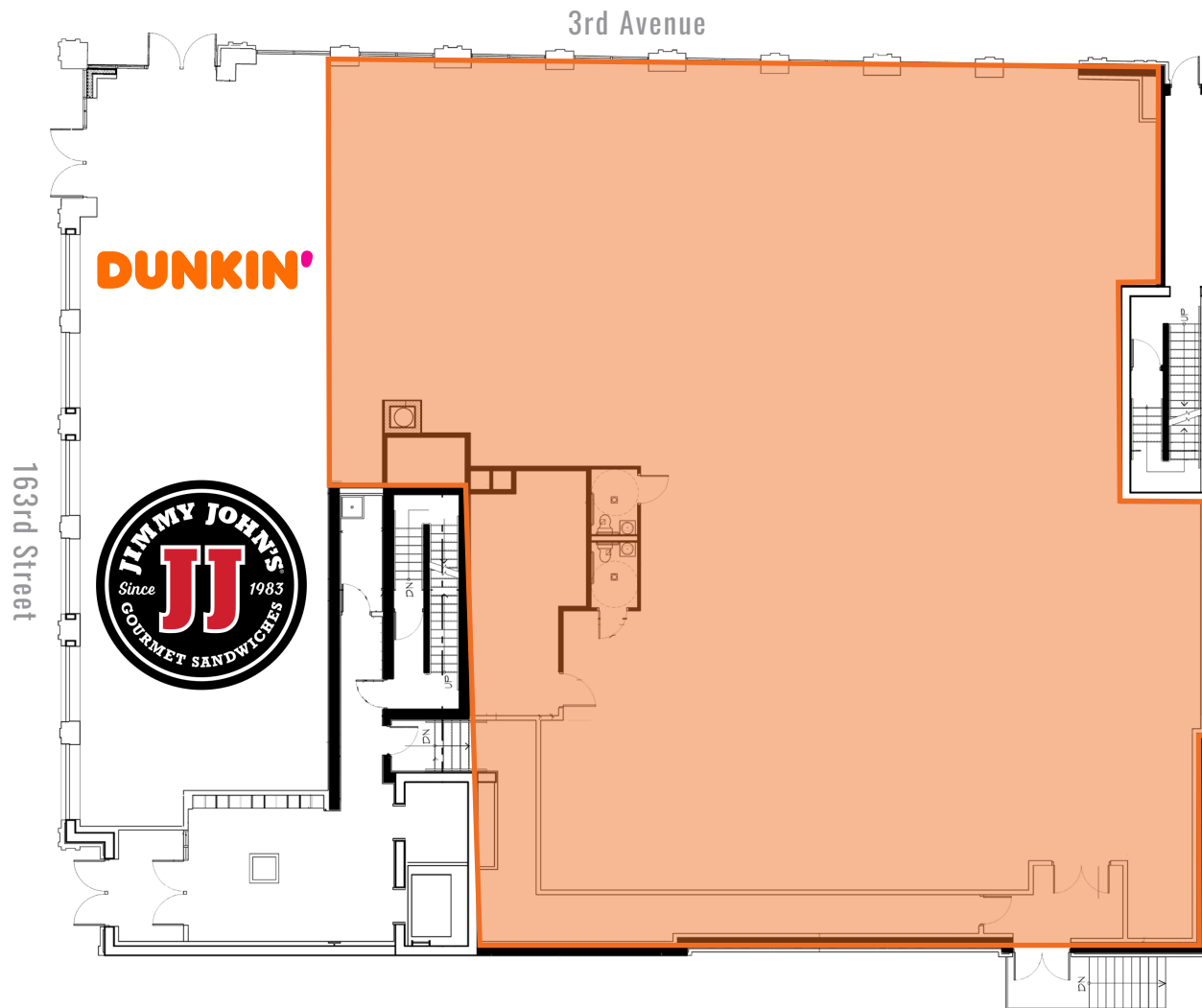

CONTACT OUR BROKERS FOR MORE INFORMATION:

MARC SITT
MSitt@ksrny.com
917.757.8863

MILES SABBAGH
Miles@ksrny.com
646.894.3176

All information supplied in this marketing presentation and/or flyer is from sources deemed reliable and is furnished subject to errors, omissions, modifications, removal of listings from sale/lease and to any listing condition. Any square footage, dimensions, floor plans and/or technical data set forth are approximations and are subject to further elaboration/confirmation.



3225 Third Avenue

Corner of 163rd & 3rd | Melrose

Interiors



CONTACT OUR BROKERS FOR MORE INFORMATION:

MARC SITT
MSitt@ksrny.com
917.757.8863

MILES SABBAGH
Miles@ksrny.com
646.894.3176

All information supplied in this marketing presentation and/or flyer is from sources deemed reliable and is furnished subject to errors, omissions, modifications, removal of listings from sale/lease and to any listing condition. Any square footage, dimensions, floor plans and/or technical data set forth are approximations and are subject to further elaboration/confirmation.

