

AVAILABLE FOR LEASE

2727 FIRE ROAD

EGG HARBOR TWP, NEW JERSEY



GREAT RATE! \$5,250 PER MONTH GROSS

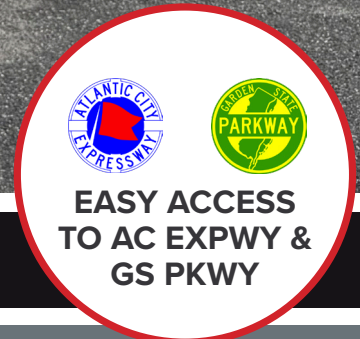

4,500± SF REMAINING FOR LEASE | 4,500± SF JUST LEASED!

CONTACT

JONATHAN KLEAR

+1 856 433 1801

jonathan.klear@naimertz.com



PROPERTY DETAILS

2727 FIRE ROAD EGG HARBOR TWP, NJ



SPACE AVAIL

**4,500±
SQ. FEET**



CEILING
HEIGHT

**20'
CLEAR**



LOADING

**1 DRIVE-IN
(10'x14')**

BUILDING DETAILS

- 9,000+/- SF office/flex building
- 1,000 SF of office
- 8,000 SF of warehouse
- 20' clear ceiling at eaves
- Two (2) drive-in overhead doors:
 - (1) 10'x14' and (1) 12'x14'
- 80'x100' clear span
- 200 amp, 208/120 Volt, 3 Phase Service
- Natural gas
- Well water/on site septic
- Multiple parking spaces



CONTACT

JONATHAN KLEAR

+1 856 433 1801

jonathan.klear@naimertz.com

NAIMertz

FLOORPLAN

2727 FIRE ROAD EGG HARBOR TWP, NJ

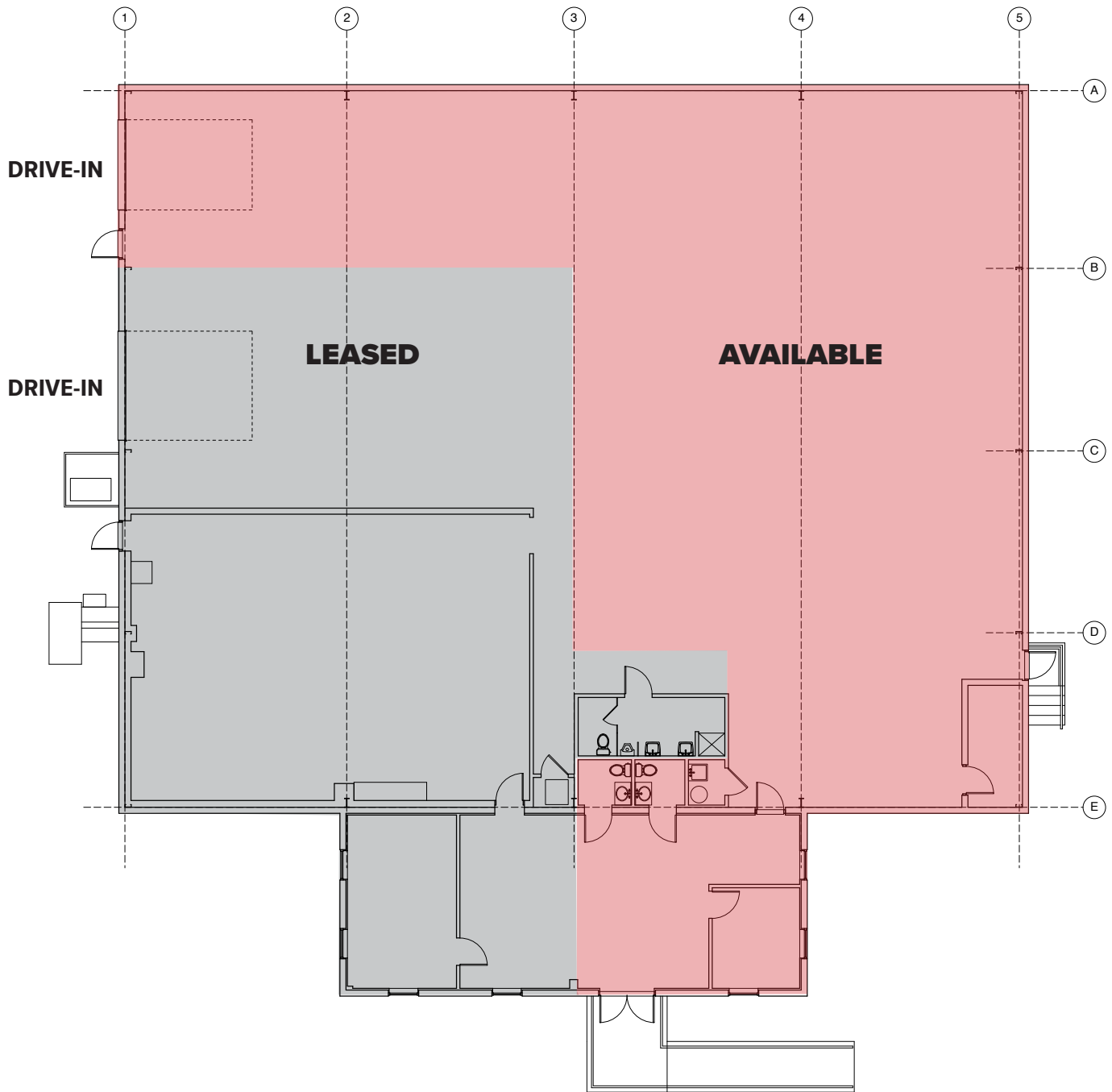

CONTACT

JONATHAN KLEAR

+1 856 433 1801

jonathan.klear@naimertz.com

Naimertz

LOCATION INFORMATION

2727 FIRE ROAD EGG HARBOR TWP, NJ



DISTANCE TO:

Garden State Parkway	0.8 mi
Atlantic City Expressway	1.3 mi
Atlantic City	7.5 mi
Philadelphia	53 mi
New York City	119 mi

CONTACT

JONATHAN KLEAR

+1 856 433 1801

jonathan.klear@naimertz.com

