

# FIREWHEEL COMMERCE CENTER

2360 Crist Rd, Suite 700 | Garland TX 75040

**17,277 SF  
FOR LEASE**



## PROPERTY HIGHLIGHTS

- 17,277 SF Available
- Immediate access to the George Bush Tollway
- Frontage on Highway 78
- 18' Clear Height
- Built in 2008
- 100% HVAC

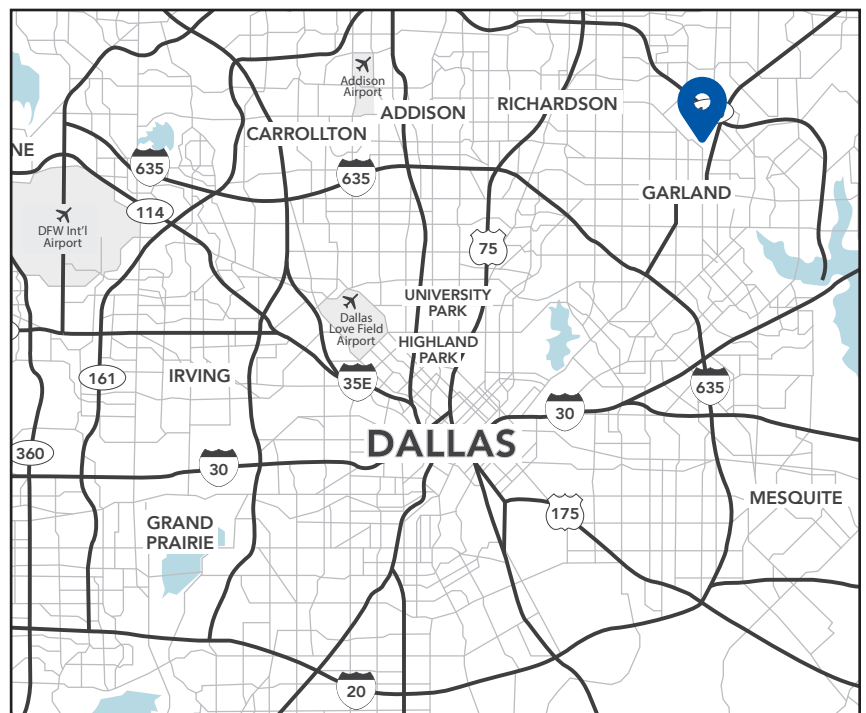

Bob Hagewood  
214.267.0471  
bhagewood@streamrealty.com



# FIREWHEEL COMMERCE CENTER

2360 Crist Rd, Suite 700 | Garland TX 75040

**17,277 SF  
FOR LEASE**

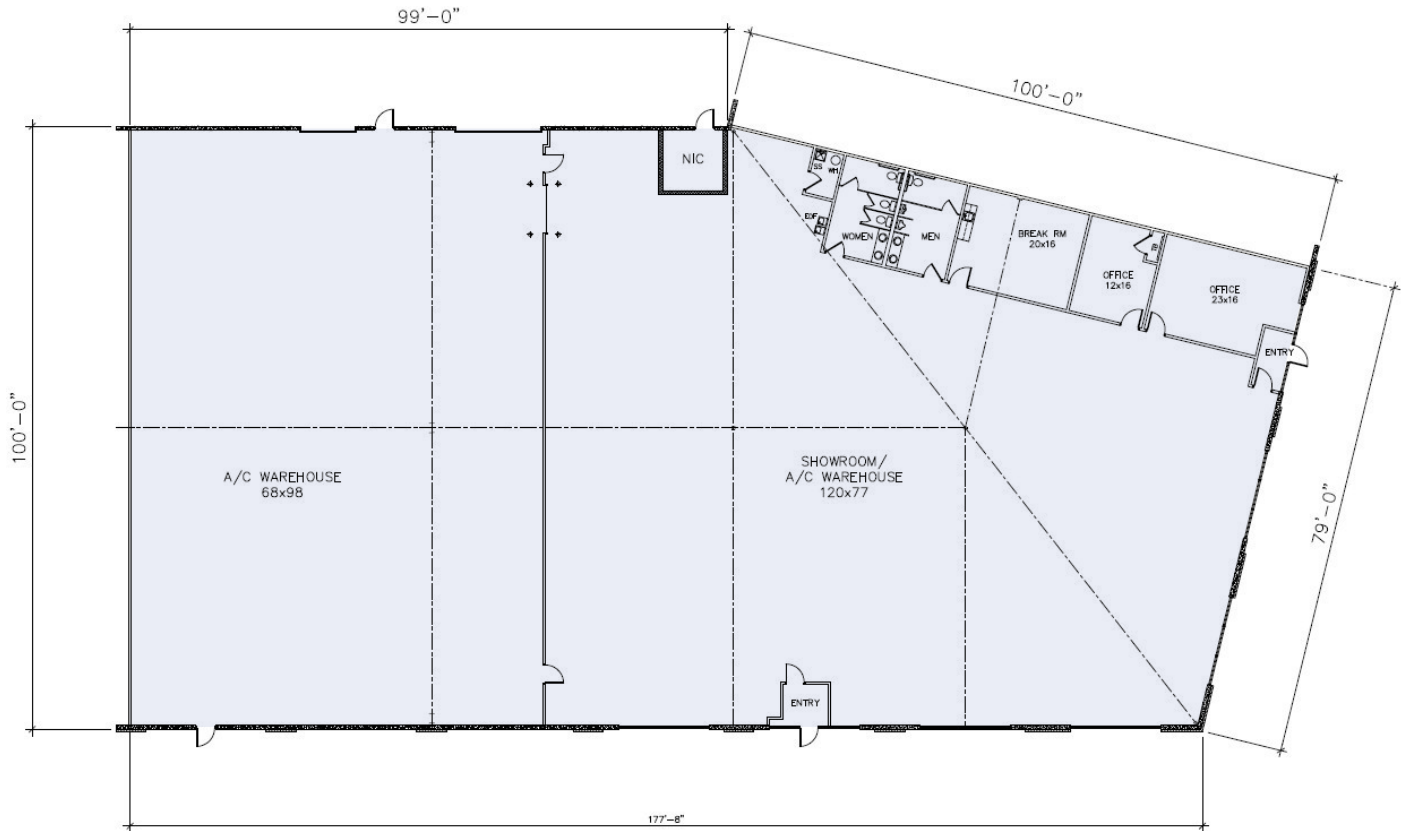

## PROPERTY HIGHLIGHTS

- 17,277 SF Available
- 1,373 SF Office
- 9,240 SF AC Lab/Showroom
- 6,664 SF AC Warehouse
- (1) - 9' x 10' Grade Level Door
- 14' x 14' Grade Level Door
- 18' Clear Height



**Bob Hagewood**  
214.267.0471  
bhagewood@streamrealty.com

