

# 1360-1363 Leesburg Ave

Washington Court House, OH 43160

FOR LEASE | 1600SF - 9600SF | RETAIL



## HIGHLIGHTS

- ▶ **Size - 1,600 - 9,600 SF | Divisible**
- ▶ **Rate - Negotiable**
- ▶ **Opex - \$2.35/SF**
- ▶ **Walmart-Anchored Center - Prime location with strong daily traffic**
- ▶ **Flexible Space - Can be demised to meet tenant requirements**
- ▶ **Ample Parking - Easy access for customers**
- ▶ **High Visibility - Monument signage available**
- ▶ **Strong Customer Base - 262K+ annual customers / 2.2M+ annual visits**
- ▶ **Join National & Regional Tenants - T-Mobile, Jackson Hewitt, Top Nails, Cricket, Shoe Show & more**
- ▶ **Strategic Location - Close to Southern State Community College**

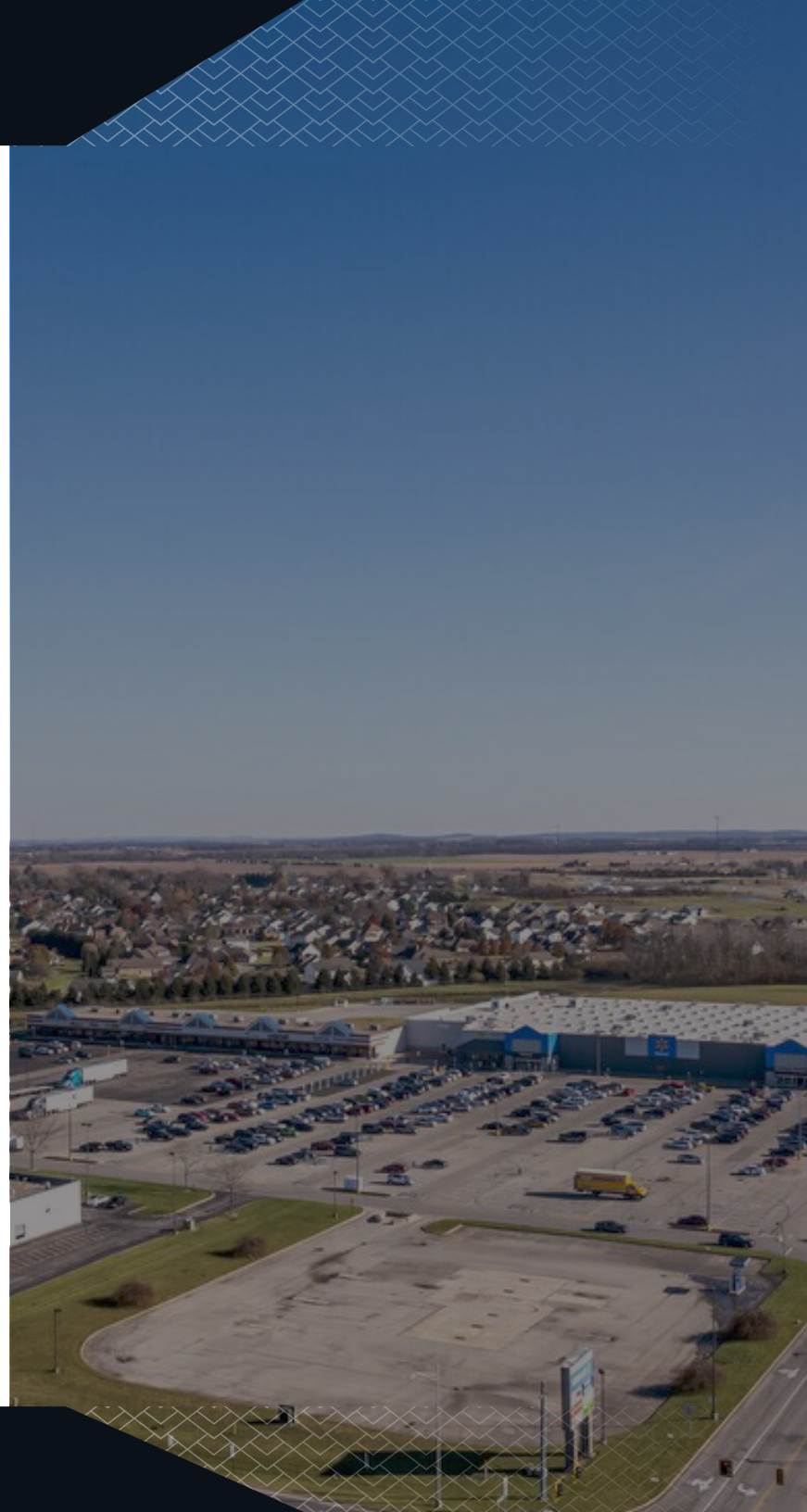



# 1360-1363

Leesburg Ave  
FOR LEASE

## SITE PLAN

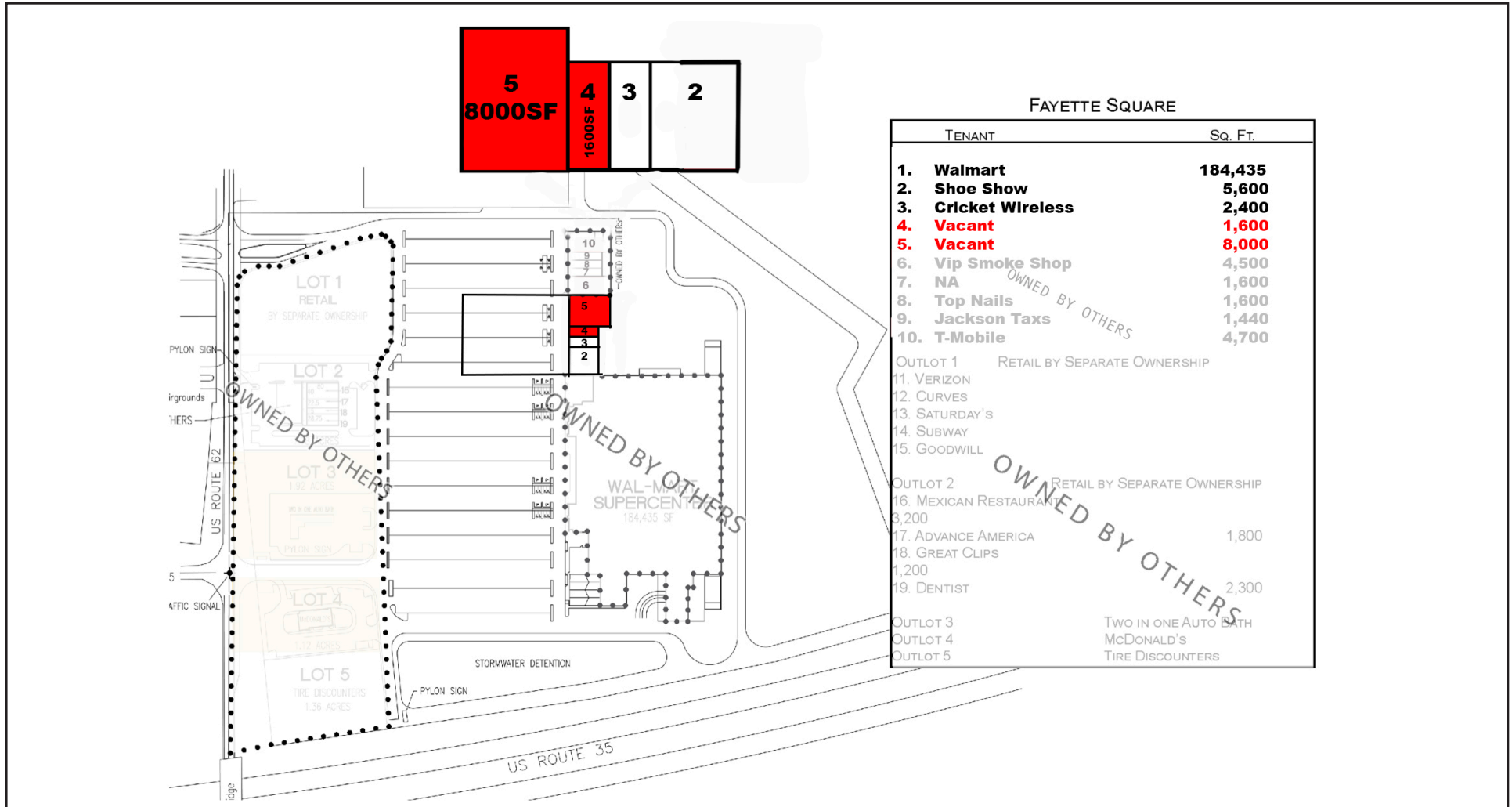

FOR LEASE

**Architectural Floor Plan: Suite 5 and Suite 4**

**Suite 5 Dimensions:** 83'-5" (Left), 14'-8" (Top), 78'-7" (Bottom), 20'-0" (Right)

**Suite 4 Dimensions:** 30'-0" (Right)

**Rooms and Features in Suite 5:**

- STOCK ROOM (Top Left)
- CHANGING ROOMS (Top Center)
- CASH WRAP / POS (Center)
- RETAIL STORAGE ROOM (Bottom Center)
- TOILET (Top Right)
- STORAGE (Top Right)
- WATER METER (Top Right)
- MOP SINK (Top Right)
- ELECTRIC METER (Top Left)
- ELECTRIC PANELS (Top Left)
- GAS METER (Top Right)
- 3'-6" x 1'-6" HM DOOR (Top Right)
- 3'-6" x 1'-6" HM DOOR (Right)
- LOOSE FIXTURES AROUND PERIMETER (Right)
- FLOORING TRANSITIONS (Left and Right)
- LOOSE FIXTURE (Center)
- LOOSE FIXTURE (Center)
- PULL HEIGHT STOREFRONT (Bottom Left)
- PULL HEIGHT STOREFRONT (Bottom Right)
- COVERED SIDEWALK (Bottom)
- FULL GLASS DOORS (Bottom)
- GYP. SOFFIT ABOVE (Bottom)

**Plan Notes:**

- INTERIOR FLOOR AREA = 9,604 SF
- EXISTING CEILING HEIGHT = 11'-0" AFF
- BOTTOM OF ROOF JOISTS = 15'-3" AFF
- BOTTOM OF ROOF DECK = 18'-8" AFF

# 1360-1363

Leesburg Ave  
FOR LEASE

## DEMOGRAPHICS

	1 Mile	3 Mile	5 Mile
Population	2193	15,826	18,438
Median Age	47	42	42
Total Households	890	6,586	7,832
Household Income	\$92K	\$76K	\$77K

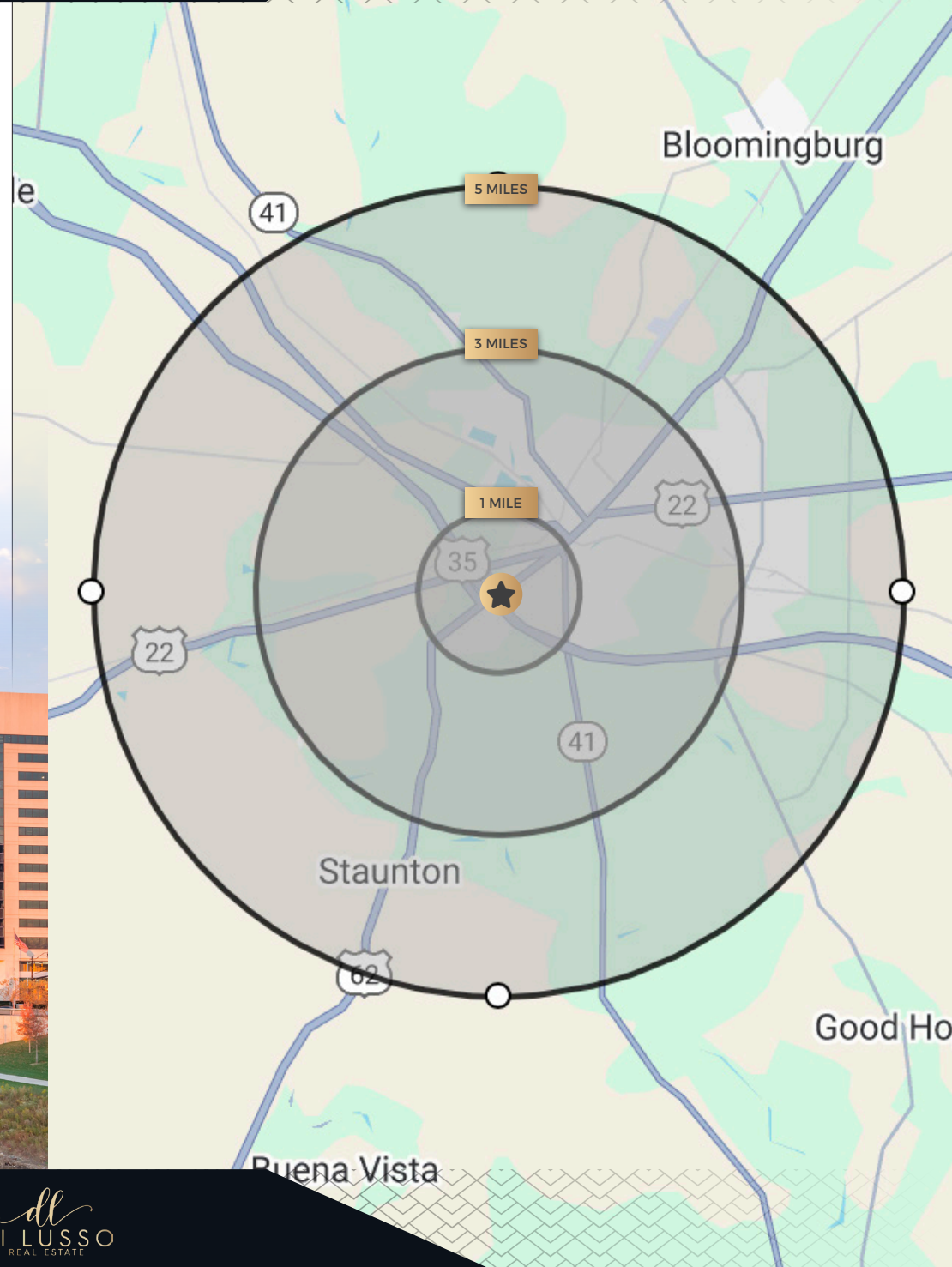



# 1360-1363

Leesburg Ave  
FOR LEASE

## TRAFFIC MAP

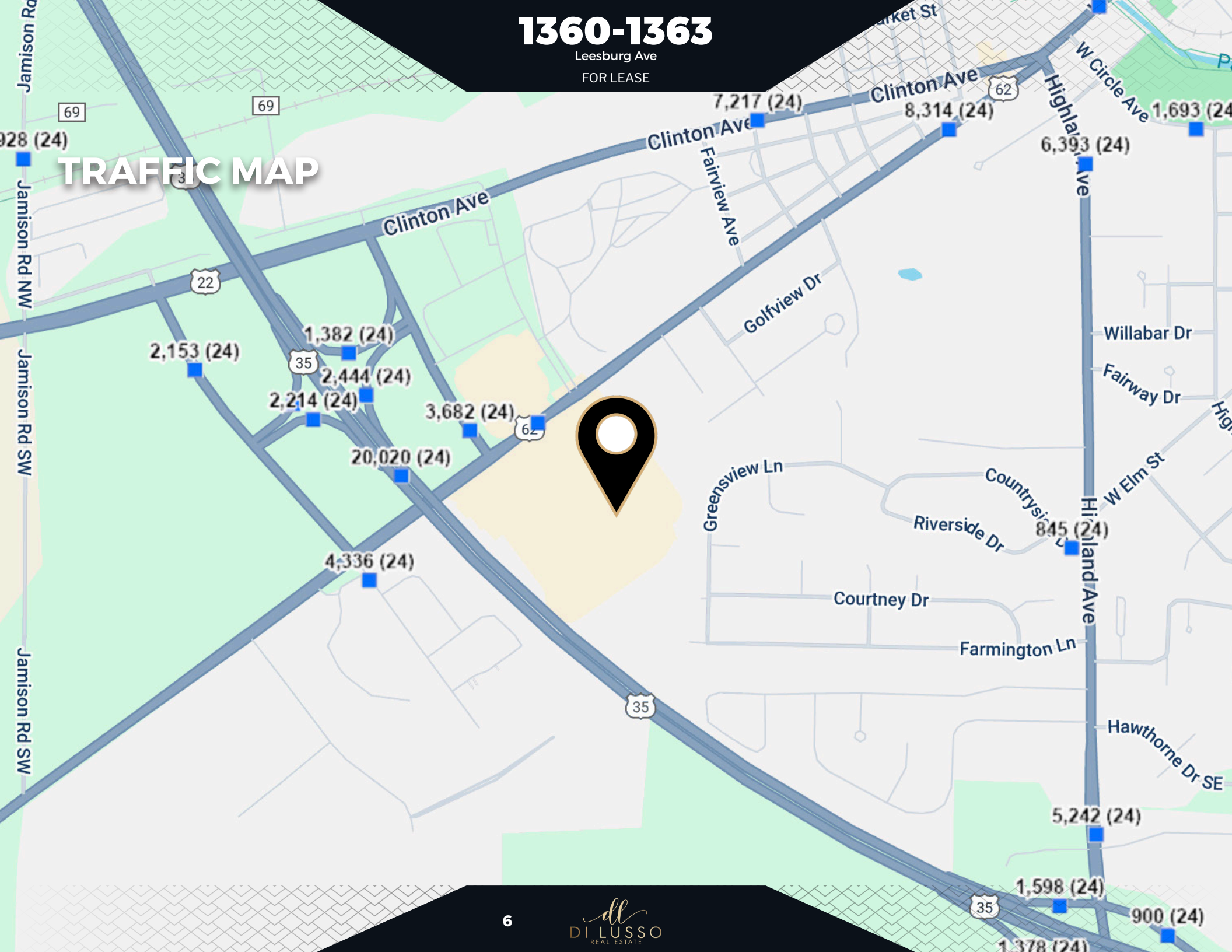

# 1360-1363

Leesburg Ave

FOR LEASE

## LOCATION MAP



Google Earth



# 1360-1363 Leesburg Ave

Washington Court House OH 43160



**Fisal Ikhmayes**

Di Lusso Real Estate

(614) 900-1000

Fisal@MyOhioAgency.com

## Disclaimer

This Offering Memorandum has been prepared by Di Lusso Real Estate for information purposes only and does not constitute an offer to sell or a solicitation of an offer to buy any property. The information contained herein has been obtained from sources deemed reliable; however, Di Lusso Real Estate makes no guarantees, warranties, or representations as to the completeness or accuracy thereof. Any projections, opinions, assumptions, or estimates used are for example only and do not represent the current or future performance of the property.

Prospective purchasers should conduct their own independent due diligence and analysis, including verification of zoning, permitted uses, legal descriptions, square footage, and all other information. The property is offered subject to prior sale, lease, or withdrawal from the market without notice.