



FOR SALE



**SELLER FINANCING  
AVAILABLE**

## 13225 N COLUMBIA BLVD

### Office Building with Excess Land

± 3,300 SF Building on 1.76 Acres | **Sale Price:** \$1,499,999

#### 13225 N Columbia Blvd, Portland, OR 97203

- Plug-and-Play Office/HQ Opportunity w/ High-End Finishes
- Large Fenced/Secured Parking Area
- Excess (Unimproved) Land with Future Development/Yard Area Potential
- Seller Financing Available

#### **BRODY COHEN, SIOR**

Senior Associate | Licensed in OR & WA

**503-517-9878**

brody@capacitycommercial.com

#### **MIKE HALE, SIOR**

Principal | Licensed in OR & WA

**503-517-7129**

mikehale@capacitycommercial.com

#### **RYAN BOWERS**

Associate | Licensed in OR & WA

**503-517-9874**

ryanbowers@capacitycommercial.com





## PROPERTY SUMMARY

**FOR  
SALE**



### PROPERTY DETAILS

Address	13225 N Columbia Blvd Portland, OR 97203
Building Size	± 3,300 SF
Lot Size	1.76 AC (76,665 SF)
Construction	Masonry
Private Offices	Multiple Private Offices, Conference Rooms, Breakroom
Parking	40 Off-Street Private Parking Spaces
Zoning	IH (Heavy Industrial)
Sale Price	\$1,499,999 (Seller Financing Available)

### Location Features

- In Close Proximity to I-5 via North Columbia Blvd
- Near Port of Portland Terminals
- 11 Miles to Portland International Airport
- Multiple Access Points to CBD

### Nearby Highlights

- Amazon Distribution Center
- Cathedral Park
- Fulcrum Logistics
- IRC aluminum
- JR Simplot
- Peninsula Iron Works
- Port of Portland
- Radius Recycling
- T & G Trucking
- Time Oil Co
- US Distributng
- Western Machine Works





AERIAL



\*Average Daily Traffic Volume | Traffic Counts are Provided by REGIS Online at SitesUSA.com ©2024 | Map data ©2024 Google Imagery ©2024, Airbus, CNES / Airbus, Maxar Technologies, Metro, Portland Oregon, Public Laboratory, State of Oregon, U.S. Geological Survey, USDA/FPAC/GEO





# FLOOR PLAN

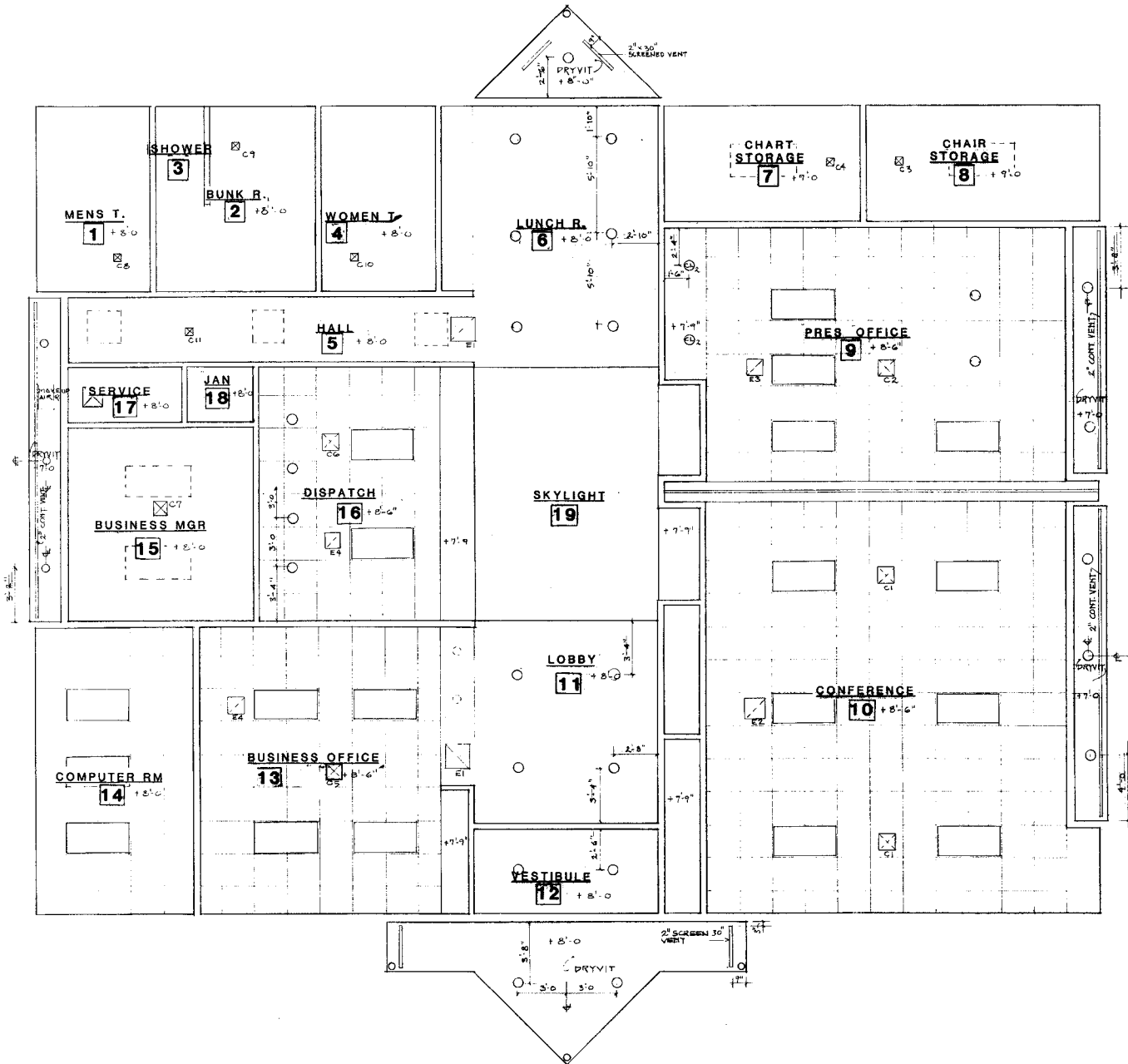





# LOCAL AERIAL MAP

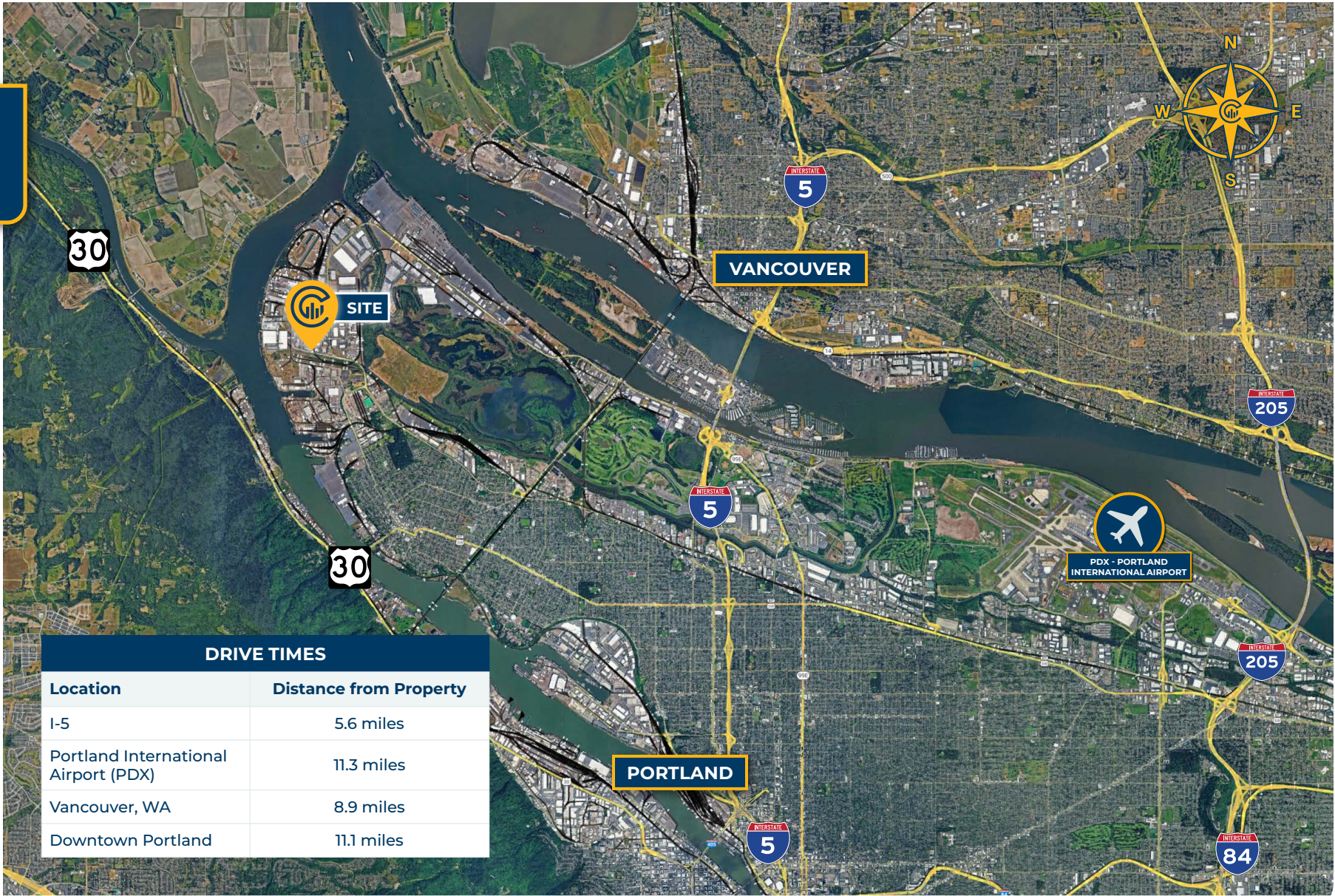

DRIVE TIMES	
Location	Distance from Property
I-5	5.6 miles
Portland International Airport (PDX)	11.3 miles
Vancouver, WA	8.9 miles
Downtown Portland	11.1 miles

\*Average Daily Traffic Volume | Traffic Counts are Provided by REGIS Online at SitesUSA.com ©2024 | Map data ©2024 Google Imagery ©2024, Airbus, CNES / Airbus, Maxar Technologies, Metro, Portland Oregon, Public Laboratory, State of Oregon, U.S. Geological Survey, USDA/FPAC/GEO

**BRODY COHEN, SIOR**  
Senior Associate | Licensed in OR & WA  
503-517-9878  
brody@capacitycommercial.com

**MIKE HALE, SIOR**  
Principal | Licensed in OR & WA  
503-517-7129  
mikehale@capacitycommercial.com

**RYAN BOWERS**  
Associate | Licensed in OR & WA  
503-517-9874  
ryanbowers@capacitycommercial.com