

FOR SALE

3,492 SF | \$2,200,000

Stand-Alone Restaurant with Drive-Thru

62080 NE 27th St., Bend, OR 97701



RARE TURNKEY RESTAURANT — OWNER/USER OR INVESTMENT OPPORTUNITY



Graham Dent, SIOR | Grant Schultz, SIOR, CCIM

600 SW Columbia St., Ste. 6100 | Bend, OR 97702

541.383.2444 | www.CompassCommercial.com

COMPASS
COMMERCIAL

**REAL
ESTATE
SERVICES**

FOR SALE

\$2,200,000

Stand-Alone Restaurant with Drive-Thru

PROPERTY DETAILS

- Avail. Space:** 3,492 SF
- Sale Price:** \$2,200,000
- Price/SF:** \$630/SF
- Lot Size:** 0.51 AC
- Year Built:** 1996
- Zoning:** Commercial General (CG)
- Parking:** Ample onsite parking

HIGHLIGHTS

- Attractive turnkey restaurant building that includes the FF&E in the sale
- Near prominent intersection of Hwy 20 and NE 27th Street
- Shadow anchored by Walgreens and Wilco
- Served by a drive-thru
- Traffic counts over 15,000 (AADT 2025) on the corner of NE 27th and NE Hwy 20
- Tenant vacating upon or prior to sale
- Do not disturb tenant

FLOOR PLAN

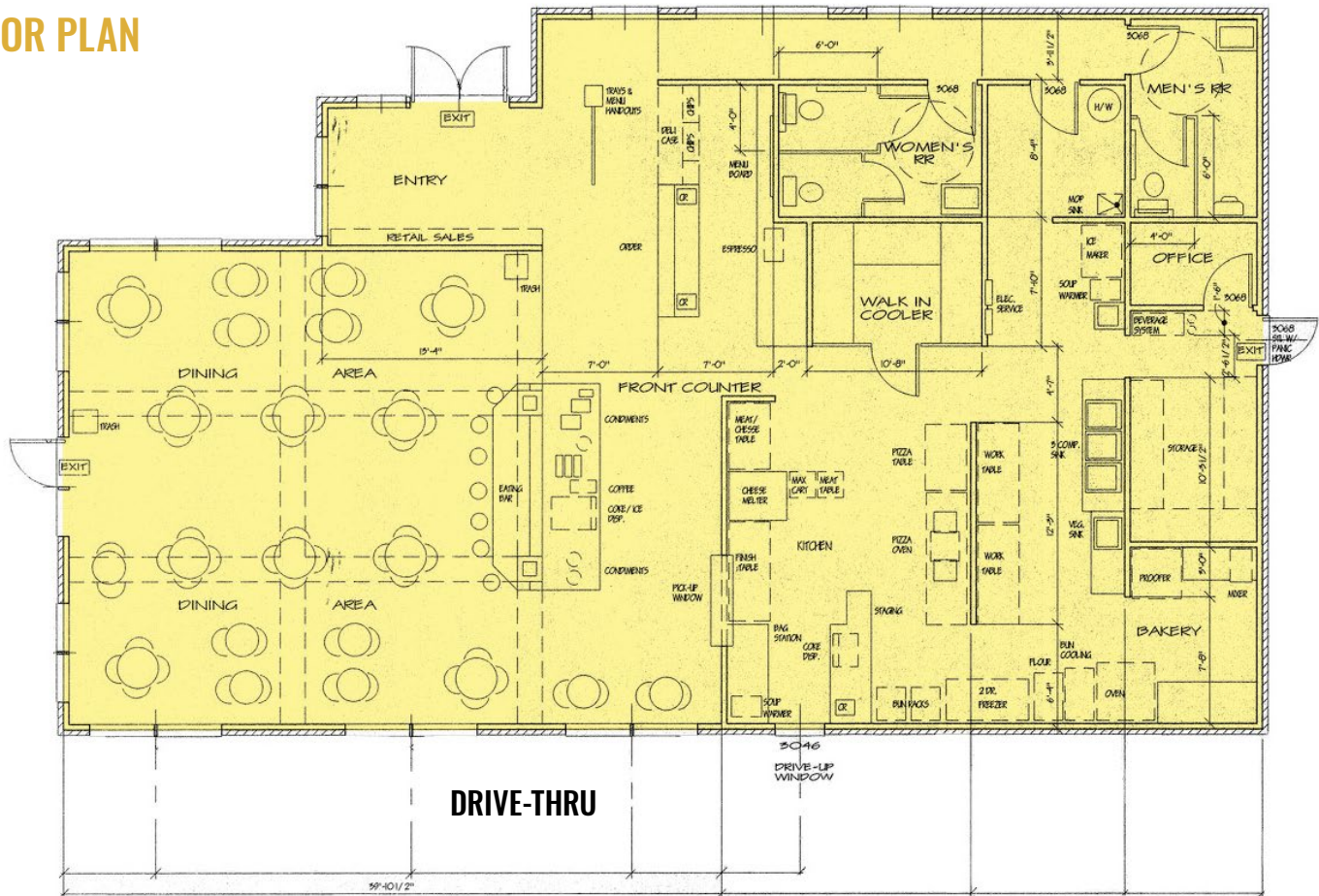

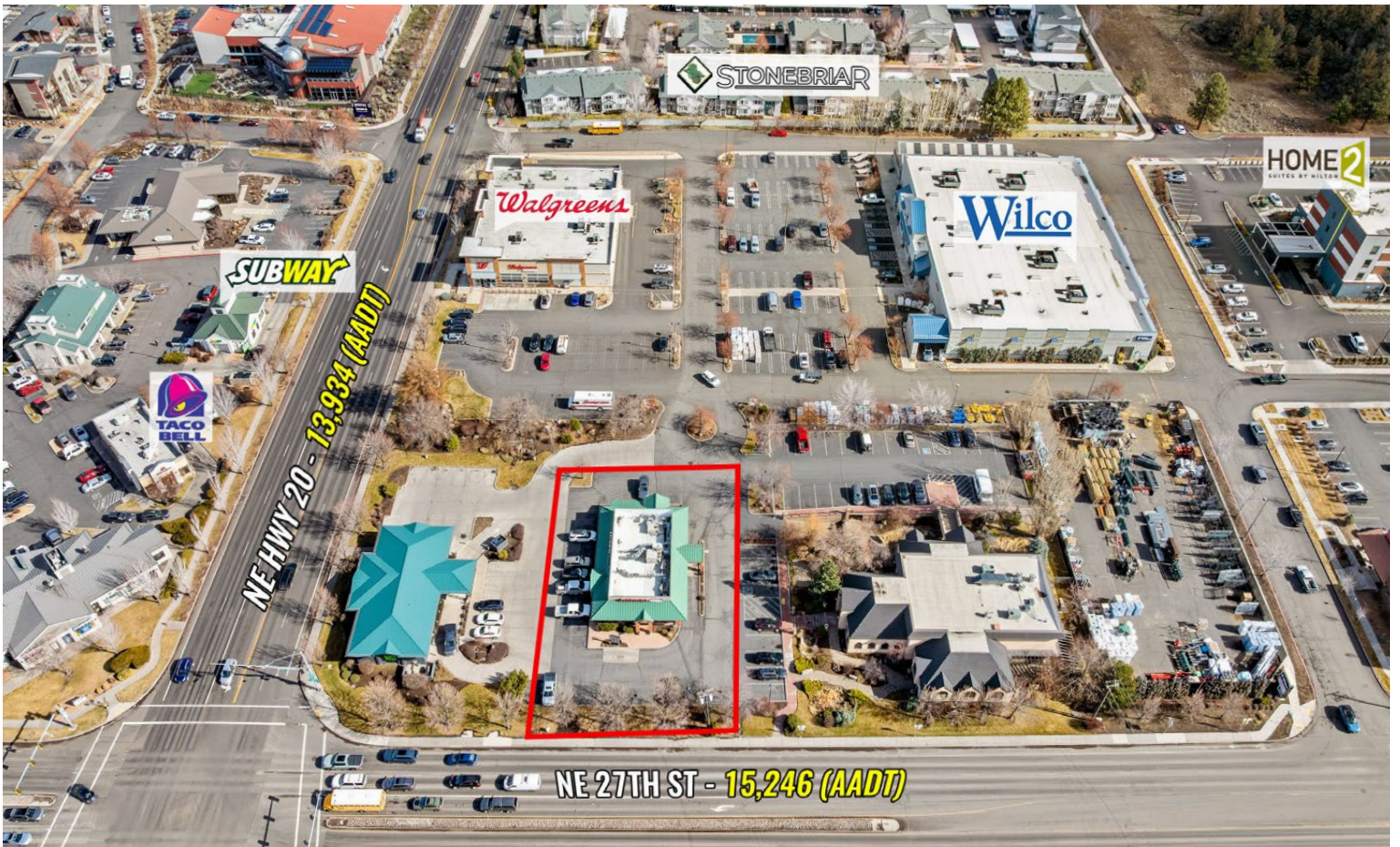

FOR SALE

62080 NE 27th St., Bend, OR 97701

DEMOGRAPHICS - 1-MILE RADIUS

POPULATION STATS

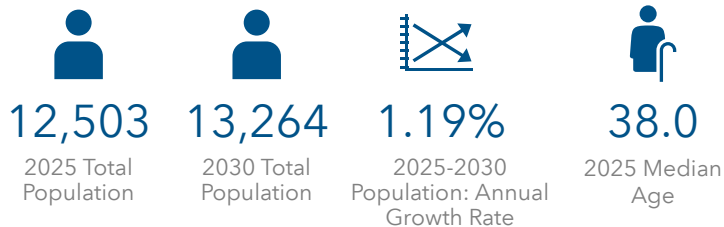

2025 HOUSING STATS

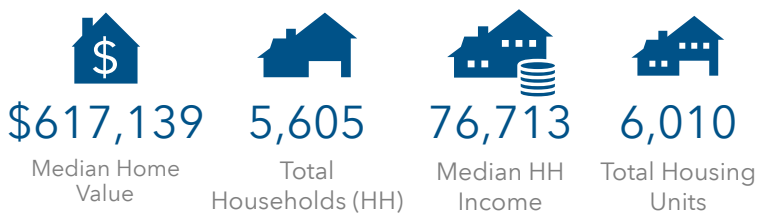

2025 BUSINESS STATS



2025 EDUCATION STATS

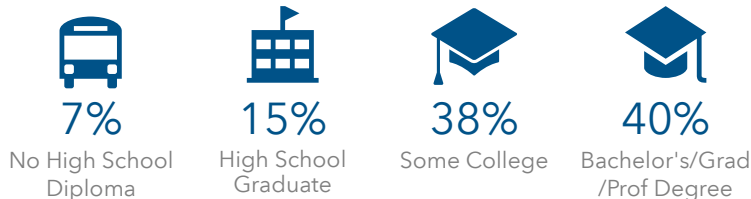

Brokers are licensed in the state of Oregon. This information has been furnished from sources we deem reliable, but for which we assume no liability. This is an exclusive listing. The information contained herein is given in confidence with the understanding that all negotiations pertaining to this property be handled through Compass Commercial Real Estate Services. All measurements are approximate.



Graham Dent, SIOR
Partner, Broker
Cell 541.639.6515
gdent@compasscommercial.com



Grant Schultz, SIOR, CCIM
Broker
Cell 541.480.9873
gschultz@compasscommercial.com

COMPASS
COMMERCIAL

REAL ESTATE SERVICES