

**FOR LEASE**

**17,434 SF**

**savills**

**Manulife**  
Investment Management



**6630-6650 ABRAMS STREET, ST-LAURENT, QC H4S 1Y1**

## Prime Industrial Space in Strategic Location

|                      |                      |
|----------------------|----------------------|
| Total available area | <b>17,434 SF</b>     |
| Warehouse area       | 11,392 SF            |
| Office area          | 6,042 SF             |
| Clear Height         | 22'4"                |
| Occupancy            | Immediate            |
| Electricity          | 600 Amps   600 Volts |
| Shipping doors       | 2 truck-level        |
| Zoning               | Industrial           |

- Excellent location, adjacent Montreal's Technoparc, near HWY 40 & 13
- Public transportation access via bus and Future REM station (Marie Curie)
- Attractive clear height in warehouse, including +/- 1,500 Mezzanine space
- Ample employee parking
- Flexible zoning



6630-6650 Abrams Street, St-Laurent



FINANCIAL DETAILS

**Net rental rate:**  
Contact Brokers

**Additional rent:**  
\$5.73 / SF (estimated 2024)





# 6630-6650 Abrams Street, St-Laurent

## Floor Plan

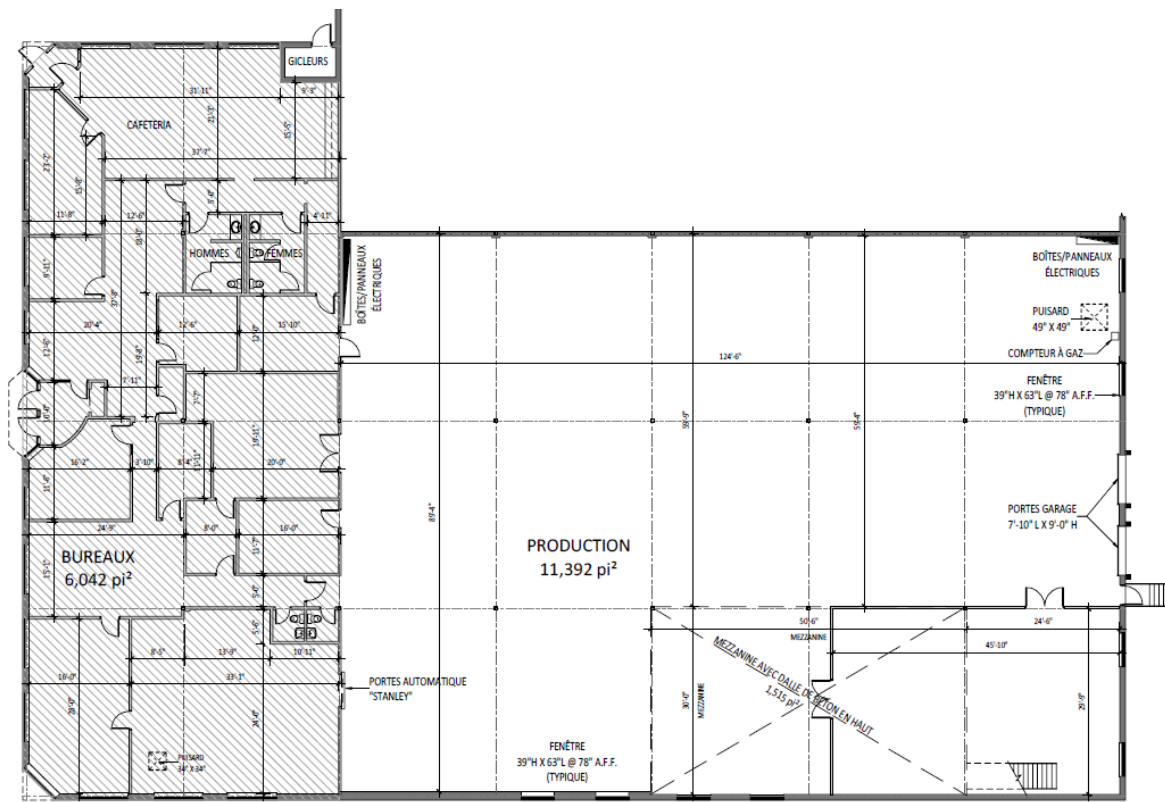

### NEARBY AMENITIES

- Easy access to Highways 40 & 13
- Pierre-Elliott-Trudeau International Airport: **± 10 KM**
- Downtown Montreal: **± 20 KM**
- Close proximity to coffee shops & restaurants
- Close to the REM station (Marie-Curie)
- Public transportation at the door

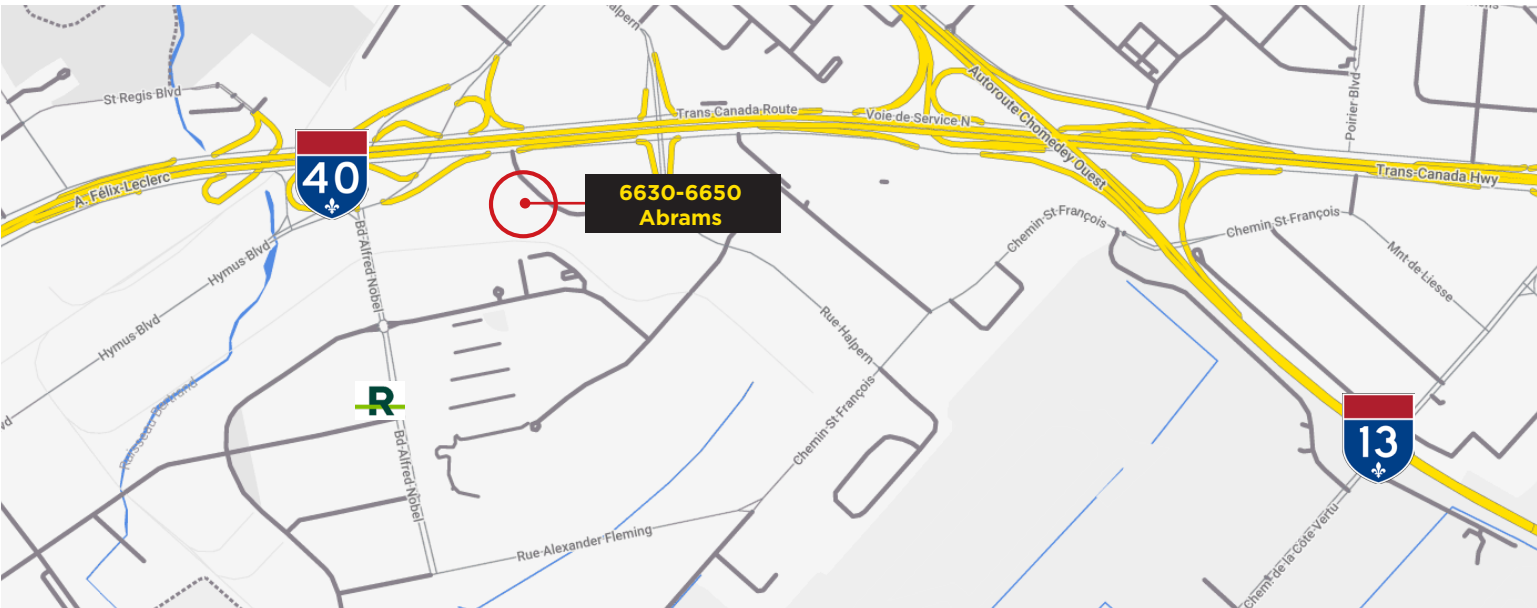



# 6630-6650 Abrams Street, St-Laurent



**Robin Blanchard**  
Vice President  
Real Estate Broker  
+1 514 796 3040  
rblanchard@savills.ca

**Antoine Dumas**  
Associate  
Real Estate Broker  
+1 514 917 7760  
adumas@savills.ca

3773 boulevard Côte-Vertu, suite 160, Saint-Laurent, Québec H4R 2M3 | +1 514 416 1270

The information contained in this communication has been obtained from a variety of sources believed to be reliable but has not been verified. NO WARRANTY OR REPRESENTATION, EXPRESS OR IMPLIED, IS MADE AS TO THE CONDITION OF THE PROPERTY OR ACCURACY OR COMPLETENESS OF THE INFORMATION CONTAINED HEREIN AND SAME IS SUBMITTED SUBJECT TO ERRORS, OMISSIONS, CHANGE OF PRICE, RENTAL OR OTHER CONDITIONS, WITHDRAWAL WITHOUT NOTICE AND TO ANY SPECIFIC CONDITIONS IMPOSED BY THE PROPERTY OWNER OR LESSOR.