

FOR SUBLEASE



PROPERTY DETAILS

2322 West 500 North, Suite C, Springville, UT 84663

- Available for short or long-term sublease, allowing maximum flexibility
- Sublease includes all office furniture
- Equidistant from the 1400 N and 400 S Springville interchanges
- Positioned to easily service northern and southern Utah County
- 4/1000 parking ratio
- 18' clear height, 14' roll-up door
- Building power: 1600 amp- 3 Phase- 208 Volt
- Warehouse dimensions are 64'x30'
- \$4,027.30/month NNN

NEWMARK



MOUNTAIN WEST

CASON ACOR

cacor@newmarkmw.com

direct 385.308.7313

[View Profile](#)

RODD JEFFERIES

rjefferies@newmarkmw.com

direct 801.400.2403

[View Profile](#)

FULL SERVICE

COMMERCIAL REAL ESTATE

312 East South Temple

Salt Lake City, Utah 84111

Office 801.456.8800

www.newmarkmw.com

SPRINGPOINTE SUBLEASE

SITE PLAN

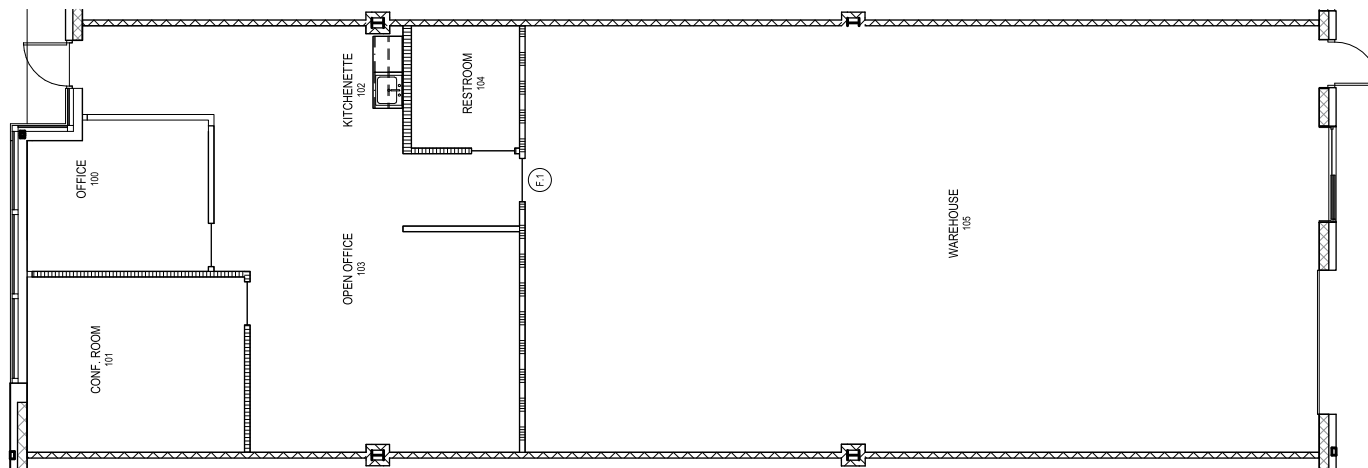

NEWMARK



MOUNTAIN WEST

CASON ACOR

cacor@newmarkmw.com

direct 385.308.7313

[View Profile](#)

RODD JEFFERIES

rjefferies@newmarkmw.com

direct 801.400.2403

[View Profile](#)

FULL SERVICE COMMERCIAL REAL ESTATE

312 East South Temple

Salt Lake City, Utah 84111

Office 801.456.8800

www.newmarkmw.com



NEWMARK

MOUNTAIN WEST

CASON ACOR

cacor@newmarkmw.com

direct 385.308.7313

[View Profile](#)

RODD JEFFERIES

rjefferies@newmarkmw.com

direct 801.400.2403

[View Profile](#)



FULL SERVICE COMMERCIAL REAL ESTATE

312 East South Temple

Salt Lake City, Utah 84111

Office 801.456.8800

www.newmarkmw.com



CASON ACOR
cacor@newmarkmw.com
direct 385.308.7313
[View Profile](#)

RODD JEFFERIES
rjefferies@newmarkmw.com
direct 801.400.2403
[View Profile](#)

**FULL SERVICE
COMMERCIAL REAL ESTATE**
312 East South Temple
Salt Lake City, Utah 84111
Office 801.456.8800
www.newmarkmw.com