

WHITE ROCK MEDICAL OFFICE

9330 POPPY DRIVE



welltower

**PRIME MEDICAL OFFICE
SPACE AVAILABLE**

PROPERTY HIGHLIGHTS

- Located on the campus of White Rock Medical Center
- Directly connected to the hospital through a climate-controlled skybridge
- Convenient patient drop-off area and renovated lobby
- Features gurney-sized elevators
- Efficient floorplans
- Aggressive TI packages
- Convenient and abundant parking





RENOVATED ELEVATOR LOBBIES



NEW SPEC SUITES

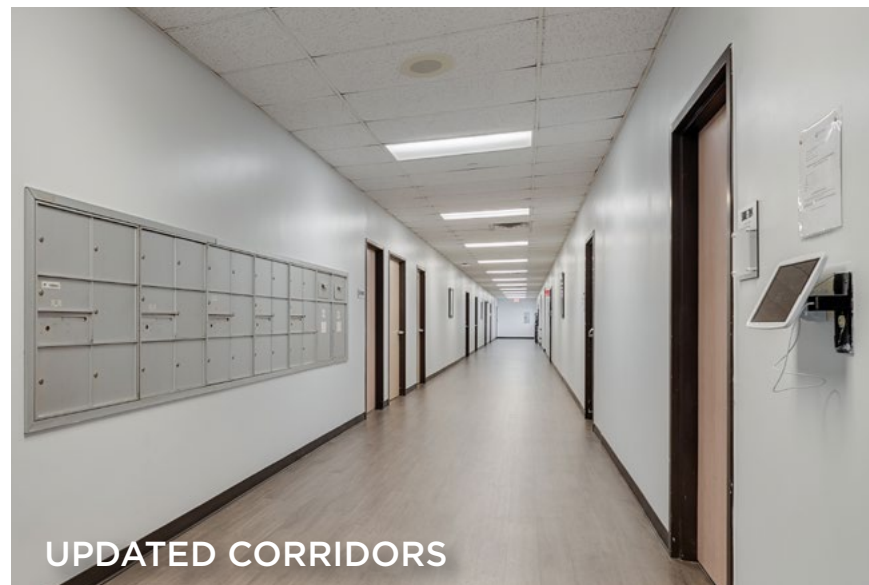

UPDATED CORRIDORS



NATURAL LIGHT ATRIUM



CONVENIENT PATIENT DROP OFF

LOCAL AMENITIES

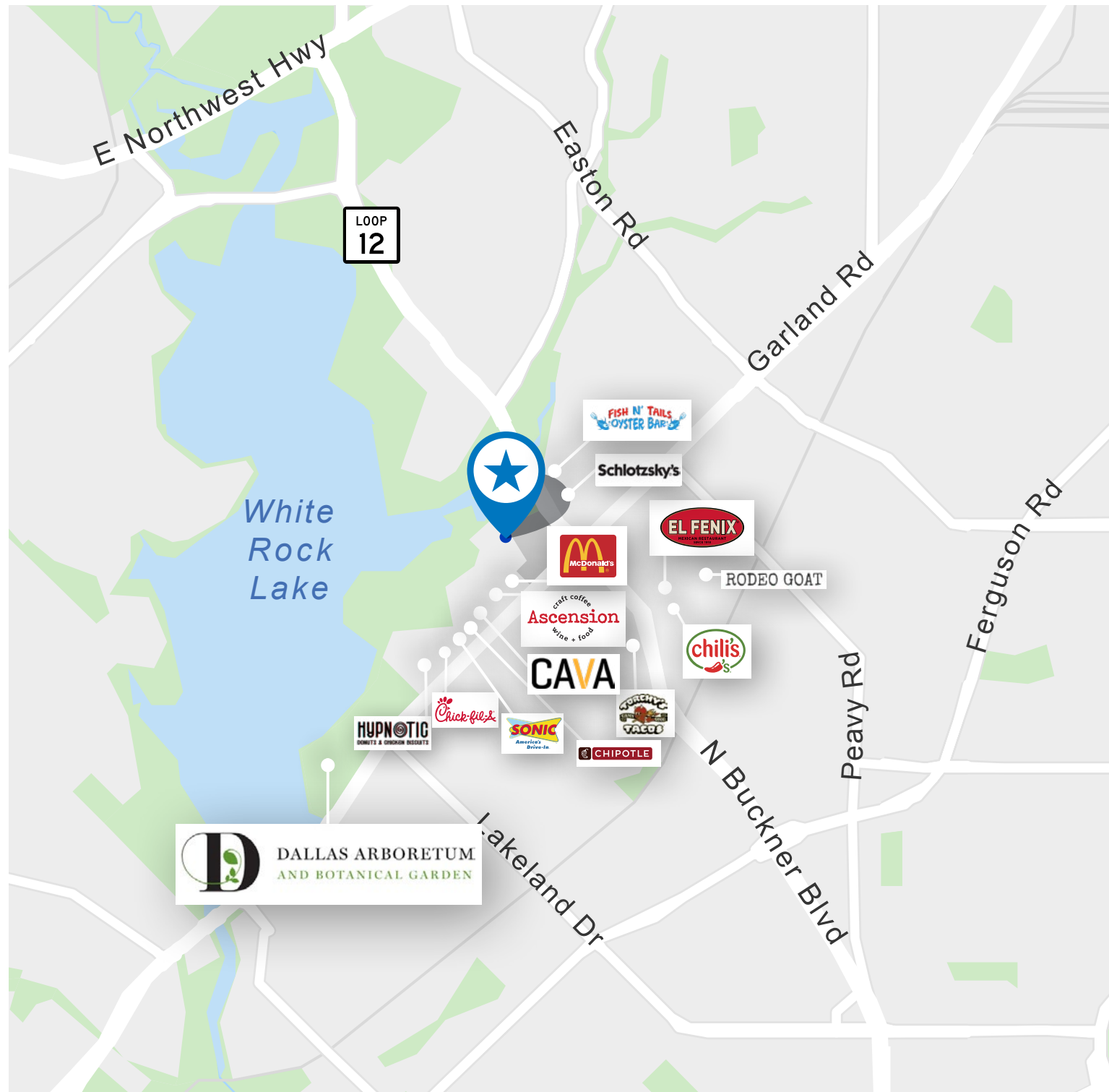

PROVIDER GAP ANALYSIS

Specialty	Providers in 3-mi Radius	Indicated Demand	Gap
Internal Medicine	34	89	55
Dental	106	153	47
Pediatrics	11	55	44
Surgery	20	56	36
Family Medicine	54	90	36
Obstetrics & Gynecology	9	32	23
Anesthesiology	18	40	22
Radiology	9	31	22
Psychiatry & Neurology	19	39	20
Emergency Medicine	15	33	18
Vision	33	50	17
Cardiology & Vascular	6	19	13
Pathology	2	13	11
Gastroenterology	1	11	10
Urology	2	7	5
Hematology	2	7	5
Infectious Disease	0	5	5
Hospitalist	3	7	4
Dermatology	4	8	4
Renal	3	7	4
Preventive Medicine	0	4	4
Endocrinology & Diabetes	1	5	4
Otolaryngology	4	7	3
Critical Care	1	4	3
Rheumatology	1	4	3
Oncology	1	3	2
Geriatrics	1	3	2
Physical Medicine & Rehab	7	9	2
Allergy & Immunology	2	3	1

 Unmet demand will support new, relocating and expanding practices.

FOR MORE INFORMATION, CONTACT:

CHRIS LIPSCOMB

Managing Director,
Agency Leasing

214.237.5022

chris.lipscomb@transwestern.com

COLLIN BURWINKEL

Associate,
Agency Leasing

972.774.2531

collin.burwinkel@transwestern.com

OWNED & MANAGED BY: **welltower**

LEASED BY:  **TRANSWESTERN**