

LEXINGTON PRESERVE BUSINESS PARK

SW of Pheasant Ridge Drive NE & Lexington Ave

..... Blaine, MN.....



JOHN RYDEN, CCIM, SIOR
Senior Vice President
+1 952 924 4641
john.ryden@cbre.com

MATT OELSCHLAGER
Senior Vice President
+1 952 924 4848
matt.oelschlager@cbre.com

MIKE BOWEN
Vice President
+1 952 924 4885
mike.bowen@cbre.com

JP MALONEY
Associate
+1 612 336 4288
jp.maloney@cbre.com



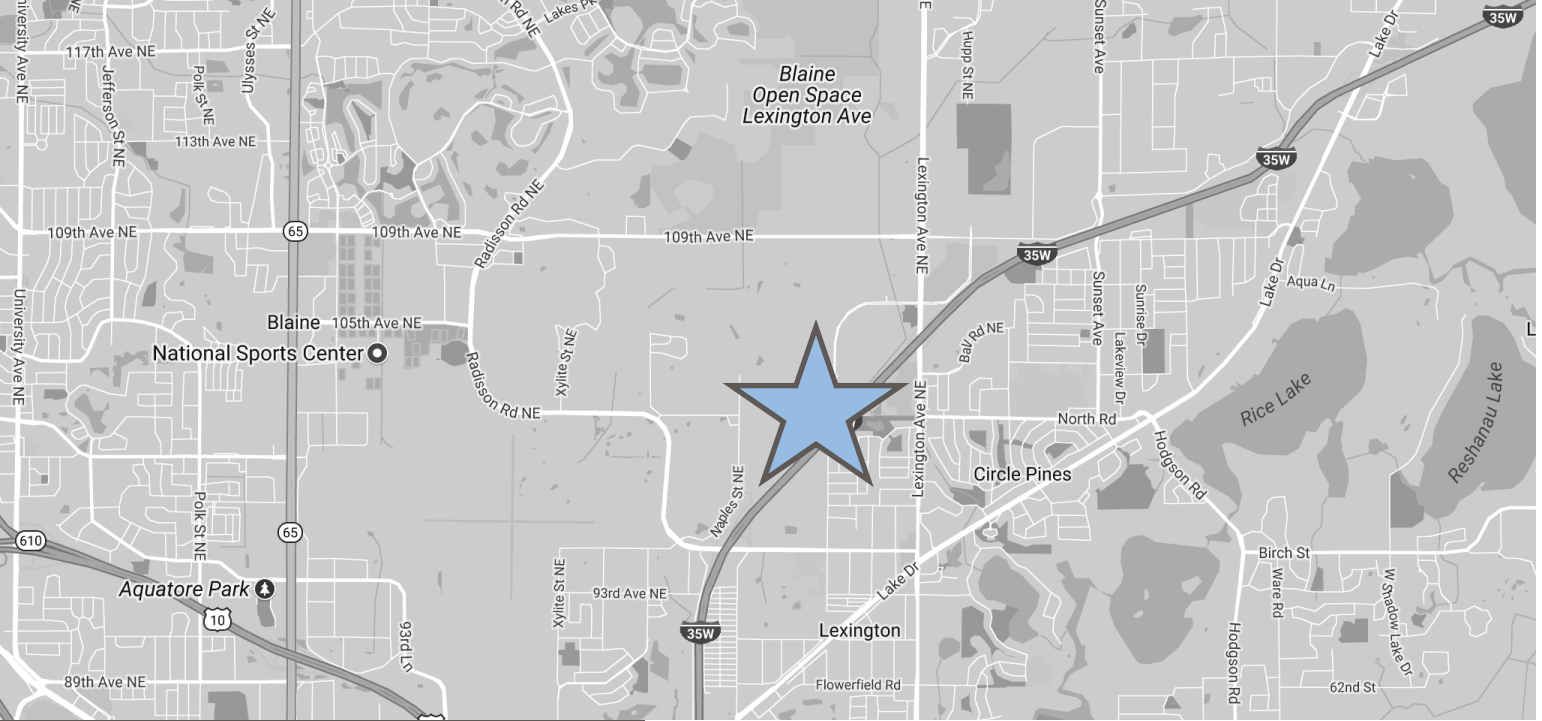

FEATURES

- 40,000 to 152,000 SF at I-35W and Lexington Avenue NE.
- Custom design built-to-suit or lead tenant opportunity
- Prime site in a strong market location with a variety of retail and dining services close by.
- Growing workforce
- Zoning approved for industrial or office use
- Developer owned and ready for development
- Visible to 53,000 CPD on I-35W
- Beautiful, natural, campus-like setting with numerous ponds

PROPERTY DESCRIPTION

Lexington Preserve Business Park is a premier new development opportunity being developed by CSM. The development will offer state-of-the art industrial office facilities in a premier northeast metro location.

Benefits of the location include immediate freeway access to I-35W and State Hwy 610 which will offer direct access to I-94. Additionally, there are numerous retail services, restaurants, and in close proximity to Blaine Villages Shopping Center.

CBRE

800 LaSalle Ave
Suite 1900
Minneapolis, MN 55402
www.cbre.com/minneapolis

Property Specifications

AVAILABLE SF

Design build from 40,000 SF to 152,000 SF

AVAILABLE ACREAGE

Lots from 2-10 Acres

CLEAR HEIGHT

Flexible - 20' - 32'

LOADING

Docks and drive-ins available

FIBER

Available through multiple providers

FREEWAY ACCESS

Immediate freeway access to I-35W and Lexington Ave NE

ZONING

Approved for industrial or office use

UTILITIES

All City of Blaine Municipal Utility services are installed in the street abutting the site; the site is free and clear of a Special Assessments for these services

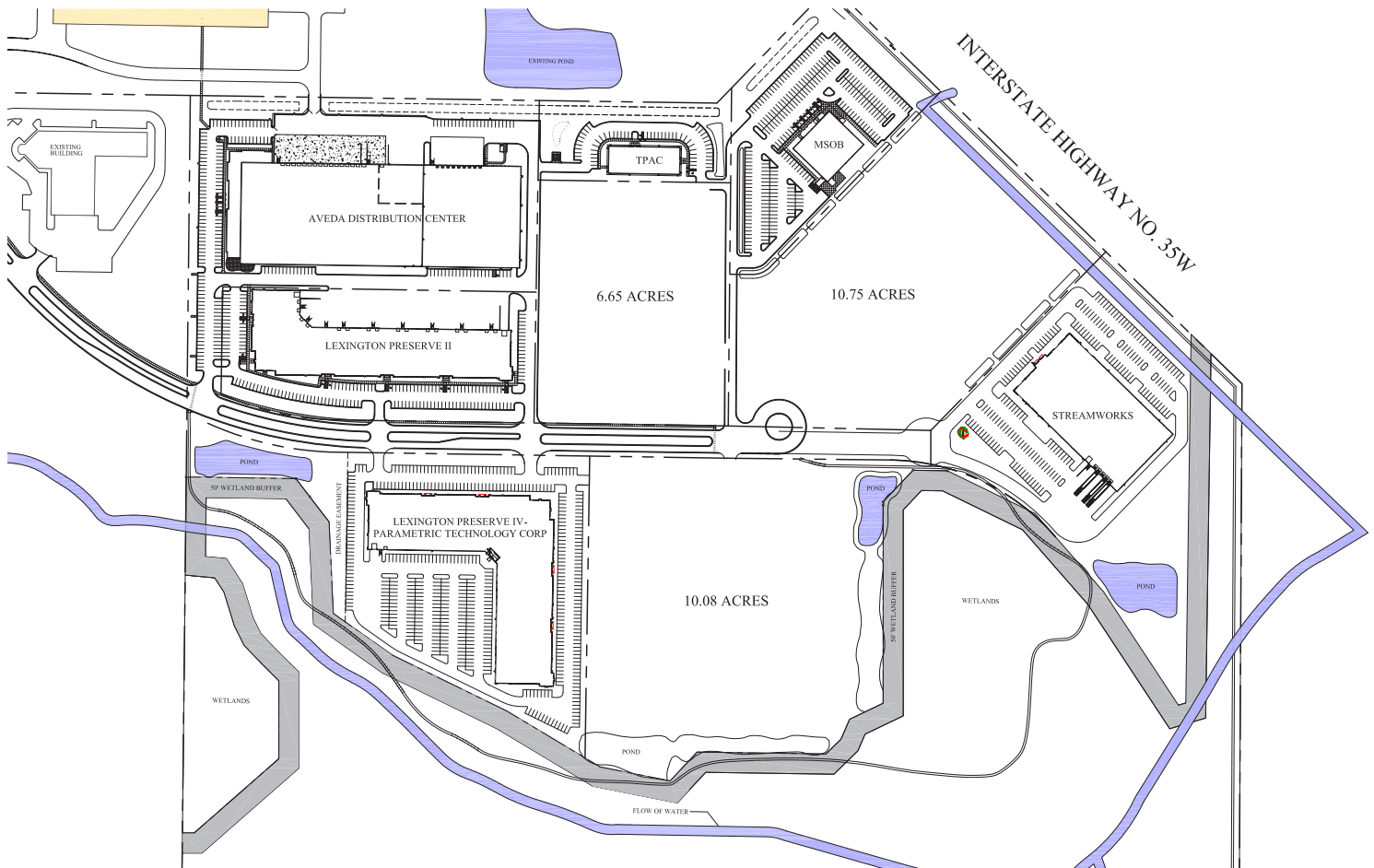

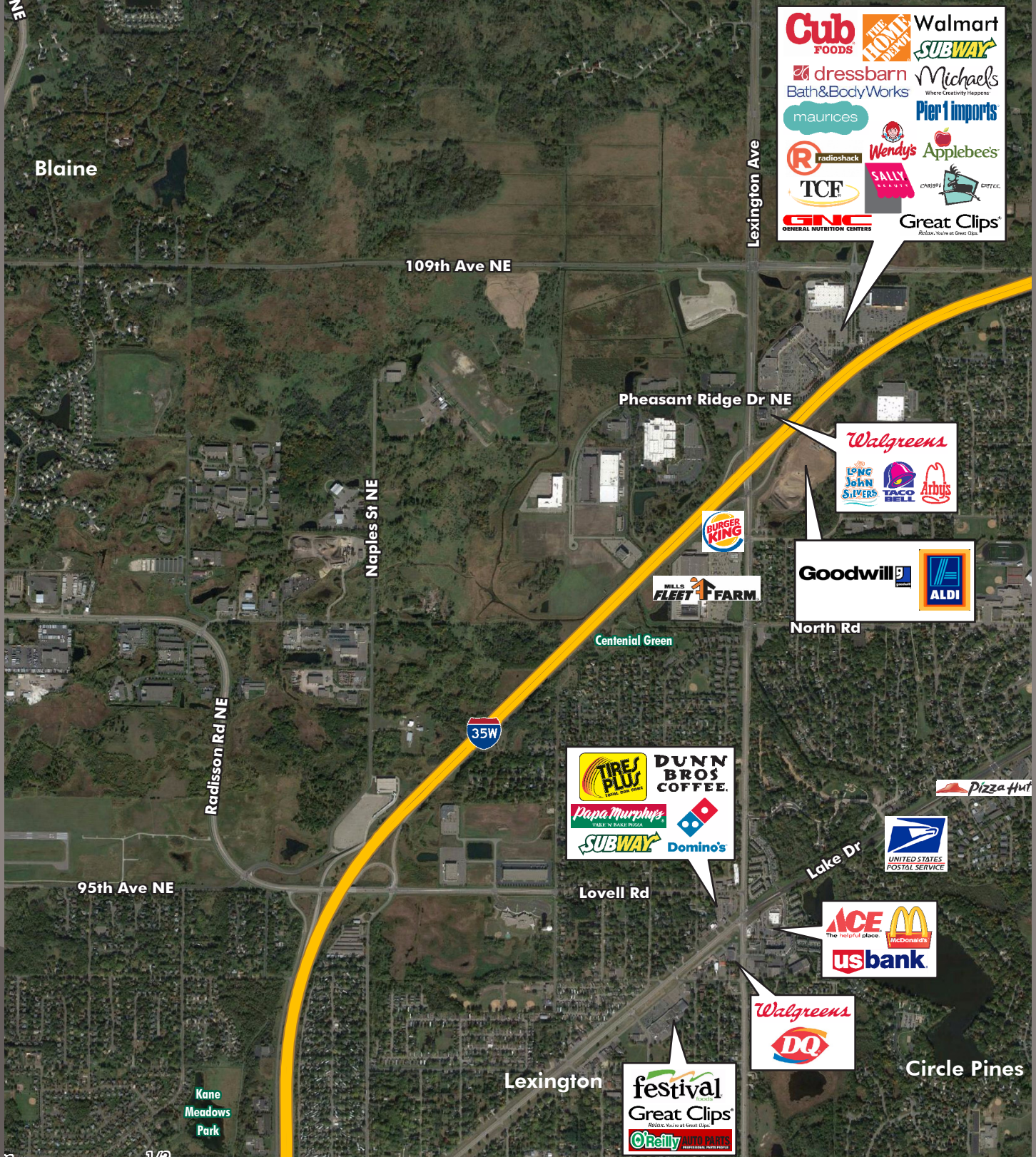

JOHN RYDEN, CCIM, SIOR
 Senior Vice President
 +1 952 924 4641
 john.ryden@cbre.com

MATT OELSCHLAGER
 Senior Vice President
 +1 952 924 4848
 matt.oelschlager@cbre.com

MIKE BOWEN
 Vice President
 +1 952 924 4885
 mike.bowen@cbre.com

JP MALONEY
 Associate
 +1 612 336 4288
 jp.maloney@cbre.com

CBRE | 800 LaSalle Ave | Suite 1900 | Minneapolis, MN 55402 | www.cbre.com/minneapolis

CBRE

© 2019 CBRE, Inc. This information has been obtained from sources believed reliable. We have not verified it and make no guarantee, warranty or representation about it. Any projections, opinions, assumptions or estimates used are for example only and do not represent the current or future performance of the property. You and your advisors should conduct a careful, independent investigation of the property to determine to your satisfaction the suitability of the property for your needs. Photos herein are the property of their respective owners and use of these images without the express written consent of the owner is prohibited. CBRE and the CBRE logo are service marks of CBRE, Inc. and/or its affiliated or related companies in the United States and other countries. All other marks displayed on this document are the property of their respective owners. PMStudio_October_2016