



## EXECUTIVE SUMMARY

## 4 PARCELS FOR SALE

US HIGHWAY 19 &amp; 84, THOMASVILLE, GA 31792



## OFFERING SUMMARY

<b>Lot 09-C:</b>	1.015 acres for \$575,000
<b>Lot 11-C:</b>	1.220 acres for \$595,000
<b>Lot 12-C:</b>	1.391 acres for \$235,000 <b>SOLD</b>
<b>Lot 13-C:</b>	2.325 acres for \$295,000 <b>SOLD</b>
<b>Lot 14-C:</b>	1.695 acres for \$355,000 <b>SOLD</b>
<b>Lot 15-C:</b>	2.101 acres for \$375,000 <b>SOLD</b>
<b>Lot 16-C2:</b>	1.49 acres for \$595,000 <b>UNDER CONTRACT</b>
<b>Lot 16-C3:</b>	1.38 acres for \$575,000 <b>UNDER CONTRACT</b>
<b>Lot 16-C4:</b>	1.07 acres for \$495,000
<b>Lot 16-C5:</b>	1.435 acres for \$495,000
<b>Lot 16-CZ:</b>	6.24 acres for \$575,000 <b>SOLD</b>

## LOT DETAILS

Located at the intersection of US 19 & 84, these parcels are situated in Thomasville's main retail corridor and serve a five-county trade area of 150,000+ people. Grand Park Apartments, a new 280-unit luxury apartment complex, is building another 80 units. A new Home2 Suites recently opened. Contact the listing agent if a larger parcel is needed. Build to suit opportunities will be considered.

## PROPERTY OVERVIEW

Located at the intersection of US 19 and US 84 in East Thomasville, GA.

Trey DeSantis  
850.766.6868  
trey@tlgproperty.com

TLG REAL ESTATE SERVICES  
3520 Thomasville Road, Suite 200, Tallahassee, FL 32309  
850.385.6363







AVAILABLE PARCELS: 11-C1, 9-C, 16-C2, C3, C4 & C5

## 4 PARCELS FOR SALE

US HIGHWAY 19 & 84, THOMASVILLE, GA 31792

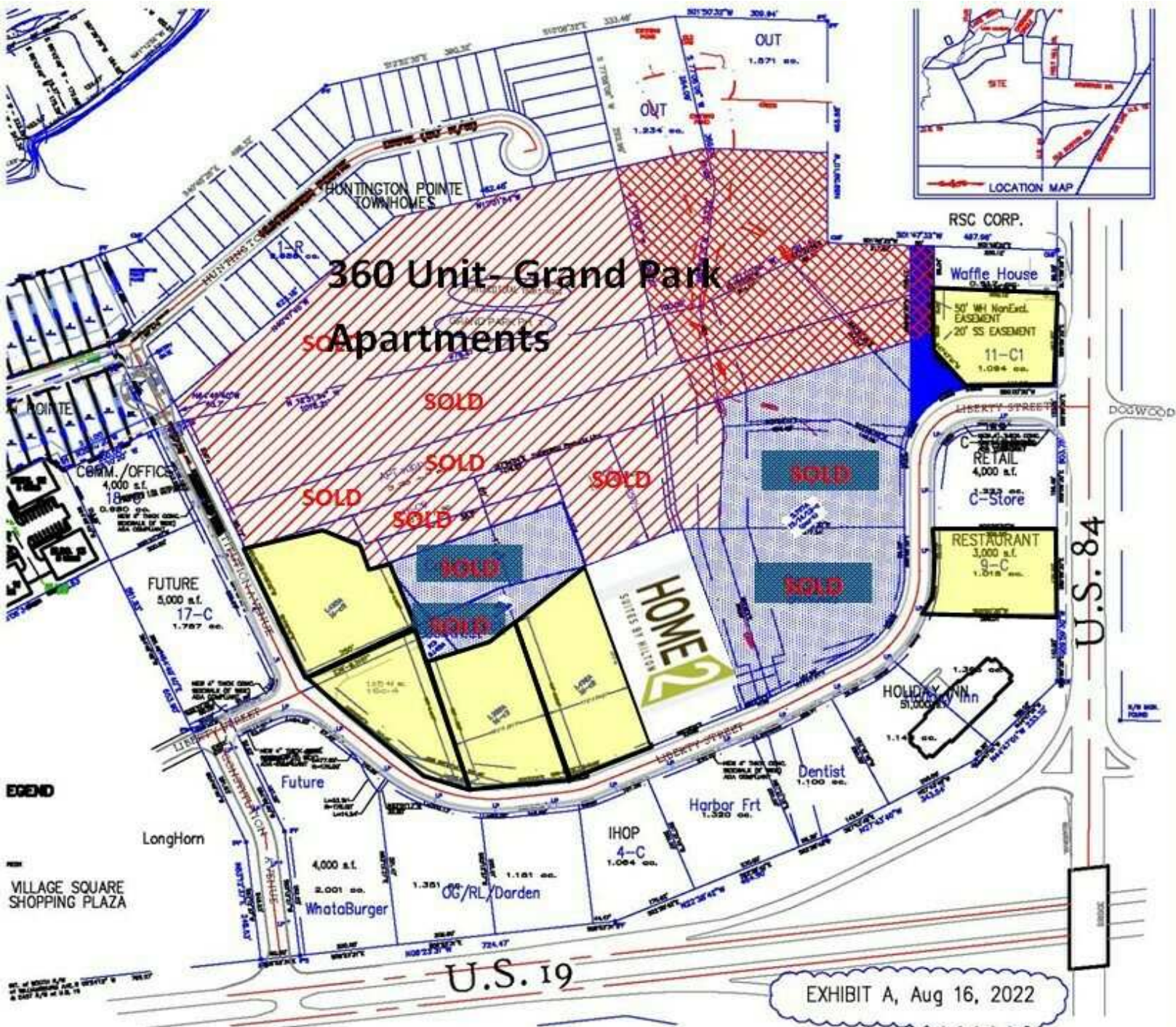

Trey DeSantis  
850.766.6868  
trey@tlgproperty.com

**TLG REAL ESTATE SERVICES**  
3520 Thomasville Road, Suite 200, Tallahassee, FL 32309  
850.385.6363





AVAILABLE PARCELS: CLOSE UP VIEW FOR 16-C2, C3, C4 & C5

**4 PARCELS FOR SALE**

US HIGHWAY 19 & 84, THOMASVILLE, GA 31792



**Trey DeSantis**  
850.766.6868  
trey@tlgproperty.com

**TLG REAL ESTATE SERVICES**  
3520 Thomasville Road, Suite 200, Tallahassee, FL 32309  
850.385.6363







RETAILER MAP

## 4 PARCELS FOR SALE

US HIGHWAY 19 &amp; 84, THOMASVILLE, GA 31792

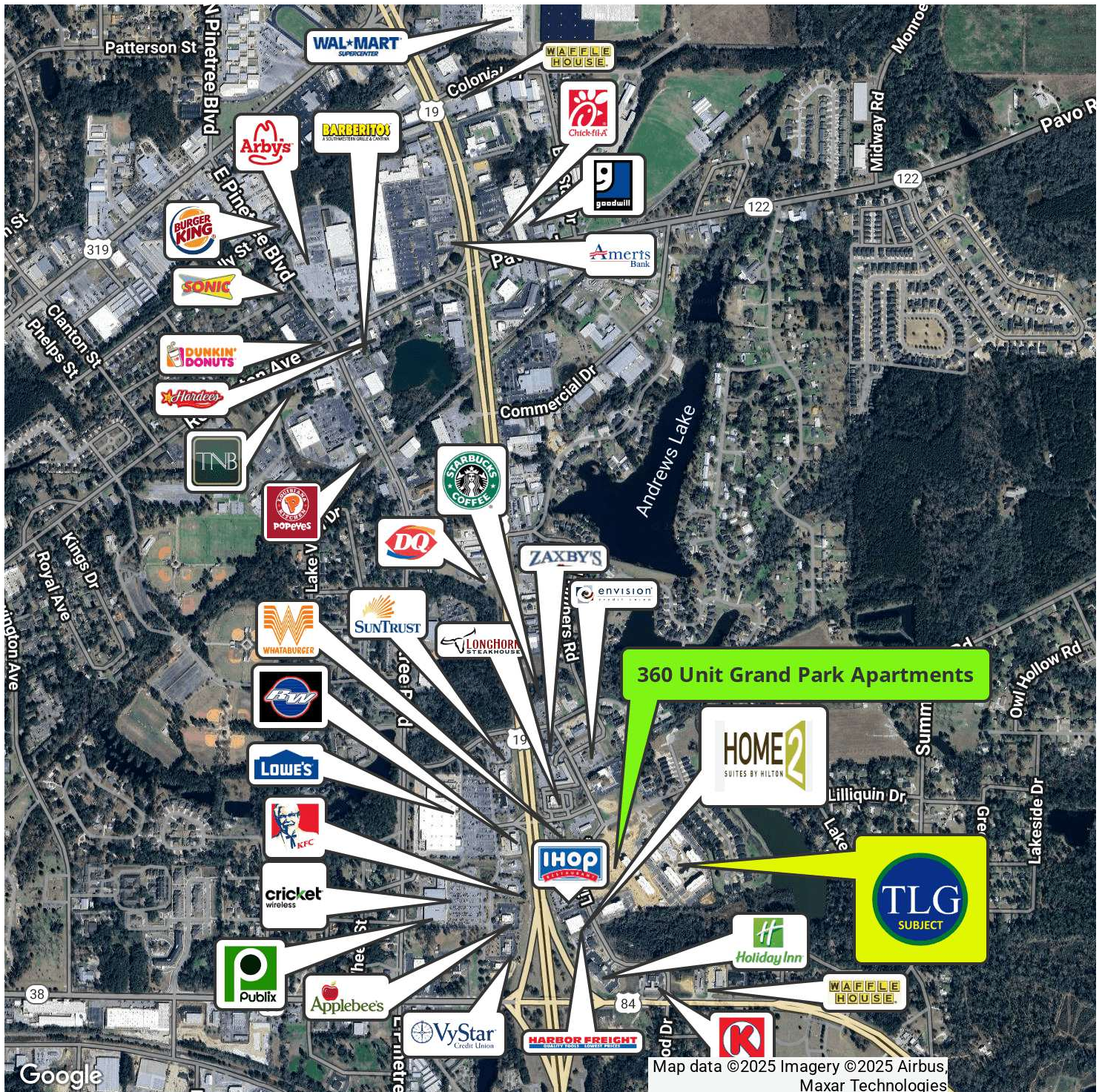

Trey DeSantis  
850.766.6868  
trey@tlgproperty.com

TLG REAL ESTATE SERVICES

3520 Thomasville Road, Suite 200, Tallahassee, FL 32309

850.385.6363







LOCATION MAPS

## 4 PARCELS FOR SALE

US HIGHWAY 19 &amp; 84, THOMASVILLE, GA 31792

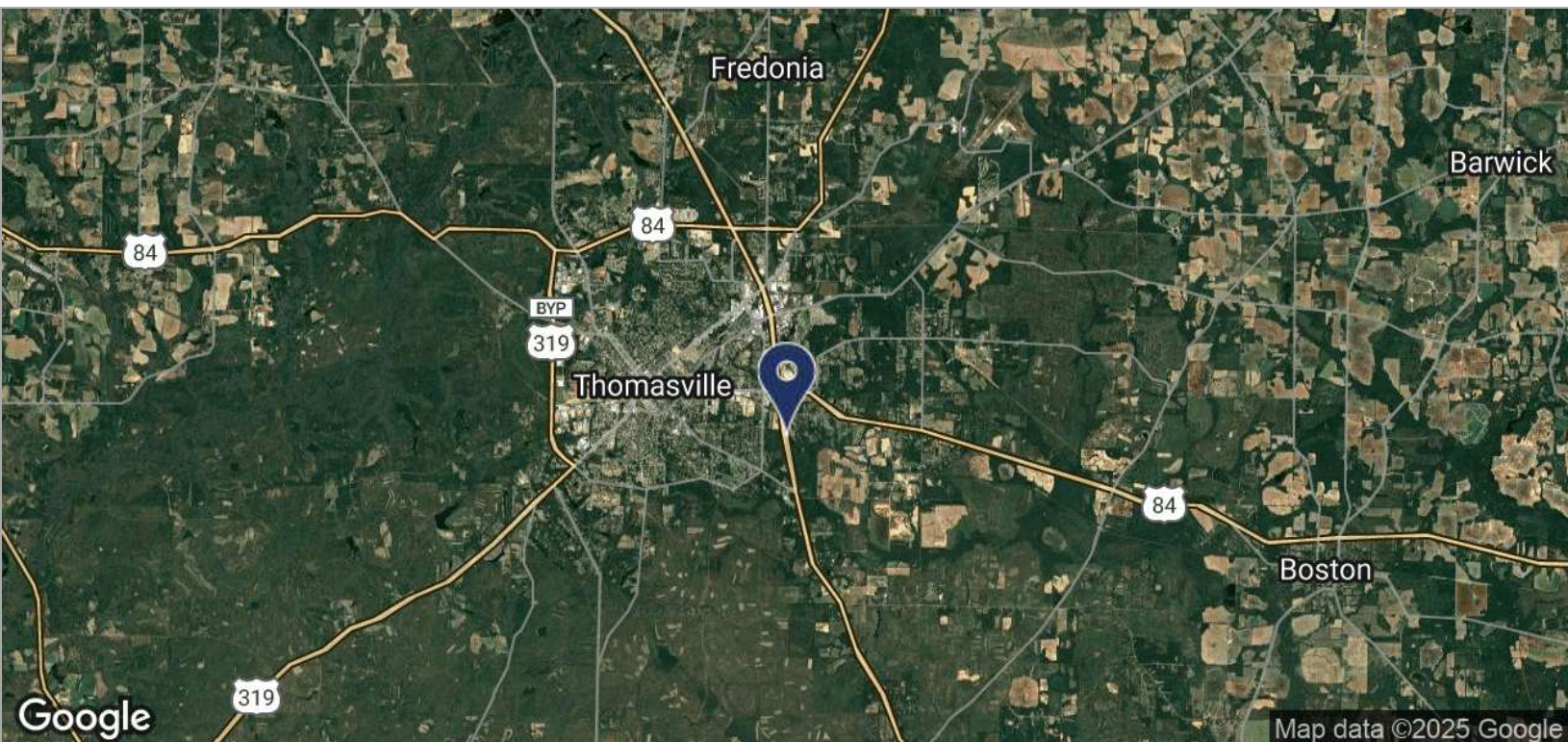
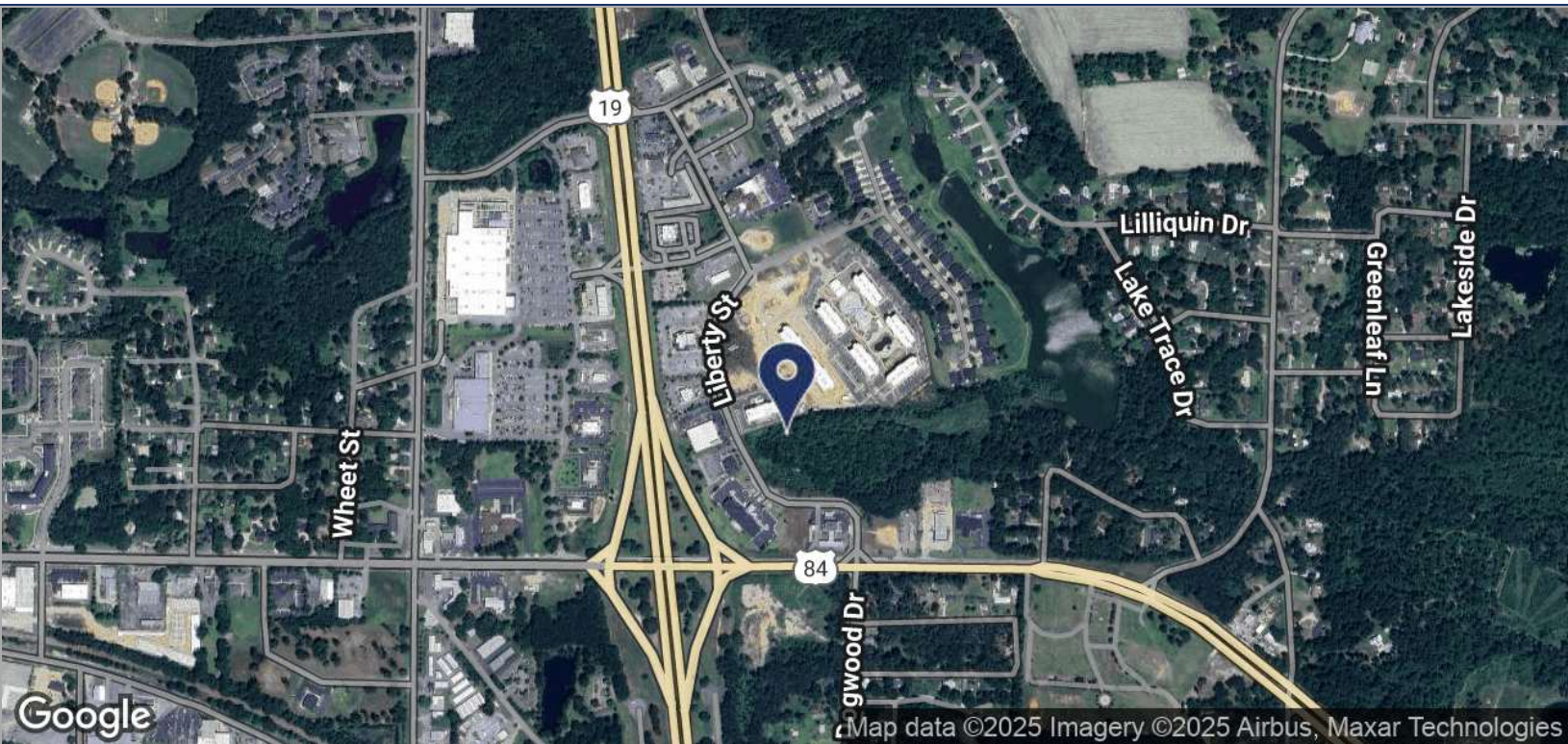

**Trey DeSantis**  
850.766.6868  
trey@tlgproperty.com

**TLG REAL ESTATE SERVICES**

3520 Thomasville Road, Suite 200, Tallahassee, FL 32309

850.385.6363







## DEMOGRAPHICS MAP

## 4 PARCELS FOR SALE

US HIGHWAY 19 &amp; 84, THOMASVILLE, GA 31792

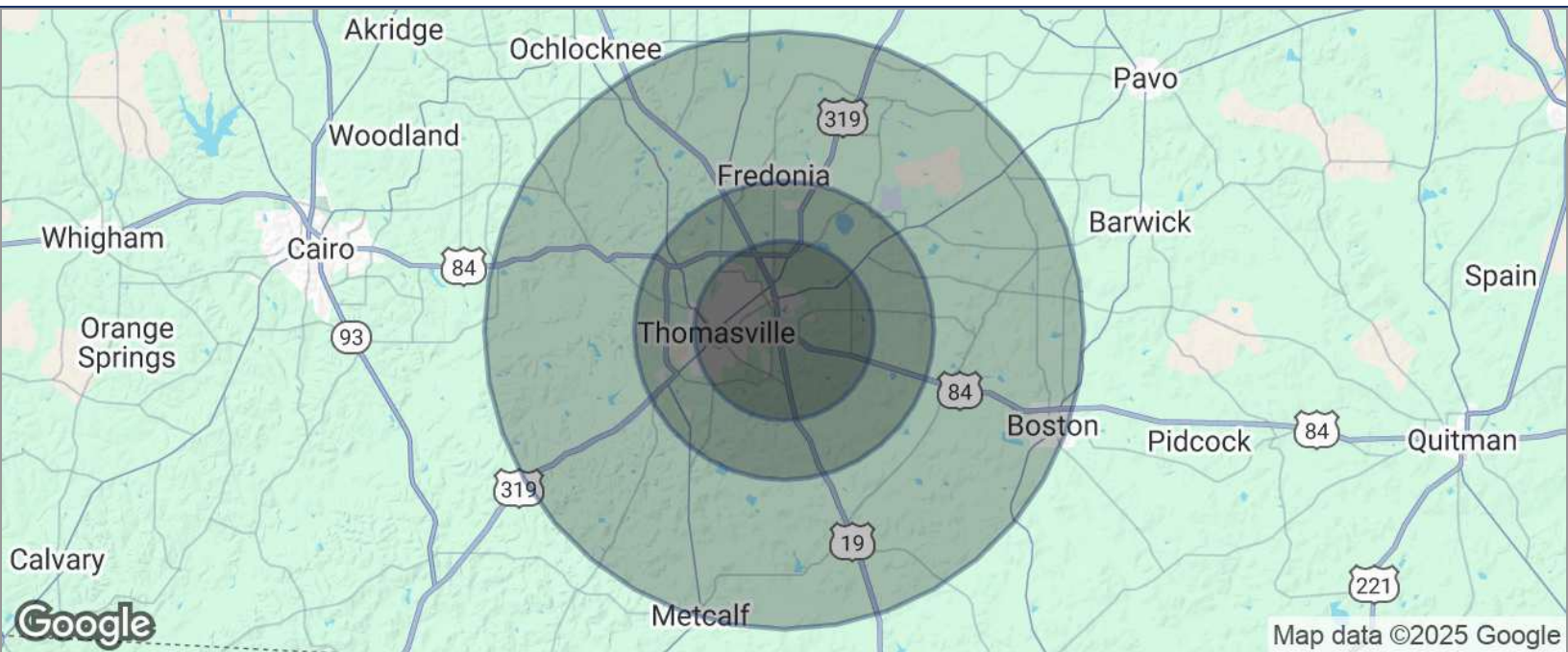

POPULATION	3 MILES	5 MILES	10 MILES
TOTAL POPULATION	16,641	25,610	36,083
MEDIAN AGE	39.5	38.8	40.0
MEDIAN AGE (MALE)	36.9	34.8	36.5
MEDIAN AGE (FEMALE)	42.9	41.0	41.8
HOUSEHOLDS & INCOME	3 MILES	5 MILES	10 MILES
TOTAL HOUSEHOLDS	8,039	12,215	16,705
# OF PERSONS PER HH	2.1	2.1	2.2
AVERAGE HH INCOME	\$54,552	\$54,757	\$58,343
AVERAGE HOUSE VALUE	\$155,012	\$143,413	\$150,819

\* Demographic data derived from 2020 ACS - US Census

Trey DeSantis  
850.766.6868  
trey@tlgproperty.com

TLG REAL ESTATE SERVICES  
3520 Thomasville Road, Suite 200, Tallahassee, FL 32309  
850.385.6363



This information has been obtained from sources believed reliable. We have not verified it and make no guarantee, warranty or representation about it. Any projections, opinions, assumptions or estimates used are for example only and do not represent the current or future performance of the property. You and your advisors should conduct a careful, independent investigation of the property to determine to your satisfaction the suitability of the property for your needs. Photos herein are the property of their respective owners and use of these images without the express written content of the owner is prohibited.