

**ONE
UNION**
CENTER

810 FIRST ST, NE
WASHINGTON, D.C. 20002

BROADSHORE
CAPITAL PARTNERS[®]



Leasing Information:
202.513.6700

Merrill Turnbull
202.513.6713
mturnbull@lpc.com

Adam Biberaj
202.513.6736
abiberaj@lpc.com

Jae Lee
202.513.6718
jlee@lpc.com

William Ruppe
202.513.6722
wruppe@lpc.com

Lincoln

Lincoln Property Company
101 Constitution Avenue, NW Suite 325 East
Washington, DC 20001

www.lpc.com



Property Highlights

- New building ownership and management
- Glass on all sides
- Signage potential
- VAV HVAC
- On-site parking
- New fitness and conference delivering 2024

Availabilities

SF

Date Available

Availabilities	SF	Date Available
2nd Floor	1,185 - 12,917 SF	Immediately
3rd Floor Spec Suites	1,604 - 3,598 SF	5 Suites Delivering 2024
4th Floor	19,523 SF	Immediately
5th Floor	19,523 SF	Immediately
6th Floor	19,523 SF	Immediately
7th Floor	19,523 SF	Immediately
8th Floor	19,523 SF	Immediately
9th Floor	19,523 SF	Immediately
10th Floor	19,523 SF	Immediately
11th Floor	19,523 SF	Immediately

Merrill Turnbull

202.513.6713
 mturnbull@lpc.com

Adam Biberaj

202.513.6736
 abiberaj@lpc.com

Jae Lee

202.513.6718
 jlee@lpc.com

William Ruppe

202.513.6722
 wruppe@lpc.com





Merrill Turnbull
202.513.6713
mturnbull@lpc.com

Adam Biberaj
202.513.6736
abiberaj@lpc.com

Jae Lee
202.513.6718
jlee@lpc.com

William Ruppe
202.513.6722
wruppe@lpc.com

Lincoln



Merrill Turnbull

202.513.6713
mturnbull@lpc.com

Adam Biberaj

202.513.6736
abiberaj@lpc.com

Jae Lee

202.513.6718
jlee@lpc.com

William Ruppe

202.513.6722
wruppe@lpc.com

Lincoln



Merrill Turnbull

202.513.6713
mturnbull@lpc.com

Adam Biberaj

202.513.6736
abiberaj@lpc.com

Jae Lee

202.513.6718
jlee@lpc.com

William Ruppe

202.513.6722
wruppe@lpc.com

Lincoln



Merrill Turnbull 202.513.6713 mturnbull@lpc.com	Adam Biberaj 202.513.6736 abiberaj@lpc.com	Jae Lee 202.513.6718 jlee@lpc.com	William Ruppe 202.513.6722 wruppe@lpc.com
--	---	--	--

Lincoln



Suite	Size	Lease Rate	Description
■ 1st Floor	2,305 SF	Negotiable	Available Immediately - Outside Entrance Available

Merrill Turnbull 202.513.6713 mturnbull@lpc.com	Adam Biberaj 202.513.6736 abiberaj@lpc.com	Jae Lee 202.513.6718 jlee@lpc.com	William Ruppe 202.513.6722 wruppe@lpc.com
--	---	--	--

Lincoln

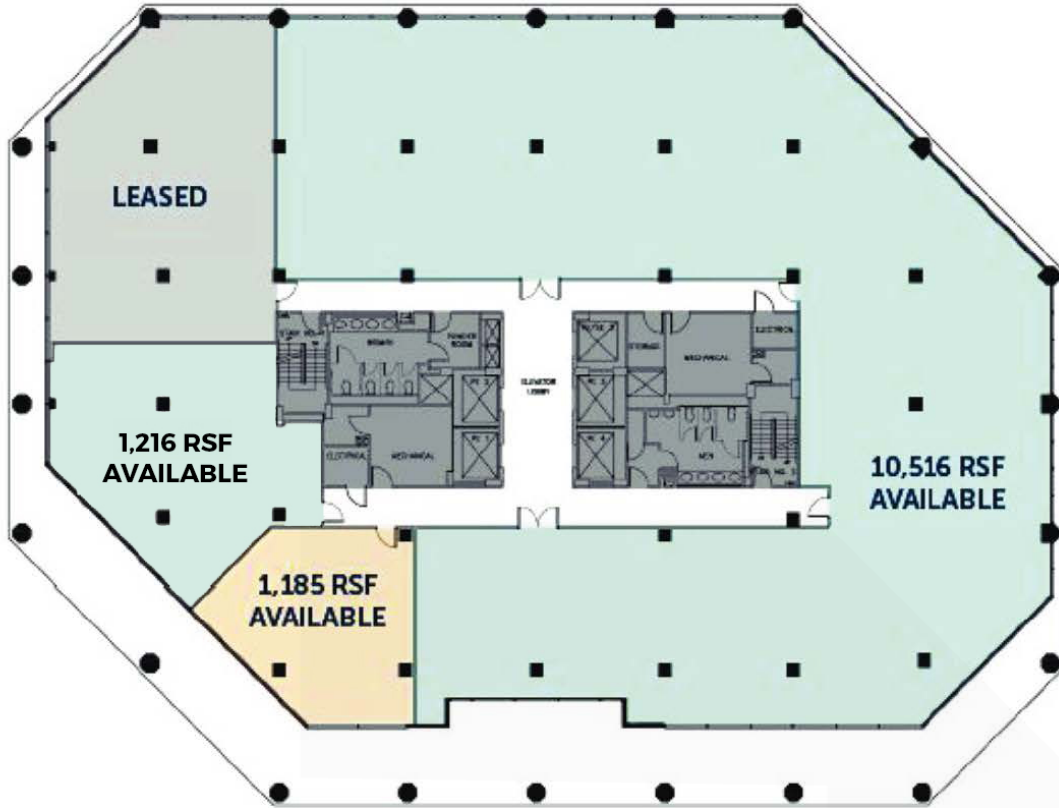

Suite	Size	Description
■ 2nd Floor	1,185 - 12,917 SF	Available Immediately

Merrill Turnbull 202.513.6713 mturnbull@lpc.com	Adam Biberaj 202.513.6736 abiberaj@lpc.com	Jae Lee 202.513.6718 jlee@lpc.com	William Ruppe 202.513.6722 wruppe@lpc.com
---	--	---	---

Lincoln



Suite	Size	Description
Spec Suite A	2,420 SF	Planned Spec Suites with Shared Lounge & Conference Ranging from 1,604 SF - 3,598
Spec Suite B	1,604 SF	Delivering 2024
Spec Suite C	2,610 SF	Delivering 2024
Spec Suite D	2,890 SF	Delivering 2024
Spec Suite E	3,598 SF	Delivering 2024

Merrill Turnbull 202.513.6713 mturnbull@lpc.com	Adam Biberaj 202.513.6736 abiberaj@lpc.com	Jae Lee 202.513.6718 jlee@lpc.com	William Ruppe 202.513.6722 wruppe@lpc.com
--	---	--	--

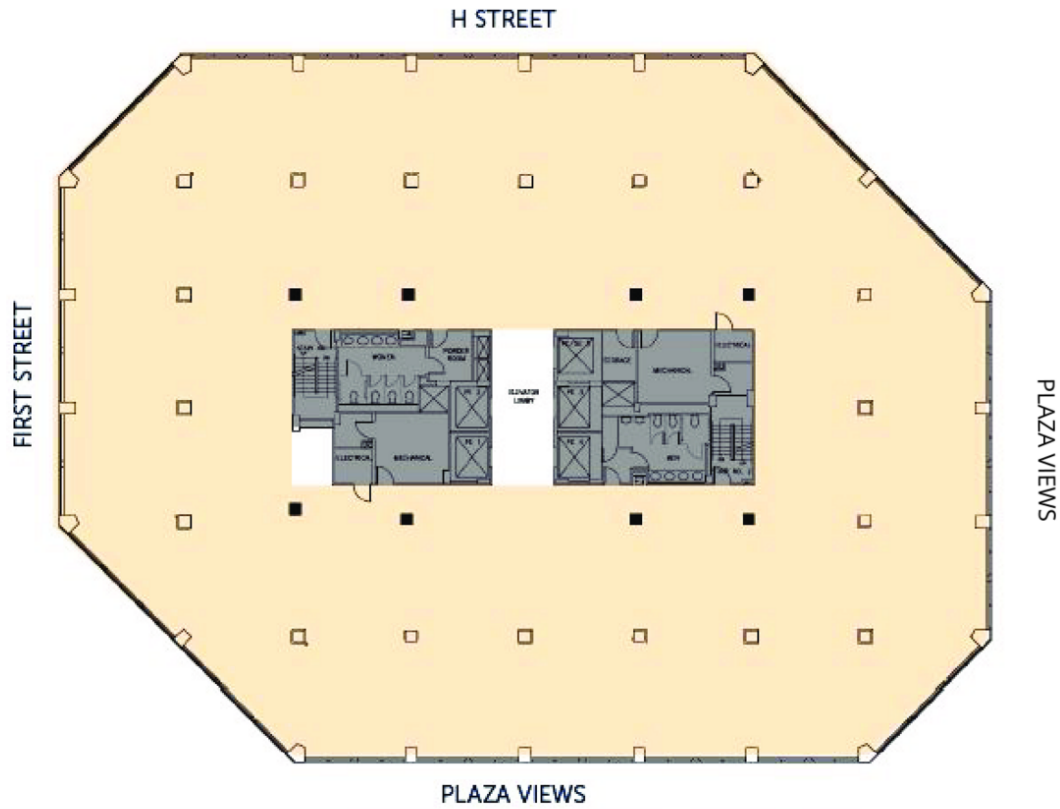

Suite	Size	Lease Rate	Description
Typical Floor Plan	19,523 SF	Negotiable	Full Floors Available Between Floors 4 and 11 Up to 156,184 Contiguous SF

Merrill Turnbull 202.513.6713 mturnbull@lpc.com	Adam Biberaj 202.513.6736 abiberaj@lpc.com	Jae Lee 202.513.6718 jlee@lpc.com	William Ruppe 202.513.6722 wruppe@lpc.com
--	---	--	--

Lincoln



810 FIRST ST, NE
WASHINGTON, D.C. 20002

Nearby Agencies & Broadcasting

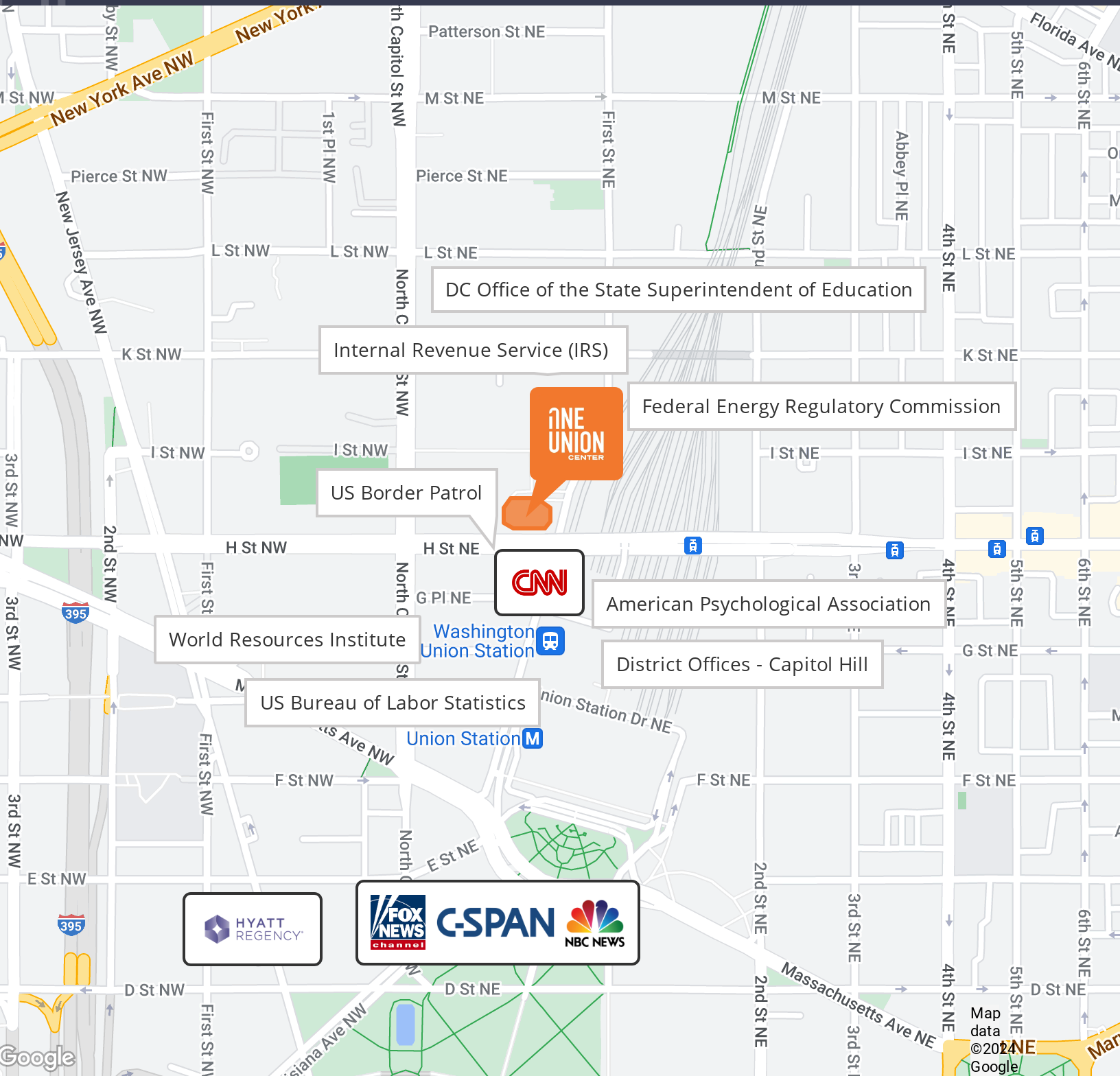

Merrill Turnbull 202.513.6713 mturnbull@lpc.com	Adam Biberaj 202.513.6736 abiberaj@lpc.com	Jae Lee 202.513.6718 jlee@lpc.com	William Ruppe 202.513.6722 wruppe@lpc.com
--	---	--	--



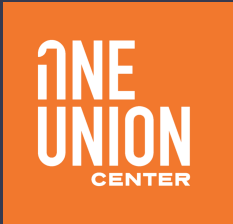

810 FIRST ST, NE
WASHINGTON, D.C. 20002



Leasing Information:
202.513.6700

Merrill Turnbull
 202.513.6713
 mturnbull@lpc.com

Adam Biberaj
 202.513.6736
 abiberaj@lpc.com

Jae Lee
 202.513.6718
 jlee@lpc.com

William Ruppe
 202.513.6722
 wruppe@lpc.com

Lincoln

Lincoln Property Company
 101 Constitution Avenue, NW Suite 325 East
 Washington, DC 20001

www.lpc.com

The information contained herein has been obtained through sources deemed reliable but neither Owner nor Lincoln Property Company makes guarantees, warranties or representations as to its completeness or accuracy.